

2007-08 ACCESSORIES AND EQUIPMENT

Doors - Element

COMPONENT LOCATION INDEX - FRONT DOOR

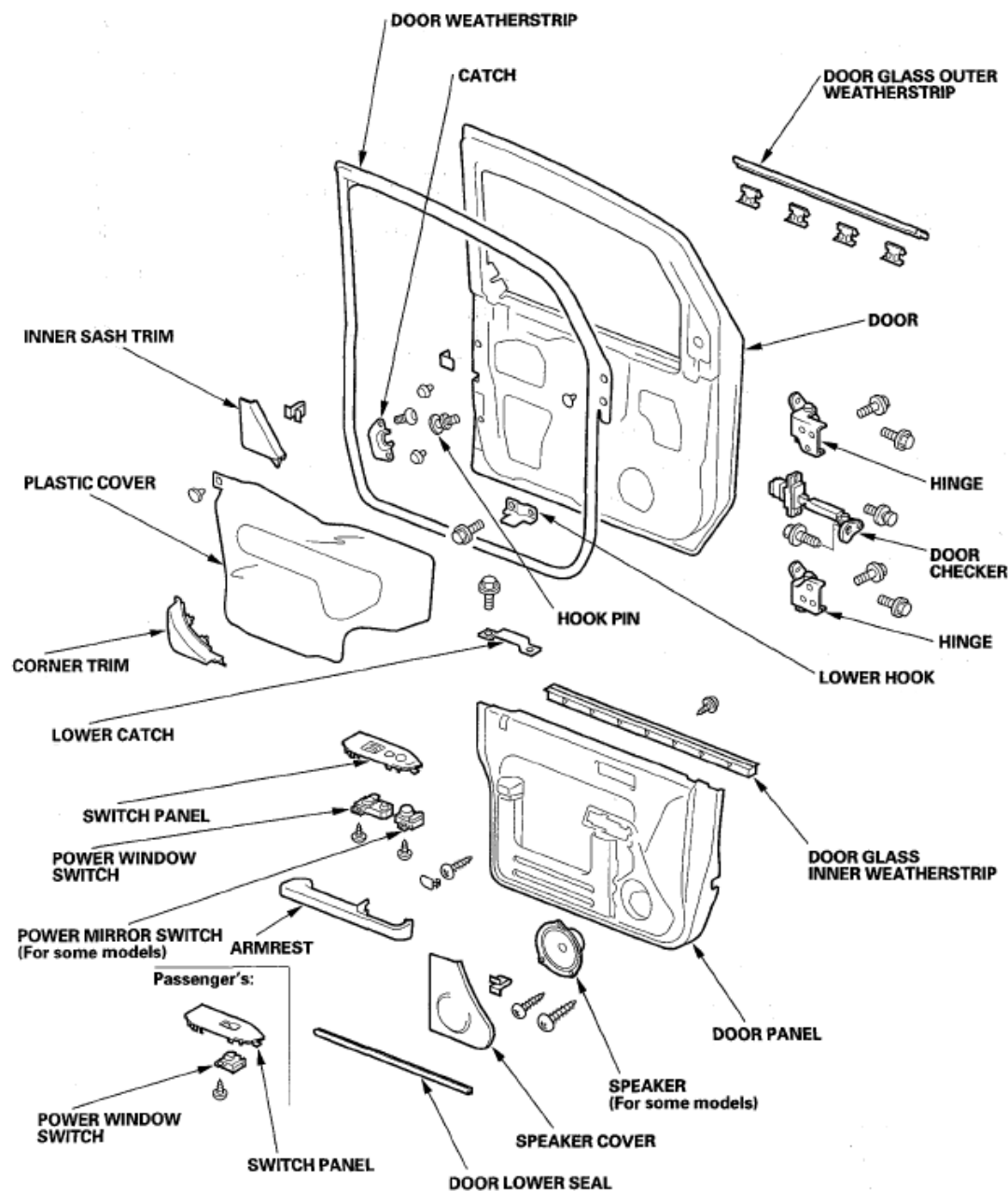

Fig. 1: Exploded View Of Front Doors Components (1 Of 2)
 Courtesy of AMERICAN HONDA MOTOR CO., INC.

2007 Honda Element EX

2007-08 ACCESSORIES AND EQUIPMENT Doors - Element

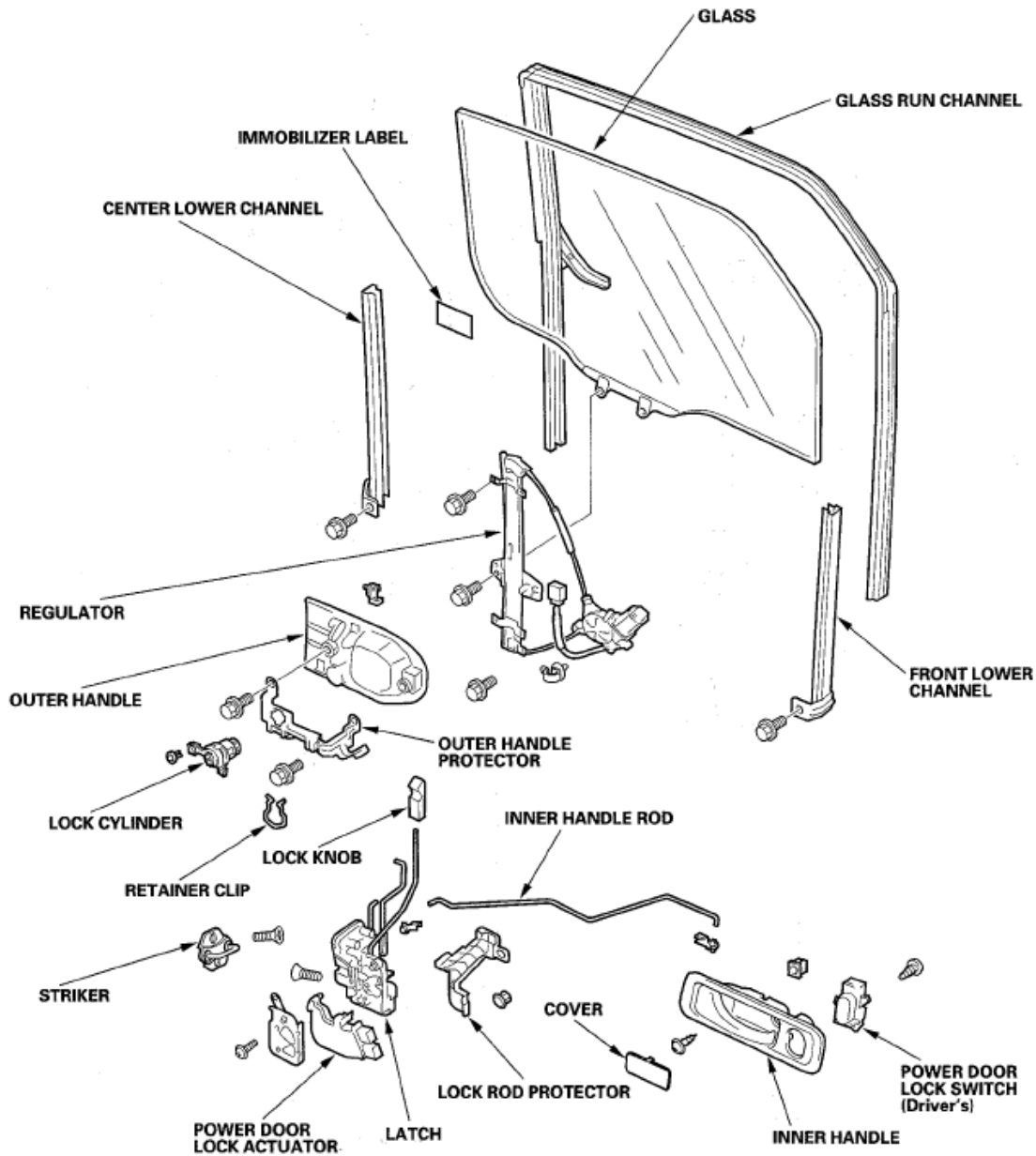

Fig. 2: Exploded View Of Front Doors Components (2 Of 2)

Courtesy of AMERICAN HONDA MOTOR CO., INC.

COMPONENT LOCATION INDEX - REAR DOOR

2007 Honda Element EX

2007-08 ACCESSORIES AND EQUIPMENT Doors - Element

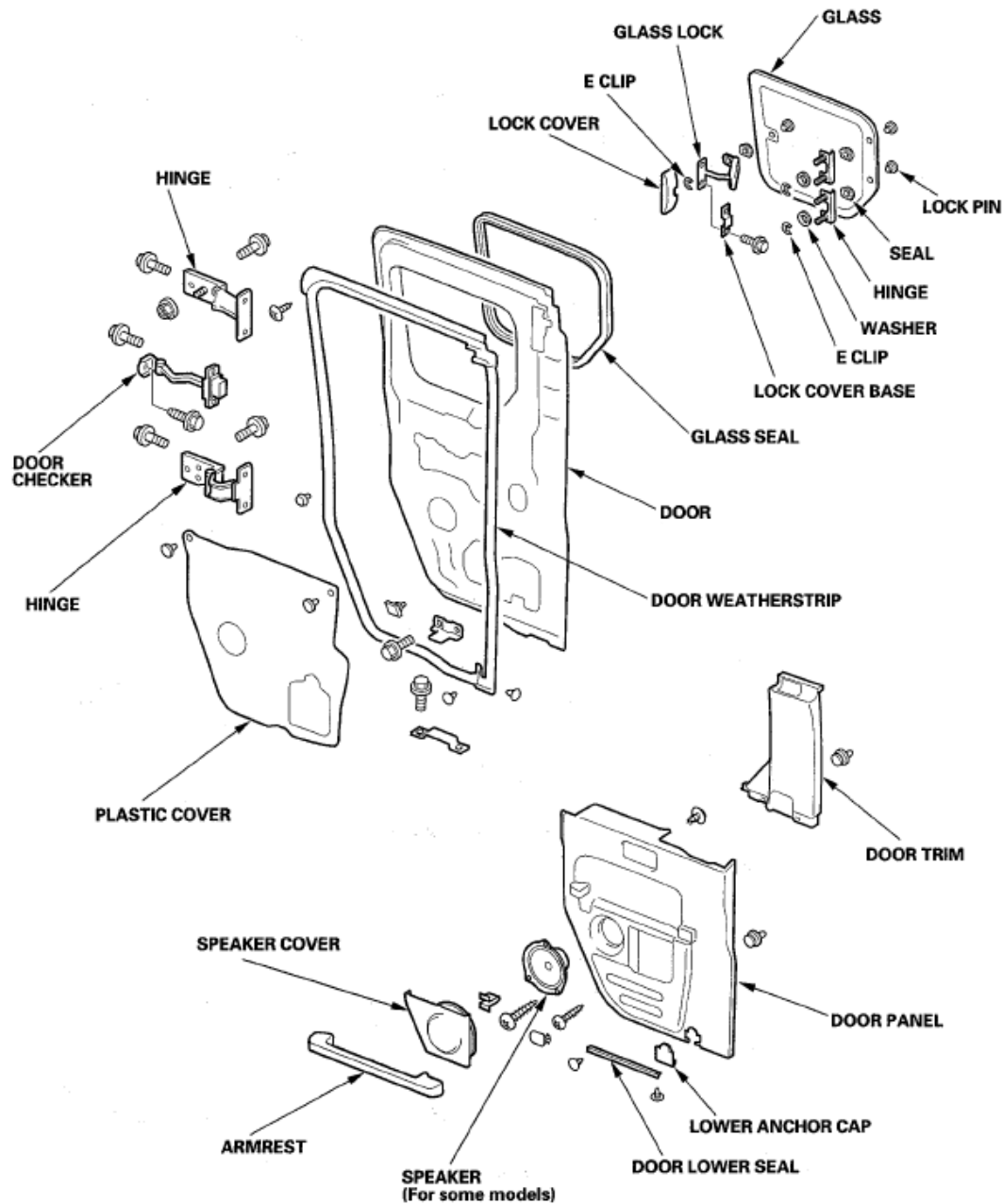

Fig. 3: Exploded View Of Rear Doors Components (1 Of 2)
Courtesy of AMERICAN HONDA MOTOR CO., INC.

2007 Honda Element EX

2007-08 ACCESSORIES AND EQUIPMENT Doors - Element

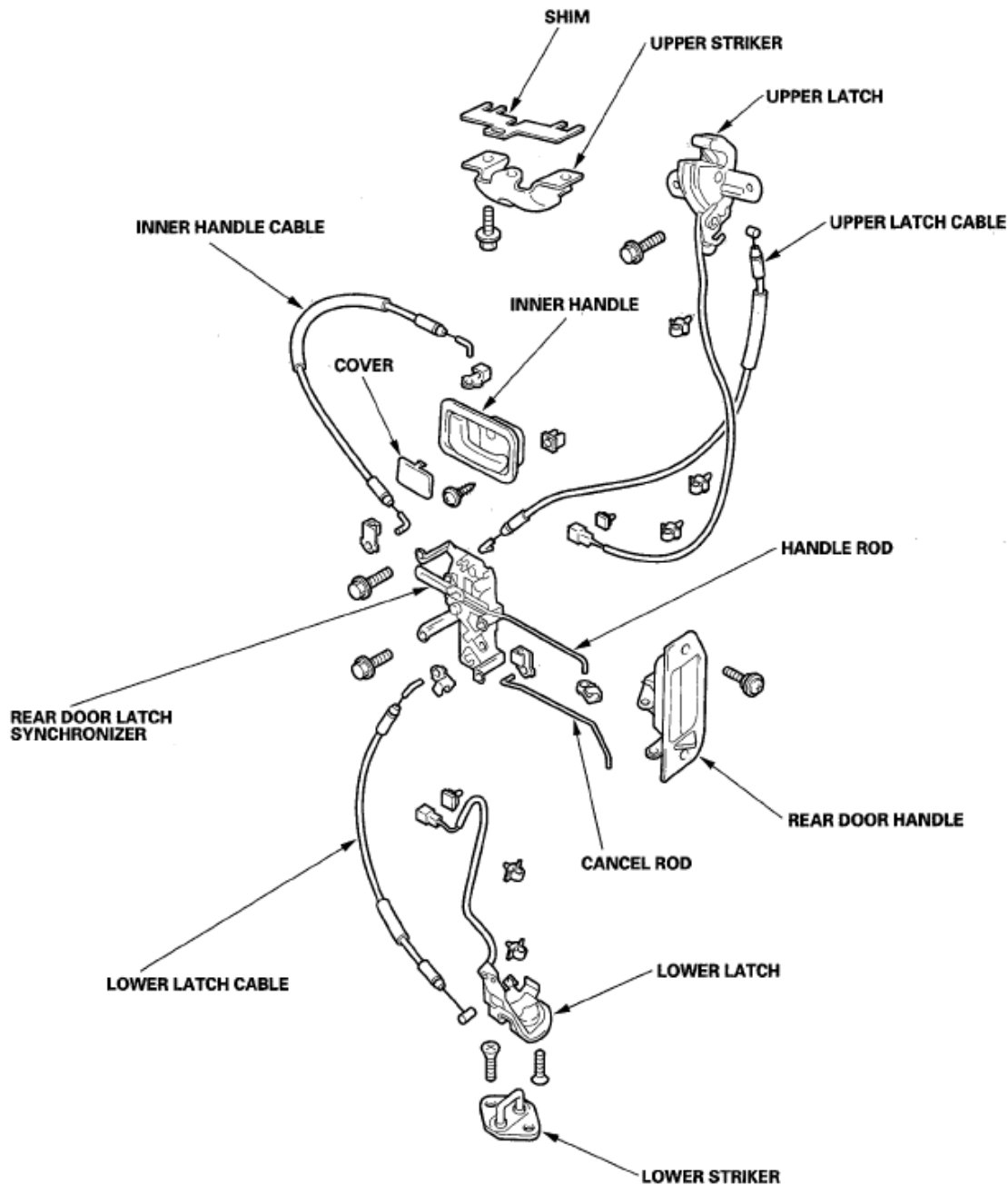

Fig. 4: Exploded View Of Rear Doors Components (2 Of 2)
Courtesy of AMERICAN HONDA MOTOR CO., INC.

FRONT DOOR PANEL REMOVAL/INSTALLATION

Special Tools Required

- KTC trim tool set SOJATP2014 *
- Trim pad remover. Snap-on A 177A or equivalent, commercially available

*Available through the American Honda Tool and Equipment Program; call 888-424-6857

NOTE: Use the appropriate tool from the KTC trim tool set to avoid damage when prying components.

1. Remove the inner handle (A).
 - 1 Using the appropriate tool from the KTC trim tool set, pry out on the upper portion of the cover (B) to release the upper hook (C), and pull up the cover to release the lower hooks (D), then remove the cover.
 - 2 Remove the screws.
 - 3 Release the hook (E), and pull the inner handle forward and out half-way to release the hook (F).
 - 4 Disconnect the inner handle rod (G).
 - 5 Disconnect the power door lock switch connector (H).

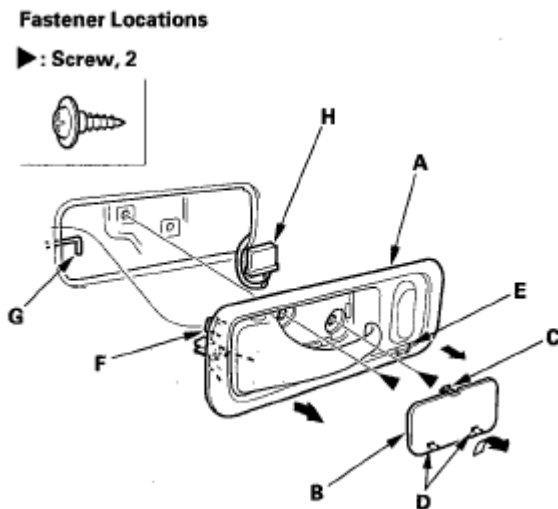

Fig. 5: Disconnecting Power Door Lock Switch Connector
Courtesy of AMERICAN HONDA MOTOR CO., INC.

2. Pull out on the speaker cover (A) to detach the hooks (B) and clips (C), then remove the cover.

Fastener Locations

C▷: Clip, 2 D▷: Screw, 3

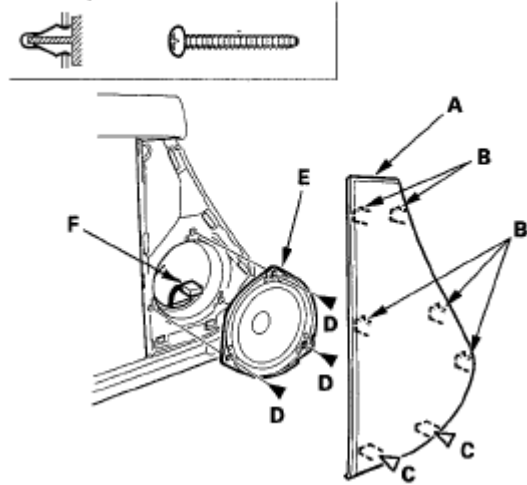

Fig. 6: Pulling Out On Speaker Cover

Courtesy of AMERICAN HONDA MOTOR CO., INC.

3. Remove the screws (D), then remove the speaker (E) (for some models), and disconnect its connector (F).
4. From under the armrest, using the appropriate tool from the KTC trim tool set, pry out the lid (A), and remove the screw.

Fastener Location

▷: Screw, 1

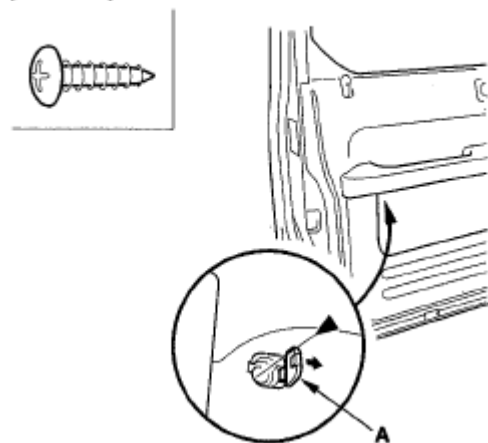

Fig. 7: Identifying Faster Location

Courtesy of AMERICAN HONDA MOTOR CO., INC.

5. Lower the glass fully.
6. Remove the mirror mount cover (see step 2 in **POWER MIRROR/MANUAL MIRROR REPLACEMENT**).
7. Lower the front window so you can access the inner sash trim (A).

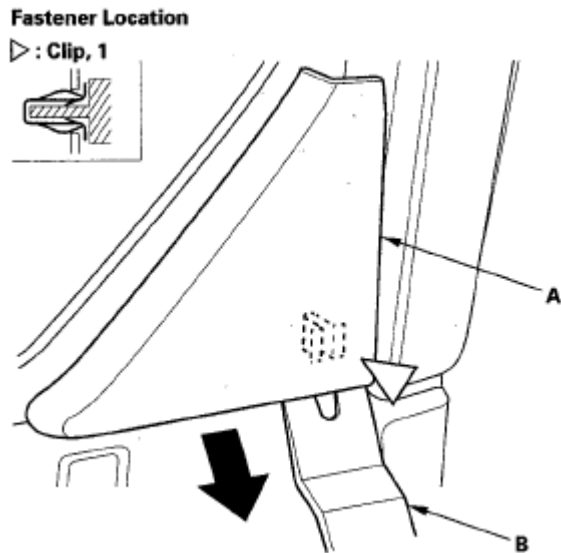

Fig. 8: Identifying Inner Sash Trim

Courtesy of AMERICAN HONDA MOTOR CO., INC.

8. Use a trim tool (B) to release the clip at the lower rear corner of the sash trim. Pry out from the edge of the sash trim until the clip releases.
9. While pressing down the front corner (A) of the sash trim, pull the top corner (B) forward until the sash trim releases.

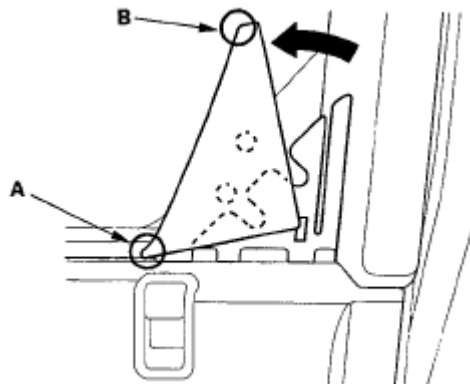

Fig. 9: Pulling Top Corner

Courtesy of AMERICAN HONDA MOTOR CO., INC.

10. Remove the door panel (A) with as little bending as possible to avoid creasing or breaking it.
 - 1 Release the clips that hold the door panel with a commercially available trim pad remover (B).
 - 2 Starting at the rear, pull the door panel upward, then release the lock knob (C).
 - 3 Disconnect the power window switch connector (D), power mirror switch connector (on the driver's door) (E).

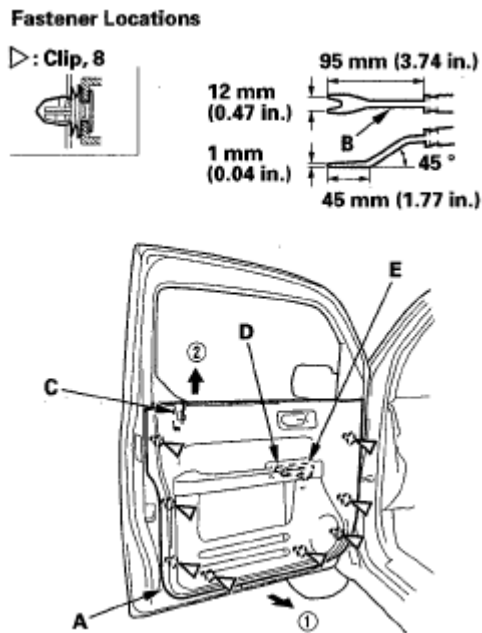

Fig. 10: Disconnecting Power Window Switch Connector And Power Mirror Switch Connector With Specification
 Courtesy of AMERICAN HONDA MOTOR CO., INC.

11. Install the door panel in the reverse order of removal, and note these items:
 - Check if the clips are damaged or stress-whitened, and if necessary, replace them with new ones.
 - Make sure the connectors are plugged in properly, and the rod is connected properly.
 - Push the clips portion into place securely.
 - Do the power window control unit reset procedure (see **RESETTING THE POWER WINDOW CONTROL UNIT**).
 - Check the window and power door lock operations.
 - When reinstalling the door panel, make sure the plastic cover is installed properly and sealed around its perimeter to seal out water.
 - Check for water leaks (see step 7).

FRONT DOOR OUTER HANDLE REPLACEMENT

NOTE: Put on gloves to protect your hands.

1. Remove these items:
 - Door panel (see **FRONT DOOR PANEL REMOVAL/INSTALLATION**)
 - Plastic cover, as necessary (see **COMPONENT LOCATION INDEX - FRONT DOOR**)
2. Raise the glass fully.
3. Pull the glass run channel (A) away as necessary, and remove the bolt, then remove the center lower channel (B) by pulling it downward.

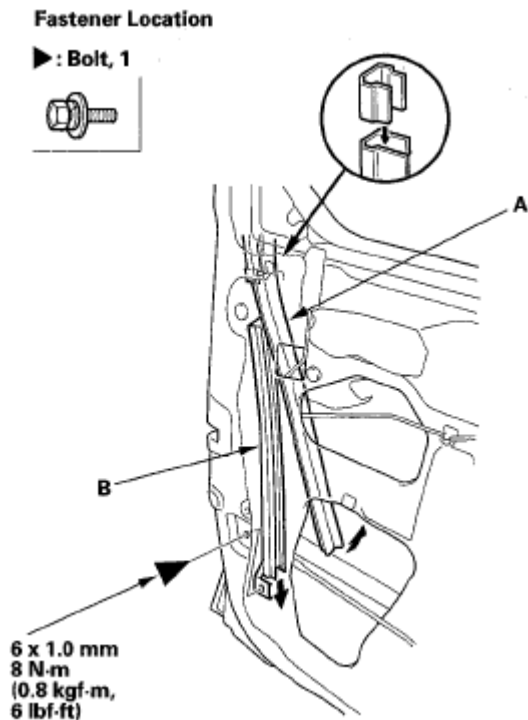

Fig. 11: Removing Center Lower Channel With Torque Specification

Courtesy of AMERICAN HONDA MOTOR CO., INC.

4. Remove the access seal (A), and disconnect the outer handle rod (B) from the bushing (C) and cylinder rod (D).

NOTE: Check the bushing for damage and replace if necessary.

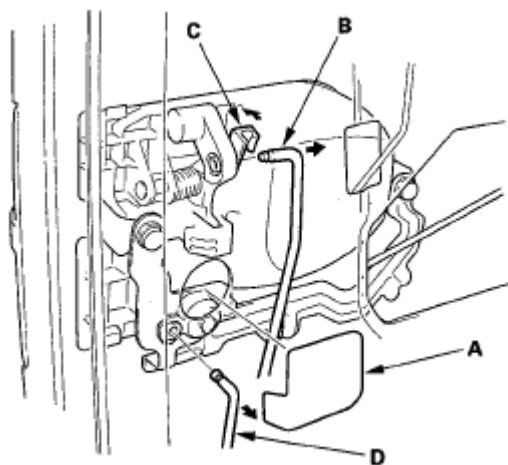

Fig. 12: Disconnecting Outer Handle Rod From Bushing And Cylinder Rod

Courtesy of AMERICAN HONDA MOTOR CO., INC.

5. Push the top of the retainer clip (A) with a flat-tip screwdriver (B), and hold it. Release the retainer clip

with a hook-shaped tool (C), then remove the lock cylinder (D).

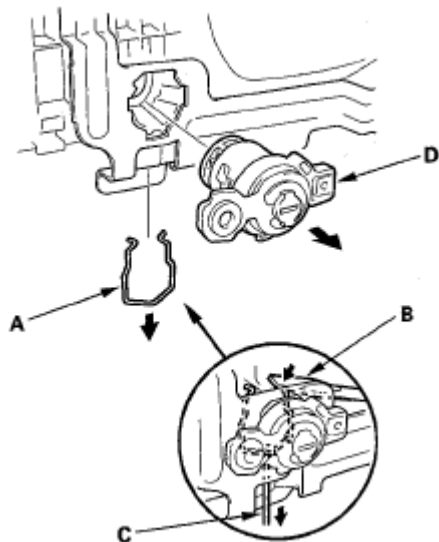

Fig. 13: Pushing Top Of Retainer Clip With Flat-Tip Screwdriver
 Courtesy of AMERICAN HONDA MOTOR CO., INC.

6. Remove the bolts, then remove the outer handle protector (A).

Fastener Locations

▶ : Bolt, 2

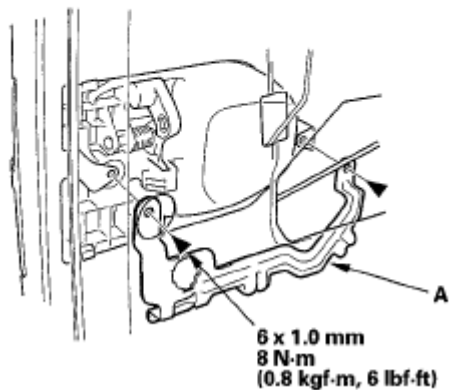
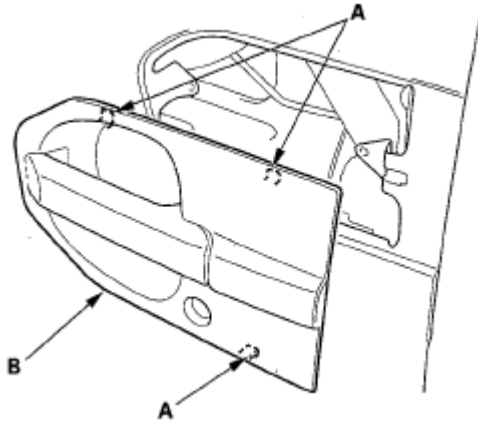

Fig. 14: Removing Outer Handle Protector With Torque Specification
 Courtesy of AMERICAN HONDA MOTOR CO., INC.

7. Release the hooks (A), then remove the outer handle (B). Take care not to scratch the door.

**Fig. 15: Removing Outer Handle**

Courtesy of AMERICAN HONDA MOTOR CO., INC.

8. Install the outer handle in the reverse order of removal, and note these items:
 - Make sure each rod is connected securely.
 - Make sure the door locks and opens properly.
 - When installing the lock cylinder, leave the outer door handle bolts loose so the inner protector does not interfere with the lock cylinder installation, then tighten the handle bolts.
 - Install the lock cylinder retaining clip on the handle, then install the lock cylinder. Be sure the clip is fully seated in the slot on the lock cylinder.
 - When reinstalling the door panel, make sure the plastic cover is installed properly and sealed around its perimeter to seal out water.
 - Check for water leaks.

FRONT DOOR LATCH REPLACEMENT

NOTE: Put on gloves to protect your hands.

1. Remove these items:
 - Door panel (see **FRONT DOOR PANEL REMOVAL/INSTALLATION**)
 - Plastic cover, as necessary (see **COMPONENT LOCATION INDEX - FRONT DOOR**)
2. Raise the glass fully.
3. Remove the center lower channel (see step 3).
4. Remove the access seal, and disconnect the outer handle rod and cylinder rod (see step 4).
5. To ease reassembly, note the distance (A) of the lock rod (B) on the lock knob (C) before disconnecting it.

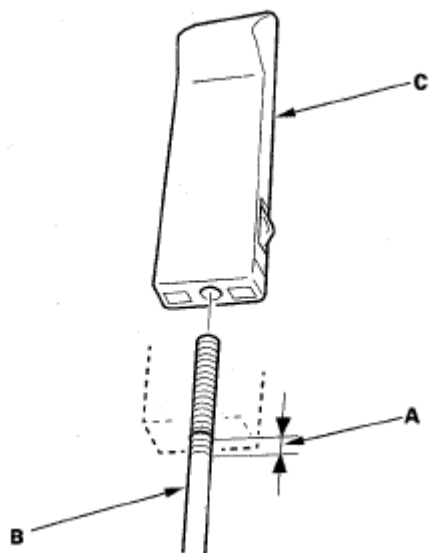

Fig. 16: Identifying Lock Rod On Lock Knob
 Courtesy of AMERICAN HONDA MOTOR CO., INC.

6. Remove the latch (A). Take care not to bend the outer handle rod (B), cylinder rod (C), lock rod (D), and inner handle rod (E).
 - 1 Remove the clip (F).
 - 2 Release the inner handle rod from the rod holder (G).
 - 3 Disconnect the connectors (H).
 - 4 Remove the screws (I).

Fastener Locations

F ▷: Clip, 1 I ▷: Screw, 3

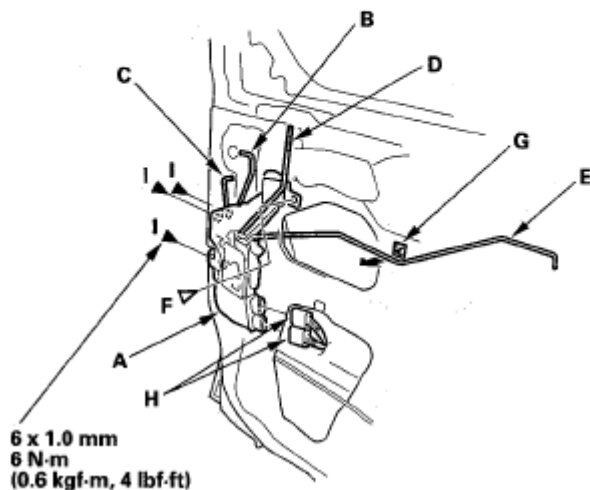
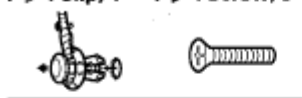

Fig. 17: Removing Screws And Connectors With Torque Specification
Courtesy of AMERICAN HONDA MOTOR CO., INC.

7. Pull the latch (A) out until you can disconnect the inner handle rod (B), then disconnect the rod.

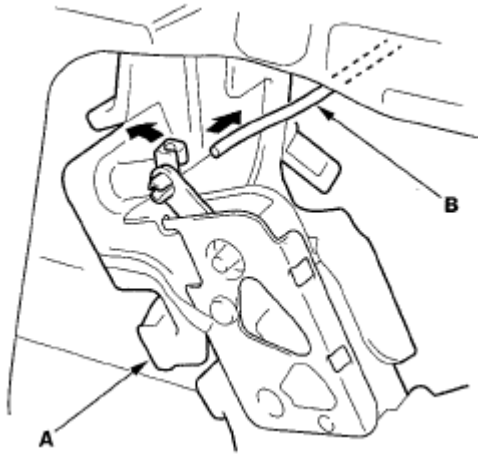

Fig. 18: Disconnecting Inner Handle Rod
Courtesy of AMERICAN HONDA MOTOR CO., INC.

8. Remove the latch from the hole in the door. Take care not to bend the rods.
9. Pull the lock rod protector (A) upward, then remove the protector from the latch (B).

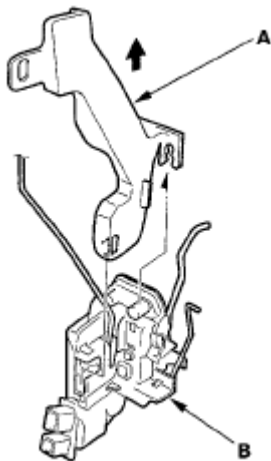

Fig. 19: Removing Protector From Latch
Courtesy of AMERICAN HONDA MOTOR CO., INC.

10. Install the latch in the reverse order of removal, and note these items:
 - Make sure the actuator connectors are plugged in properly, and each rod is connected securely.
 - Make sure the door locks and opens properly.
 - When reinstalling the door panel, make sure the plastic cover is installed properly and sealed

around its perimeter to seal out water.

- Check for water leaks.

FRONT DOOR GLASS AND REGULATOR REPLACEMENT

NOTE: Put on gloves to protect your hands.

1. Remove these items:
 - Door panel (see **FRONT DOOR PANEL REMOVAL/INSTALLATION**)
 - Plastic cover, as necessary (see **COMPONENT LOCATION INDEX - FRONT DOOR**)
2. Carefully lower the glass (A) until you can see the bolts, then remove them. Carefully pull the glass out through the window slot. Take care not to drop the glass inside the door.

Fastener Locations

▶ : Bolt, 2

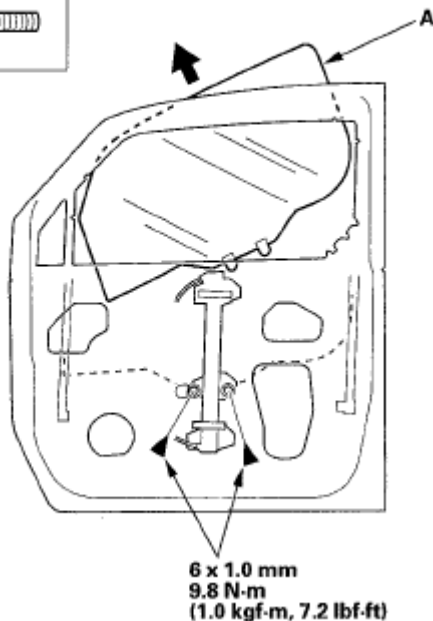

Fig. 20: Pulling Glass Out Through Window Slot With Torque Specification
Courtesy of AMERICAN HONDA MOTOR CO., INC.

3. Disconnect and detach the connector (A) and harness clips (B) from the door.

2007 Honda Element EX

2007-08 ACCESSORIES AND EQUIPMENT Doors - Element

Fastener Locations

C ► : Bolt, 3 D ► : Bolt, 4



6 x 1.0 mm
8 N-m
(0.8 kgf-m,
6 lbf-ft)

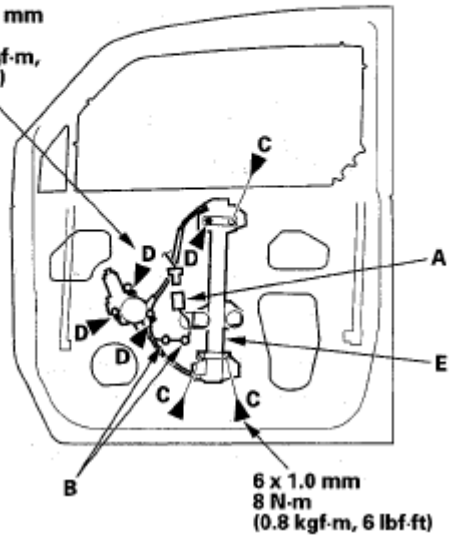

6 x 1.0 mm
8 N-m
(0.8 kgf-m, 6 lbf-ft)

Fig. 21: Detaching Connector And Harness Clips From Door With Torque Specification
Courtesy of AMERICAN HONDA MOTOR CO., INC.

4. Remove the bolts (C), and loosen the bolts (D), then remove the regulator (E) through the hole in the door.
5. Apply multipurpose grease to all the sliding surfaces of the regulator (A) where shown.

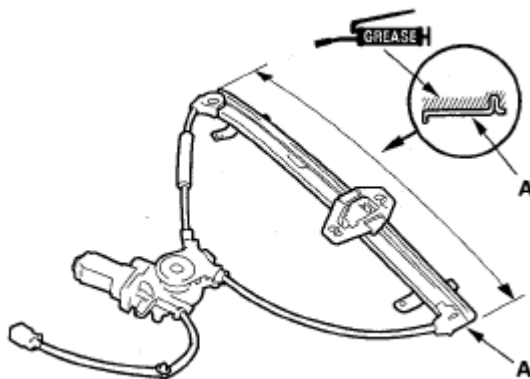

Fig. 22: Removing Regulator Through Hole In Door
Courtesy of AMERICAN HONDA MOTOR CO., INC.

6. Install the glass and regulator in the reverse order of removal, and note these items:
 - Roll the glass up and down to see if it moves freely without binding.
 - Make sure that there is no clearance between the glass and glass run channel when the glass is

closed.

- Adjust the position of the glass as necessary (see **FRONT DOOR GLASS ADJUSTMENT**).
- When reinstalling the door panel, make sure the plastic cover is installed properly and sealed around its perimeter to seal out water.
- Check for water leaks (see step 7).
- Test-drive and check for wind noise and rattles.

FRONT DOOR GLASS ADJUSTMENT

NOTE:

- Check the weatherstrips and glass run channel for damage or deterioration, and replace them if necessary.
- Wipe the run channel clean with a shop towel.
- Lubricate the run channel with Shin-Etsu silicone grease P/N 08798-9013.

1. Place the vehicle on a firm, level surface.
2. Remove these items:
 - Door panel (see **FRONT DOOR PANEL REMOVAL/INSTALLATION**)
 - Plastic cover (see **COMPONENT LOCATION INDEX - FRONT DOOR**)
3. Carefully move the glass (A) until you can see the glass mounting bolts (B), then loosen them.

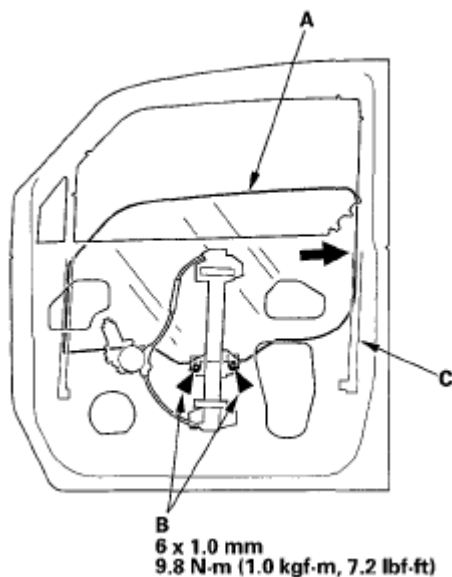

Fig. 23: Identifying Glass And Glass Mounting Bolts With Torque Specification
Courtesy of AMERICAN HONDA MOTOR CO., INC.

4. Push the glass against the channel (C), then tighten the glass mounting bolts.
5. Check that the glass moves smoothly.
6. Raise the glass fully, and check for gaps. Also check that the glass (A) contacts the glass run channel (B)

evenly.

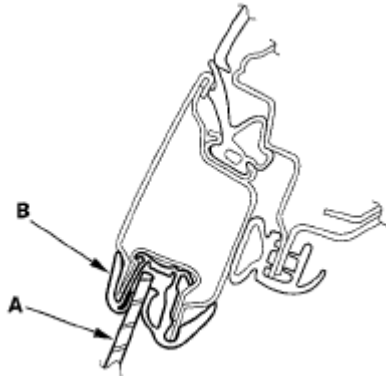

Fig. 24: Identifying Glass And Glass Run Channel
Courtesy of AMERICAN HONDA MOTOR CO., INC.

7. Check for water leaks. Run water over the roof and on the sealing area as shown, and note these items:
 - Use a 12 mm (1/2 in.) diameter hose (A).
 - Adjust the rate of water flow as shown (B).
 - Do not use a nozzle.
 - Hold the hose about 300 mm (12 in.) away from the door (C).

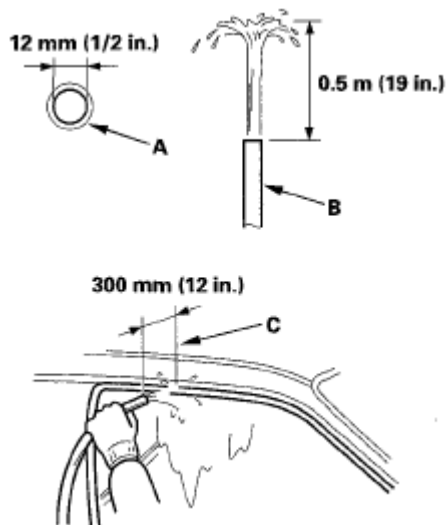

Fig. 25: Checking Water Leaks
Courtesy of AMERICAN HONDA MOTOR CO., INC.

8. Attach the plastic cover making sure it is sealed around its outside perimeter to seal out water, then install the door panel (see **FRONT DOOR PANEL REMOVAL/INSTALLATION**).
9. Test-drive and check for wind noise.

FRONT DOOR GLASS OUTER WEATHERSTRIP REPLACEMENT

Special Tools Required

KTC trim tool set SOJATP2014 *

* Available through the American Honda Tool and Equipment Program; call 888-424-6857

NOTE:

- Put on gloves to protect your hands.
- Take care not to scratch the door.
- Use the appropriate tool from the KTC trim tool set to avoid damage when prying components.

1. Remove the power/manual mirror (see [POWER MIRROR/MANUAL MIRROR REPLACEMENT](#)).
2. Starting at the rear, pry the door glass outer weatherstrip (A) up to detach the clips, and release the weatherstrip from the glass run channel (B), then remove the weatherstrip.

Fastener Locations

▷: Clip, 4

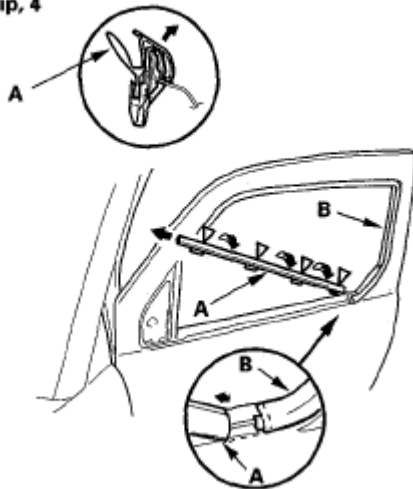

Fig. 26: Identifying Door Glass Outer Weatherstrip And Glass Run Channel
 Courtesy of AMERICAN HONDA MOTOR CO., INC.

3. Install the weatherstrip in the reverse order of removal, and note these items:
 - Check if the clips are damaged or stress-whitened, and if necessary, replace them with new ones.
 - Push the clips into place securely.

FRONT DOOR WEATHERSTRIP REPLACEMENT

NOTE:

- Take care not to scratch the door.

- Use a clip remover to remove the clips.

1. At the A-pillar, remove the door checker mounting bolt (A).

Fastener Locations

A ▶ : Bolt, 1 B ▷ : Clip, 3 C ▷ : Clip, 22

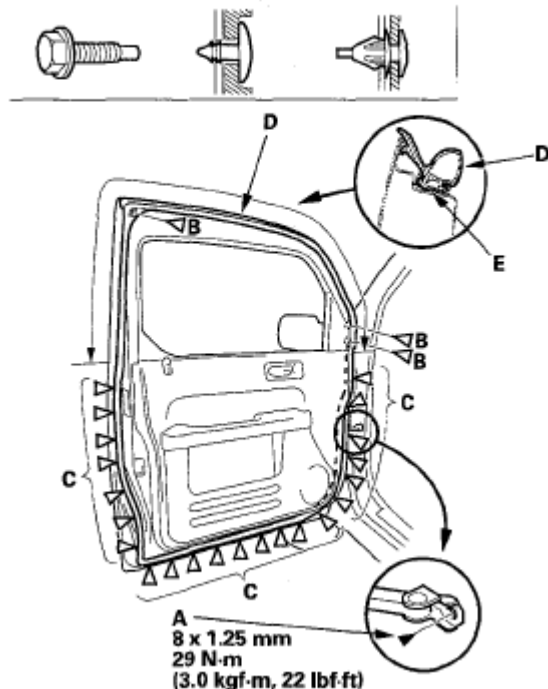

Fig. 27: Removing Door Checker Mounting Bolt With Torque Specification
 Courtesy of AMERICAN HONDA MOTOR CO., INC.

2. Detach the clips (B, C), then remove the door weatherstrip (D).
3. Install the weatherstrip in the reverse order of removal, and note these items:
 - Check if the clips are damaged or stress-whitened, and if necessary, replace them with new ones.
 - Push the clips into place securely.
 - Make sure the weatherstrip is installed in the holder (E) securely.
 - Apply liquid thread lock to the door checker mounting bolt before installation.
 - When reinstalling the door panel, make sure the plastic cover is installed properly and sealed around its perimeter to seal out water.
 - Check for water leaks.
 - Test-drive and check for wind noise.

FRONT DOOR INNER CORNER TRIM REPLACEMENT

Special Tools Required

KTC trim tool set SOJATP2014 *

* Available through the American Honda Tool and Equipment Program; call 888-424-6857

NOTE:

- Take care not to scratch the door.
- Use a clip remover to remove the clips.
- Use the appropriate tool from the KTC trim tool set to avoid damage when prying components.

1. Detach the clips (A), then remove the weatherstrip (B) pull out on the inner corner trim (C) to release the clips (D).

Fastener Locations

A ▷ : Clip, 3 D ▷ : Clip, 2

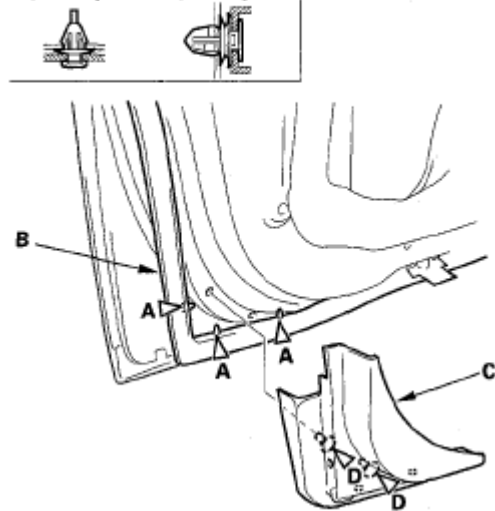

Fig. 28: Pulling Out Inner Corner Trim

Courtesy of AMERICAN HONDA MOTOR CO., INC.

2. Install the inner corner trim in the reverse order of removal, and note these items:
 - Check if the clips are damaged or stress-whitened, and if necessary, replace them with new ones.
 - Push the clips into place securely.

FRONT DOOR HOOK PIN AND CATCH REPLACEMENT

1. With a TORX T40 bit, remove the door hook pin (A) from the front door.

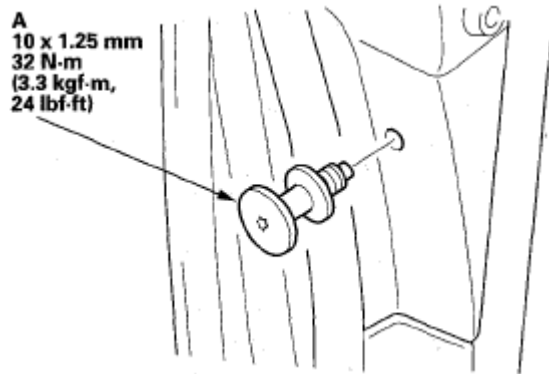

Fig. 29: Removing Door Hook Pin From Front Door With Torque Specification
Courtesy of AMERICAN HONDA MOTOR CO., INC.

2. With a TORX T40 bit, remove the bolts, then remove the catch (A) from the rear door.

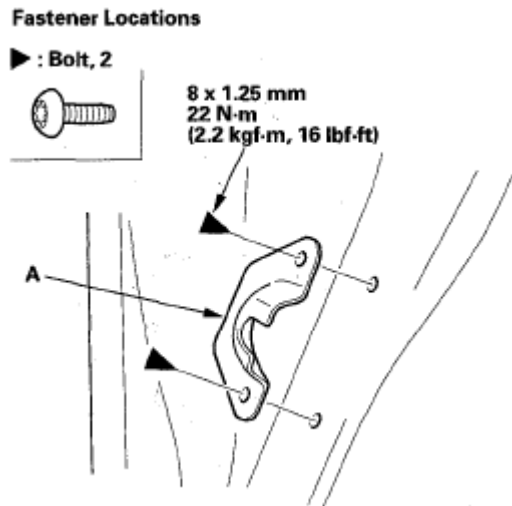

Fig. 30: Removing Catch From Rear Door With Torque Specification
Courtesy of AMERICAN HONDA MOTOR CO., INC.

3. Install the hook pin and catch in the reverse order of removal, and apply liquid thread lock to the threads of the door hook pin.
4. Apply touch-up paint to the catch mounting bolts and around the catch.

FRONT DOOR LOWER HOOK AND LOWER CATCH REPLACEMENT

NOTE: Put on gloves to protect your hands.

1. Remove the bolts, then remove the lower hook (A).

Fastener Locations

► : Bolt, 2

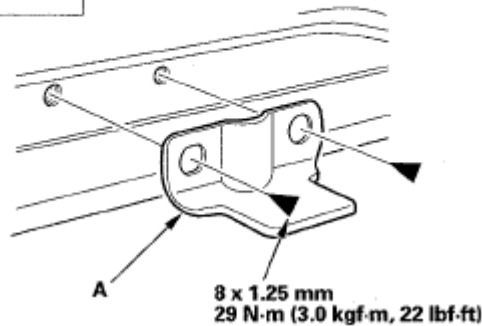

Fig. 31: Removing Lower Hook With Torque Specification
 Courtesy of AMERICAN HONDA MOTOR CO., INC.

2. Remove the door sill trim (see **TRIM REMOVAL/INSTALLATION - DOOR AREAS**).
3. Remove the bolts, then remove the lower catch (A).

Fastener Locations

► : Bolt, 2

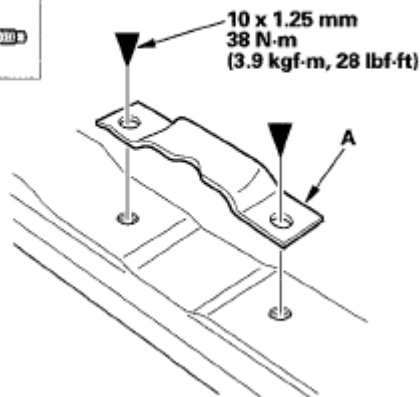

Fig. 32: Removing Lower Catch With Torque Specification
 Courtesy of AMERICAN HONDA MOTOR CO., INC.

4. Install the lower hook and lower catch in the reverse order of removal, and apply touch-up paint to the lower hook mounting bolts and around the lower hook.

FRONT DOOR POSITION ADJUSTMENT

NOTE: Check for a flush fit with the body, then check for equal gaps between the front, rear, and bottom door edges and the body. Check that the door and body edges are parallel.

1. Place the vehicle on a firm, level surface when adjusting the doors.
2. Adjust at the hinges (A):
 - Remove the front fender cladding (see **FRONT FENDER CLADDING REPLACEMENT**) and front inner fender (see **FRONT INNER FENDER REPLACEMENT**).
 - Pad a floor jack (B) with shop towels (C), then use the jack to support the door to prevent damage to the door while adjusting it.
 - Loosen the hinge mounting bolts (D) slightly, and move the door backward or forward, up or down as necessary to equalize the gaps.

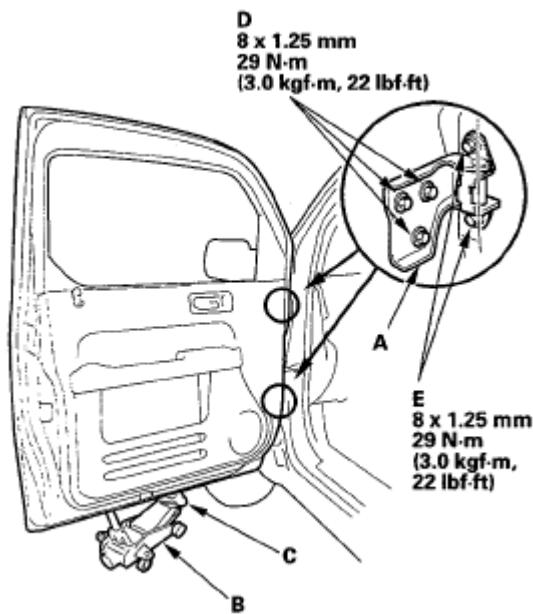

Fig. 33: Identifying Hinge Mounting Bolts With Torque Specification
 Courtesy of AMERICAN HONDA MOTOR CO., INC.

3. If necessary, replace the door mounting bolts (E) with the adjusting bolts (P/N 90102-SFA-305) made specifically for door adjustment, then adjust at the door: Loosen the door mounting bolts slightly, and move the door up or down as necessary to equalize the gaps, and in or out until it's flush with the body.
4. Check that the door and body edges are parallel. If necessary, adjust the door cushion (A) to make the rear of the door flush with the body.

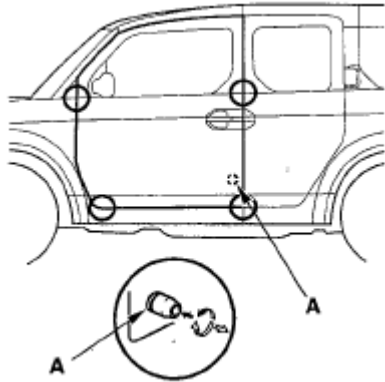

Fig. 34: Identifying Door Cushion

Courtesy of AMERICAN HONDA MOTOR CO., INC.

5. Apply touch-up paint to the hinge mounting bolts, and around the hinges.
6. Check for water leaks (see step 7).
7. Test-drive and check for wind noise.

FRONT DOOR STRIKER ADJUSTMENT

Make sure the door latches securely without slamming it. If necessary, adjust the striker (A): The striker nuts are fixed, but the striker can be adjusted slightly up or down, and in or out.

1. Loosen the screws (B).

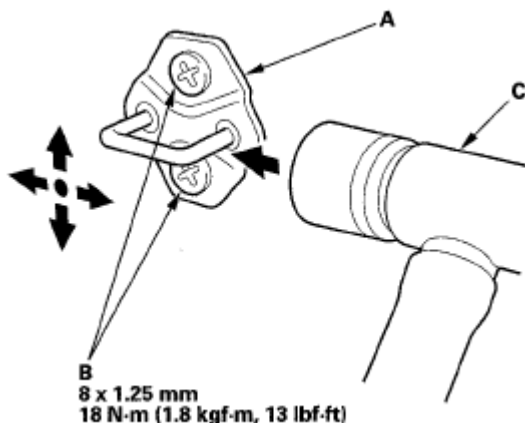

Fig. 35: Identifying Front Door Striker Adjustment With Torque Specification

Courtesy of AMERICAN HONDA MOTOR CO., INC.

2. Wrap the striker with a shop towel, then adjust the striker by tapping it with a plastic hammer (C). Do not tap the striker too hard.
3. Lightly tighten the screws.
4. Hold the outer handle out, and push the door against the body to be sure the striker allows a flush fit. If

the door latches properly, tighten the screws and recheck.

REAR DOOR PANEL REMOVAL/INSTALLATION

Special Tools Required

- KTC trim tool set SOJATP2014 *
- Trim pad remover, Snap-on A 177A or equivalent, commercially available

* Available through the American Honda Tool and Equipment Program; call 888-424-6857

NOTE: Use the appropriate tool from the KTC trim tool set to avoid damage when prying components.

SRS components are located in this area. Review the SRS component locations (see COMPONENT LOCATION INDEX) and the precautions and procedures (see PRECAUTIONS AND PROCEDURES) before doing repairs or service.

1. Using the appropriate tool from the KTC trim tool set, pry out on the upper portion of the cover (A) to release the upper hook (B), and pull up the cover to release the lower hooks (C), then remove the cover, and remove the screws securing the inner handle (D).

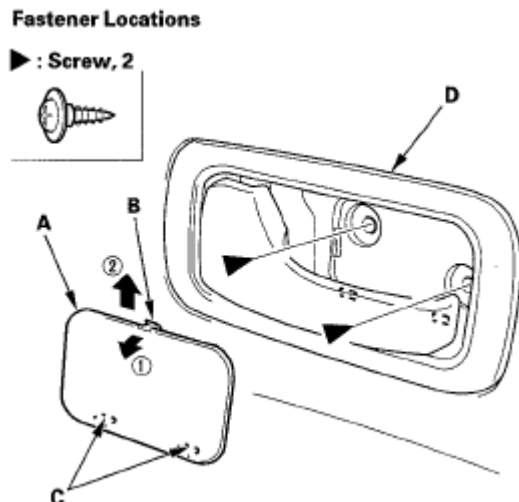

Fig. 36: Removing Screws Securing Inner Handle
Courtesy of AMERICAN HONDA MOTOR CO., INC.

2. Pull out on the front edge of the inner handle (A), and pull the inner handle forward to release the hook (B).

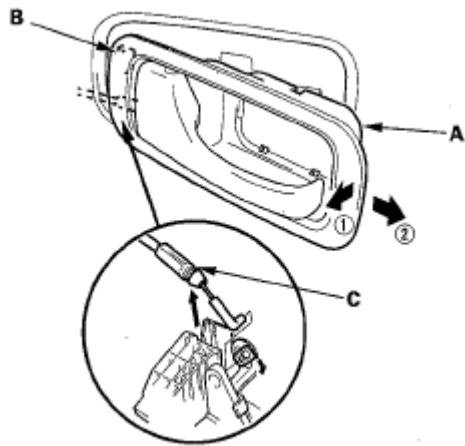

Fig. 37: Pulling Out On Front Edge Of Inner Handle
 Courtesy of AMERICAN HONDA MOTOR CO., INC.

3. Disconnect the inner handle cable (C), then remove the inner handle.
4. Pull out on the speaker cover (A) to detach the hooks (B) and clips (C), then remove the cover.

Fastener Locations

C ▷ : Clip, 2 D ▷ : Screw, 3 G ▷ : Screw, 1

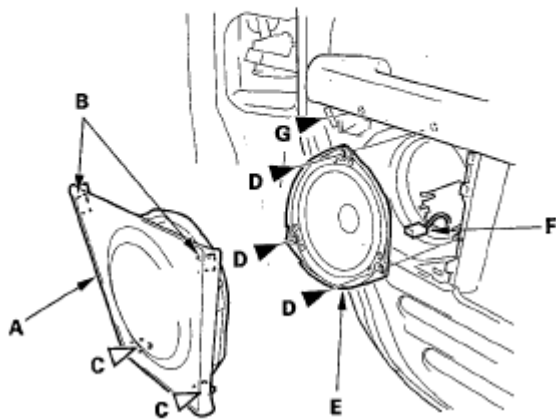
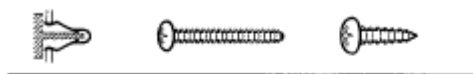

Fig. 38: Identifying Hooks And Clips
 Courtesy of AMERICAN HONDA MOTOR CO., INC.

5. Remove the screws (D), then remove the speaker (E) (for some models), and disconnect its connector (F).
6. Remove the screw (G).
7. From under the armrest, using the appropriate tool from the KTC trim tool set, pry out the lid (A), and remove the screw.

Fastener Location

► : Screw, 1

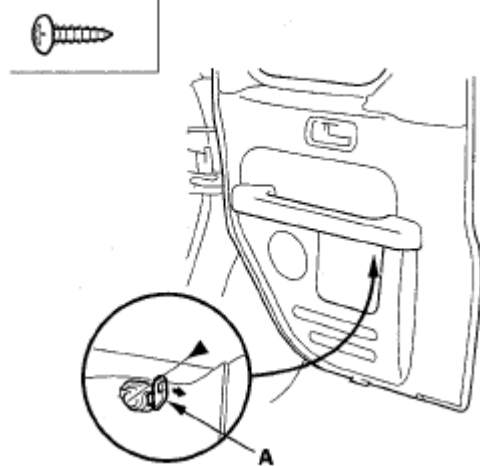

Fig. 39: Prying Out Lid

Courtesy of AMERICAN HONDA MOTOR CO., INC.

8. Pull out on the bottom of the lower anchor cap (A) to release the hooks (B), and pull down on the cap to release the hooks (C), then remove the cap from the door panel (D).

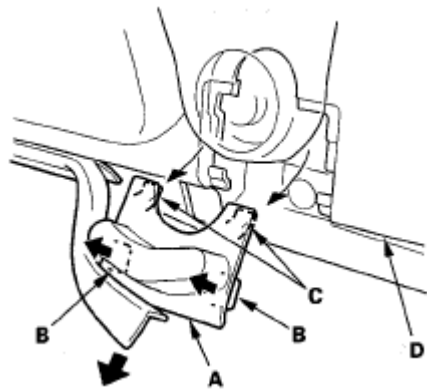

Fig. 40: Pulling Out On Bottom Of Lower Anchor Cap

Courtesy of AMERICAN HONDA MOTOR CO., INC.

9. Remove the door panel (A) with as little bending as possible to avoid creasing or breaking it.
 - 1 Pull the door weatherstrip (B) out as necessary.
 - 2 Release the clips that hold the door panel with a commercially available trim pad remover (C).
 - 3 Pull out on the top of the door panel to release the hooks (D) from the rear door trim (E).
 - 4 Pull the door panel upward.

2007 Honda Element EX

2007-08 ACCESSORIES AND EQUIPMENT Doors - Element

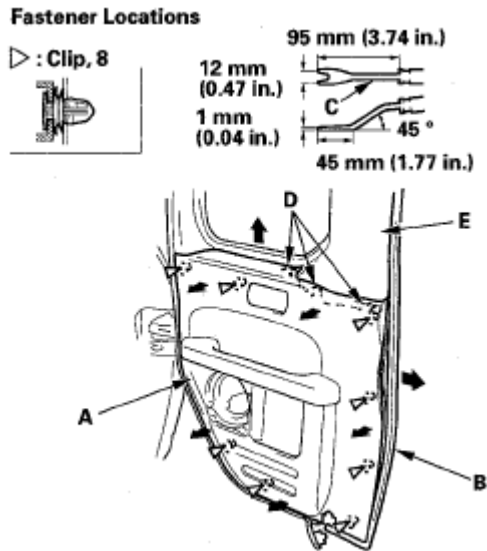

Fig. 41: Pulling Out On Top Of Door Panel With Specification
Courtesy of AMERICAN HONDA MOTOR CO., INC.

10. Install the door panel in the reverse order of removal, and note these items:
 - Make sure the inner handle cable is connected properly.
 - Check if the clips are damaged or stress-whitened, and if necessary, replace them with new ones.
 - Push the clips and hooks into place securely.
 - When reinstalling the door panel, make sure the plastic cover is installed properly and sealed around its perimeter to seal out water.
 - Check for water leaks (see step 7).

REAR DOOR TRIM REMOVAL/INSTALLATION

1. Remove the rear door trim (A).
 - 1 Pull the door weatherstrip (B) out as necessary.
 - 2 Pull out on the top of the rear door panel (C) to release the hooks (D).
 - 3 Pull out on the rear door trim to detach the clips (E, F).

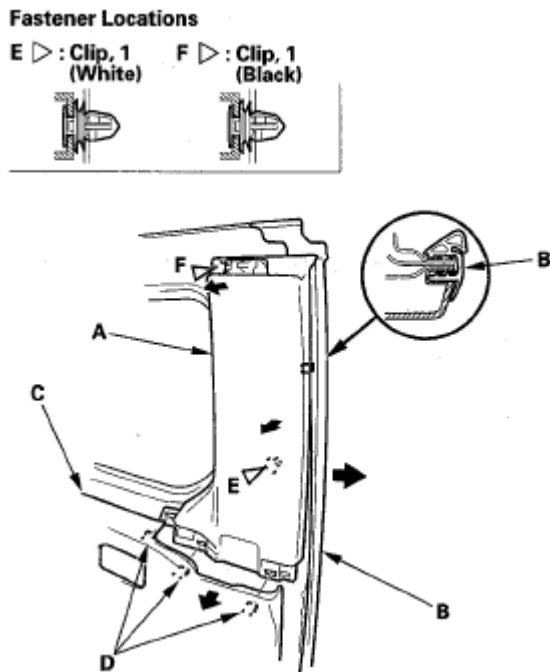

Fig. 42: Removing Rear Door Trim

Courtesy of AMERICAN HONDA MOTOR CO., INC.

2. Install the trim in the reverse order of removal, and note these items:
 - Check if the clips are damaged or stress-whitened, and if necessary, replace them with new ones.
 - Push the clips and hooks into place securely.
 - Apply liquid thread lock to the anchor bolt before reinstallation.
 - Before installing the anchor bolt, make sure there are no twists or kinks in the seat belt.

REAR DOOR HANDLE REPLACEMENT

NOTE: Put on gloves to protect your hands.

1. Remove these items:
 - Door panel (see **REAR DOOR PANEL REMOVAL/INSTALLATION**)
 - Plastic cover, as necessary (see **COMPONENT LOCATION INDEX - REAR DOOR**)
2. Disconnect the cancel rod (A) from the rear door latch synchronizer (B).

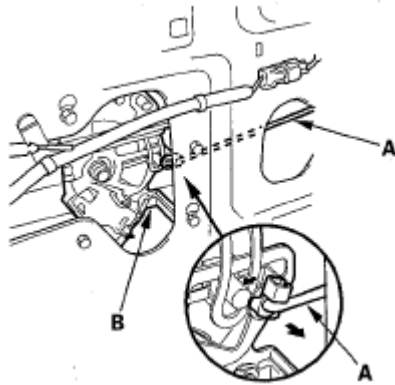

Fig. 43: Disconnecting Cancel Rod From Rear Door Latch Synchronizer
 Courtesy of AMERICAN HONDA MOTOR CO., INC.

3. Remove the screws, then pull the rear door handle (A) out. Disconnect the handle rod (B), then remove the handle.

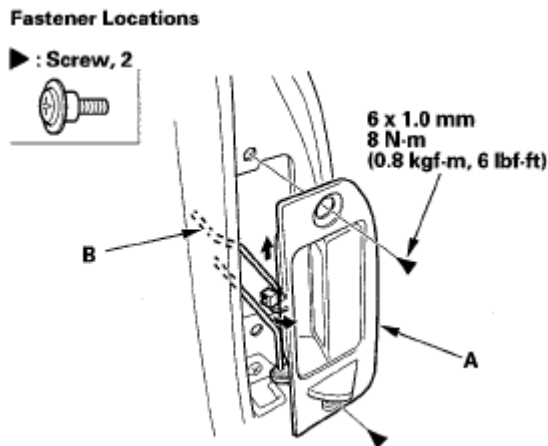

Fig. 44: Disconnecting Handle Rod With Torque Specification
 Courtesy of AMERICAN HONDA MOTOR CO., INC.

4. Install the handle in the reverse order of removal, and note these items:
 - Make sure each rod is connected securely.
 - Make sure the door locks and opens properly.
 - When reinstalling the door panel, make sure the plastic cover is installed properly and sealed around its perimeter to seal out water.
 - Check for water leaks.

REAR DOOR UPPER LATCH REPLACEMENT

NOTE: Put on gloves to protect your hands.

1. Remove these items:
 - Door panel (see **REAR DOOR PANEL REMOVAL/INSTALLATION**)
 - Plastic cover, as necessary (see **COMPONENT LOCATION INDEX - REAR DOOR**)
 - Door trim (see **REAR DOOR TRIM REMOVAL/INSTALLATION**)
2. Detach the harness clips (A). Disconnect the upper latch switch connector (B), and detach it.

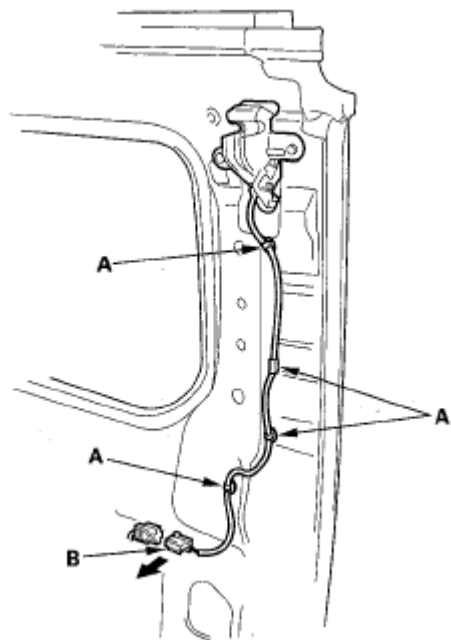

Fig. 45: Disconnecting Upper Latch Switch Connector
Courtesy of AMERICAN HONDA MOTOR CO., INC.

3. Disconnect the upper latch cable (A) in the sequence shown. Take care not to bend the cable.

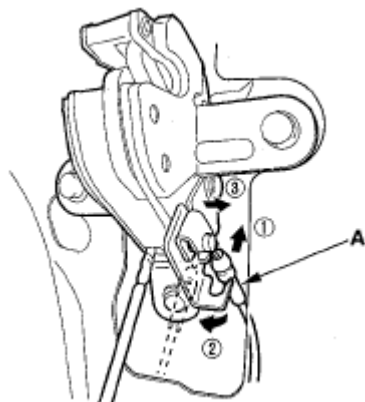

Fig. 46: Disconnecting Upper Latch Cable
Courtesy of AMERICAN HONDA MOTOR CO., INC.

4. Remove the bolts, then remove the upper latch (A).

Fastener Locations

▶ : Bolt, 3

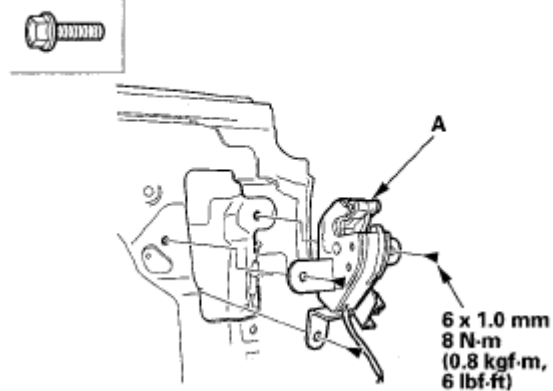

Fig. 47: Removing Upper Latch With Torque Specification
Courtesy of AMERICAN HONDA MOTOR CO., INC.

5. Install the latch in the reverse order of removal, and note these items:
 - Make sure the connector is plugged in properly, and cable is connected securely.
 - Make sure the door locks and opens properly.
 - When reinstalling the door panel, make sure the plastic cover is installed properly and sealed around its perimeter to seal out water.
 - Check for water leaks.

REAR DOOR LOWER LATCH REPLACEMENT

SRS components are located in this area. Review the SRS component locations (see COMPONENT LOCATION INDEX) and the precautions and procedures (see PRECAUTIONS AND PROCEDURES) before doing repairs or service.

NOTE: Put on gloves to protect your hands.

1. Make sure you have the anti-theft code for the audio system, then write down the audio presets.
2. Disconnect the negative cable from the battery, and wait at least 3 minutes before beginning work.
3. Remove these items:
 - Door panel (see REAR DOOR PANEL REMOVAL/INSTALLATION)
 - Plastic cover, as necessary (see COMPONENT LOCATION INDEX - REAR DOOR)
4. Detach the harness clips (A). Disconnect the lower latch switch connector (B), and detach it.

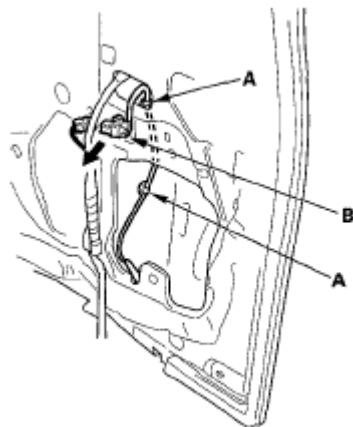

Fig. 48: Disconnecting Lower Latch Switch Connector
 Courtesy of AMERICAN HONDA MOTOR CO., INC.

5. Remove the screws from under the door.

Fastener Locations

▶ : Screw, 3

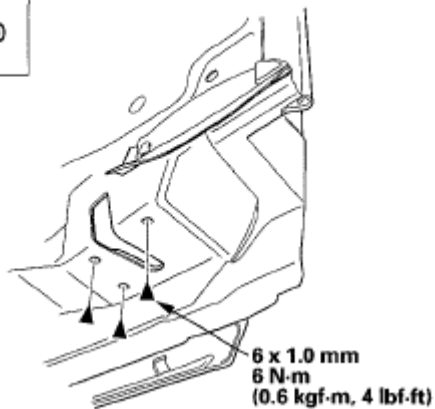

Fig. 49: Removing Screws From Under Door With Torque Specification
 Courtesy of AMERICAN HONDA MOTOR CO., INC.

6. Pull the lower latch (A) up, and disconnect the lower latch cable (B) in the sequence shown. Remove the vinyl tape (C) from the cable and wire harness. Take care not to kink the cable.

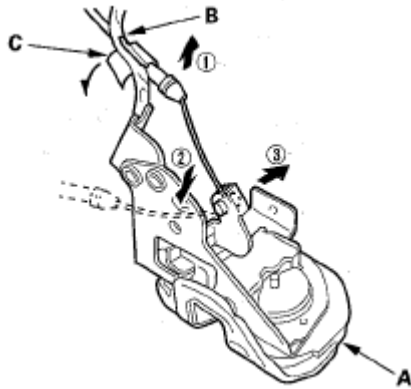

Fig. 50: Disconnecting Lower Latch Cable
 Courtesy of AMERICAN HONDA MOTOR CO., INC.

7. Remove the lower latch.
8. Install the latch in the reverse order of removal, and note these items:
 - Make sure the connector is plugged in properly, and cable is connected securely.
 - Make sure the door locks and opens properly.
 - Apply liquid thread lock to the anchor bolts before reinstallation.
 - Before installing the anchor bolts, make sure there are no twists or kinks in the seat belt.
 - When reinstalling the door panel, make sure the plastic cover is installed properly and sealed around its perimeter to seal out water.
 - Check for water leaks.
 - Reconnect the negative cable to the battery.
 - Enter the anti-theft code for the audio system, then enter the audio presets.
 - Reset the clock.
 - Do the power window control unit reset procedure (see **RESETTING THE POWER WINDOW CONTROL UNIT**).

REAR DOOR LATCH SYNCHRONIZER REPLACEMENT

NOTE: Put on gloves to protect your hands.

1. Remove these items:
 - Door panel (see **REAR DOOR PANEL REMOVAL/INSTALLATION**)
 - Plastic cover, as necessary (see **COMPONENT LOCATION INDEX - REAR DOOR**)
 - Door handle (see **REAR DOOR HANDLE REPLACEMENT**)
2. Disconnect the upper latch cable (A) and lower latch cable (B) from the latch synchronizer (C).

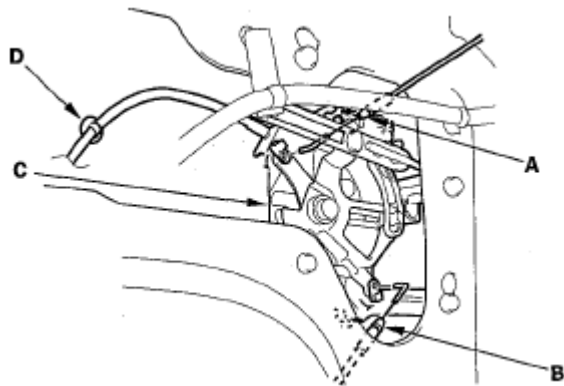

Fig. 51: Disconnecting Upper Latch Cable And Lower Latch Cable From Latch Synchronizer
 Courtesy of AMERICAN HONDA MOTOR CO., INC.

3. Detach the inner handle cable clip (D).
4. Remove the bolts (A), and loosen the bolts (B), then remove the latch synchronizer (C) through the hole in the door.

Fastener Locations

A ▶ : Bolt, 2 B ▶ : Bolt, 2

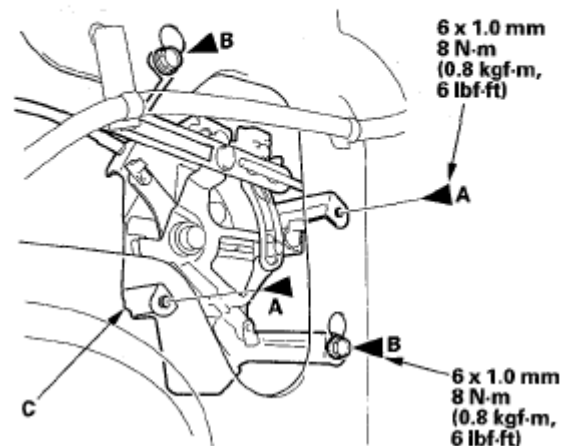

Fig. 52: Removing Latch Synchronizer Through Hole In Door With Torque Specifications
 Courtesy of AMERICAN HONDA MOTOR CO., INC.

5. Install the latch synchronizer in the reverse order of removal, and note these items:
 - Make sure each cable and rod is connected securely.
 - Make sure the door locks and opens properly. If necessary, adjust the upper latch cable and lower latch cable (see **REAR DOOR UNLOCK SYNCHRONIZATION ADJUSTMENT**).
 - When reinstalling the door panel, make sure the plastic cover is installed properly and sealed around its perimeter to seal out water.

- Check for water leaks.

REAR DOOR UNLOCK SYNCHRONIZATION ADJUSTMENT

1. Remove these items:
 - Door panel (see [REAR DOOR PANEL REMOVAL/INSTALLATION](#))
 - Plastic cover, as necessary (see [COMPONENT LOCATION INDEX - REAR DOOR](#))
2. Install the inner handle by securing the screws.
3. Close the door securely.
4. Pull the inner handle (A), and measure the inner handle stroke (B) when unlocking the door.

Inner handle stroke: 36 mm (1.42 in.)

- If the inner handle stroke is less than the specification, loosen the bolts (C) slightly, and move the plates (D) in the direction shown by the minus arrow.
- If the inner handle stroke is more than the specification, loosen the bolts slightly, and move the plates in the direction shown by the plus arrow.

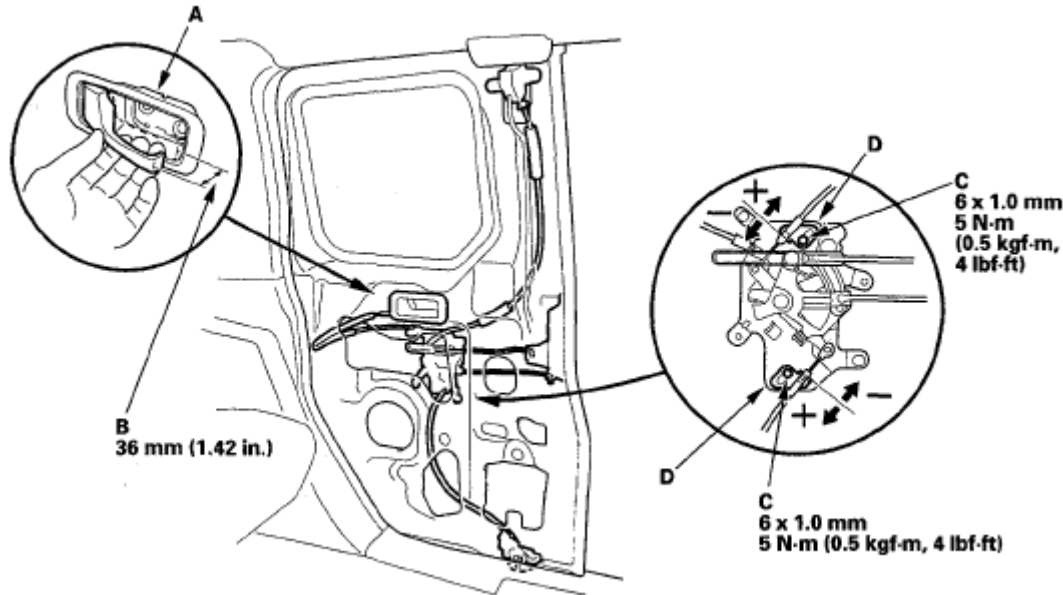

Fig. 53: Pulling Inner Handle With Torque Specifications
 Courtesy of AMERICAN HONDA MOTOR CO., INC.

5. Tighten the bolts, and recheck the inner handle stroke.
6. Remove the inner handle, and attach the plastic cover making sure it is sealed around its outside perimeter to seal out water, then install the door panel.

REAR DOOR GLASS REPLACEMENT

NOTE: Put on gloves to protect your hands.

1. Remove the door trim (see **REAR DOOR TRIM REMOVAL/INSTALLATION**).
2. Pull out on the glass lock cover (A) to release the hooks (B) from the lock cover base (C), then remove the cover.

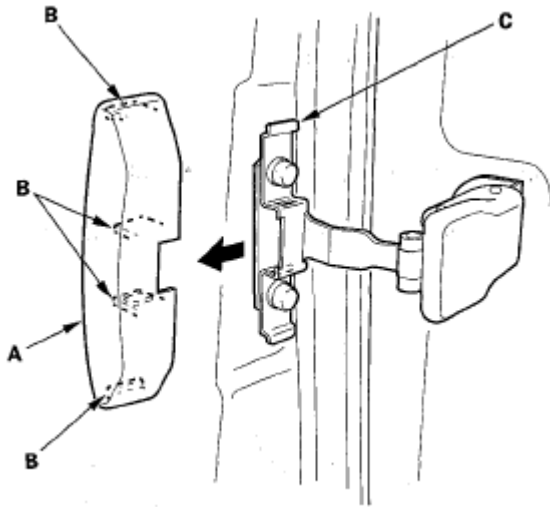

Fig. 54: Releasing Hooks From Lock Cover Base
 Courtesy of AMERICAN HONDA MOTOR CO., INC.

3. Remove the bolts, then remove the glass lock (A) from the door.

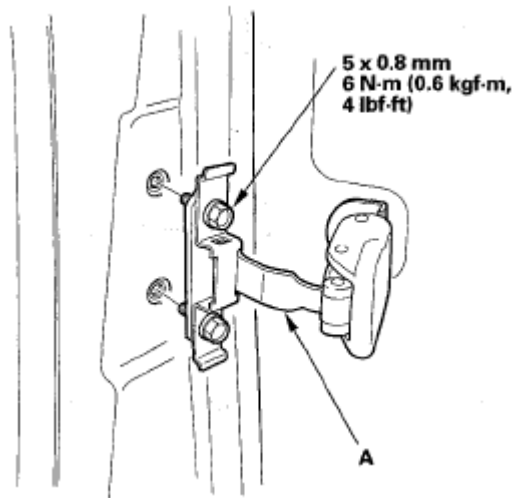

Fig. 55: Removing Glass Lock From Door With Torque Specification
 Courtesy of AMERICAN HONDA MOTOR CO., INC.

4. While holding the glass (A), remove the nuts, then remove the glass.

Fastener Locations

● : Nut, 4

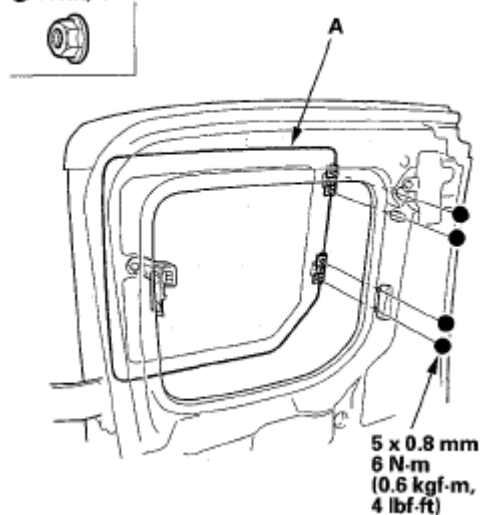

Fig. 56: Identifying Glass With Torque Specification
 Courtesy of AMERICAN HONDA MOTOR CO., INC.

5. If necessary, release the E clip (A), and remove the glass lock (B), lock pin (C) and rubber seal (D) from the glass. Remove the lock cover base (E) by removing the lock washers (F).

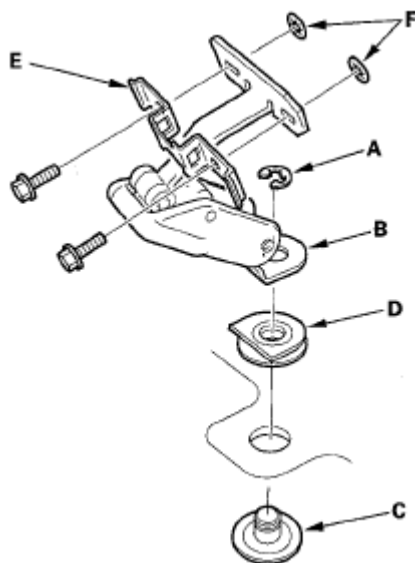

Fig. 57: Removing Glass Lock, Lock Pin And Rubber Seal From Glass
 Courtesy of AMERICAN HONDA MOTOR CO., INC.

6. If necessary, release the E clip (A), and remove the washer (B), hinge (C), lock pin (D) and rubber seal (E) from the glass.

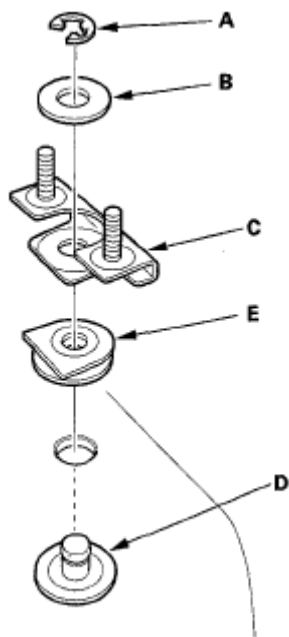

Fig. 58: Removing Washer, Hinge, Lock Pin And Rubber Seal From Glass
Courtesy of AMERICAN HONDA MOTOR CO., INC.

7. Install the glass in the reverse order of removal, and note these items:
 - The glass and rear door edges should be parallel.
 - Make sure the glass locks properly.
 - Check that the glass contacts the glass seal evenly.
 - Check for water leaks (see step 7).
 - Test-drive and check for wind noise.

REAR DOOR GLASS SEAL REPLACEMENT

1. Remove the bolts securing the glass lock (see step 3).
2. Remove the glass seal (A) by pulling out on it.

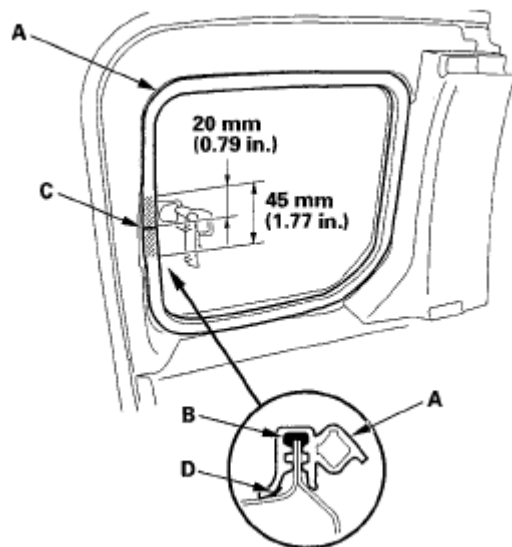

Fig. 59: Identifying Glass Seal

Courtesy of AMERICAN HONDA MOTOR CO., INC.

3. Apply clear sealant (B) into the channel of the joint (C).

Sealant: Cemedine P/IM 08712-0004, or equivalent

4. Locate the painted alignment mark (D) on the joint. Align the painted mark with the center of the glass opening, and install the glass seal all the way around.
5. Check for water leaks.
6. Test-drive and check for wind noise.

REAR DOOR WEATHERSTRIP REPLACEMENT

NOTE:

- Take care not to scratch the door.
- Use a clip remover to remove the clips.

1. Detach the clips (A, B), release the double-sided adhesive tape (C), then remove the door weatherstrip (D).

Fastener Locations

A▷: Clip, 6 B▷: Clip, 11

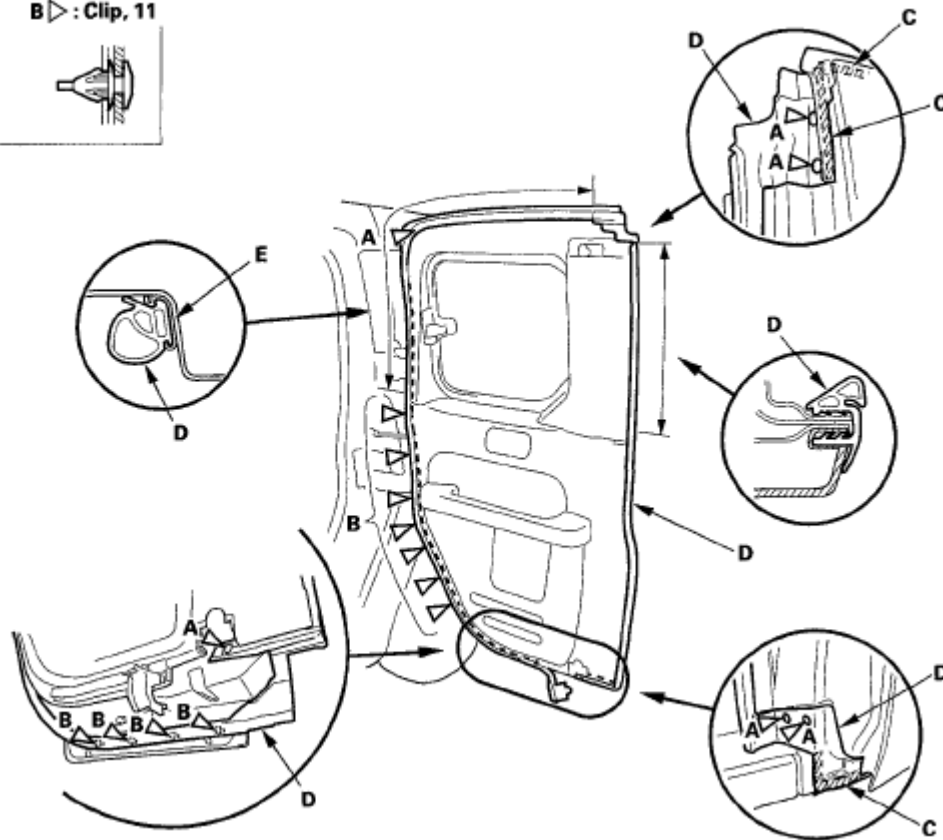
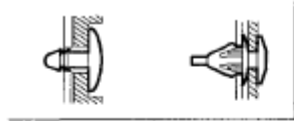

Fig. 60: Removing Door Weatherstrip
 Courtesy of AMERICAN HONDA MOTOR CO., INC.

2. Install the weatherstrip in the reverse order of removal, and note these items:
 - Check if the clips are damaged or stress-whitened, and if necessary, replace them with new ones.
 - Scrape off the remaining double-sided adhesive tape from the weatherstrip and rear door, and clean the weatherstrip and rear door with alcohol. Attach new double-sided adhesive tape (3M 4213, or equivalent) to the weatherstrip.
 - Make sure the weatherstrip is installed in the holder (E) securely.
 - Check for water leaks.
 - Test-drive and check for wind noise.

REAR DOOR POSITION ADJUSTMENT

SRS components are located in the lower B-pillar area. Review the SRS component locations (see **COMPONENT LOCATION INDEX**) and the precautions and procedures (see **PRECAUTIONS AND PROCEDURES**) before doing repairs or service.

NOTE: **Check for a flush fit with the body, then check for equal gaps between the front,**

rear, and bottom door edges and the body. Check that the door and body edges are parallel.

1. Place the vehicle on a firm, level surface when adjusting the doors.
2. Adjust at the hinges (A):
 - Pad a floor jack (B) with shop towels (C), then use the jack to support the door to prevent damage to the door while adjusting it.
 - Loosen the door mounting bolts (D) slightly, and move the door in or out until it's flush with the body.
 - Remove these items:
 - C-pillar outer trim (see **C-PILLAR OUTER TRIM REPLACEMENT**)
 - Rear cladding (see **REAR QUARTER PANEL CLADDING REPLACEMENT**)
 - Upper quarter window trim (see **TRIM REMOVAL/INSTALLATION - REAR SIDE PILLAR AREA**)
 - Loosen the hinge mounting bolts (E) and nut (F) slightly, and move the door backward or forward, up or down as necessary to equalize the gaps.

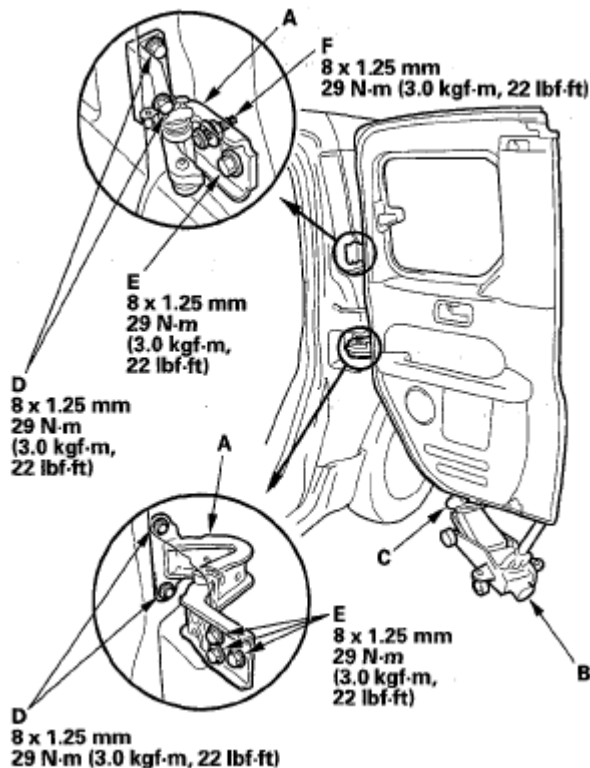

Fig. 61: Identifying Rear Door Position Adjustment With Torque Specifications
 Courtesy of AMERICAN HONDA MOTOR CO., INC.

3. Close the rear door, and check that it latches securely without slamming it, and the rear door and body edges are parallel. If necessary, adjust the upper and lower striker at the same time (see **REAR DOOR**

STRIKER ADJUSTMENT).

Fig. 62: Identifying Upper And Lower Striker
 Courtesy of AMERICAN HONDA MOTOR CO., INC.

4. Close the front door, and make sure it latches securely without slamming it, and the front door, rear door, and body edges are parallel.
5. After adjusting the upper and lower strikers (see **REAR DOOR STRIKER ADJUSTMENT**), check the rear door unlock synchronization. If necessary, adjust the upper and lower latch cables (see **REAR DOOR UNLOCK SYNCHRONIZATION ADJUSTMENT**).
6. Apply touch-up paint to the hinge mounting bolts, and around the hinges.
7. Check for water leaks (see step 7).
8. Test-drive and check for wind noise.

REAR DOOR STRIKER ADJUSTMENT

Make sure the door latches securely without slamming it. If necessary, adjust the upper and lower strikers at the same time.

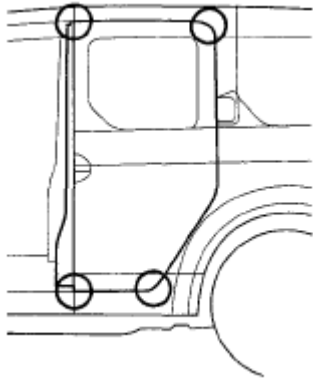
1. Remove these items:
 - Upper striker cover (see step 2 in **HEADLINER REMOVAL/INSTALLATION**)
 - Door sill trim (see **TRIM REMOVAL/INSTALLATION - DOOR AREAS**)
2. Adjust the upper striker (A) and lower striker (B):
 - Loosen the upper striker mounting bolts (C) slightly, and move the striker in or out until the upper edge of the door is flush with the body. Install and/or remove shims (D) until the striker is centered in the upper latch.
 - Loosen the lower striker mounting screws (E) slightly, and move the striker in or out until the bottom edge of the door is flush with the body. Move the striker forward or rearward until the striker is centered in the lower latch.

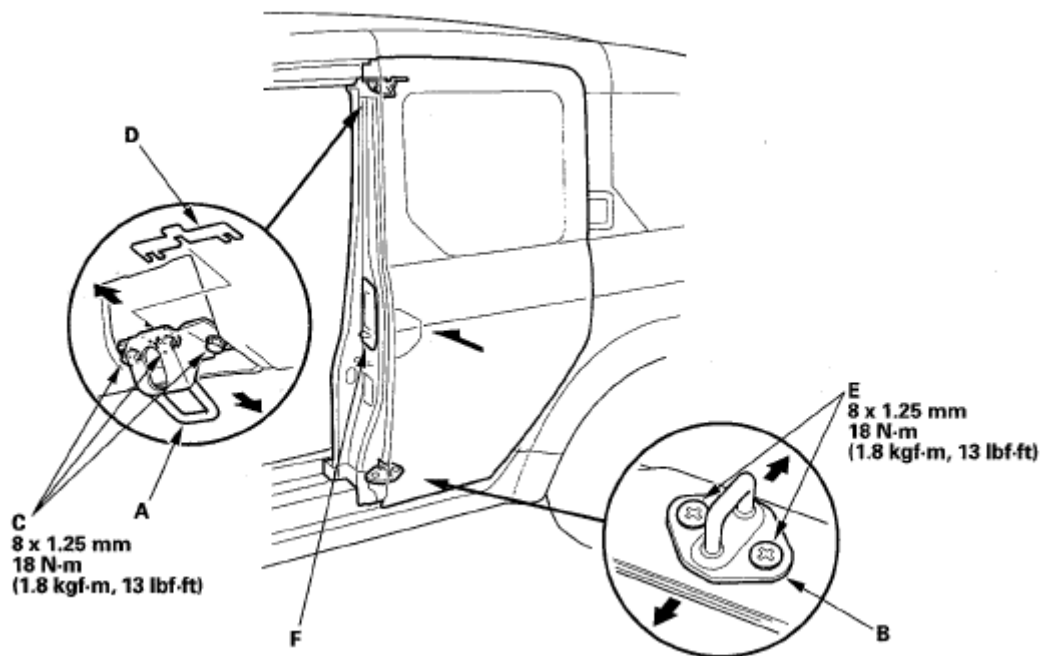

Fig. 63: Identifying Rear Door Striker Adjustment With Torque Specifications
Courtesy of AMERICAN HONDA MOTOR CO., INC.

3. Lightly tighten the bolts and screws.
4. Hold the door handle (Flout, and push the door against the body to be sure the strikers allow a flush fit. If the door latches properly, tighten the bolts and screws and recheck.
5. Check the door unlock synchronization. If necessary, adjust the upper and lower latch cables (see **REAR DOOR UNLOCK SYNCHRONIZATION ADJUSTMENT**).