

2007-08 ACCESSORIES AND EQUIPMENT

Interior Trim - Element

COMPONENT LOCATION INDEX

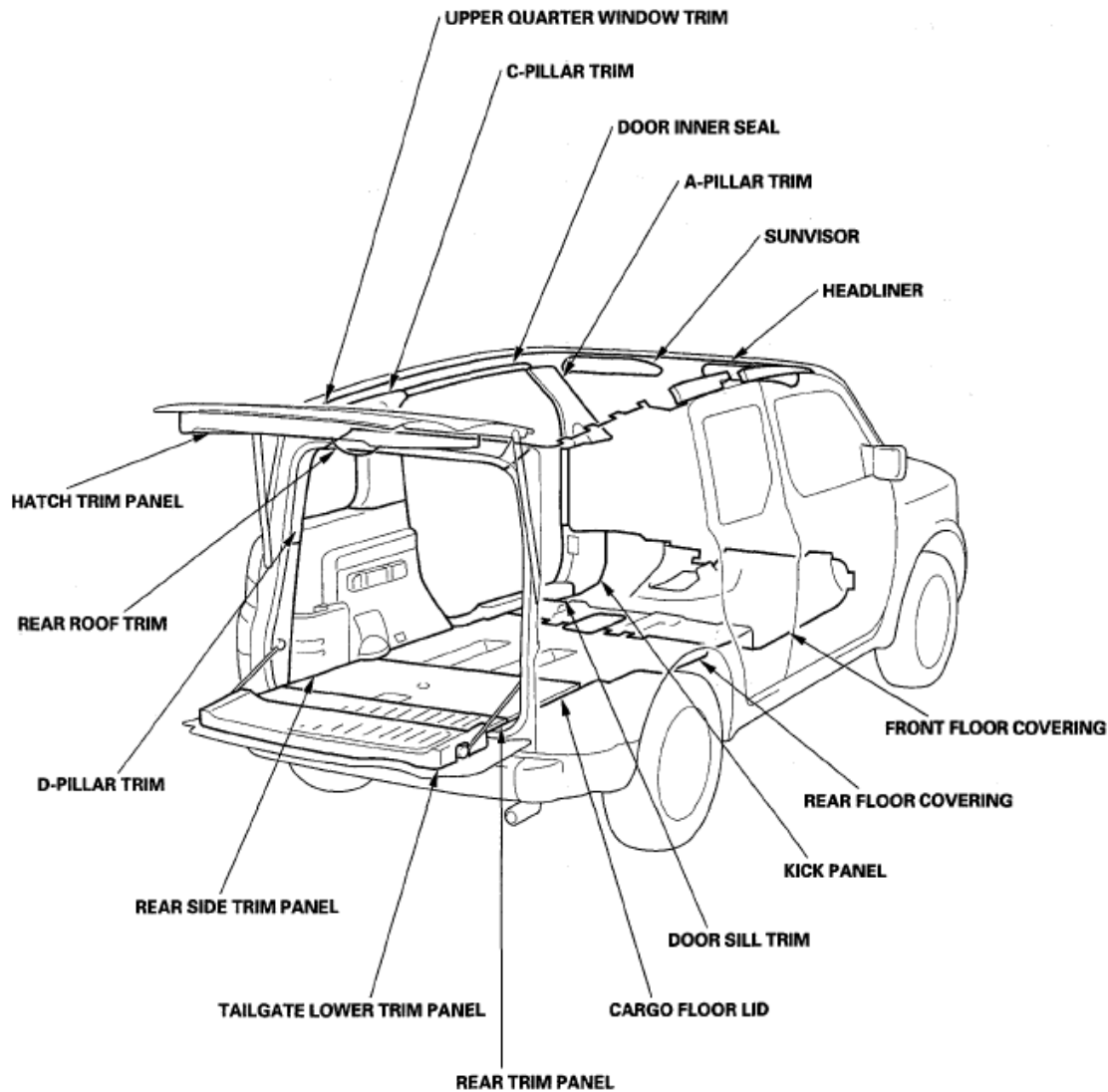

Fig. 1: Identifying Interior Trim Components
Courtesy of AMERICAN HONDA MOTOR CO., INC.

TRIM REMOVAL/INSTALLATION - DOOR AREAS

Special Tools Required

KTC trim tool set SOJATP2014 *

* Available through the American Honda Tool and Equipment Program; call 888-424-6857

SRS components are located in this area. Review the SRS component locations (see **COMPONENT LOCATION INDEX**) and the precautions and procedures (see **PRECAUTIONS AND PROCEDURES**) before doing repairs or service.

FRONT DOOR SILL AREA

NOTE:

- Put on gloves to protect your hands.
- Use the appropriate tool from the KTC trim tool set to avoid damage when prying components.
- Take care not to bend or scratch the trim and panels.

1. Remove the front seat track floor cover.

- Slide the front seat forward fully.
- Pull the front seat track floor cover (A) up by hand to detach the clips (B, C) and release the hooks (D) from the carpet, then remove the cover.

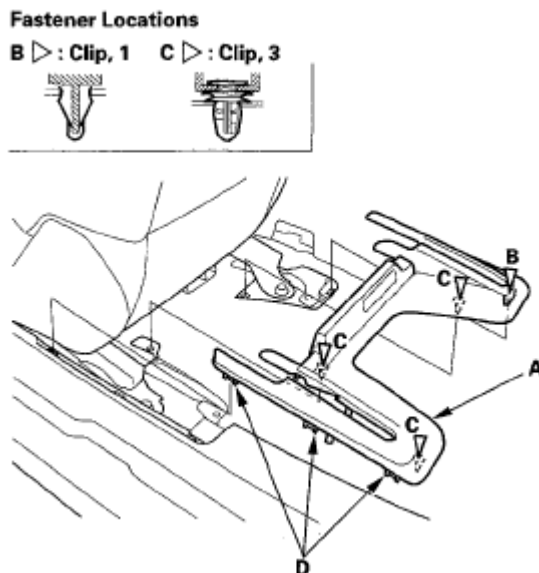

Fig. 2: Identifying Front Seat Track Floor Cover And Clips
Courtesy of AMERICAN HONDA MOTOR CO., INC.

2. Pull the front door sill trim (A) up by hand to detach the clips (B, C), then remove the trim.

Fastener Locations

B ▷ : Clip, 7 (White) C ▷ : Clip, 2 (Orange)

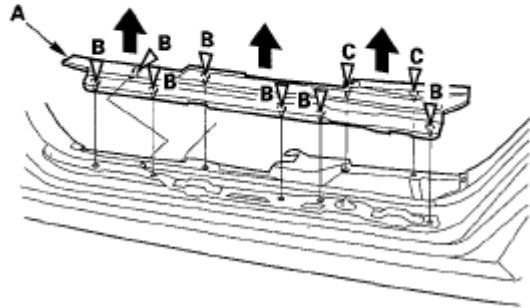

Fig. 3: Identifying Front Door Sill Trim Clips
 Courtesy of AMERICAN HONDA MOTOR CO., INC.

3. Remove the left kick panel (A) or the right kick panel (B).
 - 1 Pull out the front door inner seal (C) from the kick panel hooks (D) and the front door opening flange.
 - 2 Pull the kick panel back by hand to detach the clips (E, F), then remove the panel. On the driver's side, pull the hood opener knob (G) and hold it while removing the panel.

Driver's side

Fastener Locations

E ▷ : Clip, 1 (White) F ▷ : Clip, 1 (Black)

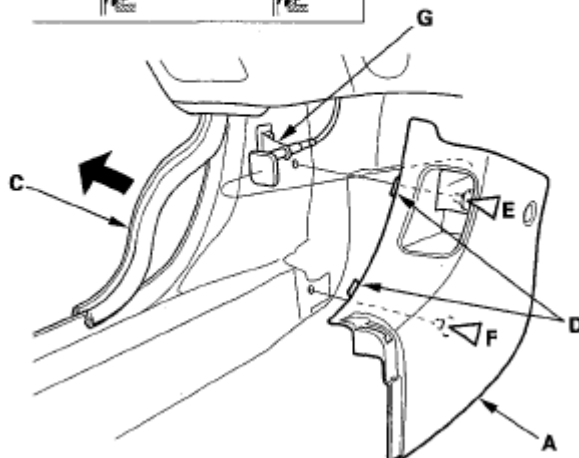
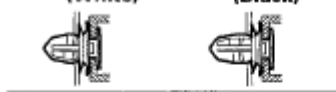

Fig. 4: Identifying Kick Panel Clips (Driver's Side)
 Courtesy of AMERICAN HONDA MOTOR CO., INC.

Passenger's side

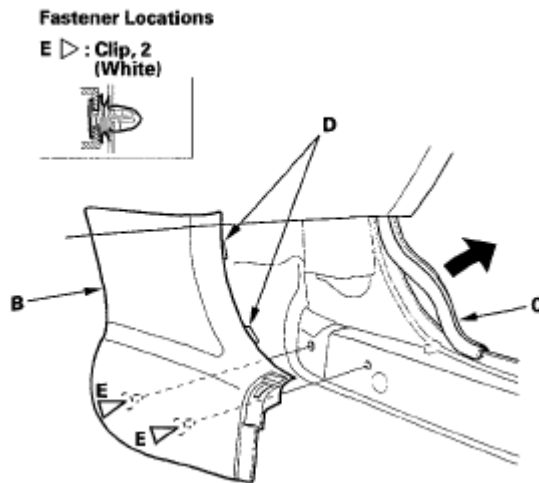

Fig. 5: Identifying Kick Panel Clips (Passenger's Side)
 Courtesy of AMERICAN HONDA MOTOR CO., INC.

4. Pull out the front door inner seal (A) from the trim hooks (B) and around the front door opening flange, then remove the seal.

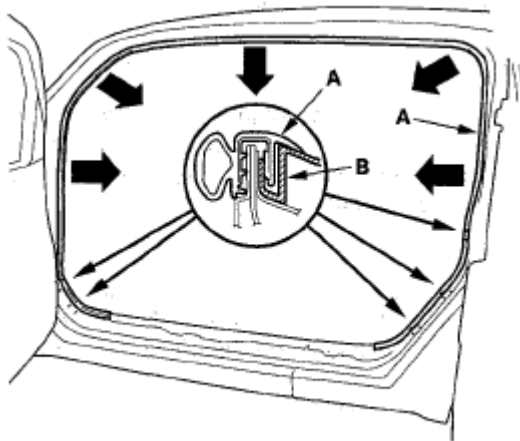

Fig. 6: Identifying Front Door Inner Seal From Trim Hooks
 Courtesy of AMERICAN HONDA MOTOR CO., INC.

5. Install the trim in the reverse order of removal, and note these items:
 - Check if the clips are damaged or stress-whitened, and if necessary, replace them with new ones.
 - Push the clips into place securely.

Special Tools Required

KTC trim tool set SOJATP2014 *

* Available through the American Honda Tool and Equipment Program; call 888-424-6857

A-PILLAR TRIM

SRS components are located in this area. Review the SRS component locations (see COMPONENT LOCATION INDEX) and the precautions and procedures (see PRECAUTIONS AND PROCEDURES) before doing repairs or service.

NOTE:

- Follow the A-pillar trim installation procedure carefully; improper installation could cause the side curtain airbag to deploy improperly and possibly cause injury.
- Put on gloves to protect your hands.
- Use the appropriate tool from the KTC trim tool set to avoid damage when prying components.
- Take care not to scratch the trim and panels.
- The upper clip in the A-pillar trim (A) consists of a grommet (B) and a pin (C). The grommet expands when the pin secures it to the body panel (D). The projections (E) on the pin are broken during removal, so the clip must be replaced with a new one when the trim is reinstalled.

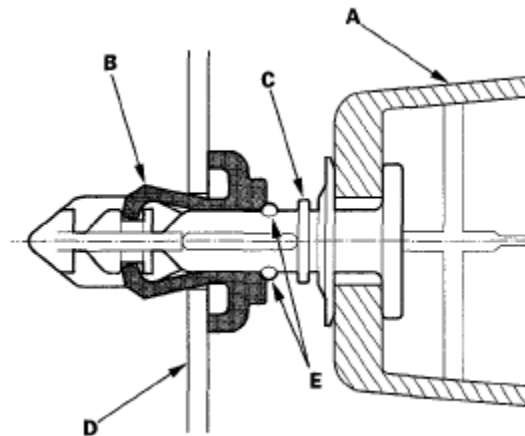

Fig. 7: Identifying A-Pillar Trim And Grommet
Courtesy of AMERICAN HONDA MOTOR CO., INC.

1. Pull the front door inner seal away from the front pillar as needed (see step 3 on Front Door Sill Area).
2. Hit the upper clip in the front pillar trim (A) with a rubber mallet. The clip is under the point (B) on the edge of the trim indicates. Hitting the clip breaks the projections (C) on the pin (D) and pushes it into the grommet (E) and against the body (F). The grommet becomes narrow.

NOTE: The clip must be replaced with a new one when the front pillar trim is reinstalled.

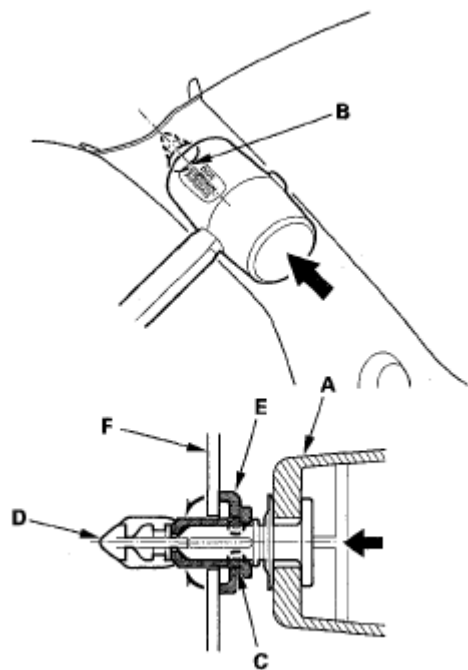

Fig. 8: Hitting Upper Clip In Front Pillar Trim With Rubber Mallet
 Courtesy of AMERICAN HONDA MOTOR CO., INC.

3. Pull the top of the A-pillar trim (A) back by hand to remove the upper clip (B) from the body (C).

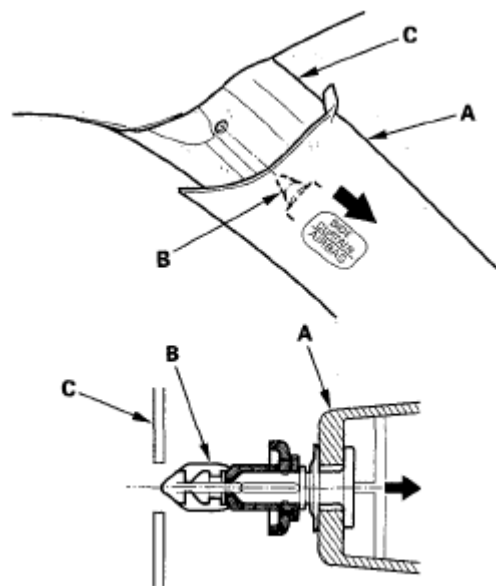
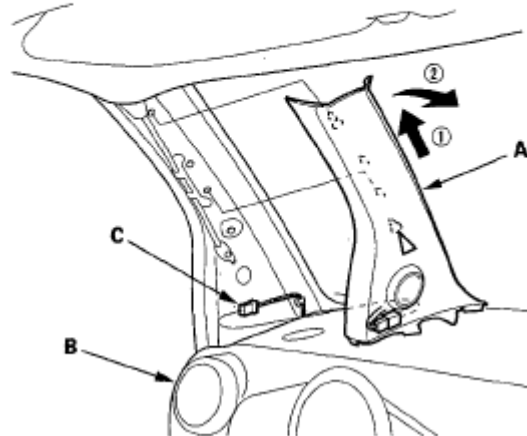

Fig. 9: Identifying Upper Clip From Body
 Courtesy of AMERICAN HONDA MOTOR CO., INC.

4. Pull the A-pillar trim (A) by hand to detach the clip. Pull the trim up from the dashboard (B), then disconnect the tweeter connector (C) (if equipped) and remove the trim.

Fastener Location▷ : Clip, 1
(White)**Fig. 10: Identifying Trim Up From Dashboard**

Courtesy of AMERICAN HONDA MOTOR CO., INC.

5. If the side curtain airbag has deployed, replace the A-pillar trim and all clips on the trim with new ones.
6. If the side curtain airbag has not deployed, remove the upper clip (A) from the removed A-pillar trim (B) and discard it. Then check the trim:
 - To prevent the side curtain airbags from deploying improperly and possibly causing injury, inspect the A-pillar trim and replace it if it has any of these types of damage:
 - Any cracks, deformations, or stress-whitened areas in the A-pillar trim
 - Any cracks or stress-whitening in the clip seating surfaces (C, D)
 - Check if the clip (E) is damaged or stress-whitened, and if necessary, replace it with a new one.
 - Replace the upper clip with a new one.

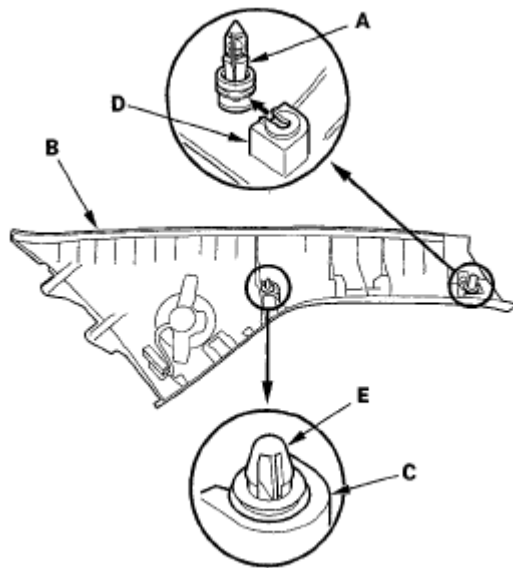

Fig. 11: Identifying Clip Seating Surfaces
 Courtesy of AMERICAN HONDA MOTOR CO., INC.

7. Before installing the A-pillar trim (A), whether it is being replaced or reinstalled, temporarily remove the new upper clip (B).

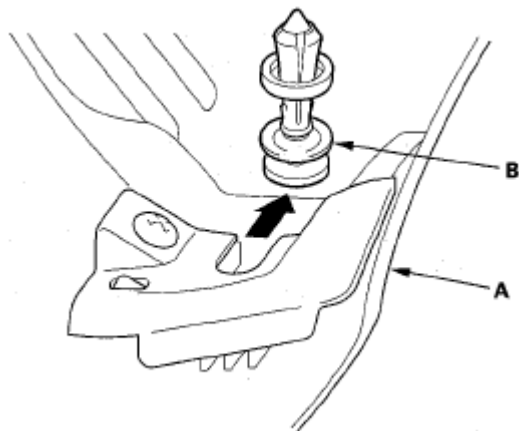

Fig. 12: Identifying Upper Clip
 Courtesy of AMERICAN HONDA MOTOR CO., INC.

8. Carefully install a new upper clip (A) to the A-pillar trim (B). Be sure that the grommet (C) is nearest to the top of the pin (D) as shown.

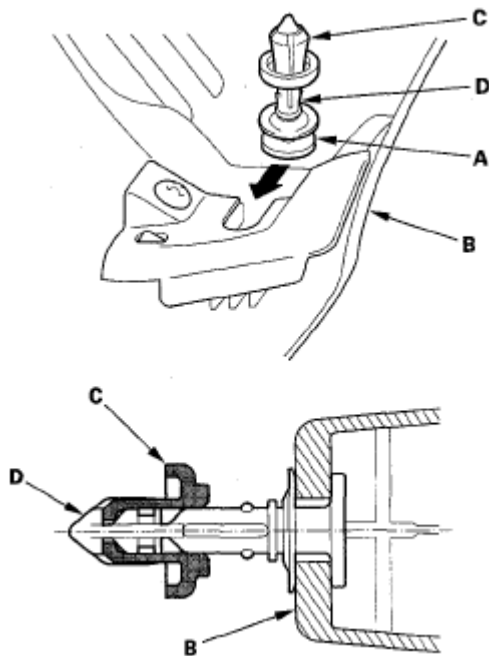

Fig. 13: Installing Upper Clip To A-Pillar Trim

Courtesy of AMERICAN HONDA MOTOR CO., INC.

9. Reinstall the A-pillar trim (A).

- 1 Connect the tweeter connector (for some models).
- 2 Insert the bottom of the trim into the dashboard (B).
- 3 Place the trim over the A-pillar (C), and fit its upper clip (D), and lower clip into the holes (E) in the A-pillar, then lightly push the trim into place.

NOTE:

- Make sure the side curtain airbag isn't tucked down under the clips and ribs.
- Push lightly on the upper clip. If you push too hard, the clip will be damaged, and it will not hold the trim properly.

2007 Honda Element EX

2007-08 ACCESSORIES AND EQUIPMENT Interior Trim - Element

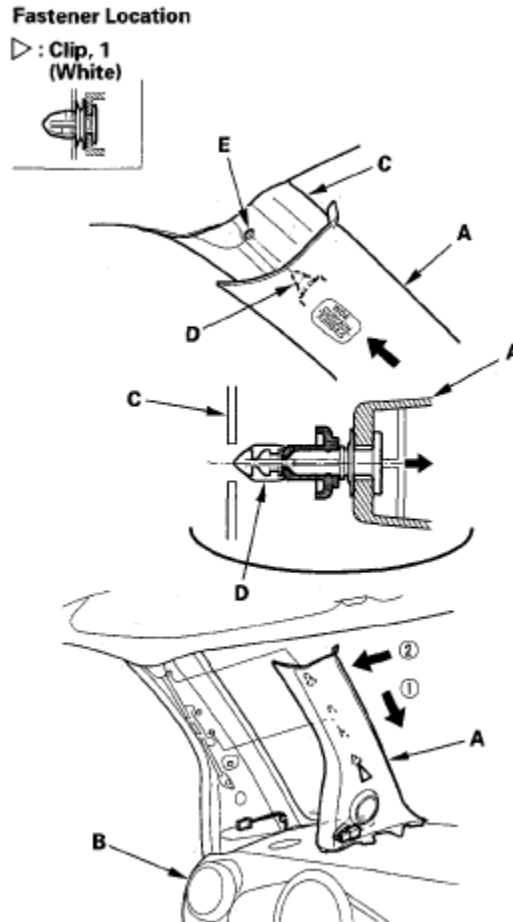

Fig. 14: Identifying A-Pillar Trim
Courtesy of AMERICAN HONDA MOTOR CO., INC.

10. Reinstall the door inner seal.

TRIM REMOVAL/INSTALLATION - CARGO AREA

Special Tools Required

KTC trim tool set SOJATP2014 *

* Available through the American Honda Tool and Equipment Program; call 888-424-6857

NOTE:

- Put on gloves to protect your hands.
- Use the appropriate tool from the KTC trim tool set to avoid damage when prying components.
- Take care not to bend or scratch the trim and panels.

2007 Honda Element EX

2007-08 ACCESSORIES AND EQUIPMENT Interior Trim - Element

1. Remove the cargo area trim as shown. To remove the rear trim panel, lift up on the hinged section and hold it, then remove the screws and release the clips.
2. Install the trim in the reverse order of removal, and note these items:
 - Check if the clips are damaged or stress-whitened, and if necessary, replace them with new ones.
 - Push the clips into place securely.

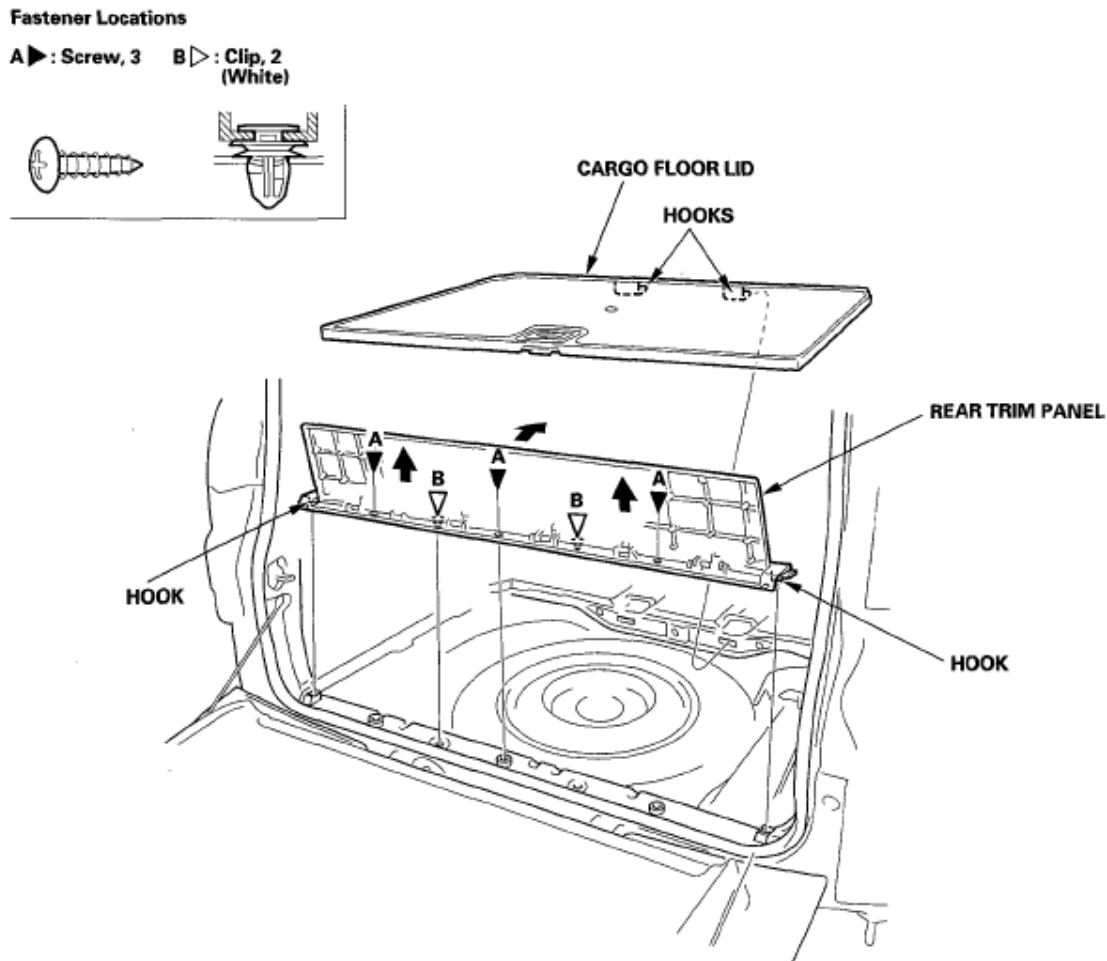

Fig. 15: Identifying Trim Removal/Installation - Cargo Area
Courtesy of AMERICAN HONDA MOTOR CO., INC.

TRIM REMOVAL/INSTALLATION - REAR SIDE AREA

Special Tools Required

KTC trim tool set SOJATP2014 *

* Available through the American Honda Tool and Equipment Program; call 888-424-6857

REAR SIDE TRIM PANEL

NOTE:

- Put on gloves to protect your hands.
- Use the appropriate tool from the KTC trim tool set to avoid damage when prying components.
- Take care not to bend or scratch the trim and panels.

1. Remove these items:

- Door sill trim (see TRIM REMOVAL/INSTALLATION - DOOR AREAS)
- Rear seat (see REAR SEAT DISASSEMBLY/REASSEMBLY)
- Hatch weatherstrip, as needed (see HATCH WEATHERSTRIP REPLACEMENT)
- Cargo area floor (see TRIM REMOVAL/INSTALLATION - CARGO AREA)

2. Remove the lower anchor bolt (A) and tie down hooks (B).

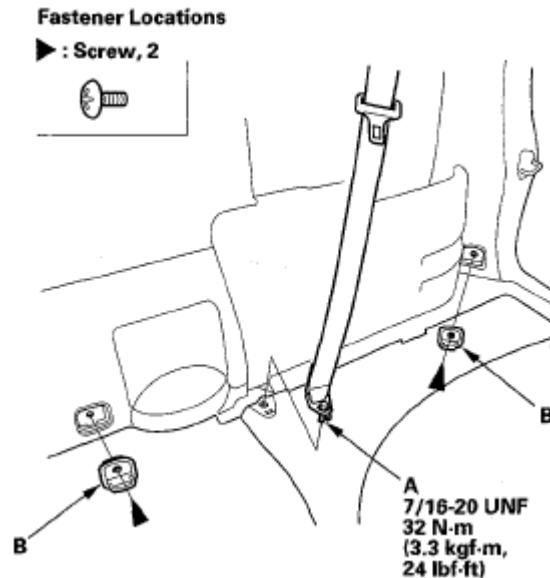

Fig. 16: Identifying Lower Anchor Bolt And Tie Down Hooks With Torque Specification
Courtesy of AMERICAN HONDA MOTOR CO., INC.

3. Remove the rear side trim panel (A).

- 1 Remove the screws (B, C) and release the clips (D).
- 2 Remove the seat belt lid (E) from the rear side trim panel.
- 3 Pull the upper edge of the panel back to release the upper hooks (F) from the quarter pillar trim (G).
- 4 Detach the clips (H, I) and pull the panel back to remove it.
- 5 Passenger's side: Disconnect the accessory power socket connector (J).

2007 Honda Element EX

2007-08 ACCESSORIES AND EQUIPMENT Interior Trim - Element

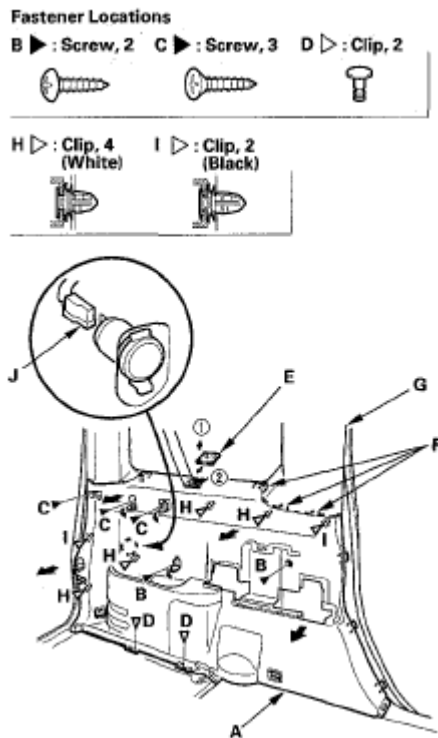

Fig. 17: Identifying Rear Side Trim Panel
Courtesy of AMERICAN HONDA MOTOR CO., INC.

4. Install the panel in the reverse order of removal, and note these items:
 - Check if the clips are damaged or stress-whitened, and if necessary, replace them with new ones.
 - When installing the panel, make sure there are no pinches in the seat belt.
 - Push the clips into place securely.
 - Before installing the anchor bolt, make sure there are no twists or kinks in the seat belt.
 - Make sure the each connector is plugged in properly.

TRIM REMOVAL/INSTALLATION - REAR SIDE PILLAR AREA

Special Tools Required

KTC trim tool set SOJATP2014 *

* Available through the American Honda Tool and Equipment Program; call 888-424-6857

C-PILLAR TRIM/UPPER QUARTER WINDOW TRIM

SRS components are located in this area. Review the SRS component locations (see **COMPONENT LOCATION INDEX**) and the precautions and procedures (see **PRECAUTIONS AND PROCEDURES**) before doing repairs or service.

NOTE:

- Put on gloves to protect your hands.
- Take care not to bend or scratch the trim and panels.
- Use the appropriate tool from the KTC trim tool set to avoid damage when prying components.

1. Fold the rear seat forward.
2. Remove the rear seat belt lower anchor bolt (see step 2 on REAR SEAT BELT REPLACEMENT).
3. Remove the rear seat belt upper anchor bolt (see step 6 on REAR SEAT BELT REPLACEMENT).
4. Remove these items:
 - Door sill trim (see TRIM REMOVAL/INSTALLATION - DOOR AREAS)
 - Rear seat
 - Door inner seal, as needed (see step 3 on Front Door Sill Area)
 - Hatch weatherstrip, as needed (see HATCH WEATHERSTRIP REPLACEMENT)
 - Cargo area floor (see TRIM REMOVAL/INSTALLATION - CARGO AREA)
 - Rear side trim panel (see TRIM REMOVAL/INSTALLATION - REAR SIDE AREA)
5. Remove the C-pillar trim (A).
 1. Detach the clips (B, C) by pulling the trim back.
 2. Lower the trim to release the upper hooks (D) from the C-Pillar (E)

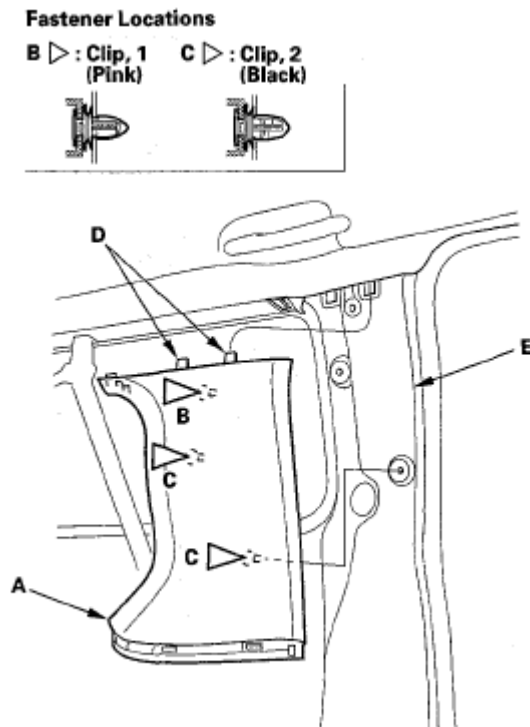

Fig. 18: Identifying C-Pillar Trim Clips
 Courtesy of AMERICAN HONDA MOTOR CO., INC.

6. Detach the clips by pulling the trim back, then remove the upper quarter window trim (A).

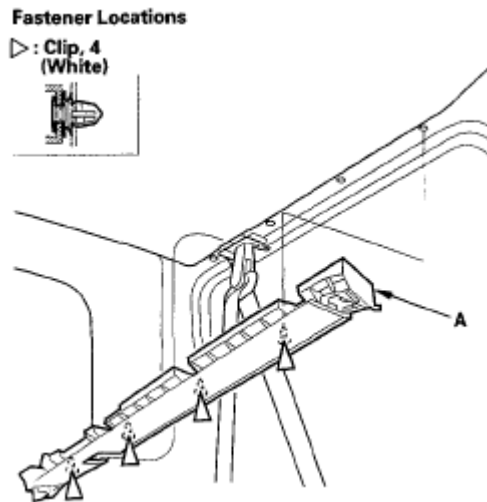

Fig. 19: Identifying Upper Quarter Window Trim Clips
Courtesy of AMERICAN HONDA MOTOR CO., INC.

7. Install the trim in the reverse order of removal, and note these items:
- Check if the clips (A) are damaged or stress-whitened, and if necessary, replace them with new ones.
 - If the side curtain airbag has deployed, replace the C-pillar trim and all clips on the trim with new ones (see **SIDE CURTAIN AIRBAG REPLACEMENT**).
 - To prevent the side curtain airbags from deploying improperly and possibly causing injury, inspect the trim and replace it if it has any of these types of damage:
 - Any cracks or deformations in the upper quarter window trim (B), the C-pillar trim (C) and the upper hooks (D), and any stress-whitened areas in the upper part of the trim
 - Any cracks or stress-whitened areas in the clips seating surfaces (E)
 - Replace any damaged parts with new ones.
 - Make sure the hooks on the C-pillar trim are installed in the side curtain airbag bracket properly.
 - Make sure the trim hook is installed into the side curtain airbag the quarter pillar bracket securely.
 - Push the clips and hooks into place securely.
 - Before installing the anchor bolts, make sure there are no twists or kinks in the seat belt.

Upper quarter window trim

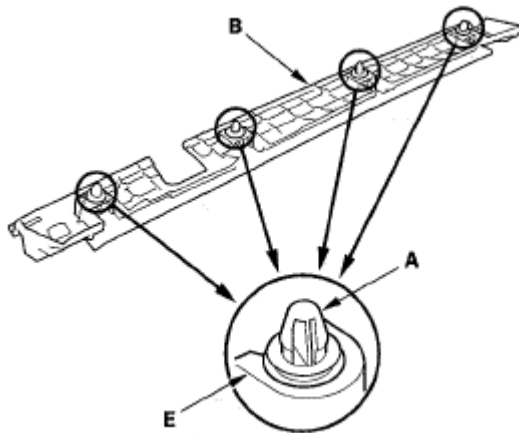

Fig. 20: Identifying Upper Quarter Window Trim
Courtesy of AMERICAN HONDA MOTOR CO., INC.

C-pillar trim

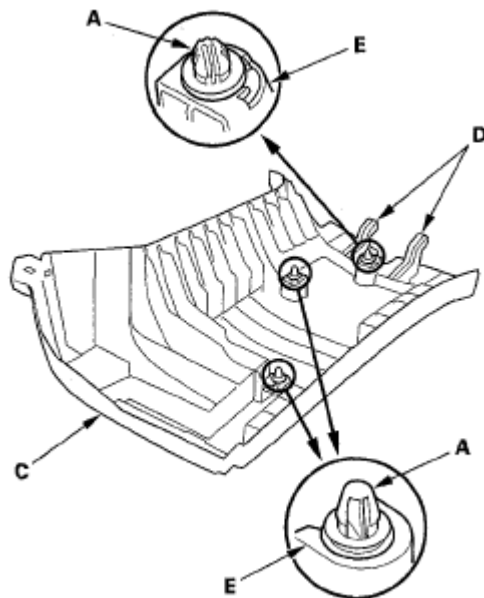

Fig. 21: Identifying C-Pillar Trim
Courtesy of AMERICAN HONDA MOTOR CO., INC.

Special Tools Required

KTC trim tool set SOJATP2014 *

* Available through the American Honda Tool and Equipment Program; call 888-424-6857

D-PILLAR TRIM/REAR ROOF TRIM

NOTE:

- Put on gloves to protect your hands.
- Take care not to bend or scratch the trim and panels.
- Use the appropriate tool from the KTC trim tool set to avoid damage when prying components.

1. Remove these items:

- Door sill trim (see TRIM REMOVAL/INSTALLATION - DOOR AREAS)
- Rear seat
- Door inner seal, as needed (see step 3 on Front Door Sill Area)
- Hatch weatherstrip, as needed (see HATCH WEATHERSTRIP REPLACEMENT)
- Cargo area floor (see TRIM REMOVAL/INSTALLATION - CARGO AREA)
- Rear side trim panel (see TRIM REMOVAL/INSTALLATION - REAR SIDE AREA)

2. Remove the rear roof trim (A).

1. Detach the clips and release the hooks (B).
2. Disconnect the ceiling light connector (C).

Fastener Locations▷ : Clip, 4
(White)

Fig. 22: Identifying Ceiling Light Connector
 Courtesy of AMERICAN HONDA MOTOR CO., INC.

3. Remove the D-pillar trim panel (A).

1. Pry off the lid (B), then remove the screw (C).
2. Detach the clips (D).

2007 Honda Element EX

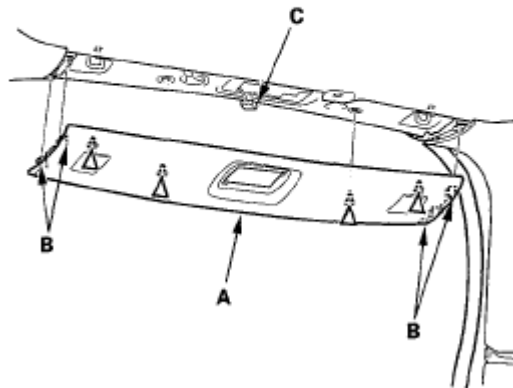
2007-08 ACCESSORIES AND EQUIPMENT Interior Trim - Element

Fastener Locations

C ► : Screw, 1 D ▷ : Clip, 4
(White)

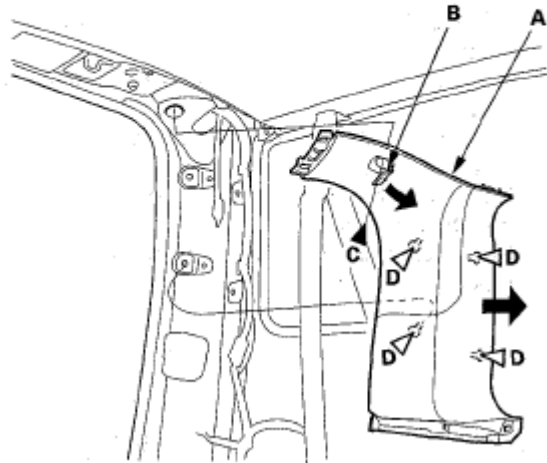

Fig. 23: Identifying D-Pillar Trim Panel

Courtesy of AMERICAN HONDA MOTOR CO., INC.

4. Install the trim in the reverse order of removal, and note these items:
 - Check if the clips (A) are damaged or stress-whitened, and if necessary, replace them with new ones.
 - To prevent the side curtain airbag from deploying improperly and possibly causing injury, inspect the trim and replace it if it has any of these types of damage:
 - Any cracks, deformations, or stress-whitening in the D-pillar trim (B), rear roof trim (C), and hooks (D)
 - Any cracks or stress-whitened areas in the clips seating surfaces (E)
 - Replace any damaged parts with new ones.
 - Push the clips and hooks into place securely.
 - Make sure the top of the trim overlaps with the headliner correctly.
 - Make sure the rear ceiling light connector is plugged in properly.

2007 Honda Element EX

2007-08 ACCESSORIES AND EQUIPMENT Interior Trim - Element

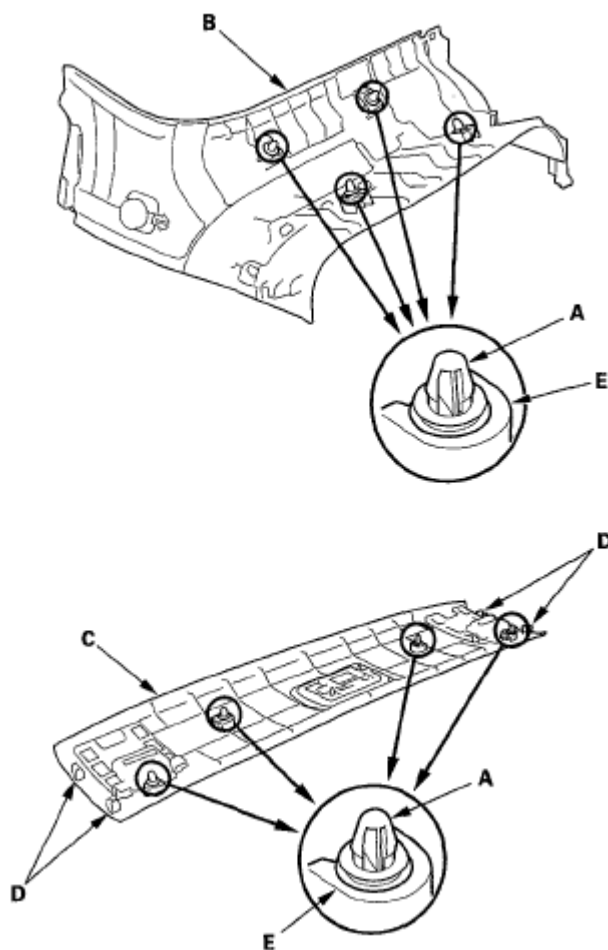

Fig. 24: Identifying Clips, D-Pillar Trim, Rear Roof Trim And Hooks
Courtesy of AMERICAN HONDA MOTOR CO., INC.

TRIM REMOVAL/INSTALLATION - HATCH AREA

Special Tools Required

KTC trim tool set SOJATP2014 *

* Available through the American Honda Tool and Equipment Program; call 888-424-6857

NOTE:

- Put on gloves to protect your hands.
- Use the appropriate tool from the KTC trim tool set to avoid damage when prying components.
- Take care not to bend or scratch the trim and panels.

1. Remove the trim as shown.
2. Install the trim in the reverse order of removal, and note these items:

2007 Honda Element EX

2007-08 ACCESSORIES AND EQUIPMENT Interior Trim - Element

- Check if the clips are damaged or stress-whitened, and if necessary, replace them with new ones.
- Make sure the rear window defogger wire harness on each side is not pinched.
- Push the clips into place securely.

Fastener Locations

A▷ : Clip, 1 B▷ : Clip, 6 (White) C▷ : Clip, 3 (Black)

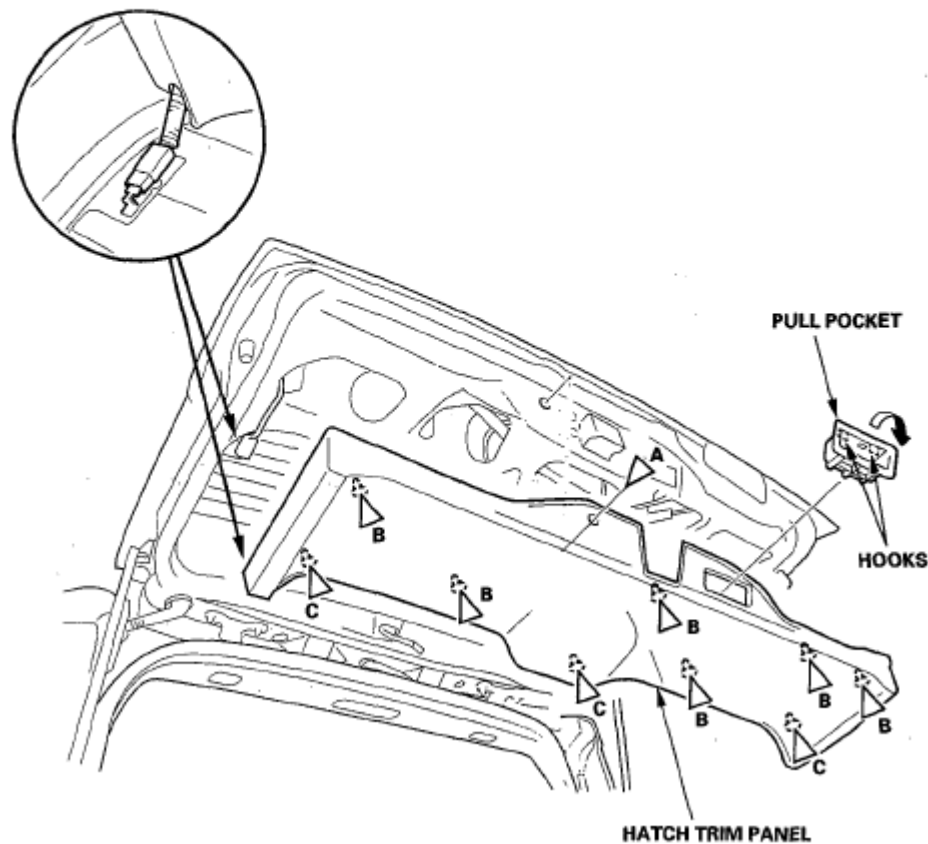

Fig. 25: Trim Removal/Installation - Hatch Area
Courtesy of AMERICAN HONDA MOTOR CO., INC.

TRIM REMOVAL/INSTALLATION - TAILGATE AREA

Special Tools Required

KTC trim tool set SOJATP2014 *

* Available through the American Honda Tool and Equipment Program; call 888-424-6857

NOTE:

- Put on gloves to protect your hands.
- Use the appropriate tool from the KTC trim tool set to avoid damage when prying components.
- Take care not to bend or scratch the trim and panels.

1. Remove the tailgate weatherstrip as needed (see **TAILGATE WEATHERSTRIP REPLACEMENT**).
2. Remove the tailgate handle knob (A), and remove the screw.

Fastener Location

▶ : Screw, 1

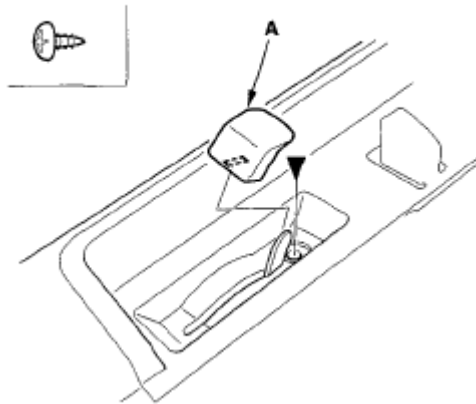

Fig. 26: Identifying Tailgate Handle Knob Screw
 Courtesy of AMERICAN HONDA MOTOR CO., INC.

3. Open the tailgate. Starting at the bottom edge on the tailgate lower trim panel (A), pull the trim panel up to detach the clips.

Fastener Locations

▷ : Clip, 9 (White)

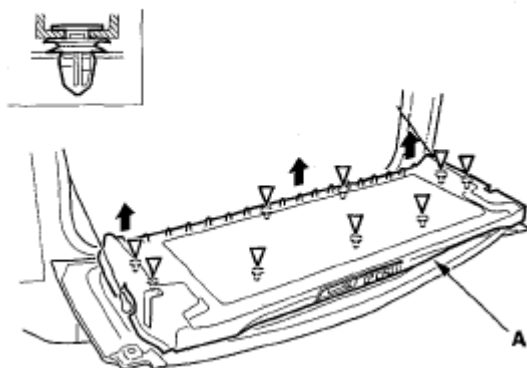

Fig. 27: Identifying Bottom Edge On Tailgate Lower Trim Panel
 Courtesy of AMERICAN HONDA MOTOR CO., INC.

4. Close the tailgate half-way and hold it there to loosen the tailgate support cables (A) on both sides. Pull

up on the bottom edge of the trim panel (B) and pass the cables under the trim panel on each side.

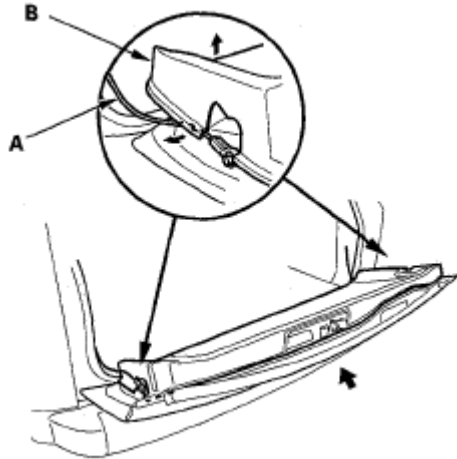

Fig. 28: Identifying Tailgate Support Cables On Both Sides
 Courtesy of AMERICAN HONDA MOTOR CO., INC.

5. Pull the trim panel (A) out to release the pins (B) of the trim panel and the tailgate handle lever (C), then remove the trim panel.

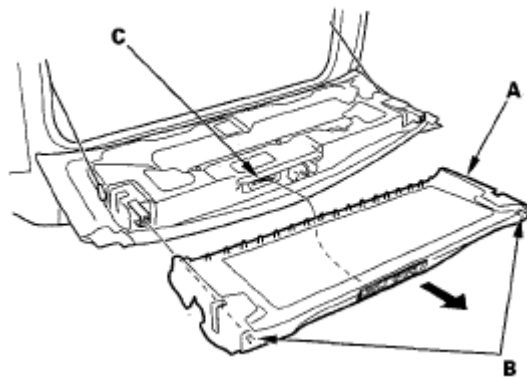

Fig. 29: Removing Trim Panel Out To Release Pins Of Trim Panel And Tailgate Handle Lever
 Courtesy of AMERICAN HONDA MOTOR CO., INC.

6. Install the trim panel in the reverse order of removal, and note these items:
 - Check if the clips are damaged or stress-whitened, and if necessary, replace them with new ones.
 - Make sure the tailgate handle lever is slipped through the slit of the trim panel properly.
 - Push the clips into place securely.

SUNVISOR REMOVAL/INSTALLATION

1. Release the tabs (A) on both sides with the appropriate tool from the KTC trim tool set, then remove the sunvisor cap (B) from the bracket (C). Turn the cap, and remove it.

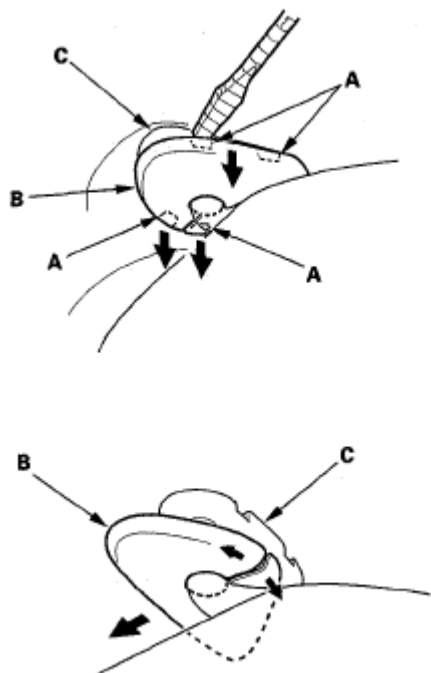

Fig. 30: Identifying Sunvisor Cap

Courtesy of AMERICAN HONDA MOTOR CO., INC.

2. Remove the sunvisor (A).
 1. Remove the sunvisor from the holder (B).
 2. Using a TORX T25 bit, remove the screws.
 3. Remove the sunvisor from the body.

Fastener Locations

▶ : Screw, 2

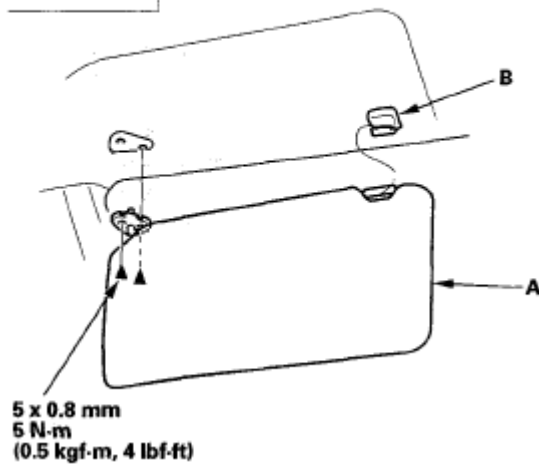

Fig. 31: Identifying Sunvisor Screws With Torque Specification

Courtesy of AMERICAN HONDA MOTOR CO., INC.

- Using a flat-tip screwdriver, push the hook (A), and turn the holder (B) 90°, then pull it out.

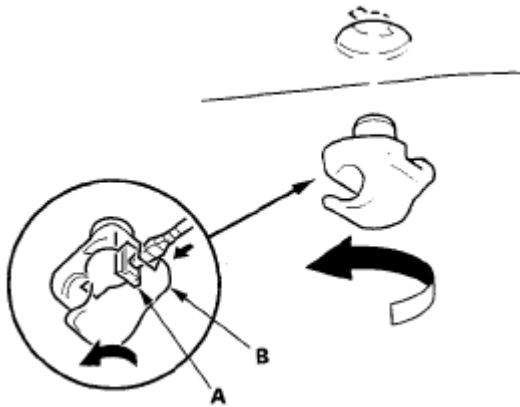

Fig. 32: Removing Holder Hook

Courtesy of AMERICAN HONDA MOTOR CO., INC.

- Install the sunvisor in the reverse order of removal, and note these items:
 - If the side curtain airbag has deployed, replace the sunvisor with a new one.
 - To prevent the side curtain airbags from deploying improperly and possibly causing injury, inspect removed pieces and replace them if they have any of these types of damage:
 - Any cracks in the sunvisor stay base (A)
 - Any bends or cracks in the sunvisor stay shaft (B)
 - Any cracks in the sunvisor base (C)
 - If the threads on a visor screws are worn out, use an oversized self-tapping ET screw, P/N 90137-S30-003, made specifically for this application.

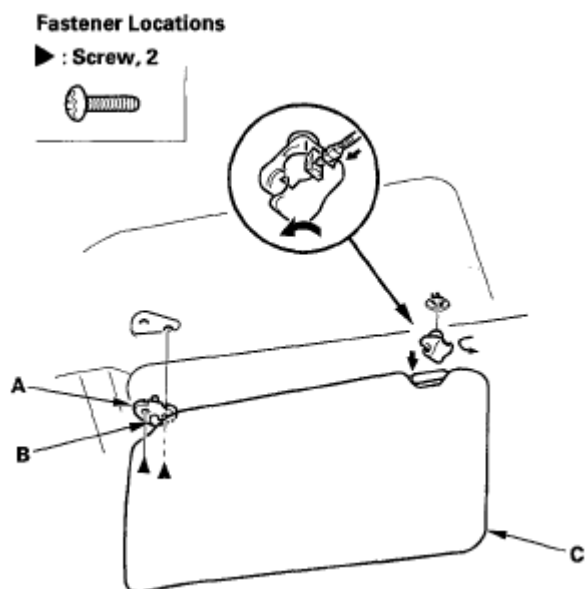

Fig. 33: Identifying Sunvisor Stay Base And Sunvisor Base
Courtesy of AMERICAN HONDA MOTOR CO., INC.

GRAB HANDLE REMOVAL/INSTALLATION

Special Tools Required

KTC trim tool set SOJATP2014 *

* Available through the American Honda Tool and Equipment Program; call 888-424-6857

NOTE: Use the appropriate tool from the KTC trim tool set to avoid damage when prying components.

1. On the front passenger's side: Remove the caps (A), and remove the screws, then remove the grab handle (B).

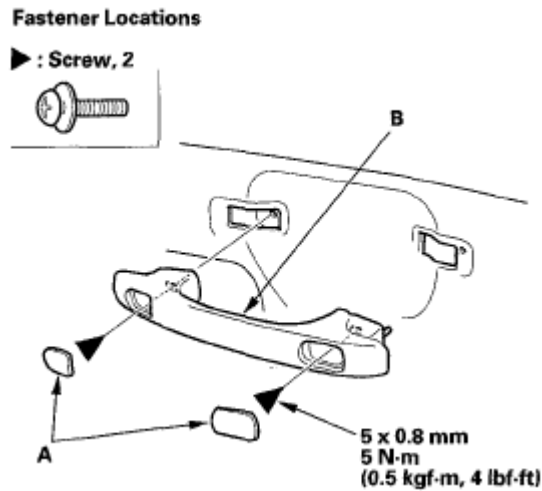

Fig. 34: Identifying Grab Handle Screws With Torque Specification
Courtesy of AMERICAN HONDA MOTOR CO., INC.

2. Install the grab handle in the reverse order of removal, and note these items:
 - If the side curtain airbag has deployed, replace the grab handles with new ones.
 - To prevent the side curtain airbags from deploying improperly and possibly causing injury, inspect the removed grab handle (A) and replace it if it has any deformations.

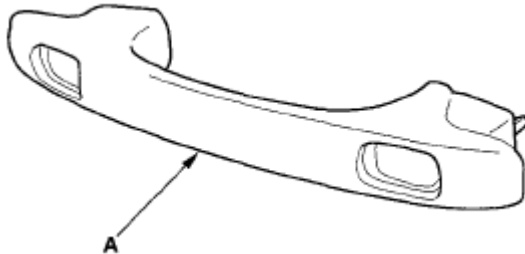

Fig. 35: Identifying Grab Handle
Courtesy of AMERICAN HONDA MOTOR CO., INC.

HEADLINER REMOVAL/INSTALLATION

Special Tools Required

KTC trim tool set SOJATP2014 *

* Available through the American Honda Tool and Equipment Program; call 888-424-6857

NOTE:

- Put on gloves to protect your hands.
- Use the appropriate tool from the KTC trim tool set to avoid damage when prying components.

- Take care not to bend or scratch the trim and panels.
- Be careful not to damage the dashboard and other interior trim.

1. Remove these items:

- Ceiling light (see **CEILING LIGHT TEST/REPLACEMENT**)
- A-pillar trim, both sides (see **A-PILLAR TRIM**)
- C-pillar trim, both sides (see **C-PILLAR TRIM/UPPER QUARTER WINDOW TRIM**)
- Upper quarter window trim (see **C-PILLAR TRIM/UPPER QUARTER WINDOW TRIM**)
- D-pillar trim, both sides (see **D-PILLAR TRIM/REAR ROOF TRIM**)
- Rearview mirror (see **REARVIEW MIRROR REPLACEMENT**)
- Skylight (for some models)

2. Remove the upper striker covers (A) from both sides.

1. Pull the door inner seal (B) away as needed.
2. Pull the cover to the rear to release it from the rear access panel upper striker (C). Detach the clips.

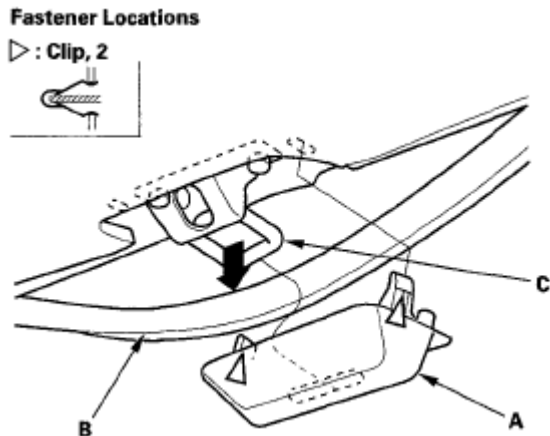

Fig. 36: Removing Upper Striker Covers

Courtesy of AMERICAN HONDA MOTOR CO., INC.

3. If equipped, remove the roof console (A).

1. Remove the lens (B).
2. Remove the self-tapping screws.
3. Pull the console down, and slide it rearward to release the hooks (C). Take care not to damage the roof wire harness.
4. Disconnect the front individual map light connector (D).

2007 Honda Element EX

2007-08 ACCESSORIES AND EQUIPMENT Interior Trim - Element

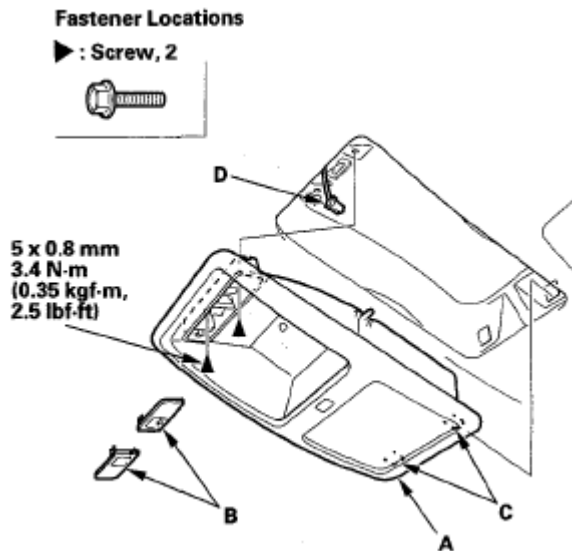

Fig. 37: Identifying Roof Console With Torque Specification
Courtesy of AMERICAN HONDA MOTOR CO., INC.

4. If equipped with a skylight, remove the screws, and slide the glass latch handle trim (A) forward to release the hook (B), then remove the trim.

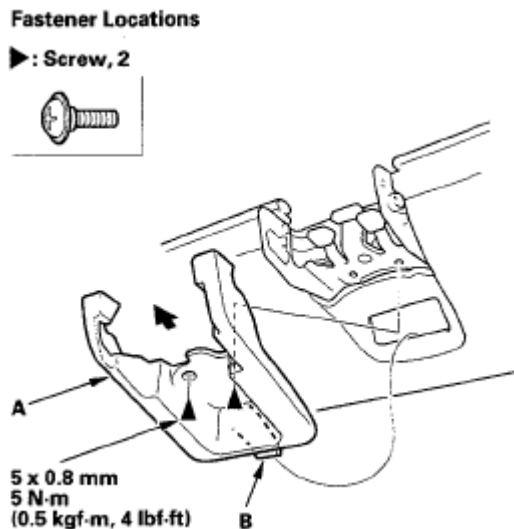

Fig. 38: Identifying Hook And Glass Latch Handle Trim With Torque Specification
Courtesy of AMERICAN HONDA MOTOR CO., INC.

5. Lower the headliner (A).
 - 1 If equipped with a skylight, remove the roof trim (B).
 - 2 Remove the clip from the rear edge of the headliner.
 - 3 Remove the remaining door inner seal (C) from each opening.

2007 Honda Element EX

2007-08 ACCESSORIES AND EQUIPMENT Interior Trim - Element

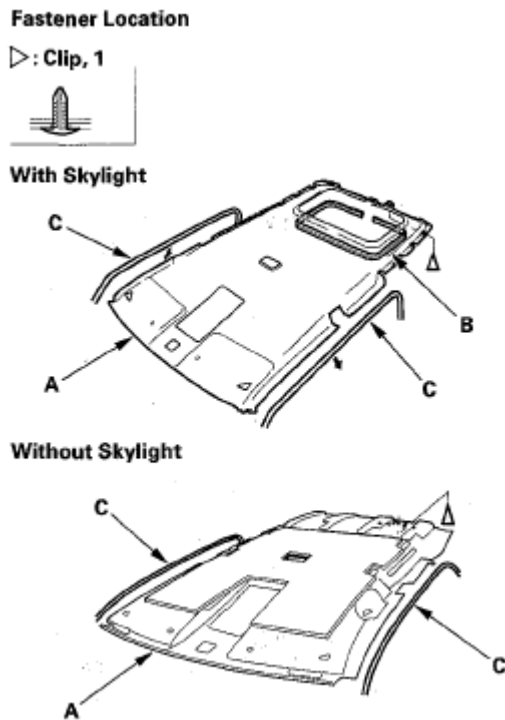

Fig. 39: Identifying Lower Headliner

Courtesy of AMERICAN HONDA MOTOR CO., INC.

6. With the help of an assistant, pull the headliner (A) out through the tailgate opening. Do not bend the liner. Bending the liner will crease and damage it.

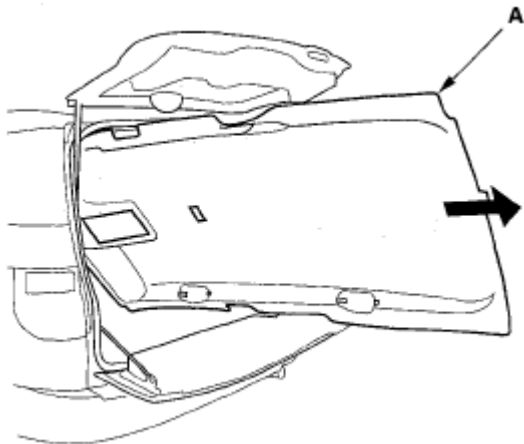

Fig. 40: Removing Headliner Out Through Tailgate Opening

Courtesy of AMERICAN HONDA MOTOR CO., INC.

7. If necessary, remove the side curtain airbag mounting, bolts (A) and grab handle bracket mounting, bolts (B), then remove the grab handle bracket (C) from each side by releasing the hooks (D).

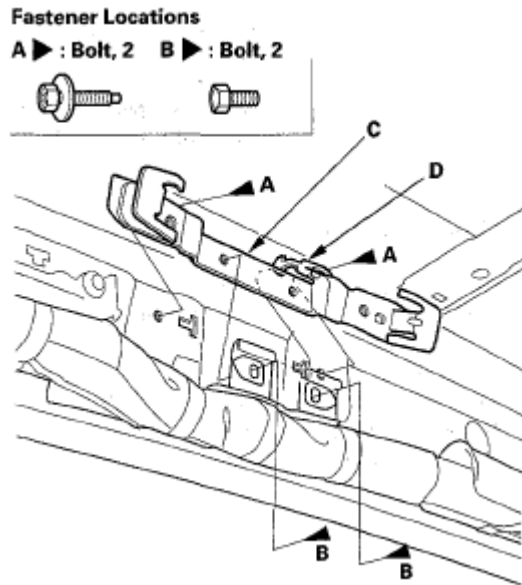

Fig. 41: Identifying Side Curtain Airbag Mounting Bolts And Grab Handle Bracket Mounting Bolts

Courtesy of AMERICAN HONDA MOTOR CO., INC.

8. Install the headliner in the reverse order of removal, and note these items:
 - If the side curtain airbag has deployed, replace the headliner and removed trim pieces with new ones.
 - To prevent the side curtain airbags from deploying improperly and possibly causing injury, inspect removed pieces and replace them if they have any of these types of damage:
 - Any crease or tears in the headliner (A)
 - Any deformations in the grab handle (B)
 - Any damage around the grab handle holes (C) or Sunvisor holes in the headliner
 - Any cracks in the sunvisor stay base (D)
 - Any bends or cracks in the sunvisor stay shaft (E)
 - Any cracks in the sunvisor base (F)
 - Any Velcro fasteners (G) which have come off the headliner
 - Check if the clips are damaged or stress-whitened, and if necessary, replace them with new ones.
 - Replace the removed cushion tape with new ones.
 - Check that both sides of the headliner are securely attached to the trim.
 - Make sure the headliner overlaps the trim pieces correctly (see **COMPONENT REPLACEMENT/INSPECTION AFTER DEPLOYMENT**).
 - When reinstalling the headliner through the tailgate opening, be careful not to fold or bent it. Also, be careful not to scratch the body.
 - With skylight: When installing the roof trim (H), align the roof trim ends with the opening flange of the skylight frame as shown.

Headliner

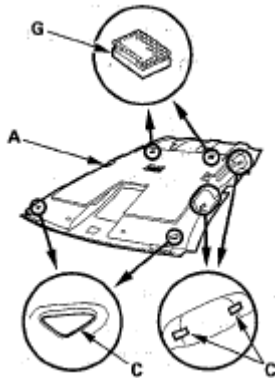

Fig. 42: Identifying Headliner
Courtesy of AMERICAN HONDA MOTOR CO., INC.

Grab handle

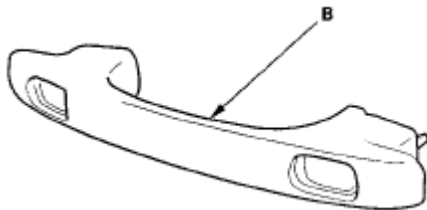

Fig. 43: Identifying Grab Handle
Courtesy of AMERICAN HONDA MOTOR CO., INC.

Sunvisor

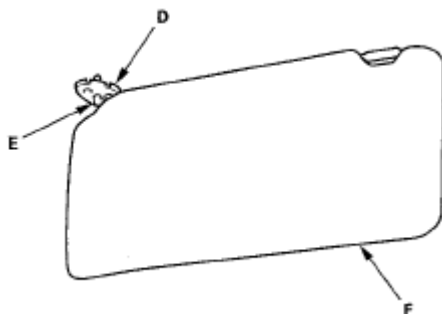

Fig. 44: Identifying Sunvisor
Courtesy of AMERICAN HONDA MOTOR CO., INC.

Skylight (some models)

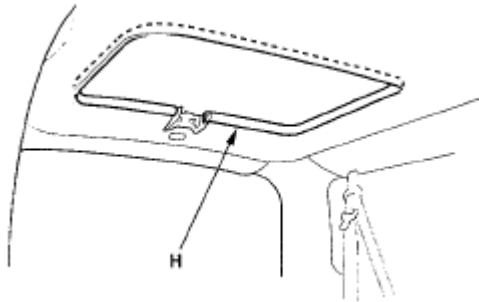

Fig. 45: Identifying Skylight (Some Models)
Courtesy of AMERICAN HONDA MOTOR CO., INC.

FLOOR COVERING REPLACEMENT

Special Tools Required

KTC trim tool set SOJATP2014 *

* Available through the American Honda Tool and Equipment Program; call 888-424-6857

SRS components are located in this area. Review the SRS component locations (see **COMPONENT LOCATION INDEX**) and the precautions and procedures (see **PRECAUTIONS AND PROCEDURES**) before doing repairs or service.

NOTE:

- Put on gloves to protect your hands.
- Use the appropriate tool from the KTC trim tool set to avoid damage when prying components.
- Take care not to damage, wrinkle or twist the floor covering.
- Be careful not to damage the dashboard or other interior trim pieces.

FRONT FLOOR COVERING

1. Remove these items:

- Front seats, both sides (see **FRONT SEAT REMOVAL/INSTALLATION**)
- Door sill trim, both sides (see **TRIM REMOVAL/INSTALLATION - DOOR AREAS**)
- Kick panels, both sides (see **TRIM REMOVAL/INSTALLATION - DOOR AREAS**)
- Passenger's dashboard undercover (see **PASSENGER'S DASHBOARD UNDERCOVER REMOVAL/INSTALLATION**)
- Center lower cover (see **CENTER LOWER COVER REMOVAL/INSTALLATION**)
- Center console (see **CENTER CONSOLE REMOVAL/INSTALLATION**)
- Subwoofer (see **SUBWOOFER**)

2. Remove the front floor covering (A).

- 1 Remove the clips.
- 2 Release the Velcro fastener (B), then pull back the floor covering from under the heater unit.
- 3 Release the Velcro fasteners (C) on the front edge of the floor covering, then pull back the floor covering from under the dashboard.

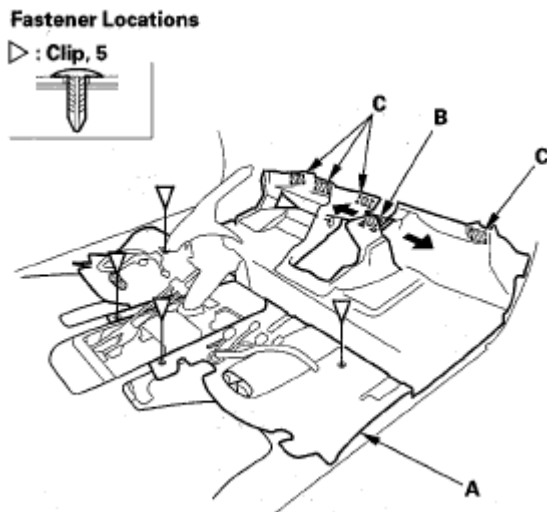

Fig. 46: Identifying Velcro Fasteners On Front Edge Of Floor Covering
 Courtesy of AMERICAN HONDA MOTOR CO., INC.

- 3. Remove the front floor covering.
- 4. Install the floor covering in the reverse order of removal, and note these items:
 - Take care not to damage, wrinkle or twist the floor covering.
 - Make sure the seat harnesses are routed correctly.
 - Check if the clips are damaged or stress-whitened, and if necessary, replace them with new ones.
 - Push the clips into place securely.

REAR FLOOR COVERING

- 1. Remove these items:
 - Front seats, both sides (see **FRONT SEAT REMOVAL/INSTALLATION**)
 - Door sill trim, both sides (see **TRIM REMOVAL/INSTALLATION - DOOR AREAS**)
 - Rear side trim panel, both sides (see **TRIM REMOVAL/INSTALLATION - REAR SIDE AREA**)
 - Center console (see **CENTER CONSOLE REMOVAL/INSTALLATION**)
- 2. Remove the clips, then remove the rear floor covering (A).

Fastener Locations

▷ : Clip, 6

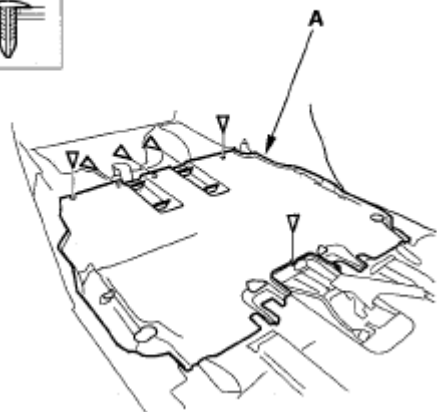

Fig. 47: Identifying Rear Floor Covering

Courtesy of AMERICAN HONDA MOTOR CO., INC.

3. Install the floor covering in the reverse order of removal, and note these items:
 - Take care not to damage, wrinkle or twist the floor covering.
 - Check if the clips are damaged or stress-whitened, and if necessary, replace them with new ones.
 - Push the clips into place securely.