

2007-08 ACCESSORIES AND EQUIPMENT

Power Mirrors - Element

COMPONENT LOCATION INDEX

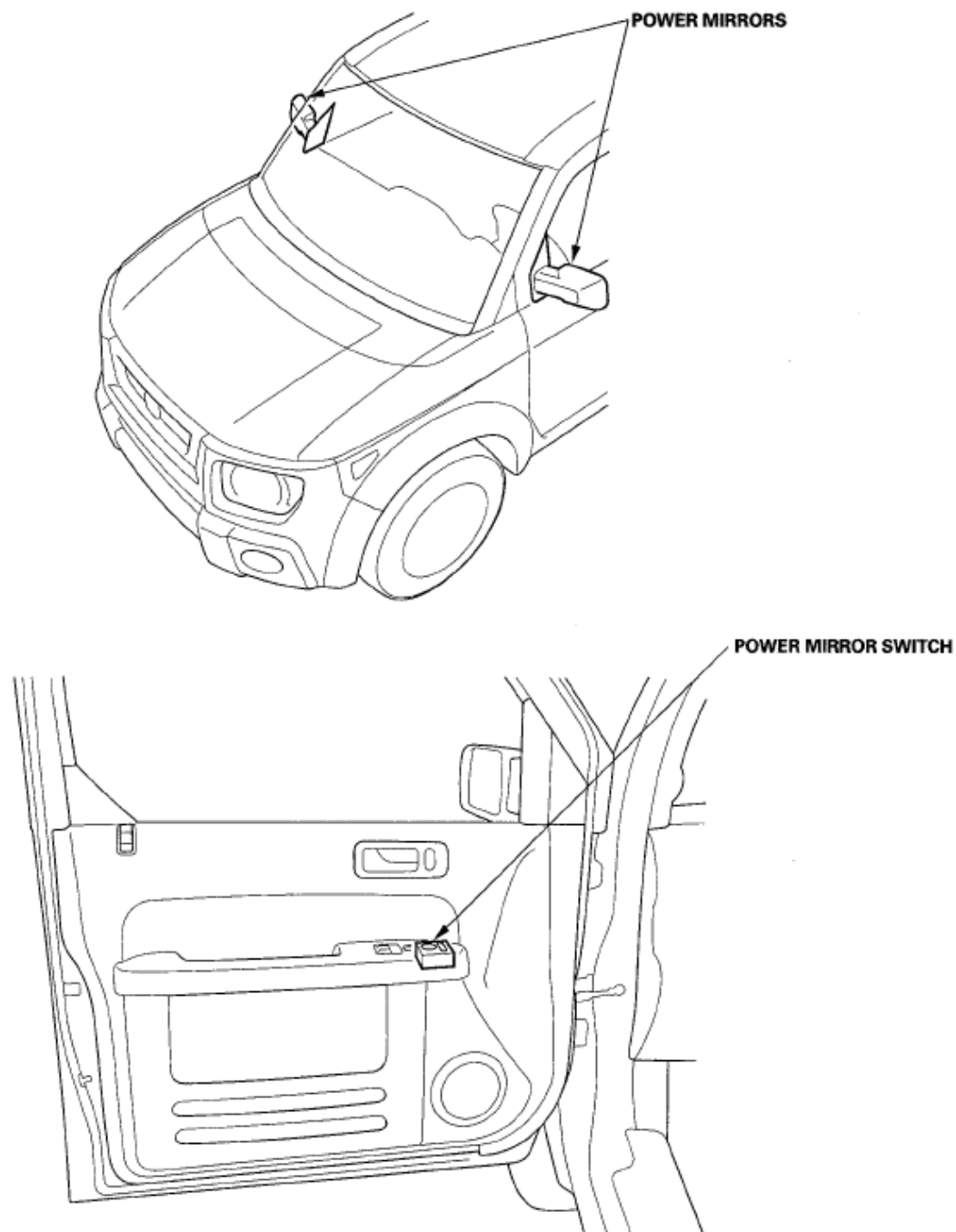

Fig. 1: Identifying Power Mirror Components Location
Courtesy of AMERICAN HONDA MOTOR CO., INC.

2007 Honda Element EX

2007-08 ACCESSORIES AND EQUIPMENT Power Mirrors - Element

CIRCUIT DIAGRAM

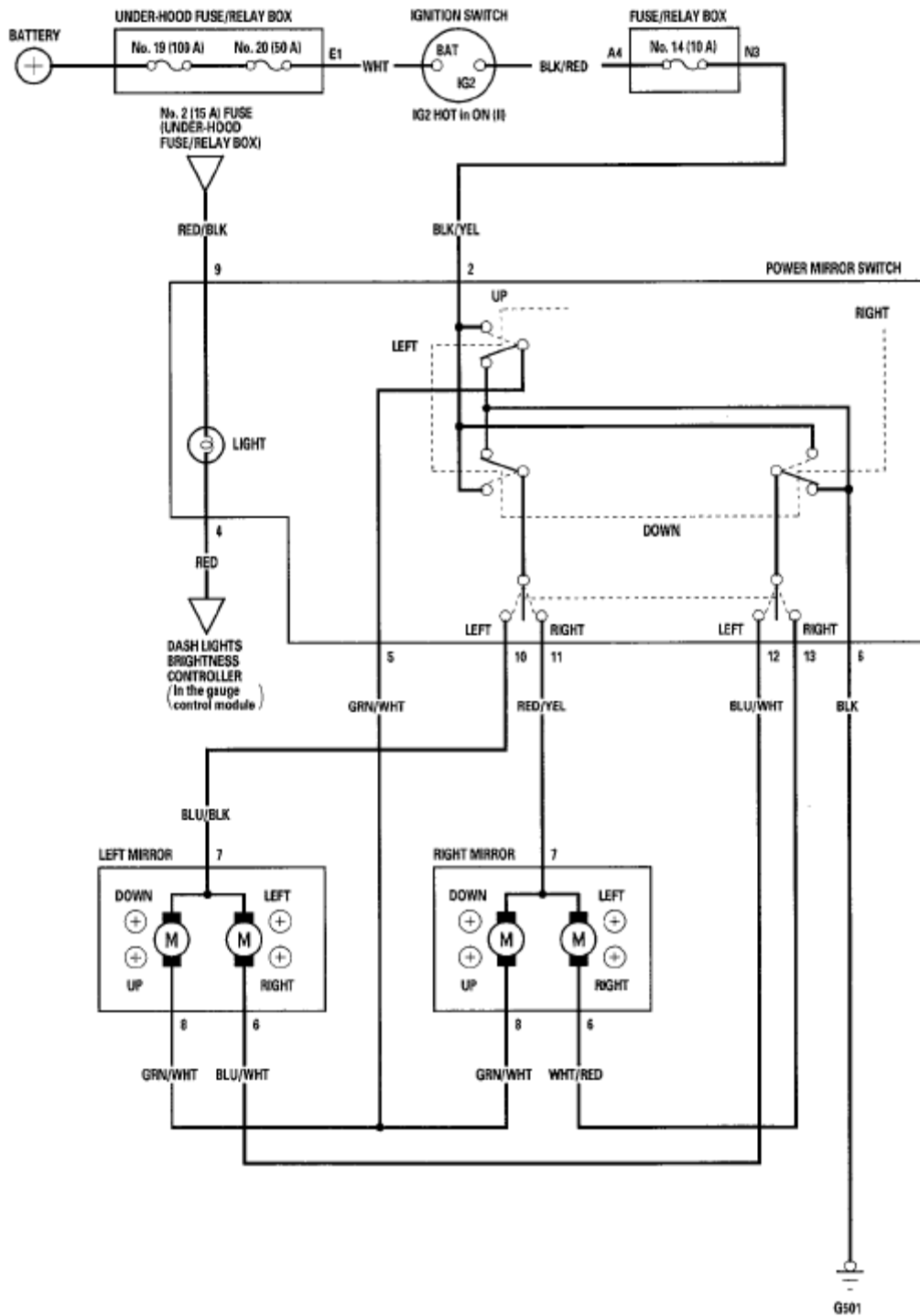

Fig. 2: Power Mirror Circuit Diagram

Courtesy of AMERICAN HONDA MOTOR CO., INC.

FUNCTION TEST

1. Remove the driver's door panel (see **FRONT DOOR PANEL REMOVAL/INSTALLATION**).
2. Disconnect the 13P connector (A) from the power mirror switch (B).

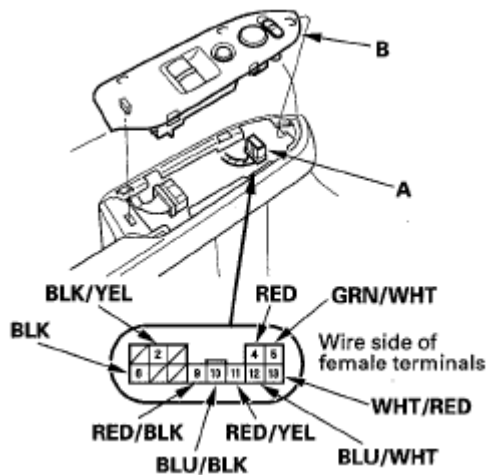

Fig. 3: Identifying Power Mirror Switch 13P Connector Terminals
 Courtesy of AMERICAN HONDA MOTOR CO., INC.

3. Choose the appropriate test based on the symptom:
 - Both mirrors don't work, go to step 4.
 - Left mirror doesn't work, go to step 6.
 - Right mirror doesn't work, go to step 7.

Both mirrors

4. Measure voltage between the No. 2 terminal and body ground with the ignition switch ON (II). There should be battery voltage.
 - If there is no battery voltage, check for:
 - Blown No. 14 (10 A) fuse in the under-dash fuse/relay box.
 - An open in the BLK/YEL wire.
 - If there is battery voltage, go to step 5.
5. Check for continuity between the No. 6 terminal and body ground.

There should be continuity.

- If there is no continuity, check for:
 - An open in the BLK wire.
 - Poor ground (G501).
- If there is continuity, check both mirrors individually as described in step 6 and step 7.

Left mirror

6. Connect the No. 2 terminal to the No. 10 terminal, and the No. 5 (then No. 12) terminal to No. 6 terminal with jumper wires. The left mirror should tilt down (then swing left) with the ignition switch ON (II).
 - If the mirror does not tilt down (or does not swing left), check for an open in the GRN/WHT (or BLU/WHT) wire between the left mirror and the 13P connector. If the wire is OK, check the left mirror actuator (see **POWER MIRROR ACTUATOR TEST**).
 - If the mirror neither tilts down nor swings left, repair the BLU/BLK wire.
 - If the mirror works properly, check the mirror switch (see **POWER MIRROR ACTUATOR TEST**).

Right mirror

7. Connect the No. 2 terminal to the No. 11 terminal, and the No. 5 (then No. 13) terminal to No. 6 terminal with jumper wires. The right mirror should tilt down (then swing left) with the ignition switch ON (II).
 - If the mirror does not tilt down (or does not swing left), check for an open in the GRN/WHT (or WHT/RED) wire between the right mirror and the 13P connector. If the wire is OK, check the right mirror actuator (see **POWER MIRROR ACTUATOR TEST**).
 - If the mirror neither tilts down nor swings left, repair the RED/YEL wire.
 - If the mirror works properly, check the mirror switch (see **POWER MIRROR ACTUATOR TEST**).

POWER MIRROR SWITCH TEST/REPLACEMENT

1. Remove the driver's door panel (see **FRONT DOOR PANEL REMOVAL/INSTALLATION**).
2. Disconnect the 13P connector from the power mirror switch (A).

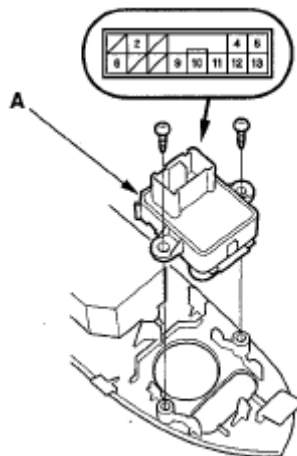

Fig. 4: Identifying Power Mirror Switch 13P Connector Terminals
 Courtesy of AMERICAN HONDA MOTOR CO., INC.

3. Check for continuity between the terminals in each switch position according to **Fig. 5**.

Terminal Position	2	5	6	10	11	12	13
L	UP	○—○		○—○—○			
	DOWN	○	○—○		○—○		
	LEFT	○—○		○			
	RIGHT	○	○—○—○			○	
R	UP	○—○		○—○—○	○—○	○	
	DOWN	○	○—○		○		○
	LEFT	○—○		○—○	○		○
	RIGHT	○	○—○—○		○		○

Fig. 5: Power Mirror Switch Terminals Continuity Chart
 Courtesy of AMERICAN HONDA MOTOR CO., INC.

4. If the continuity is not as specified, remove the screws and replace the switch.

POWER MIRROR ACTUATOR TEST

1. Remove the door panel (see **FRONT DOOR PANEL REMOVAL/INSTALLATION**).
2. Disconnect the 8P connector (A) from the power mirror actuator (B).

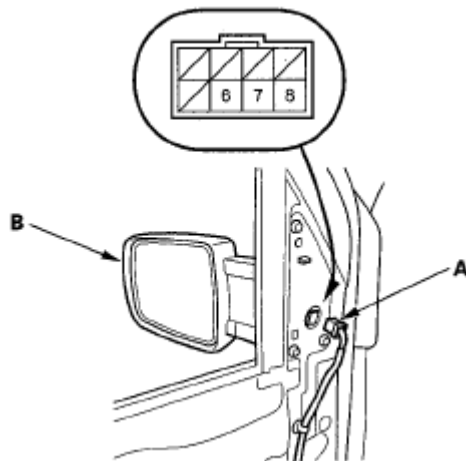

Fig. 6: Identifying Power Mirror Actuator 8P Connector Terminals
 Courtesy of AMERICAN HONDA MOTOR CO., INC.

3. Check actuator operation by connecting power and ground according to **Fig. 7**.

Terminal	6	7	8
Position			
TILT UP		⊖	⊕
TILT DOWN		⊕	⊖
SWING LEFT	⊖	⊕	
SWING RIGHT	⊕	⊖	

Fig. 7: Connecting Power And Ground Chart
Courtesy of AMERICAN HONDA MOTOR CO., INC.

- If the mirror fails to work properly, replace the mirror actuator.

POWER MIRROR ACTUATOR REPLACEMENT

- Remove the mirror holder (see MIRROR HOLDER REPLACEMENT).
- Disconnect the 6P connector from the mirror, and remove the power mirror (see POWER MIRROR/MANUAL MIRROR REPLACEMENT).
- Remove the cover (A), then remove the two screws from the mirror connector (B).

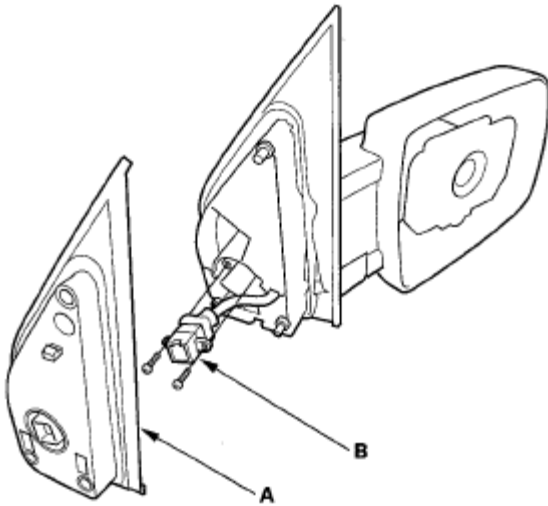

Fig. 8: Identifying Power Mirror Actuator And Cover
Courtesy of AMERICAN HONDA MOTOR CO., INC.

- Record the terminal locations and wire colors.
- Cut the wire harness with the wire cutter.

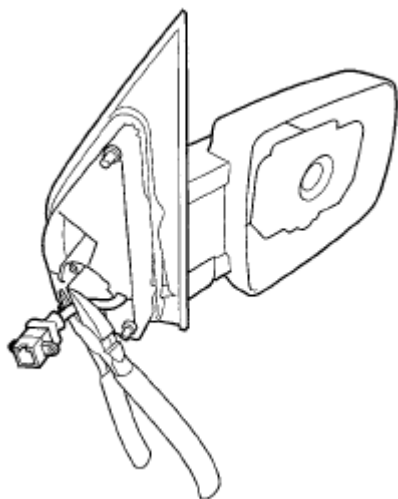

Fig. 9: Cutting Wire Harness With Wire Cutter
Courtesy of AMERICAN HONDA MOTOR CO., INC.

6. Remove the three screws, and separate the mirror housing (A) from the bracket (B).

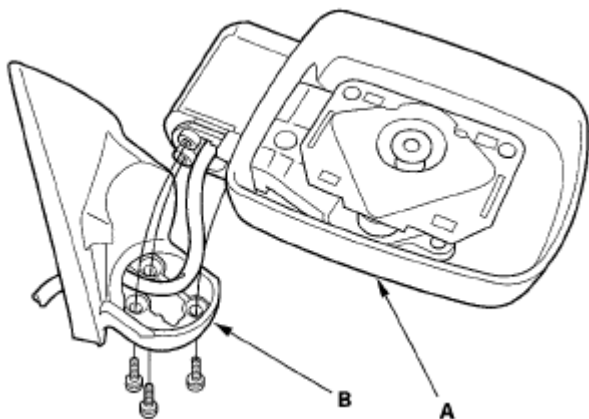

Fig. 10: Identifying Mirror Housing And Bracket
Courtesy of AMERICAN HONDA MOTOR CO., INC.

7. Remove the cover (A), then remove the three screws and the actuator (B).

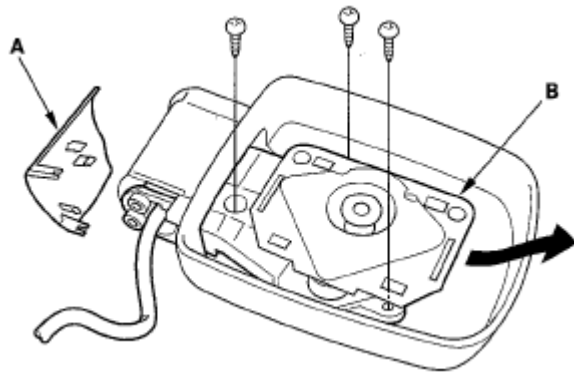

Fig. 11: Identifying Power Mirror Actuator Screws
Courtesy of AMERICAN HONDA MOTOR CO., INC.

8. Route the wire harness (A) of the new actuator through the hole in the bracket (B) and gasket (C).

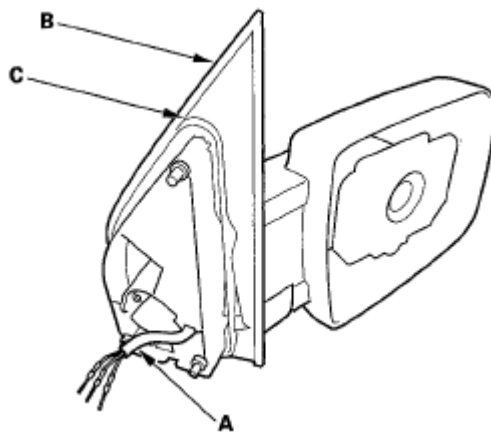

Fig. 12: Identifying Actuator Wire Harness, Bracket And Gasket
Courtesy of AMERICAN HONDA MOTOR CO., INC.

9. Install the actuator, bracket, and cover in the reverse order of removal.
10. Insert the new actuator terminals into the connector in the original arrangement as shown.

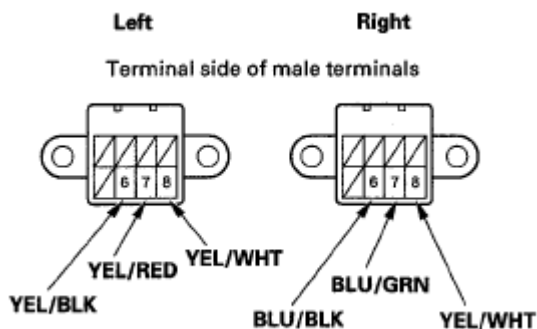

Fig. 13: Identifying Power Mirror Actuator Terminals

2007 Honda Element EX

2007-08 ACCESSORIES AND EQUIPMENT Power Mirrors - Element

Courtesy of AMERICAN HONDA MOTOR CO., INC.

11. Reassemble in the reverse order of disassembly. Be careful not to break the mirror holder when reinstalling it to the actuator.
12. Reinstall the mirror assembly to the door.
13. Operate the power mirror to ensure smooth operation.