

# **SECTION 1 - 1**

---

## **INSTRUMENTS AND CONTROLS**

### **Keys and doors**

|                                 |    |
|---------------------------------|----|
| Keys .....                      | 8  |
| Engine immobiliser system ..... | 11 |
| Wireless remote control .....   | 13 |
| Doors .....                     | 19 |

## KEYS AND DOORS

---

### KEYS



- 1 Master key (black) – The master key works in every lock. For your Lexus dealer to make you a new key with built-in transponder chip, your dealer will need it.**
- 2 Sub key (gray) – The sub key will not open the trunk, trunk main switch and the glove box. For your Lexus dealer to make you a new key with built-in transponder chip, your dealer will need it.**
- 3 Key number plate – Keep the plate in a safe place such as your wallet, not in the vehicle.**

A transponder chip for engine immobiliser system has been filled in the head of the master and sub keys. These chips are needed to enable the system to function correctly, so be careful not to lose these keys. If you make your own duplicate key, you will not be able to cancel the system or start the engine.

To protect things locked in the trunk or glove box when you have your vehicle parked, leave the sub key with the attendant.

Since the doors and trunk lid can be locked without a key, you should always carry a spare master key in case you accidentally lock your keys inside the vehicle.

If you should lose your keys or if you need additional keys, duplicates can be made by a Lexus dealer using the key number.

We recommend you to write down the key number and keep it in safe place.

**Flat key**



**As a transponder chip is built in its key case, you can start the engine with this key.**

**The flat key works in every lock.**

A transponder chip for engine immobiliser system has been filled in the key case of the flat key. This chip is needed to enable the system to function correctly, so be careful not to lose this key. If you make your own duplicate key, you will not be able to cancel the system or start the engine.

Insert your key plate in its key case as shown. We recommend that you always carry this with you for emergency use. Do not leave it in your vehicle.

**Starting the engine using a flat key**

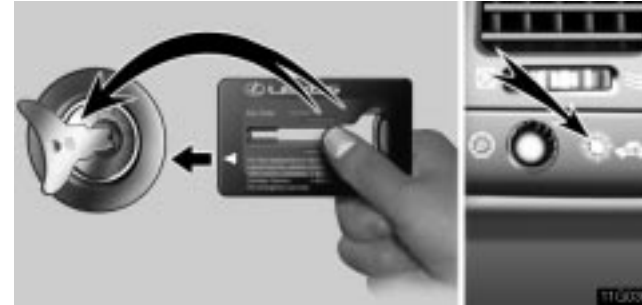

1. Remove the key plate from the key case.
2. Insert the key plate into the ignition switch. The indicator light keeps flashing.
3. Bring the key case closer to the ignition switch within 10 seconds as indicated by the arrow head. The indicator light goes out. This means the engine immobiliser system is automatically canceled. (For details, see "Engine immobiliser system" on page 11.) You can put the key case away then. You cannot cancel the engine immobiliser system if 10 seconds have past after you inserted the key plate. You need to remove the key plate from the ignition switch and try it again from the step 2.
4. Start the engine within 60 seconds after the security indicator light goes out. You cannot start the engine if 60 seconds have past after the security indicator went off. You need to remove the key plate from the ignition switch and try it again from the step 2.

## KEYS AND DOORS

### NOTICE

- Do not let the key case become bent as the key plate may fall out or become bent also.
- The flat key is designed for emergency use only. So do not use it regularly instead of other master keys.



When using a key containing a transponder chip, observe the following precautions:

- When starting the engine, do not use the key with a key ring resting on the key grip and do not press the key ring against the key grip. Otherwise the engine may not start, or may stop soon after it starts.



- When starting the engine, do not use the key with other transponder keys around (including the flat key and keys of other vehicles) and do not press other key plates against the key grip. Otherwise the engine may not start, or may stop soon after it starts. If this happens, remove the key once and then insert it again after taking off other transponder keys (including the flat key and keys of other vehicles) from the ring or while gripping or covering them with your hand to start the engine.



- ***Do not bend the key grip or flat key.***
- ***Do not cover the key grip or flat key with any material that cuts off electromagnetic waves.***
- ***Do not knock the key or flat key hard against other objects.***
- ***Do not leave the key or flat key exposed to high temperatures for a long period, such as on the dashboard and hood under the direct sunlight.***
- ***Do not put the key or flat key in water or wash it in an ultrasonic washer.***
- ***Do not use the key or flat key with electromagnetic materials.***

## ENGINE IMMOBILISER SYSTEM



The engine immobiliser system is a theft prevention system. When you insert the key in the ignition switch, the transponder chip in the key's head transmits an electronic code to the vehicle. The engine will start, only when the electronic code in the chip corresponds to the registered ID code for the vehicle.

The system is automatically set when the key is removed from the ignition switch. At this time, the security indicator light flashes. When you insert the key in the ignition switch, the security indicator light goes out and the system is canceled automatically, which enables the engine to start.

The transponder chip of the flat key is in its key case. You can cancel the engine immobiliser system using the flat key. (For details, see "Flat key" on page 9.)

## KEYS AND DOORS

---

For your Lexus dealer to make you a new key with built-in transponder chip, your dealer will need your key number and master key or the flat key. However, there is a limit to the number of additional keys your Lexus dealer can make for you.

**If you make your own duplicate key, you will not be able to cancel the system or start the engine.**

**For vehicles sold in U.S.A.**

**FCC ID: MOZ RI-4ATY  
MADE IN JAPAN**

This device complies with Part 15 of the FCC Rules. Operation is subject to the following two conditions: (1) This device may not cause harmful interference, and (2) this device must accept any interference received, including interference that may cause undesired operation.



**CAUTION**

**Changes or modifications not expressly approved by the party responsible for compliance could void the user's authority to operate the equipment.**

**For vehicles sold in Canada**

This device complies with RSS-210 of Industry Canada. Operation is subject to the following two conditions:

(1) This device may not cause interference, and (2) this device must accept any interference, including interference that may cause undesired operation of the device.

## WIRELESS REMOTE CONTROL\*



- 1 Locking the doors and sounding an alarm**
- 2 Unlocking the doors**
- 3 Indicator light**
- 4 Unlocking the trunk lid**

*NOTE: \*This feature can be set inoperative as vehicle theft deterrent measure in case of the loss of the wireless remote control key. Ask your Lexus dealer for details.*

When you operate any button on the key, push it slowly and surely. At this time, the indicator light on the key grip flashes once.

The operational range of the wireless remote control is approximately 1 meter (3 ft.). The effective range may vary with different conditions. To activate the wireless remote control without fail, do it approximately 1 meter (3 ft.) from your Lexus.

In the following cases, the battery in the key may be discharged. If this is a case, replace it using a special screwdriver.

- The remote control does not work.
- The operational range of wireless remote control becomes extremely short.
- The indicator light on the key is dimmed or does not come on.

For the replacement of the battery, see "Replacing the battery" on page 17. You can also have the battery of the key replaced by your Lexus dealer.

If you lose the wireless key, contact your Lexus dealer as soon as possible to avoid the possibility of theft, or an accident.

You can use up to 4 wireless remote control keys for the same vehicle. Contact your Lexus dealer for detailed information.

**The wireless remote control key is an electronic component. Observe the following instructions in order not to cause damage to the key.**

- Do not leave the wireless remote control key on places where the temperature becomes high such as on the dashboard.
- Do not disassemble it.
- Avoid knocking it hard against other objects or dropping it.
- Avoid putting it in water.

## KEYS AND DOORS

---

### Locking/Unlocking the doors

**When you push the "LOCK" button on the key briefly, all the doors can be locked from outside the vehicle.**

When they are locked securely, the emergency flashers will flash and one beep will sound.\* However, when you push the "LOCK" button with any door not closed securely, the buzzer sounds for 10 seconds.\*\* To stop the buzzer, close all the doors securely or push the "UNLOCK" button. If the key is in the ignition switch, locking cannot be done.

Make sure all the doors are locked when you leave the vehicle. Push the "LOCK" button once again. If they were already locked, the turn signal lights will flash.\*\*\*

*NOTE: \*The emergency flashers can be set not to flash and volume of beep sound can be changed. \*\*The buzzer can be set not to sound with any door not closed securely. \*\*\*The turn signal lights can be set not to flash. Ask your Lexus dealer for details.*

#### **NOTICE**

**Do not push the "LOCK" button any longer than 2 to 3 seconds. Pushing the button longer activates an alarm. For details, see page 15.**

**When you push the "UNLOCK" button, the driver's door is unlocked. Pushing that button once again within 3 seconds from the first push, all other doors are also unlocked.\***

*NOTE: \*Unlocking by a 2-time operation can be changed. Ask your Lexus dealer for details.*

At this time, the emergency flashers will flash twice and two beeps will sound.\* Together with the activation of unlocking, the interior light comes on for 15 seconds if the interior light switch is in "DOOR" position.\*\* However, this function does not work when the ignition key is in the "ON" position. For further information, see "Interior lights" on page 53.

You have 30 seconds to open a door after using the wireless remote unlock feature.\*\*\* If a door is not opened by then, all the doors will be automatically locked again.

Even if the "LOCK" or "UNLOCK" switch is kept pressed in, the locking or unlocking operation is not repeated. Release the button and then push again.

*NOTE: \*The emergency flashers can be set not to flash and volume of beep sound can be changed. \*\*The interior light can be set not to come on or the duration of lighting can be changed. \*\*\*The time before automatic re-locking can be changed. Ask your Lexus dealer for details.*



### Unlocking the trunk lid



**When you keep the button pushed for about 1 second, you can unlock the trunk lid.\* One beep sounds.**

This function does not work when the ignition key is in the "ON" position.

*NOTE: \*The operation method can be changed. Ask your Lexus dealer for details.*

### Sounding an alarm\*

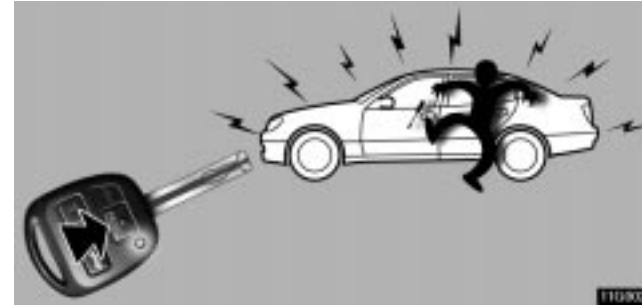

**When you push the "PANIC" button for about 2 to 3 seconds, an alarm sounds to deter any person trying to break into or damage your vehicle.**

If you want to stop the alarm, push any button.

This function does not work when the ignition key is in the "ON" position.

*NOTE: \*The alarm can be set not to sound. Ask your Lexus dealer for details.*

## KEYS AND DOORS

---

### Operating the windows and moon roof

The windows and moon roof can be operated using a wireless key from outside the vehicle.\*

*NOTE: \*The windows can be set inoperative. The moon roof can be set to slide open, tilt up or inoperative. Ask your Lexus dealer for details.*



Push the "UNLOCK" button until the windows and moon roof start to move. When you release the button, the windows and moon roof stop operating.

#### For vehicles sold in U.S.A.

This device complies with Part 15 of the FCC Rules. Operation is subject to the following two conditions: (1) This device may not cause harmful interference, and (2) this device must accept any interference received, including interference that may cause undesired operation.

#### NOTICE:

This equipment has been tested and found to comply with the limits for a Class B digital device, pursuant to Part 15 of the FCC Rules. These limits are designed to provide reasonable protection against harmful interference in a residential installation. This equipment generates, uses and can radiate radio frequency energy and, if not installed and used in accordance with the instructions, may cause harmful interference to radio communications. However, there is no guarantee that interference will not occur in a particular installation. If this equipment does cause harmful interference to radio or television reception, which can be determined by turning the equipment off and on, the user is encouraged to try to correct the interference by one or more of the following measures:

- Reorient or relocate the receiving antenna.
- Increase the separation between the equipment and receiver.
- Connect the equipment into an outlet on a circuit different from that to which the receiver is connected.
- Consult the dealer or an experienced radio / TV technician for help.

#### FCC WARNING:

**Changes or modifications not expressly approved by the party responsible for compliance could void the user's authority to operate the equipment.**

**For vehicles sold in Canada**

Operation is subject to the following two conditions: (1) this device may not cause interference, and (2) this device must accept any interference, including interference that may cause undesired operation of the device.

**Replacing the battery**

When you replace the battery, prepare a lithium battery CR1616 and a special screwdriver.

**CAUTION**

Special care should be taken that small children do not swallow the removed battery or components.

**NOTICE**

When replacing the battery, be careful not to lose the components, screws and O-ring.



1. Remove the screw, and then the cover while pushing it in the arrow direction.

## KEYS AND DOORS

---



2. Remove the module from the key frame.



3. Remove the 2 screws to take out the lid of the module.

4. Take out the discharged battery and put a new battery with the positive side up.

### NOTICE

- *Make sure the positive side and negative side of the battery should be faced correctly.*
- *Be careful not to bend the electrode of the battery insertion and that dust or oils do not adhere to the inside of the module.*
- *Take care not to lose the screws and O-ring.*

5. Install the lid with the 2 screws.

### NOTICE

*Take care not to damage or bend the O-ring when installing.*

6. Install the module into the key frame and secure the cover with the screw.

7. When pushing any switch on the wireless key, make sure the indicator light comes on.

## DOORS

### Locking with key



► **1 Lock 2 Unlock**

**Turn the key towards the front of the vehicle to lock and towards the back to unlock.**

The doors lock and unlock simultaneously with either front door. In the driver's door lock, turning the key once will unlock the driver's door and twice in succession will unlock all doors simultaneously.\* In the passenger's door lock, turning the key once will unlock all doors simultaneously.

*NOTE: \*Unlocking by a 2-time operation can be changed. Ask your Lexus dealer for details.*

The windows and moon roof can be opened and closed from outside the vehicle using the key. For details, see "Power window switches" on page 32 and "Moon roof" on page 70.

### Locking with inside lock button



► **1 Lock 2 Unlock**

**Push in the lock button to lock and unlock the door.**

When locked, the door cannot be opened with either the outside or inside door handle. However, the driver's door can be opened from the inside even with the lock button pushed in.

Closing the door with the lock button pushed in will also lock the door. Be careful not to lock your keys in the vehicle. The door will not lock if the key is left in the ignition switch when closing the front doors.

If the vehicle is subjected to a severe frontal, rear or side impact with the ignition switch turned to the "ON" position, all the doors will unlock automatically after a few seconds.

## KEYS AND DOORS

---

### CAUTION

Before driving, make sure the doors are closed and locked, especially when small children are in the vehicle. Along with the proper use of seat belts, locking the doors helps prevent the driver and passengers from being thrown out from the vehicle during an accident. It also helps prevent the doors from being opened unintentionally.

### Locking with power door lock switch



► **1** Lock **2** Unlock

To lock all the doors simultaneously, push the power door lock switch on the front side. Pushing on the rear side will unlock them.

The same switch is also equipped on the front passenger's side.

**Auto door locking function\*:** All the doors will lock automatically when the selector lever is moved out of "P" position. This auto door locking function is operable while the ignition switch is turned to the "ON" position.

*NOTE: \* This auto door locking function can be disabled or changed. Ask your Lexus dealer for details.*

**Locking with rear door child-protector**



► **1** *Unlock* **2** *Lock*

Whenever small children are in the vehicle, lock the rear door so that it does not open from the inside. To do this, turn the knob to the "LOCK" position as shown and then close the door.

