

SECTION 2-1

AIR CONDITIONING AND AUDIO

Air conditioning

Automatic air conditioning controls 134

For vehicles equipped with Navigation System, please refer to the separate "Owner's Manual for Navigation System".

AIR CONDITIONING

AUTOMATIC AIR CONDITIONING CONTROLS

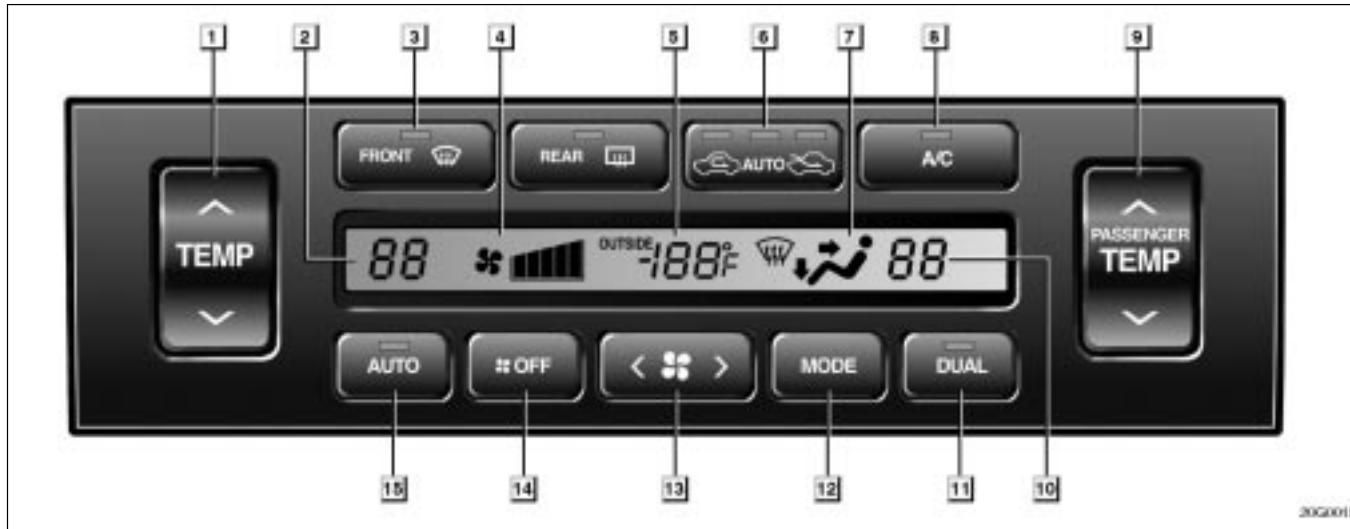

- **The automatic air conditioning automatically maintains the set temperature.**

In the automatic operation mode, the air conditioning selects the most suitable fan speed, air flow, air intake and on-off of the air conditioning according to the temperature.

The ignition key must be in the "ON" position.

NOTICE

To prevent the battery from being discharged, do not leave the air conditioning on longer than necessary when the engine is not running.

- 1 *Driver side temperature control button*
- 2 *Driver side temperature display (in degrees Fahrenheit or Centigrade)*
- 3 *Front windshield button*
- 4 *Fan speed display*
- 5 *Outside temperature display (in degrees Fahrenheit or Centigrade)*
- 6 *Air intake control button*
- 7 *Air flow display*
- 8 *Air conditioning on-off button*
- 9 *Passenger side temperature control button*
- 10 *Passenger side temperature display (in degrees Fahrenheit or Centigrade)*
- 11 *Separate/dual control button*
- 12 *Air flow control button*
- 13 *Fan speed control button*
- 14 *OFF button*
- 15 *Automatic control button*

AIR CONDITIONING

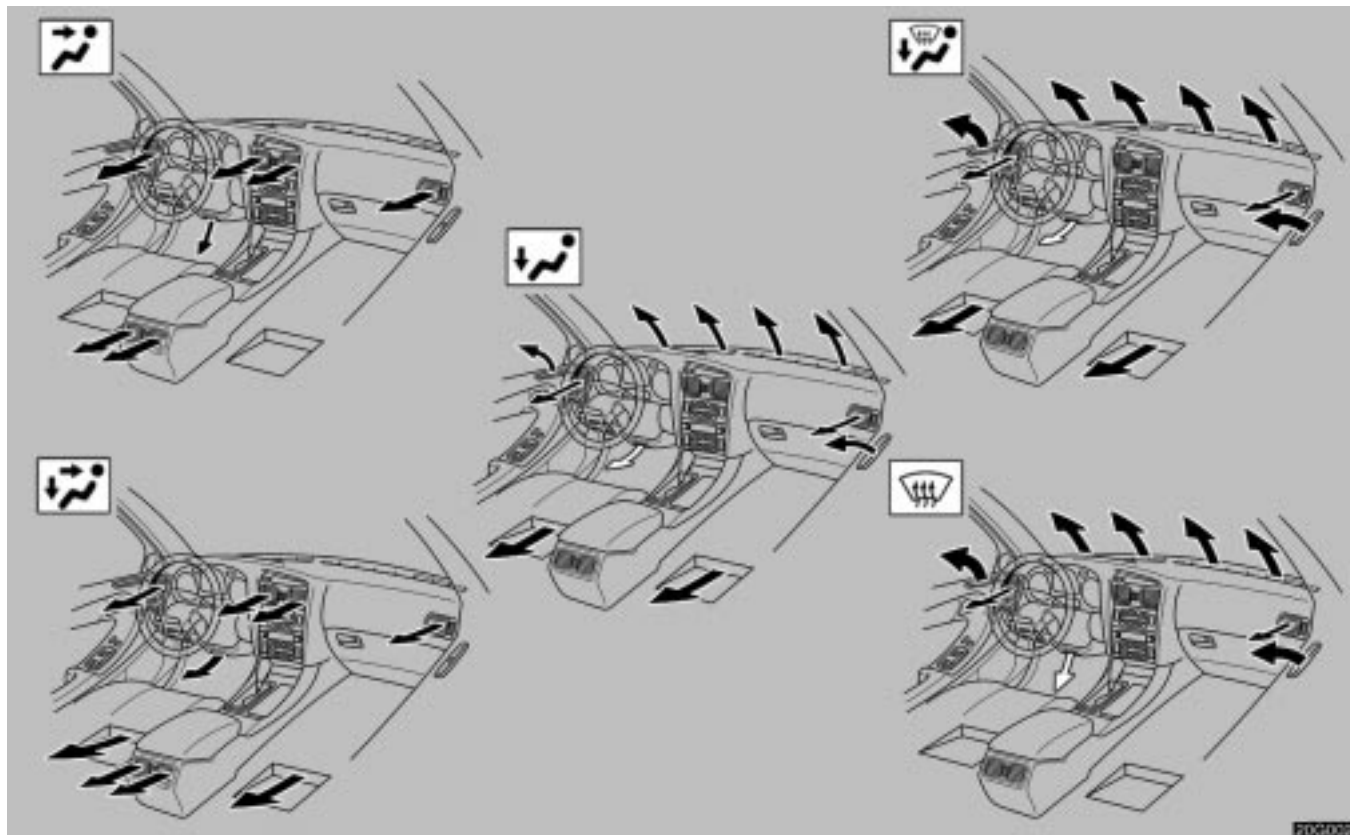

► **Air flow selection**

⇒ See "Lower vents" on page 144.

(a) Climate control

SETTING OPERATION – automatic control

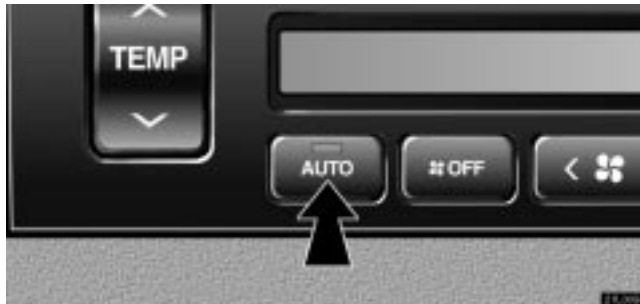

1. Push the "AUTO" button.

Air flow quantity, switching of the diffusers, on–off of the air conditioning, and switching of the air intake between RECIRCULATED AIR and OUTSIDE AIR are automatically adjusted. The operation status is shown by each indicator.

When one of the manual control buttons is depressed while operating in automatic mode, the mode relevant to the depressed button is set. Other conditions continue to be adjusted automatically.

It is recommended to close the lower vent. For details about it, see page 144.

Push the "OFF" button to turn the air conditioning off.



2. Use the "TEMP" or "PASSENGER TEMP" button to set the desired temperature.

The "TEMP" or "PASSENGER TEMP" button is used to set the desired temperature. The temperature will be controlled on the driver and passenger sides simultaneously or individually.

"TEMP" button – Changes the temperature on the driver and passenger sides simultaneously or the driver side only.

"PASSENGER TEMP" button – Changes the temperature on the passenger side only.

"DUAL" button – Changes the mode of the temperature setting.

The indicator on the "DUAL" button has two modes:

- **With the indicator on** – For individual temperature setting
- **With the indicator off** – For simultaneous temperature setting

AIR CONDITIONING

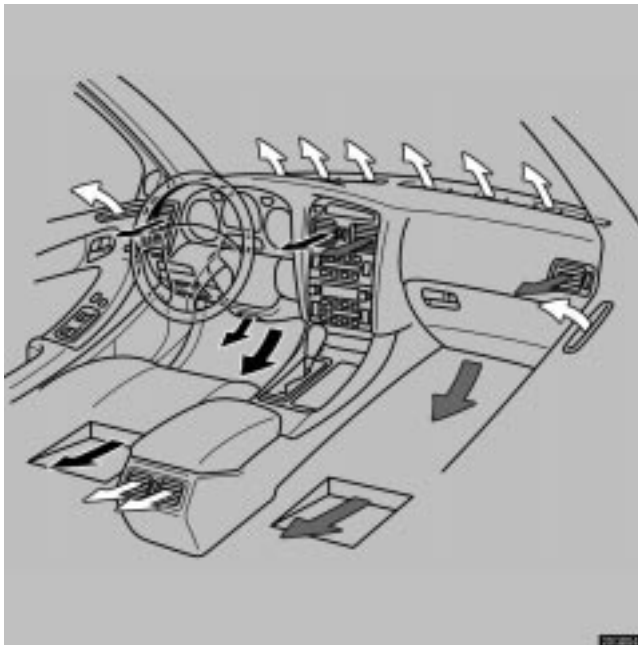

- ➔ Driver side setting
- ➔ Passenger side setting
- ⇄ Mixed setting

SETTING OPERATION – manual control

When one of the manual control buttons is depressed while operating in automatic mode, the mode relevant to the depressed button is set. Other conditions continue to be adjusted automatically.

If manual air flow selection is desired –

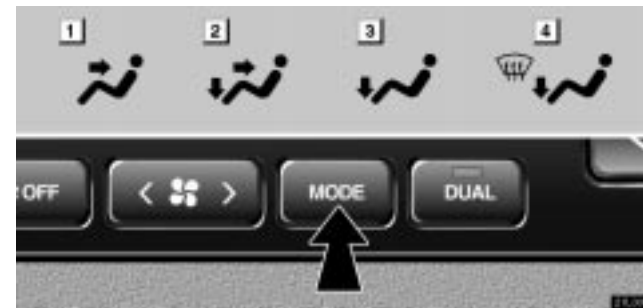

The outlets from which air is delivered can be selected manually by pushing the button. The function of each mode is as follows:

- 1 Panel** – Air flows mainly from the instrument panel vents.
- 2 Bi-level** – Air flows from both the floor vents and the instrument panel vents.
- 3 Floor** – Air flows mainly from the floor vents.

It is recommended to close the lower vent. For details about it, see page 144.

- 4 **Floor/Windshield** – Air flows mainly from the floor vents and windshield vents.

It is recommended to close the lower vent. For details about it, see page 144.

If quick heating or cooling is desired –

Push the "TEMP" or "PASSENGER TEMP" button on either side and hold it until the maximum figure or minimum figure appears on the display.

If manual fan speed control is desired –



- ▶ 1 **Fan speed at low** 2 **Fan speed at high**

The fan speed can be set to your desired speed by pushing the appropriate side of fan speed control button. The higher the fan speed is, the more air is delivered. Pushing the "OFF" button turns off the fan.

To remove exterior windshield frost, use the high speed setting.

If manual switching of air intake is desired –

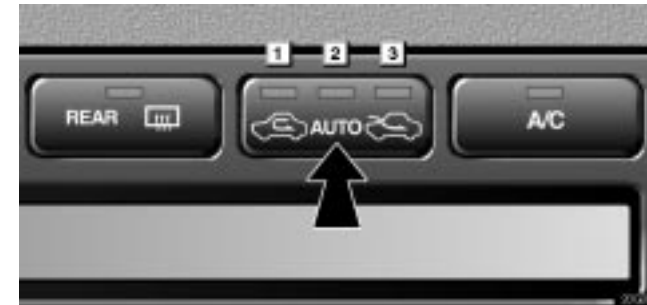

Each time you push the air intake control button, the mode changes in order from the RECIRCULATED AIR mode to AUTOMATIC mode to OUTSIDE AIR mode, then back to the RECIRCULATED AIR mode. Each indicator light shows which mode is now selected.

- 1 **RECIRCULATED mode** – If quick circulation of cooled air is desired, select this mode.
- 2 **EXHAUST GAS AUTOMATIC mode** – If the outside air contains harmful substances like exhaust gas (i.e., when the vehicle running just in front of your vehicle accelerates rapidly), the system changes automatically from the OUTSIDE AIR mode (with indicators 2 and 3 on) to the RECIRCULATED mode (with indicators 1 and 2 on).
- 3 **OUTSIDE AIR mode** – The system will take fresh outside air into the vehicle.

AIR CONDITIONING

Turning off the air conditioning manually will cancel the EXHAUST GAS AUTOMATIC mode. If you select the "AUTO" mode during fan operating, the air conditioning turns on and the EXHAUST GAS AUTOMATIC mode will operate.

For normal use, it is best to keep the air intake control button set to OUTSIDE AIR mode. If recirculated air is used during heating, the windows will fog up more easily.

To change the sensitivity of the sensor switching between the RECIRCULATED and OUTSIDE AIR in the AUTOMATIC mode, push the air intake control button until the "AUTO" indicator light flashes. The display changes as illustrated below.

The sensitivity of the sensor can be adjusted only while the vehicle has stopped.



Each time you push the "TEMP" button, the sensitivity changes from "+3" down to "-3". If you do not operate any button for a few seconds or if you push the button other than the air intake control button and driver side temperature control button, the previous display returns.

If manual on-off of the air conditioning is desired –

Push the "A/C" button to turn the air conditioning on and push it again to turn the air conditioning off. If you turn off the air conditioning manually, the EXHAUST GAS AUTOMATIC mode will be cancelled.

If the outside temperature is lowered down to around 0°C (32°F), the air conditioning will turn off automatically. At this time, the indicator on the A/C button is off and the EXHAUST GAS AUTOMATIC indicator light remains on. However, the EXHAUST GAS AUTOMATIC mode does not operate. When the air conditioning turns on as with the raised temperature, the EXHAUST GAS AUTOMATIC mode resumes.

If the system is used for ventilation, heating in dry weather or removing frost or exterior fog on the windshield, turn the air conditioning off once it is no longer required. This will improve fuel economy. The air conditioning can be used for year-round automatic temperature control including cooling and dehumidifying operation.

If the air conditioning compressor does not operate, the indicator of the "A/C" button will blink. If the indicator of the "A/C" button blinks even when the "A/C" button is pushed again, have the compressor checked by your nearest Lexus dealer.

Displaying the outside temperature –

The temperature display ranges from -30°C (-22°F) up to 50°C (122°F).

(b) Windshield defogging and defrosting



To remove interior fog on the windshield –

Push the "FRONT WINDSHIELD" button.

To remove frost or exterior fog on the windshield –

1. Place the temperature control button at the maximum temperature.
2. Push the "FRONT WINDSHIELD" button.
3. Push the fan speed control button on the right side to obtain a maximum air flow.
4. Leave the air conditioning on-off button off.

For further information for removing frost and fog, see "Lower vent" on page 144.

AIR CONDITIONING

When the "FRONT WINDSHIELD" button is pushed while operating in automatic mode, the air conditioning is set to operate and the OUTSIDE AIR mode is set.

If you push the "FRONT WINDSHIELD" button once again while in the FRONT WINDSHIELD mode, the mode then returns to the last mode used.



CAUTION

Do not use the "FRONT WINDSHIELD" button during cooled air operation in extremely humid weather. The difference between the temperature of the outside air and that of the windshield could cause the outer surface of the windshield to fog up blocking your vision.

(c) Air filter

The air filter may clog after long use and reduce air flow. You can inspect the filter easily.

When you inspect and replace the air filter, be sure to turn off the fan.

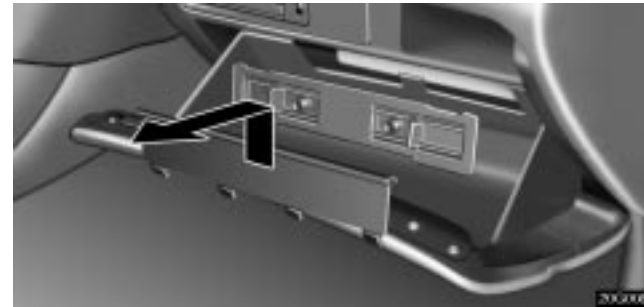

1. Open the glove box and remove the two covers.

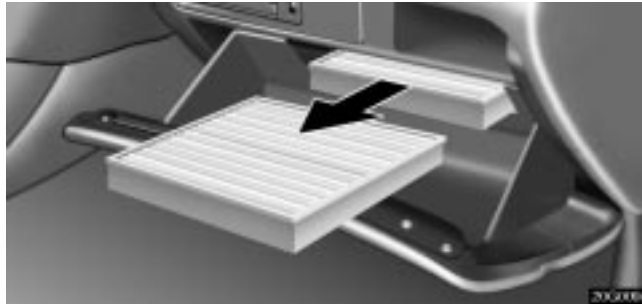

2. Take out the air filter.

If it is dirty, it should be replaced. To maintain the air conditioning efficiency, replace the air filter according to the maintenance schedule. (For scheduled maintenance information, please refer to the "Owner's Manual Supplement / Maintenance Schedule".)

NOTICE

Do not drive with the air filter removed, or the efficiency of air conditioning may be lost.

(d) Operating tips

- Make sure the air inlet grilles in front of the windshield are not blocked by leaves or other obstructions.
- If air flow control is not satisfactory, check the dashboard vents. (See "Center vents", "Side vents", "Lower vent" and "Rear vents".)
- To help cool down the interior after parking in the hot sun, drive for the first few minutes with the windows open. After the excess heat has blown away, close the windows.
- When driving on dusty roads, close all windows. If dust thrown up by the vehicle is still drawn into the vehicle after closing the windows, it is recommended that the air intake control button be left to the OUTSIDE AIR mode and the fan speed control button be pressed to anywhere except the "OFF" button.
- If following another vehicle on a dusty road, or driving in windy and dusty conditions, it is recommended that the air intake control button be temporarily pressed in to the RECIRCULATED AIR mode, which will close off the outside passage and prevent outside air and dust from entering the vehicle interior.

AIR CONDITIONING

Center vents

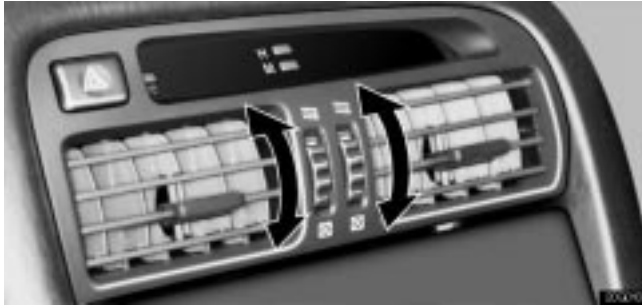

The center vents may be opened or closed as shown.

Side vents



The side vents may be opened or closed as shown.

Lower vent



The lower vent may be opened or closed as shown.

For removing frost or fog, it is recommended to close the lower vent when you push the “FRONT WINDSHIELD” button or use the “Floor” or the “Floor/Windshield” mode.

Rear vents



The rear vents may be opened or closed as shown.

