

BODY DIMENSION DRAWINGS

ENGINE COMPARTMENT

(Three-Dimensional Distance)

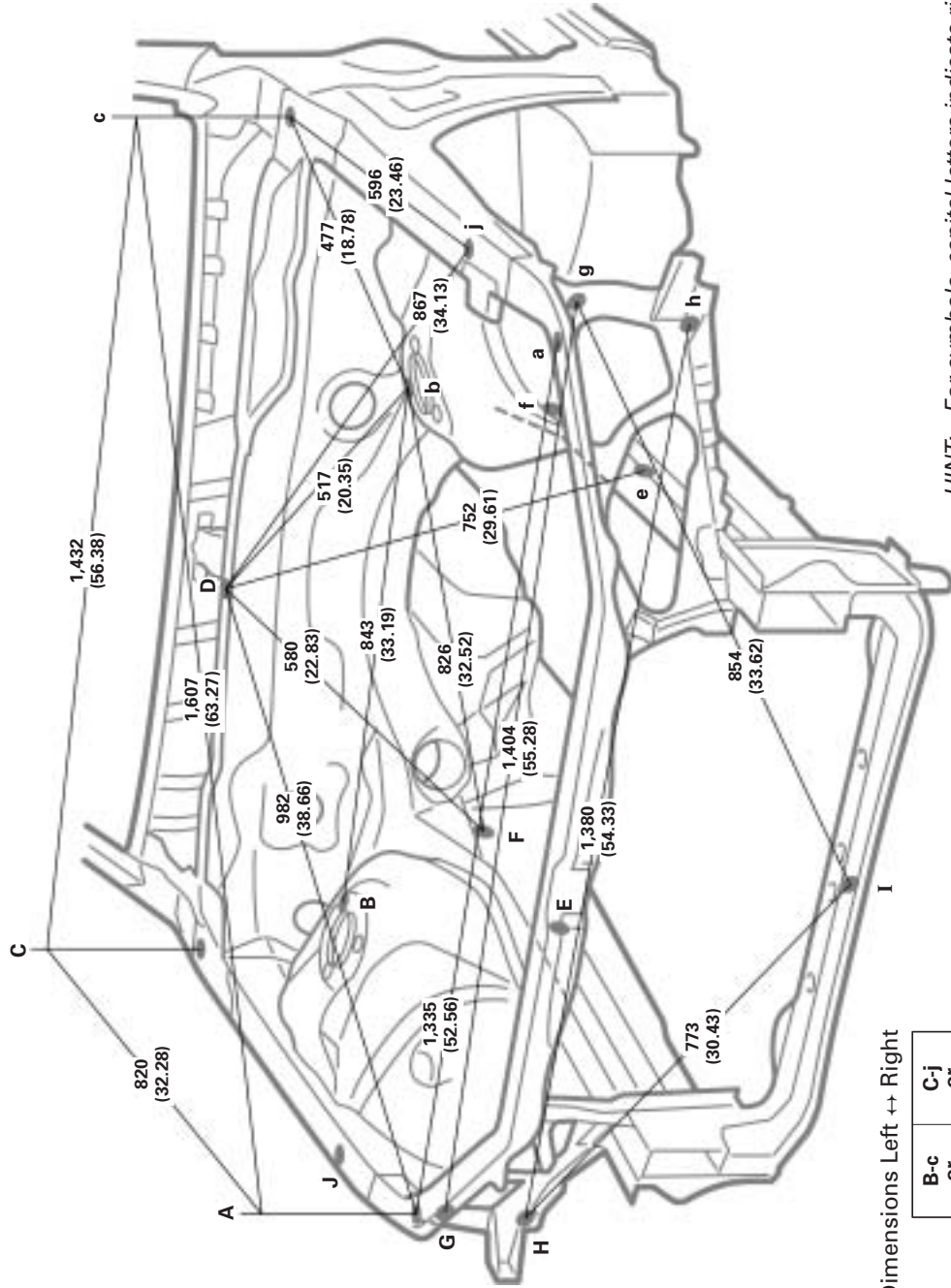

HINT: For symbols, capital letters indicate right side of vehicle, small letters indicate left side of vehicle (Seen from rear).

Vehicle Dimensions Left ↔ Right

J-j	C-j or b-C
1,420 (55.91)	1,545 (60.83)

B-c or b-C	C-j or c-J
1,198 (47.17)	1,545 (60.83)

Symbol	Name	Hole dia.	Symbol	Name	Hole dia.
A, a	Front fender installation nut	6 (0.24) nut	F, f	Front side member working hole	18 (0.71)
B, b	Front spring support hole-inner	12 (0.47)	G, g	Radiator support standard hole	10 (0.39)
C, c	Front fender installation nut	6 (0.24) nut	H, h	Radiator support standard hole	10 (0.39)
D	Cowl top panel center mark	1 (0.04) R	I	Hood lock support installation nut	6 (0.24) nut
E, e	Front side member working hole	13 (0.51)	J, j	Front fender apron standard hole	16 (0.63)

mm (in.)

BODY OPENING AREAS (Side View: Front)

(Three-Dimensional Distance)

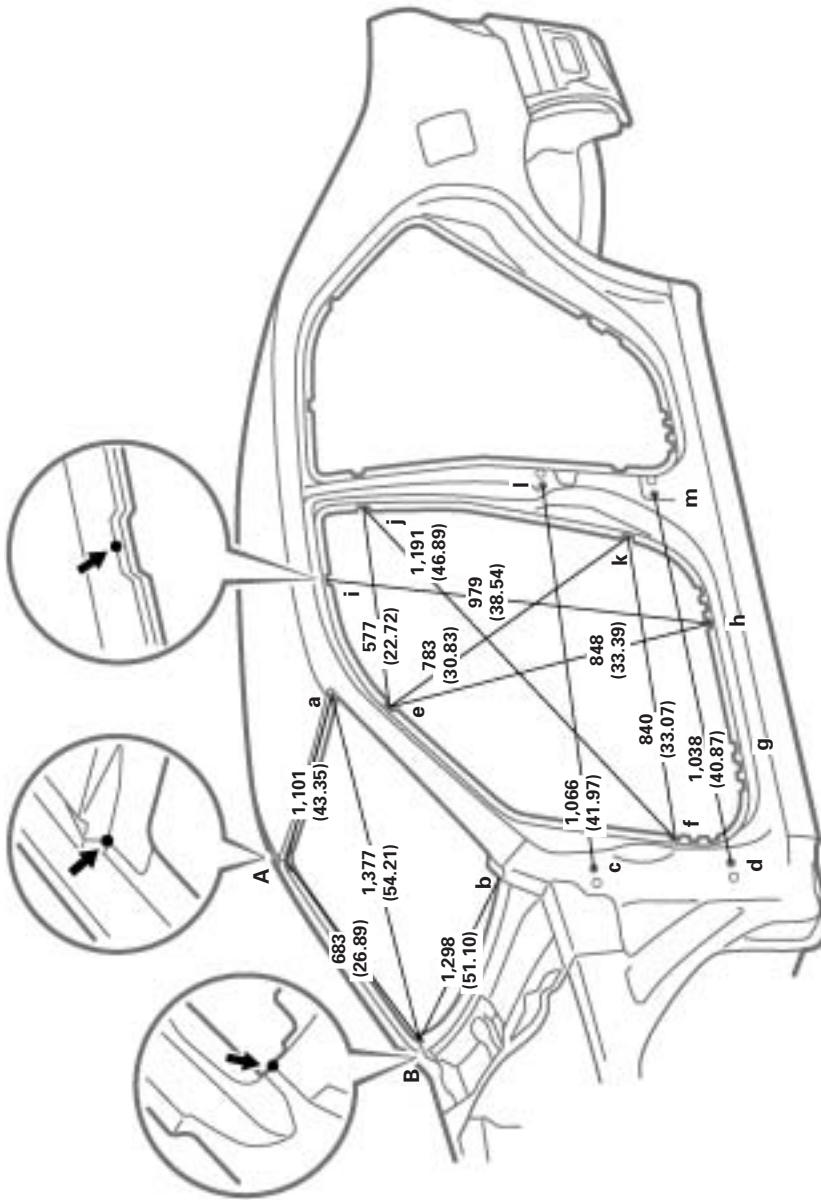

HINT: For symbols, capital letters indicate right side of vehicle, small letters indicate left side of vehicle (Seen from rear).

Vehicle Dimensions Left ↔ Right

E-e	F-f	G-g	H-h	I-i	J-j	K-k
1,207 (47.52)	1,438 (56.61)	1,450 (57.09)	1,450 (57.09)	1,097 (43.19)	1,214 (47.80)	1,432 (56.38)

E-f or e-F	E-j or e-J	F-j or f-J	F-k or f-K	H-i or h-I	J-k or j-K
1,522 (59.92)	1,341 (52.80)	1,779 (70.04)	1,663 (65.47)	1,597 (62.87)	1,490 (58.66)

mm (in.)

Symbol	Name	Hole dia.	Symbol	Name	Hole dia.
A, a	Roof panel/Front body pillar adjoining portion	—	H, h	Rocker panel assembly mark	—
B, b	Cowl panel/Front body pillar adjoining portion	—	I, i	Roof side rail assembly mark	—
C, c	Front door hinge installation nut	8 (0.31) nut	J, j	Center body pillar assembly mark	—
D, d	Front door hinge installation nut	8 (0.31) nut	K, k	Center body pillar assembly mark	—
E, e	Front body pillar assembly mark	—	L, l	Rear door hinge installation hole	13 (0.51)
F, f	Front body pillar assembly mark	—	M, m	Rear door hinge installation hole	13 (0.51)
G, g	Rocker panel assembly mark	—	—	—	—

BODY OPENING AREAS (Side View: Rear)

(Three-Dimensional Distance)

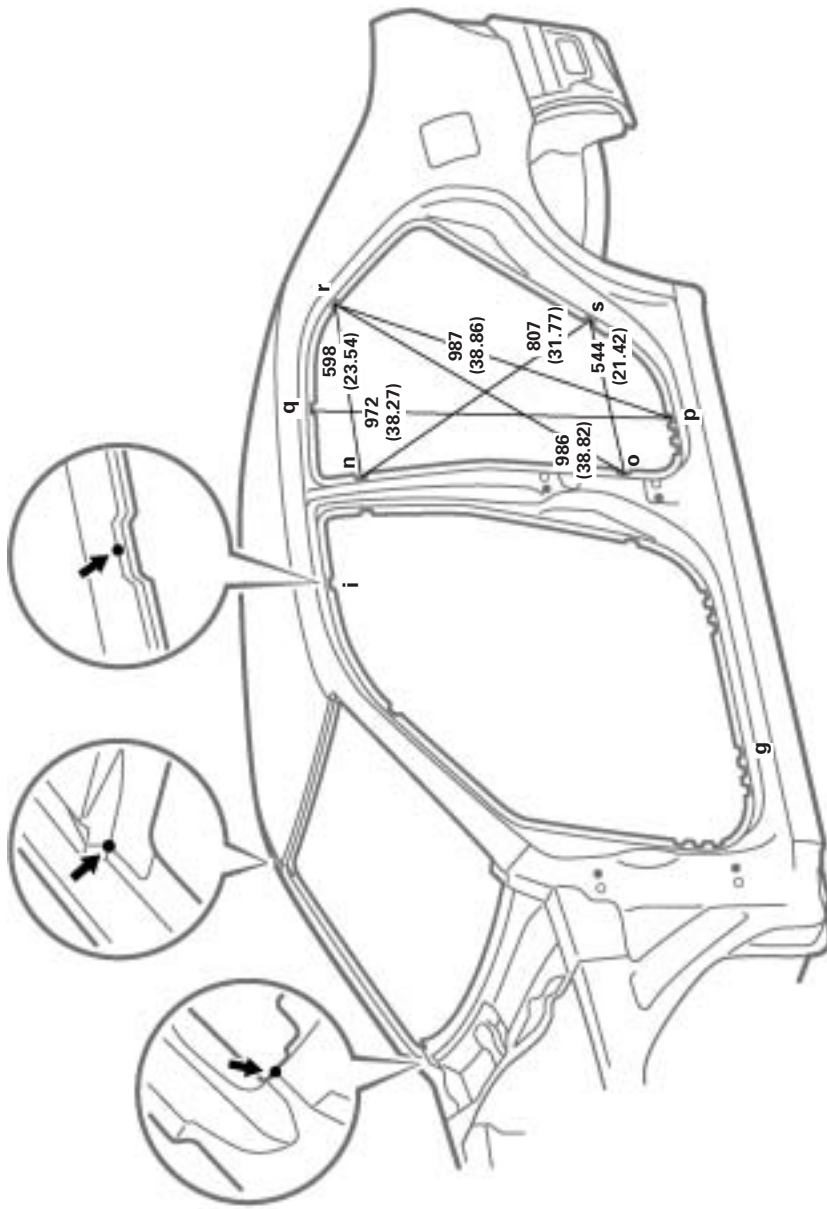

HINT: For symbols, capital letters indicate right side of vehicle, small letters indicate left side of vehicle (Seen from rear).

Vehicle Dimensions Left ↔ Right

N-n	O-o	P-p	Q-q	R-r	S-s
1,228 (48.35)	1,434 (56.46)	1,450 (57.09)	1,098 (43.23)	1,184 (46.61)	1,433 (56.42)

G-p or g-P	I-q or i-Q	N-r or n-R	O-s or o-S	P-q or p-Q	R-s or r-S
1,768 (69.61)	1,229 (48.39)	1,346 (52.99)	1,533 (60.35)	1,593 (62.72)	1,484 (58.43)

mm (in.)

Symbol	Name	Symbol	Name	Hole dia.	Hole dia.
G, g	Rocker panel assembly mark	P, p	Rocker panel assembly mark	—	—
I, i	Roof side rail assembly mark	O, o	Roof side rail assembly mark	—	—
N, n	Center body pillar assembly mark	R, r	Quarter panel assembly mark	—	—
O, o	Center body pillar assembly mark	S, s	Quarter panel assembly mark	—	—

BODY OPENING AREAS (Rear View)

(Three-Dimensional Distance)

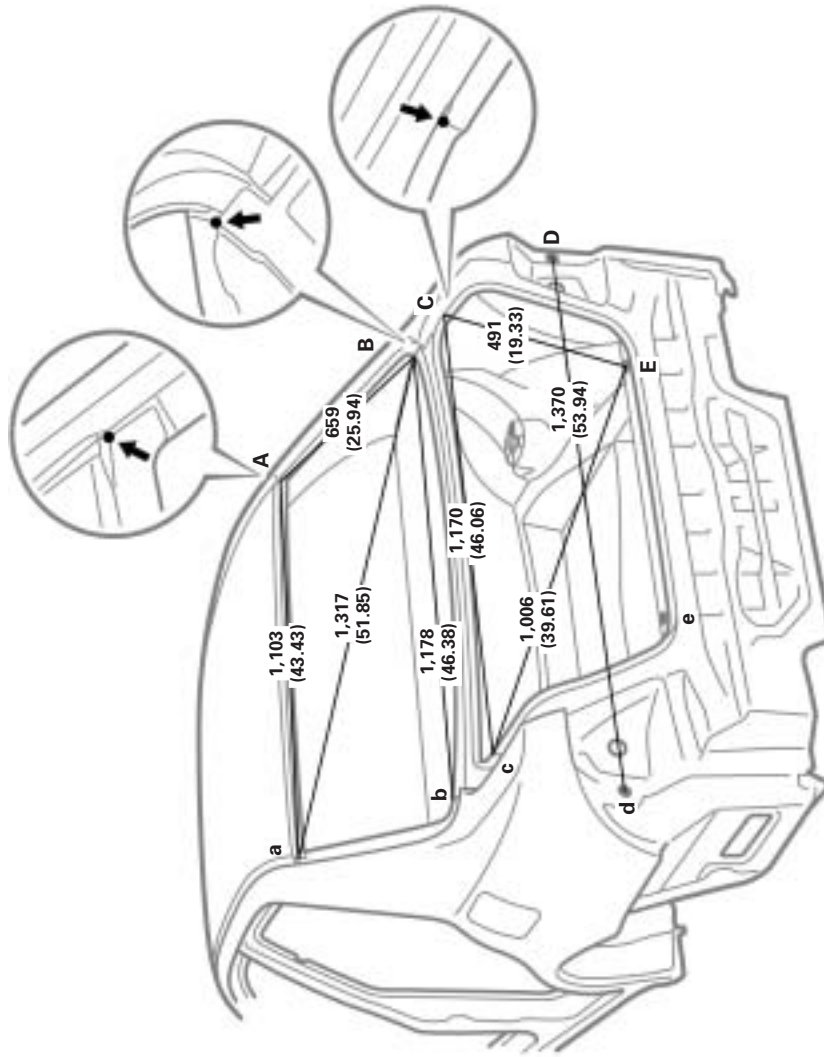

HINT: For symbols, capital letters indicate right side of vehicle, small letters indicate left side of vehicle (Seen from rear).

Symbol	Name	Hole dia.	Symbol	Name	Hole dia.
A, a	Roof panel/Quarter panel adjoining portion	—	D, d	Quarter panel standard hole	10 (0.39)
B, b	Upper back panel/Quarter panel adjoining portion	—	E, e	Rear floor finish plate installation hole	9 (0.35)
C, c	Quarter panel/Upper back panel adjoining portion	—	—	—	—

mm (in.)

UNDER BODY

(Three-Dimensional Distance)

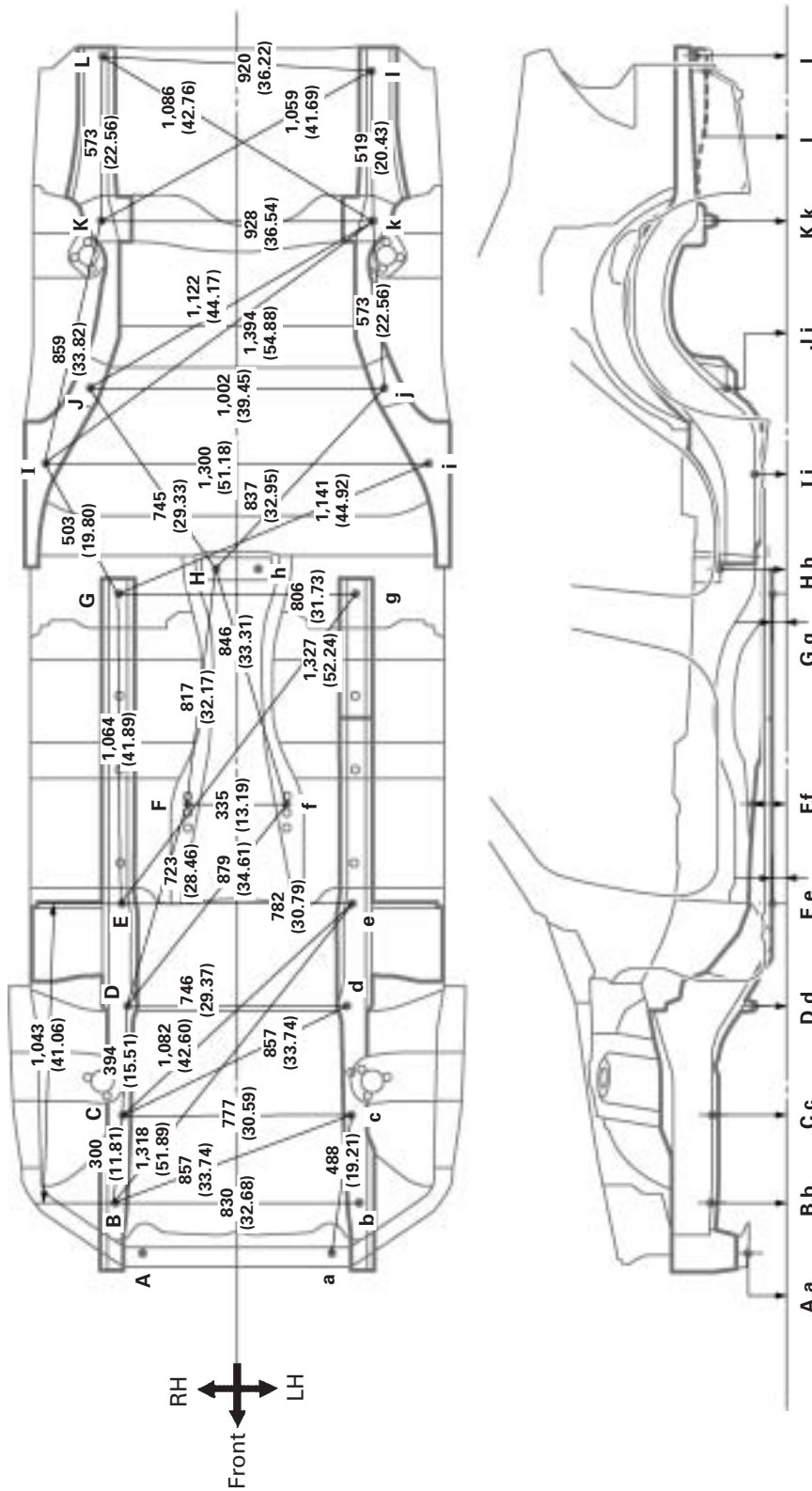

mm (in.)

Symbol	Name	Hole dia.	Symbol	Name	Hole dia.
A, a	Front crossmember standard hole	10 (0.39)	H, h	Drive shaft center support bearing installation nut	10 (0.39) nut
B, b	Front side member standard hole	25 (0.98)	I, i	Rear floor side member standard hole	25 (0.98)
C, c	Front suspension crossmember installation nut	14 (0.55) nut	J, j	Rear suspension member installation nut	14 (0.55) nut
D, d	Strut bar bracket installation nut	12 (0.47) nut	K, k	Rear suspension member installation nut	14 (0.55) nut
E, e	Front side member standard hole	25 (0.98)	L	Exhaust pipe installation bolt	8 (0.31) bolt
F, f	Engine mounting member bracket standard hole	10 (0.39)	I	Transport hook installation nut	12 (0.47) nut
G, g	Front floor under reinforcement standard hole	18 (0.71)	—	—	—

UNDER BODY (Cont'd)

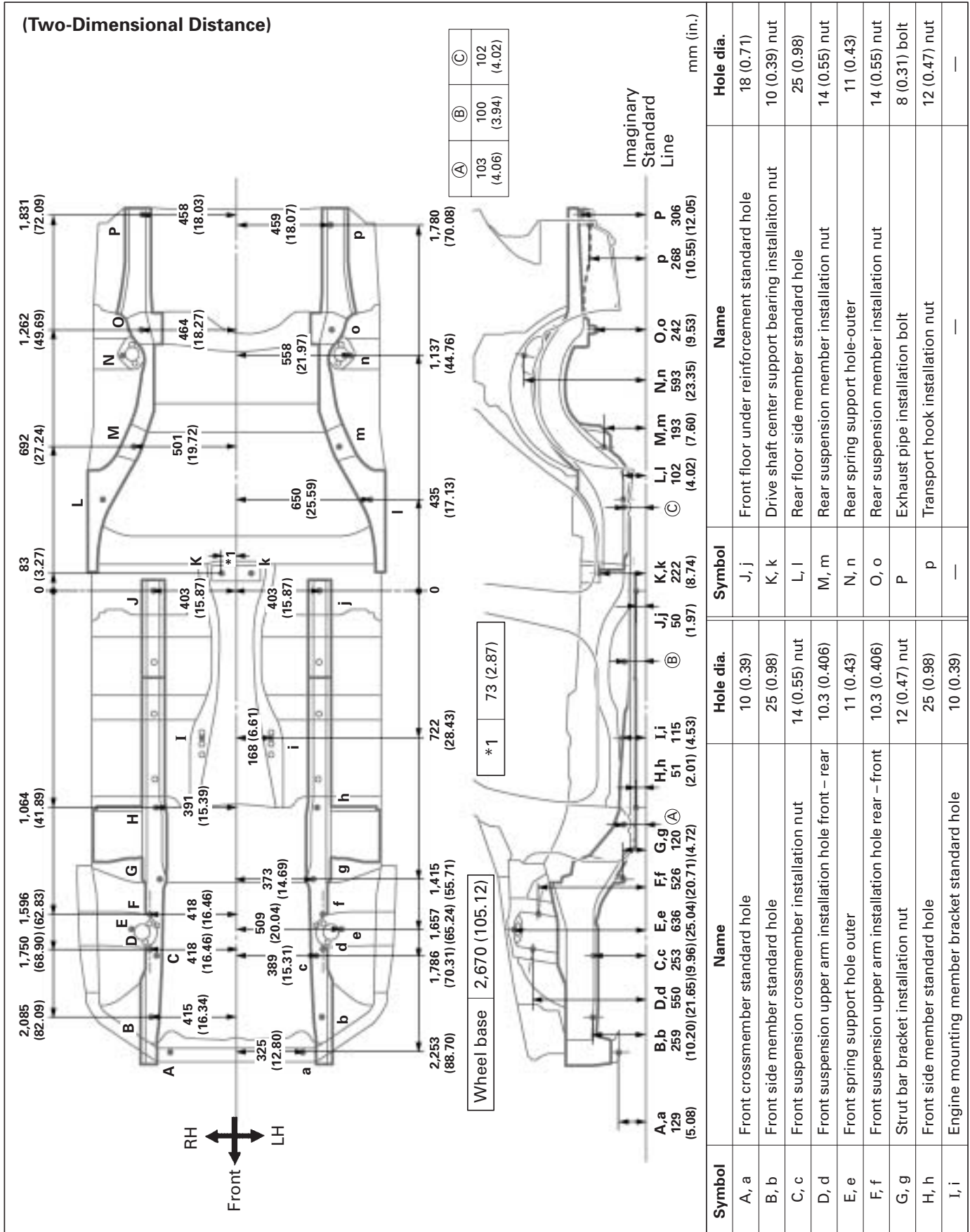

FRONT SUSPENSION CROSSMEMBER (LHD)

(Three-Dimensional Distance)

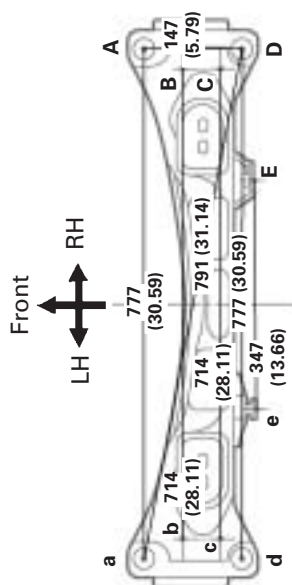

(Two-Dimensional Distance)

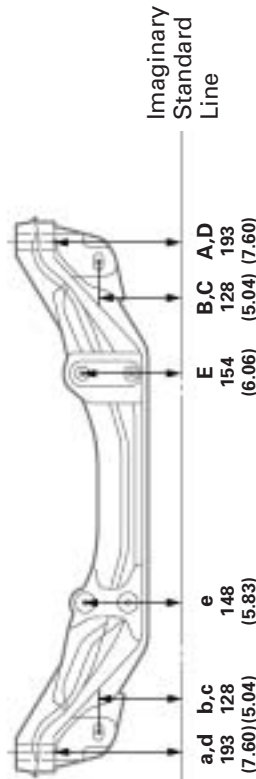
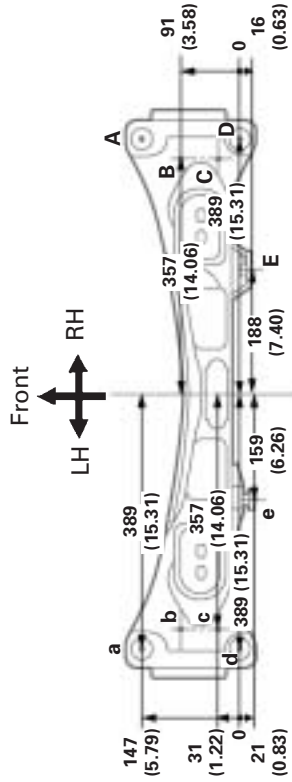

Symbol	Name	Hole dia.	Symbol	Name	Hole dia.
A, a	Front suspension crossmember installation hole-lower	18 (0.71)	D, d	Front suspension crossmember installation hole-lower	18 (0.71)
B, b	Lower arm installation hole-front	26.5 (1.043) x 14.5 (0.571)	E, e	Steering gear box installation nut	10 (0.39) nut
C, c	Lower arm installation hole-rear	26.5 (1.043) x 14.5 (0.571)	—	—	—

mm (in.)

FRONT SUSPENSION CROSSMEMBER (RHD)

(Two-Dimensional Distance)

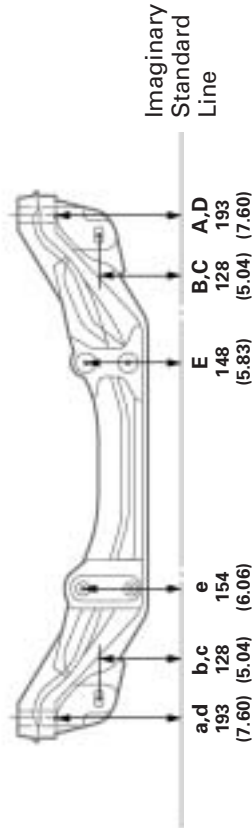
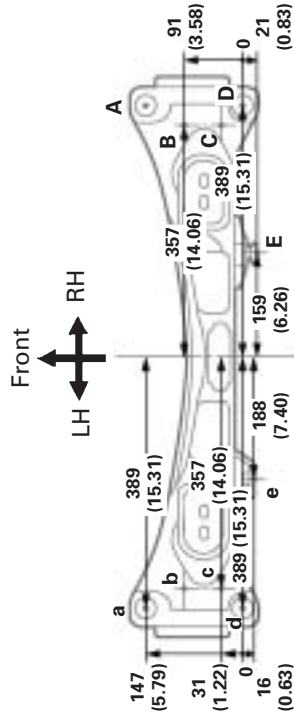

(Three-Dimensional Distance)

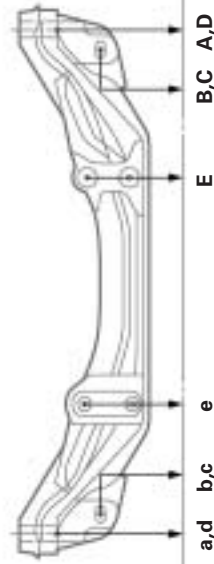
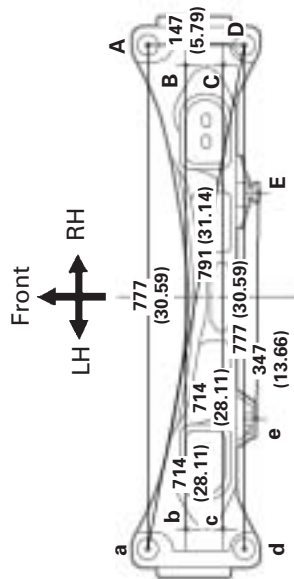

Symbol	Name	Hole dia.	Symbol	Name	Hole dia.
A, a	Front suspension crossmember installation hole-lower	18 (0.71)	D, d	Front suspension crossmember installation hole-lower	18 (0.71)
B, b	Lower arm installation hole-front	26.5 (1.043) x 14.5 (0.571)	E, e	Steering gear box installation nut	10 (0.39) nut
C, c	Lower arm installation hole-rear	26.5 (1.043) x 14.5 (0.571)	—	—	—

mm (in.)

REAR SUSPENSION MEMBER

(Three-Dimensional Distance)

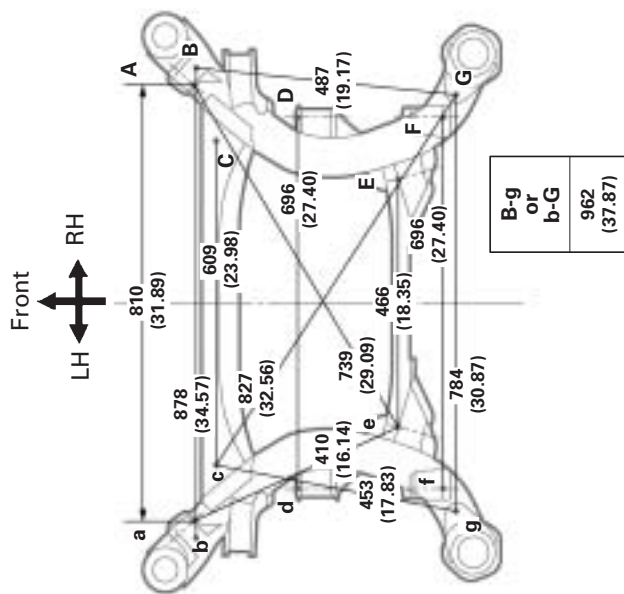

(Two-Dimensional Distance)

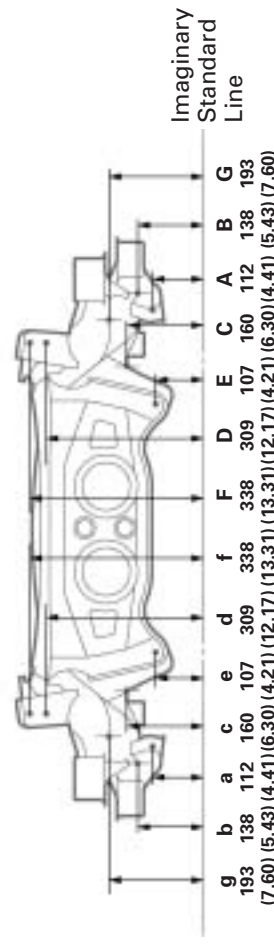
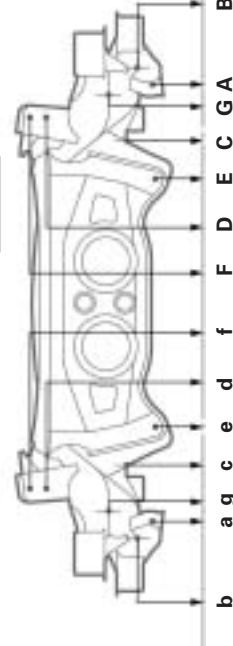
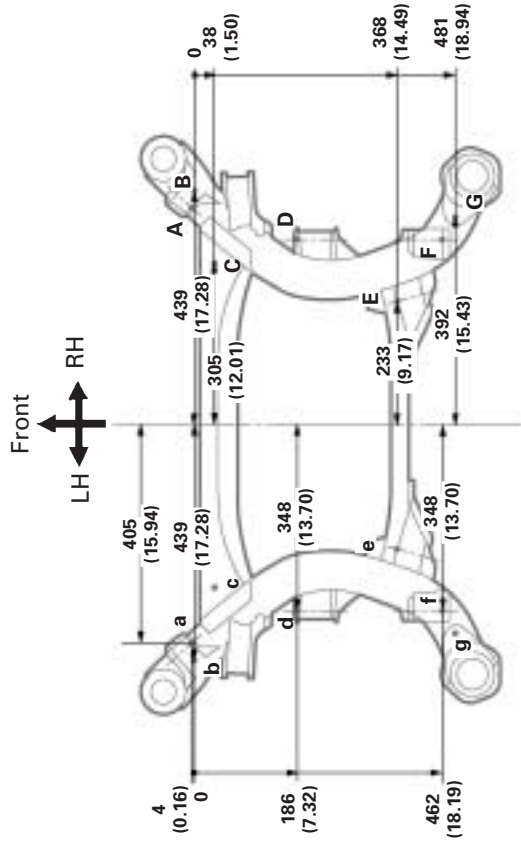

Symbol	Name	Hole dia.	Symbol	Name	Hole dia.
A, a	Lower arm installation hole-rear	12.2 (0.480)	E, e	Lower arm installation hole-front	14.2 (0.559)
B, b	Rear suspension member standard hole	15 (0.59)	F, f	Upper arm installation hole-rear	12.2 (0.480)
C, c	Rear suspension member standard hole	15 (0.59)	G, g	Rear suspension member standard hole	15 (0.59)
D, d	Upper arm installation hole-front	12.2 (0.480)	—	—	—

mm (in.)