

# HOW TO USE THIS MANUAL

Each repair method description provided in Section RE of this manual comprises two pages, divided into 2 blocks (REMOVAL AND INSTALLATION) and includes illustrations to facilitate body repair.

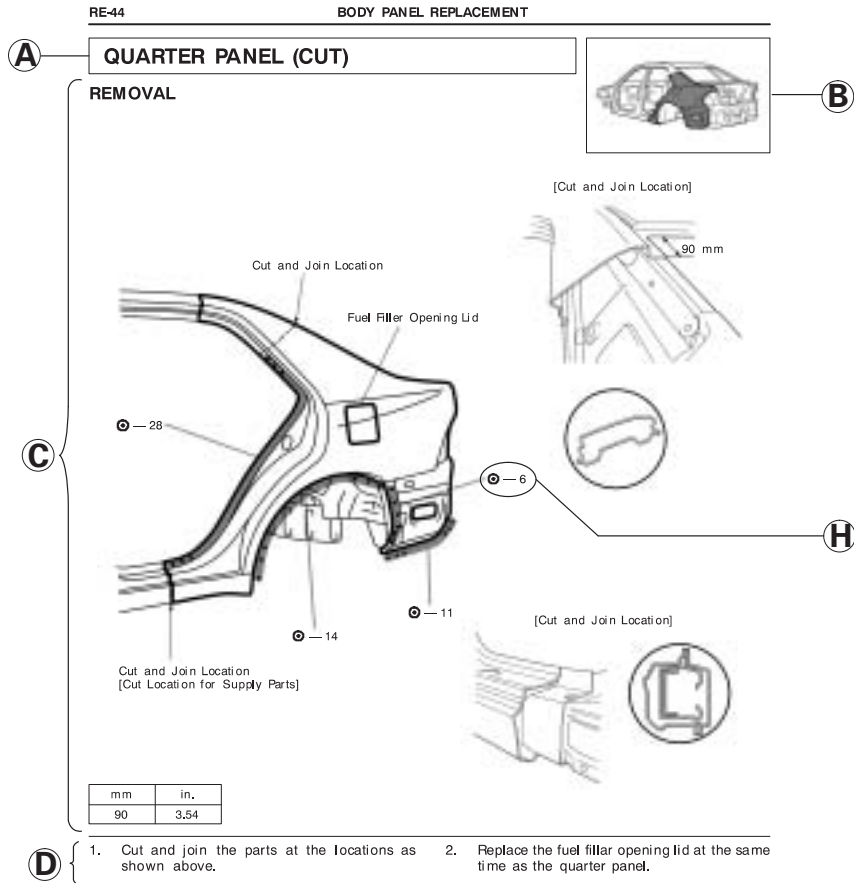

**A** : **REPLACEMENT PARTS AND METHOD**

**QUARTER PANEL (CUT)**

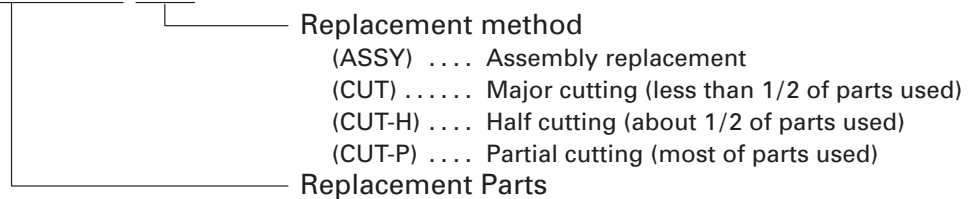

**B** : **PARTS LOCATION**

**C** : **REMOVAL DIAGRAM**

Describes in detail removal of the damaged parts involving repair by cutting.

**D** : **REMOVAL GUIDE**

Provides additional information to more efficiently help you perform the removal.

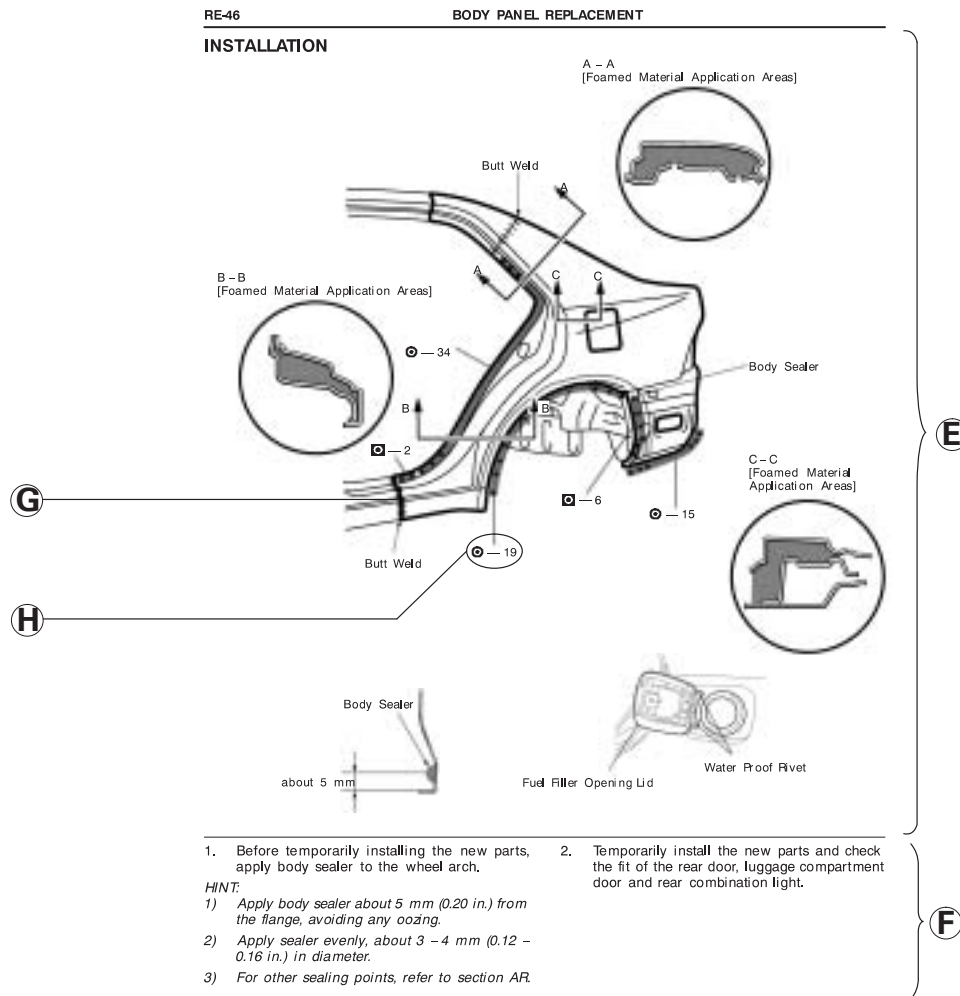

**E : INSTALLATION DIAGRAM**

Describes in detail installation of the new parts involving repair by welding and/or cutting, but excluding painting.

**F : INSTALLATION GUIDE**

Provides additional information to more efficiently help you perform the installation.

**G : SYMBOLS**

See page IN-4.

**H : ILLUSTRATION OF WELD POINTS**

Weld method and panel position symbols.

See page IN-5.