

## QUARTER PANEL (CUT)

### REMOVAL

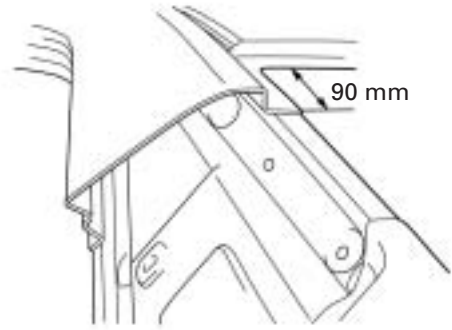

[Cut and Join Location]

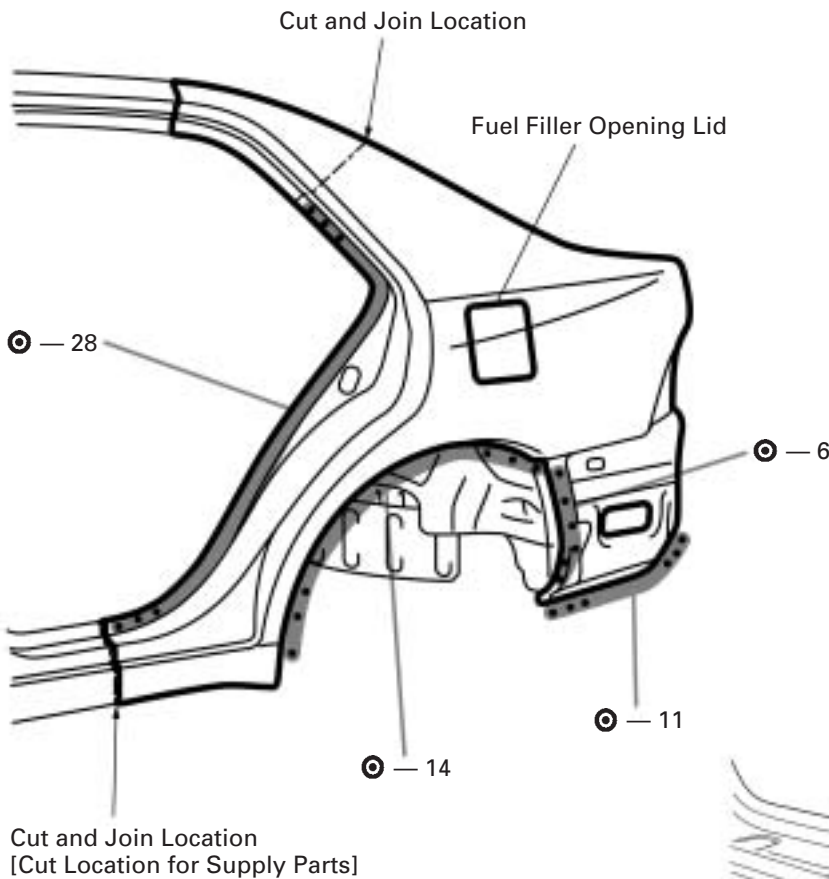

[Cut and Join Location]

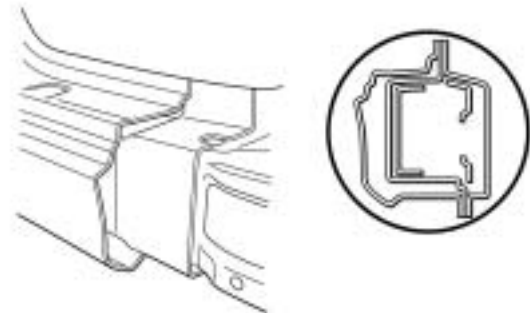

mm	in.
90	3.54

1. Cut and join the parts at the locations as shown above.
2. Replace the fuel filler opening lid at the same time as the quarter panel.

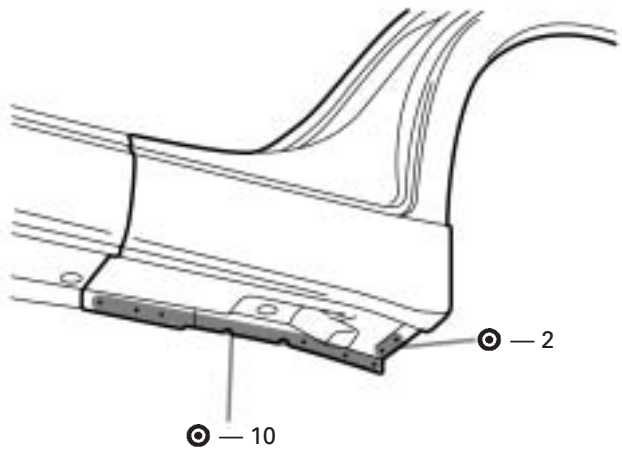
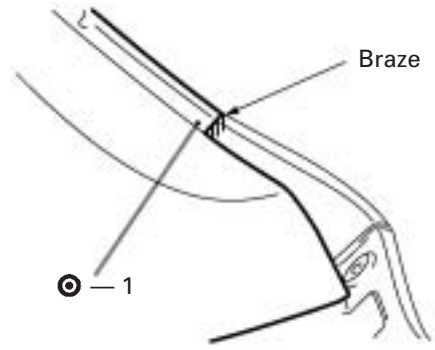
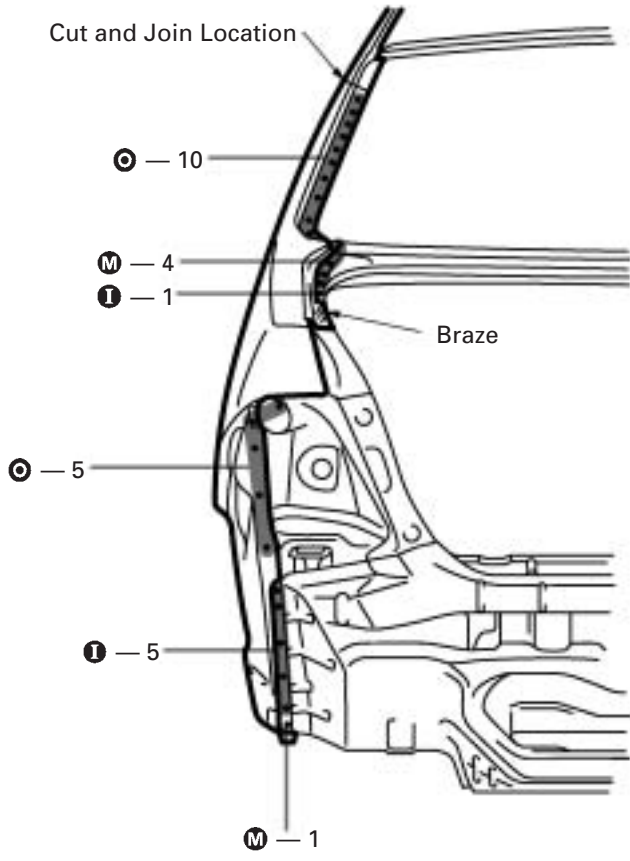

## INSTALLATION

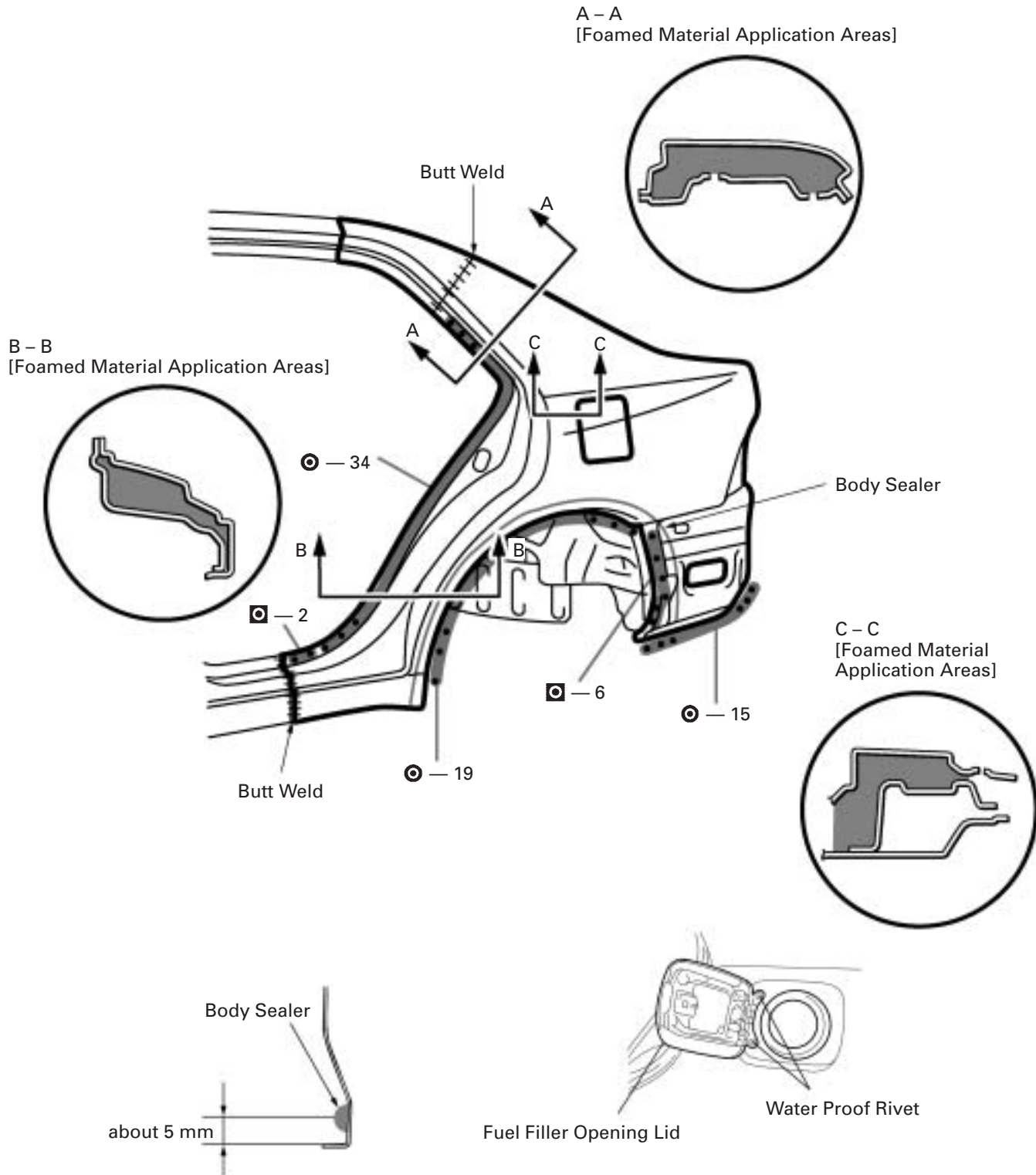

1. Before temporarily installing the new parts, apply body sealer to the wheel arch.

**HINT:**

- 1) Apply body sealer about 5 mm (0.20 in.) from the flange, avoiding any oozing.
- 2) Apply sealer evenly, about 3 – 4 mm (0.12 – 0.16 in.) in diameter.
- 3) For other sealing points, refer to section AR.

2. Temporarily install the new parts and check the fit of the rear door, luggage compartment door and rear combination light.

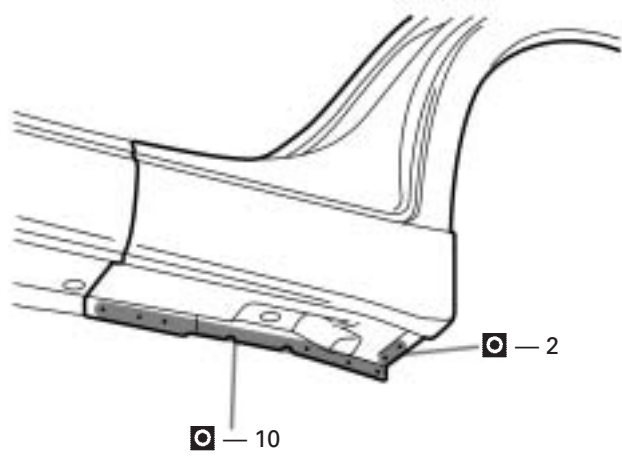
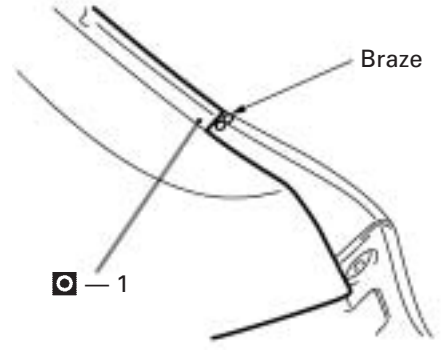
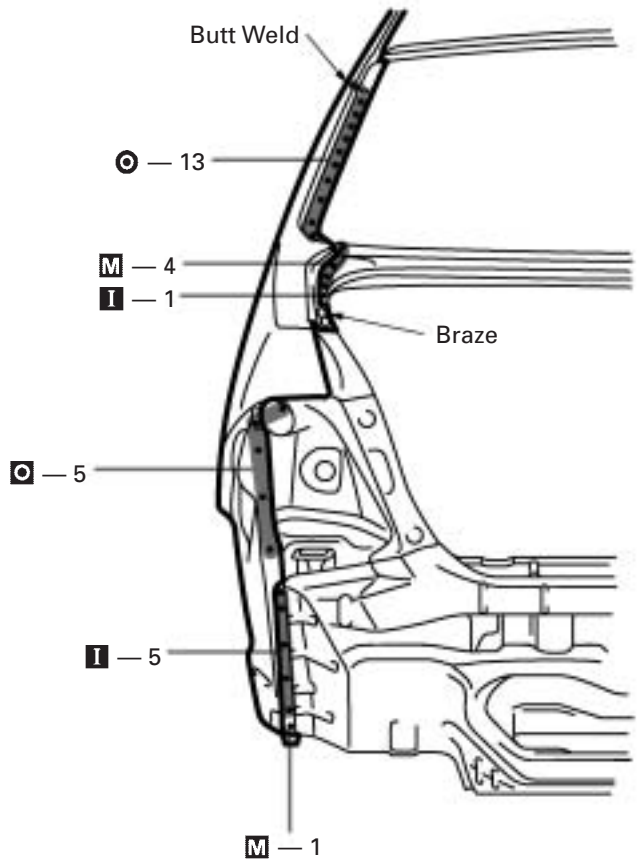

3. Attach the fuel filler opening lid by rivets to the quarter panel.

**HINT:**

- 1) Use waterproof rivets.
- 2) Refer to the introduction when installaiton rivets.

4. After installing the new parts, apply foamed materials.