

REAR FLOOR SIDE REAR MEMBER (ASSY)

REMOVAL (With the body lower back panel removed.)

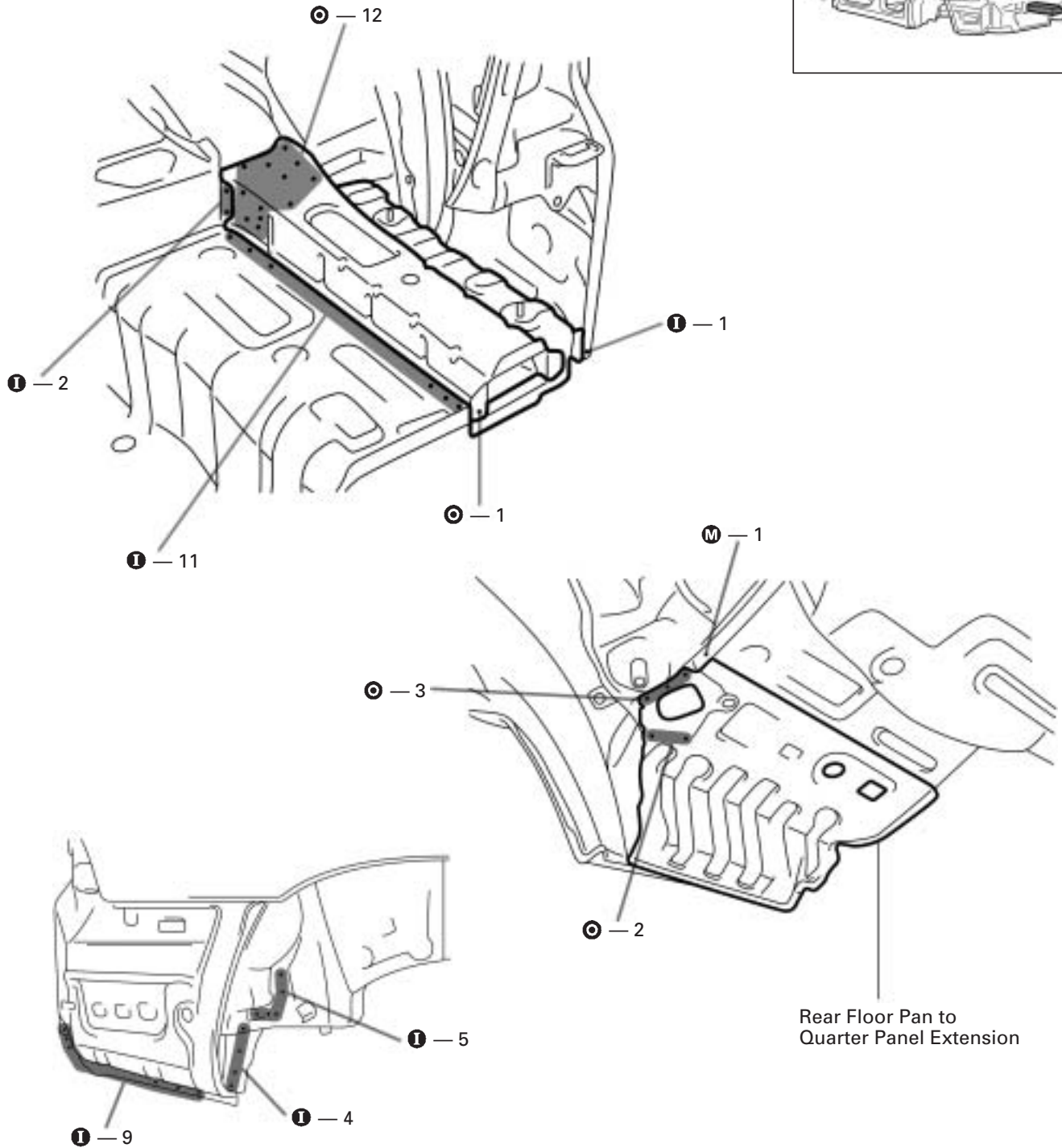
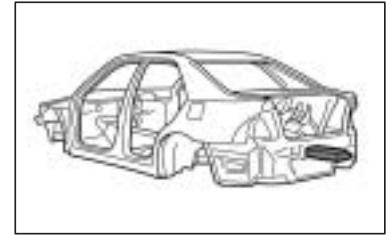

1. Replace the rear floor pan to quarter panel extension at the same time as the rear floor side rear member.

INSTALLATION

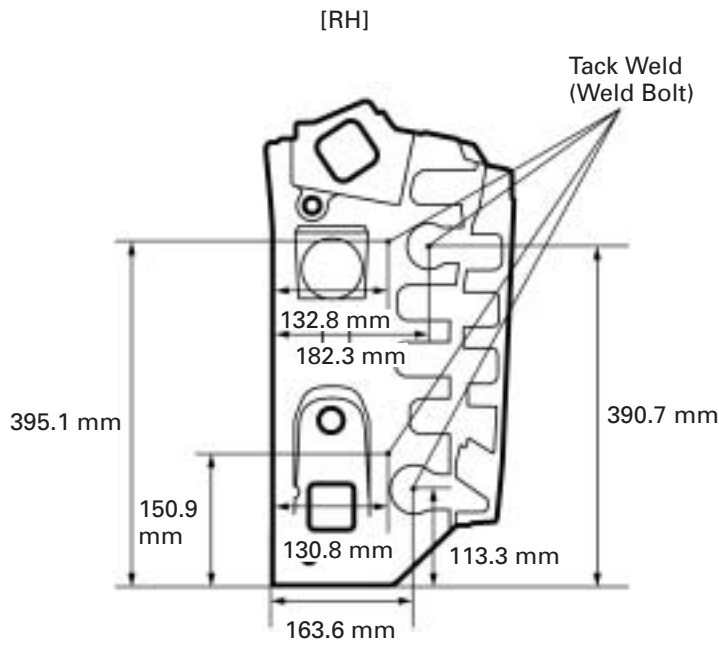
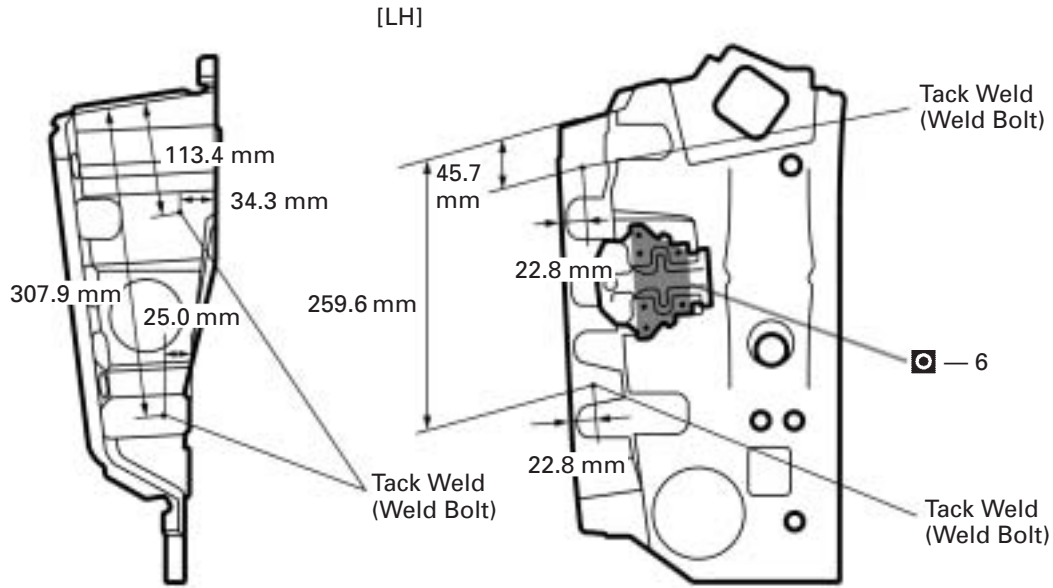

mm	in.
22.8	0.898
25.0	0.984
34.3	1.350
45.7	1.799
113.3	4.461
113.4	4.465
130.8	5.150
132.8	5.228
150.9	5.941
163.6	6.441
182.3	7.177
259.6	10.220
307.9	12.122
390.7	15.382
395.1	15.555

1. Install the weld bolt at the location shown above.
2. Before welding the weld bolts, check the fit of the aerodynamic parts.

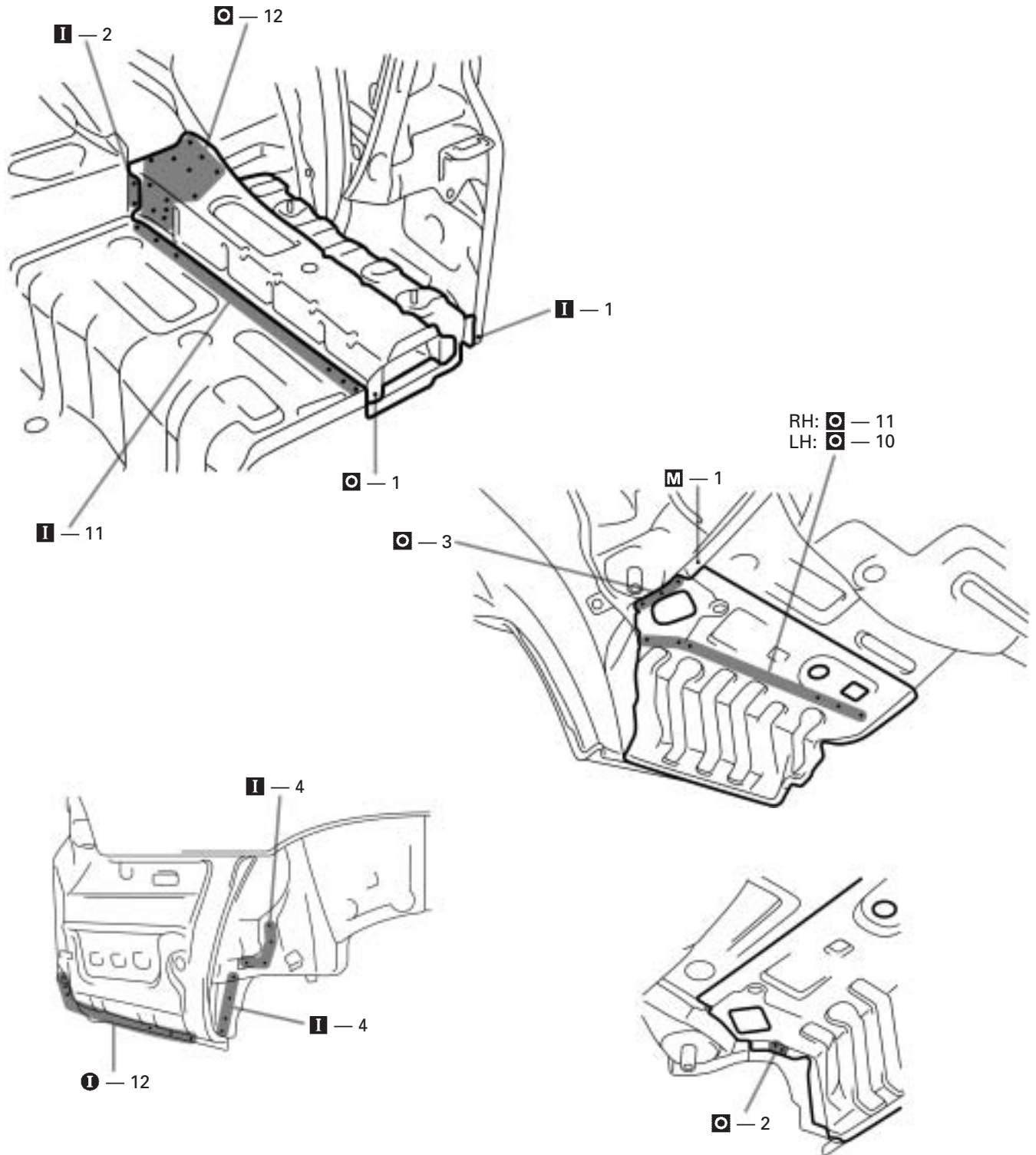

3. Temporarily install the new parts and measure each part in accordance with the body dimension diagram.
4. After welding the rear floor side rear member, install the rear floor pan to quarter panel extension.