

E ELECTRICAL WIRING ROUTING

Position of Parts in Instrument Panel

[LHD]

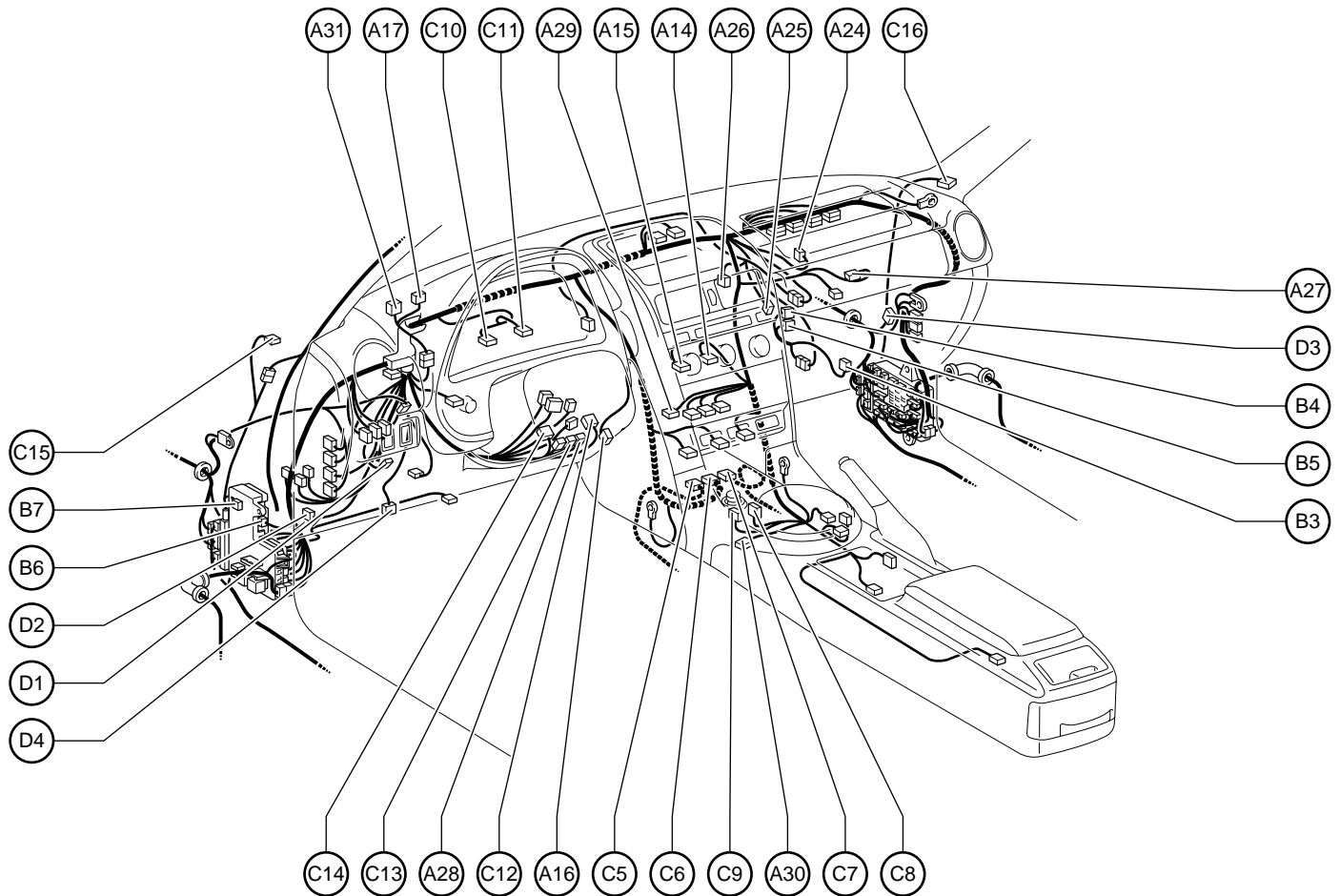

- A 14 A/C Control Assembly
- A 15 A/C Control Assembly
- A 16 A/C Room Temp. Sensor
- A 17 A/C Solar Sensor
- A 24 Air Inlet Control Servo Motor
- A 25 Air Mix Control Servo Motor
- A 26 Air Vent Mode Control Servo Motor
- A 27 Airbag Squib (Front Passenger Airbag Assembly)
- A 28 Airbag Squib (Steering Wheel Pad)
- A 29 Antenna Amplifier
- A 30 Ashtray Illumination
- A 31 Automatic Light Control Sensor

- C 5 Center Airbag Sensor Assembly
- C 6 Center Airbag Sensor Assembly
- C 7 Center Airbag Sensor Assembly
- C 8 Cigarette Lighter
- C 9 Cigarette Lighter Illumination
- C 10 Combination Meter
- C 11 Combination Meter
- C 12 Combination SW
- C 13 Combination SW
- C 14 Combination SW
- C 15 Curtain Shield Airbag Squib LH
- C 16 Curtain Shield Airbag Squib RH

- B 3 Blower Motor
- B 4 Blower Motor Controller
- B 5 Blower Motor Controller
- B 6 Body ECU
- B 7 Body ECU

- D 1 Daytime Running Light Relay Short Connector
- D 2 Double Locking ECU
- D 3 Diode (A/C)
- D 4 DLC3