

Kick-down Switch Circuit (LHD)

CIRCUIT DESCRIPTION

The kick-down switch is turned ON when the accelerator pedal is depressed to the full throttle and sends signals to Engine and ECT ECU.

When the kick-down switch is turned ON, the Engine and ECT ECU controls gear shifting according to the programmed shift diagrams.

If a short circuit develops in the kick-down switch, the Engine and ECT ECU disregards the kick-down signals and controls shifting at the normal shift points.

WIRING DIAGRAM

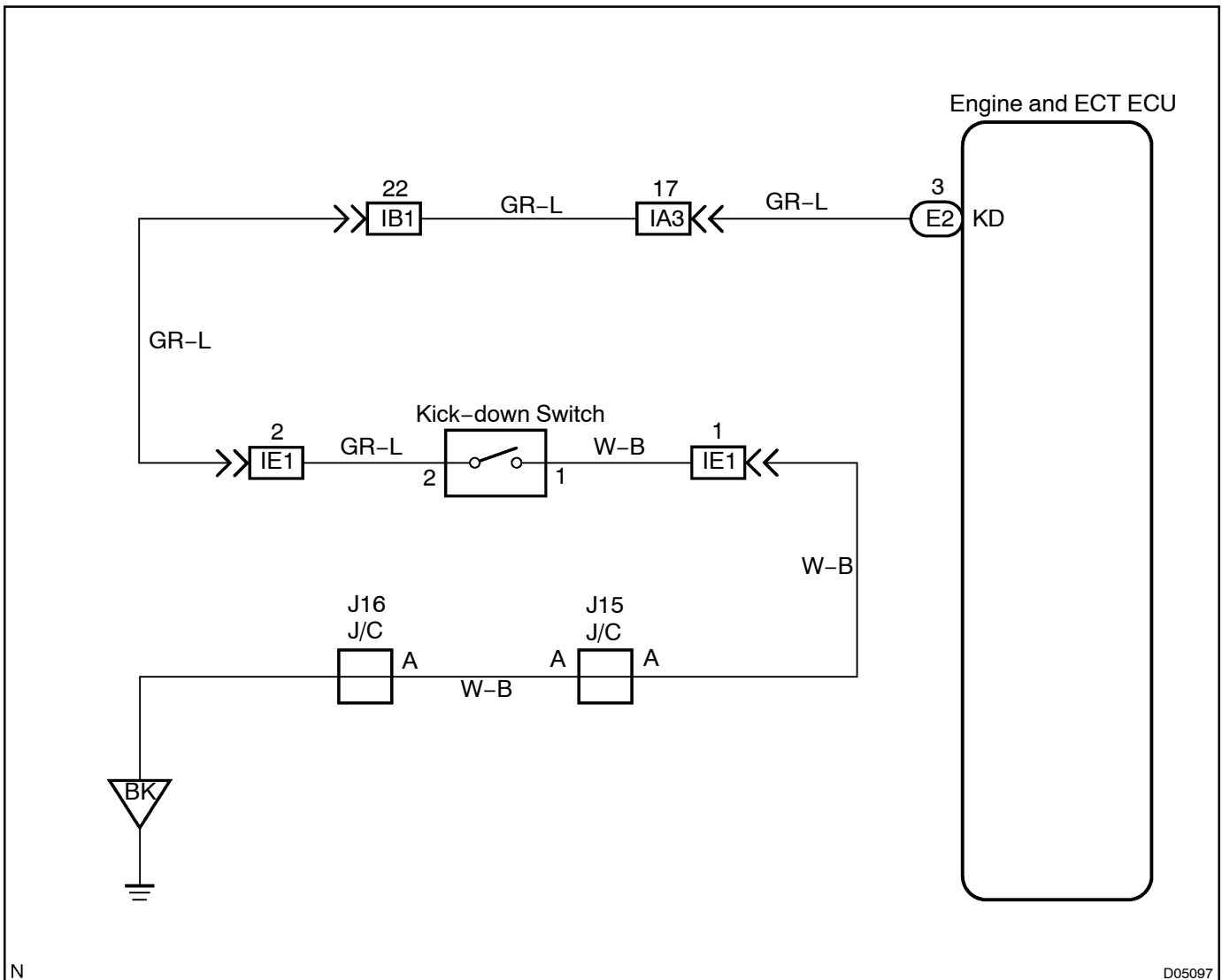

N

D05097

INSPECTION PROCEDURE

1 Check KICKDOWN SW signal.

When using hand-held tester:

PREPARATION:

- (a) Remove the DLC3 cover.
- (b) Connect a hand-held tester to the DLC3.
- (c) Turn the ignition switch ON and hand-held tester main switch ON.

CHECK:

Read the KICKDOWN SW signal on the hand-held tester.

OK:

Accelerator Pedal	KICKDOWN SW signal
Fully depressed (kick-down SW is ON)	ON
Released (kick-down SW is OFF)	OFF

When not using hand-held tester:

PREPARATION:

Turn the ignition switch ON.

CHECK:

Measure voltage between terminal KD of Engine and ECT ECU connector and body ground when accelerator pedal is fully depressed or not.

OK:

Accelerator Pedal	Voltage
Fully depressed (kick-down SW is ON)	Below 1V
Released (kick-down SW is OFF)	10 - 14 V

OK

Proceed to next circuit inspection shown in problem symptoms table (See page DI-175).

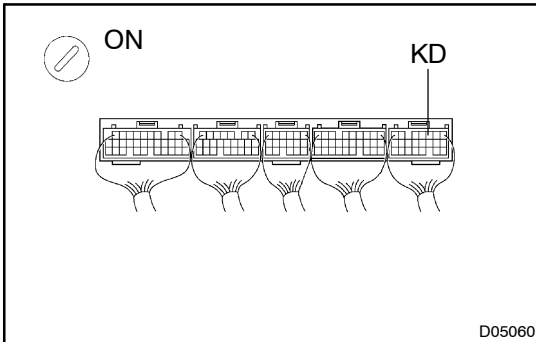

NG

2 Check kick-down switch.

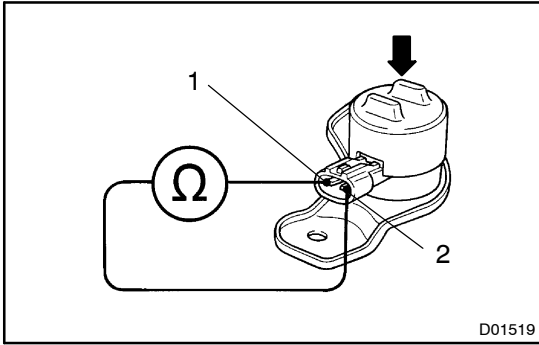

PREPARATION:

Disconnect the kick-down switch connector.

CHECK:

Check continuity at each terminal of kick-down switch connector.

OK:

Kick-down Switch	Specified Condition
ON	No continuity
OFF	Continuity

NG

Replace kick-down switch

OK

3 Check harness and connector between Engine and ECT ECU and kick-down switch, kick-down switch and body ground (See page IN-32).

NG

Repair or replace the harness or connector.

OK

Check and replace Engine and ECT ECU (See page IN-32).