

# Air Inlet Damper Control Servomotor Circuit

## CIRCUIT DESCRIPTION

The air inlet damper control servomotor is controlled by the A/C control assembly and moves the air inlet damper to the desired position.

## WIRING DIAGRAM

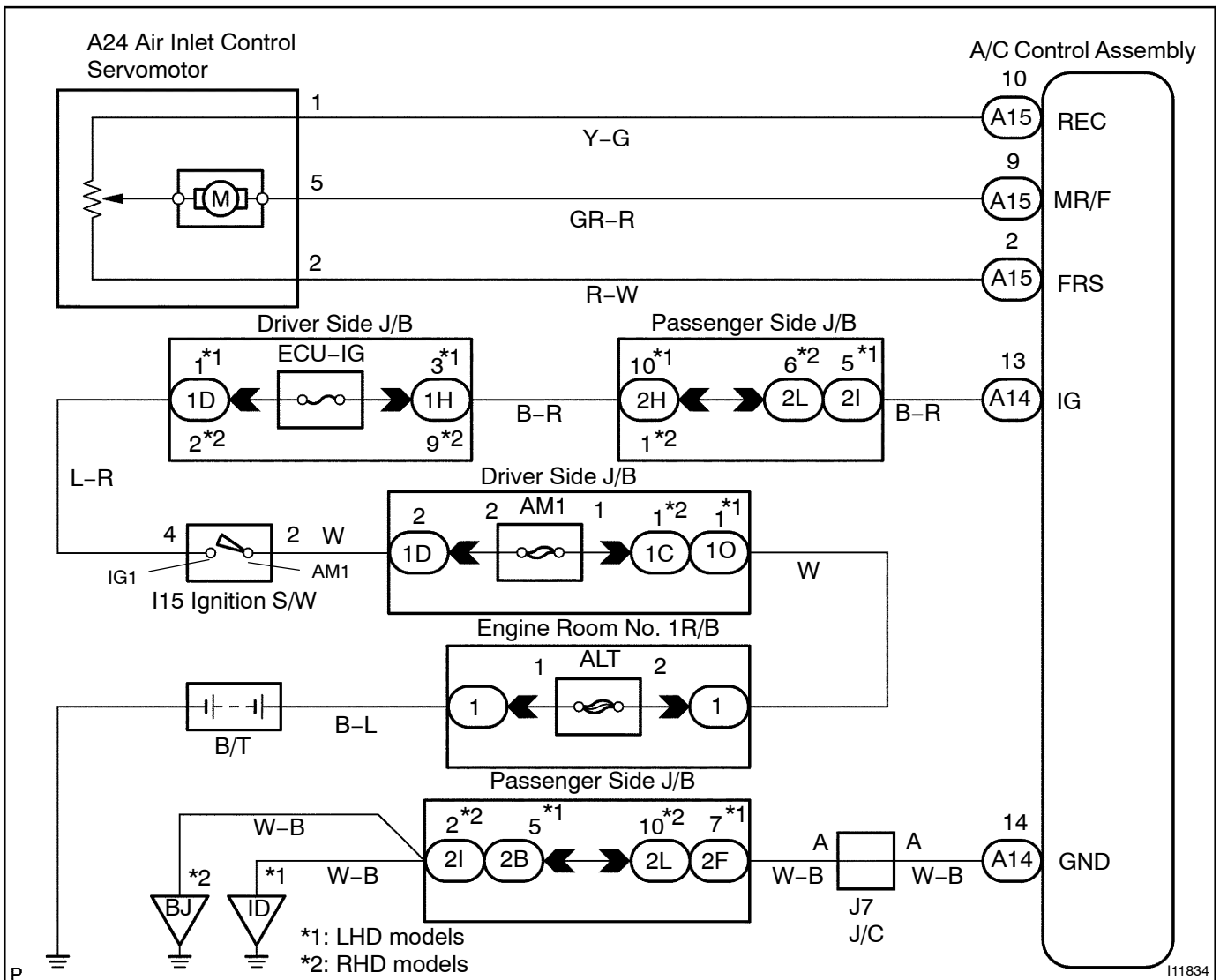

## INSPECTION PROCEDURE

## 1 Actuator check.

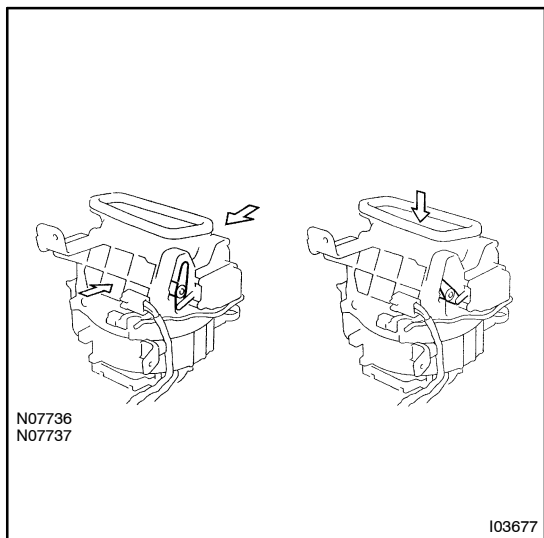
**PREPARATION:**

Connect the hand-held tester to the DLC3.

**CHECK:**

- (a) Enter into ACTIVE TEST function of hand-held tester.
- (b) Check air inlet damper operates as hand-held tester directs.

**OK:**

Pattern No.	Air Inlet Damper
0 - 3	FRS
4 - 9	REC

OK

Proceed to next circuit inspection shown on problem symptoms table (See page DI-674).

NG

## 2 Check air inlet damper control servomotor.

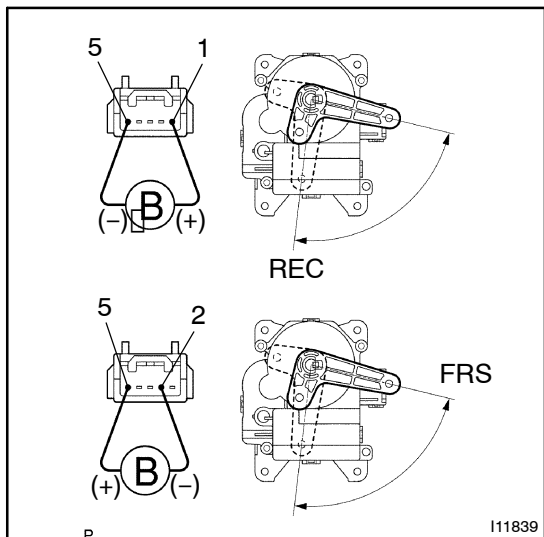
**PREPARATION:**

Remove the air inlet damper control servomotor.

**CHECK:**

Connect positive (+) lead to terminal 1 and negative (-) lead to terminal 5.

**OK:**

The lever moves smoothly to REC position.

**CHECK:**

Connect positive (+) lead to terminal 5 and negative (-) lead to terminal 2.

**OK:**

The lever moves smoothly to FRS position.

NG

Replace air inlet damper control servomotor assembly.

OK

3 Check harness and connector between A/C control assembly and air inlet damper control servomotor (See page IN-32).

NG

Repair or replace harness or connector.

OK

Check and replace A/C control assembly.