

DISASSEMBLY

1. REMOVE GREASE CAP

Using a screwdriver and hammer, remove the grease cap from the steering knuckle.

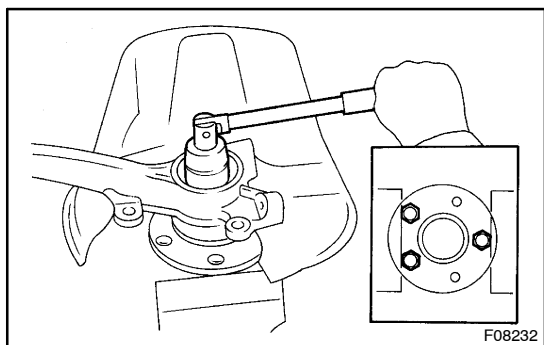

2. REMOVE LOCK NUT

- (a) Mount the axle hub in a soft jaw vise.

HINT:

Close the vise until it holds hub bolts. Do not tighten further.

- (b) Using a chisel and hammer, loosen the staked part of the lock nut.

- (c) Using a socket wrench (32 mm), remove the lock nut.

3. REMOVE ABS SPEED SENSOR ROTOR AND AXLE HUB

- (a) Remove the 4 bolts and shift the brake dust cover toward the outside.

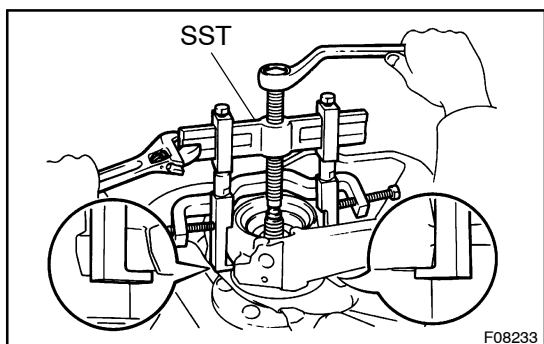

- (b) Using SST, remove the ABS speed sensor rotor and axle hub from the steering knuckle.

SST 09950-40011 (09951-04020, 09952-04010, 09953-04020, 09954-04010, 09955-04051, 09957-04010, 09958-04011)

NOTICE:

Take care not to scratch the serrations of the sensor rotor.

- (c) Remove the brake dust cover.

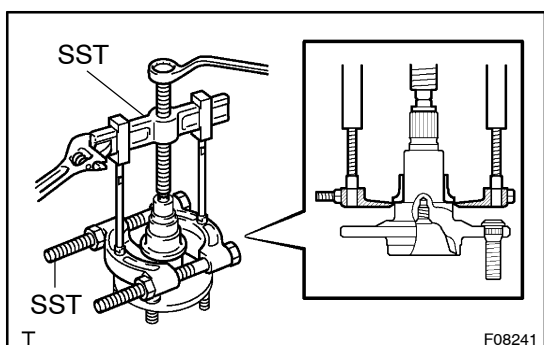

4. REMOVE INNER RACE (OUTSIDE)

Using SST, remove the inner race from the axle hub.

SST 09950-00020, 09950-40011 (09951-04020, 09953-04030, 09957-04010), 09950-50012 (09952-05010, 09954-05030, 09955-05040)

NOTICE:

Be careful not to damage the axle hub.

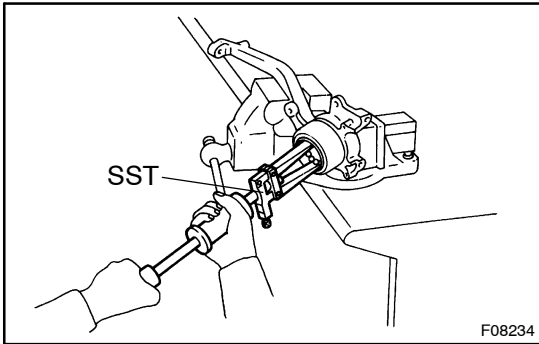
**5. REMOVE OIL SEAL**

Using SST, remove the oil seal from the steering knuckle.

SST 09308-00010

6. REMOVE BEARING

(a) Using snap ring pliers, remove the snap ring from the steering knuckle.

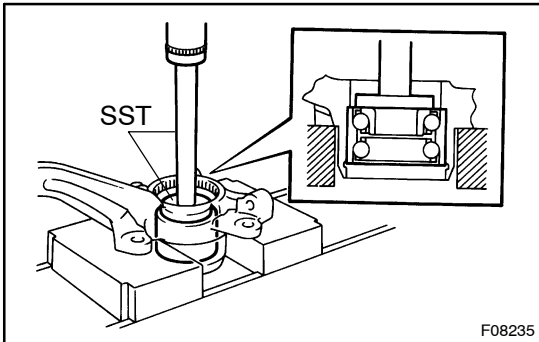

(b) Using SST and a press, remove the bearing from the steering knuckle.

SST 09950-60010 (09951-00560), 09950-70010
(09951-07150)