

INSTALLATION

1. INSTALL FRONT SHOCK ABSORBER WITH COIL SPRING

- (a) Install the No. 3 front spring reinforcement to the shock absorber.
- (b) Install the shock absorber, No. 1 front spring reinforcement to the body with the 3 nuts.
Torque: 35 N·m (360 kgf·cm, 26 ft·lbf)
- (c) Connect the shock absorber to the shock absorber bracket with the bolt and nut.
Torque: 64 N·m (650 kgf·cm, 47 ft·lbf)

HINT:

After stabilizing the suspension, torque the nut.

- (d) Torque the nut in the center of the suspension support.
Torque: 34 N·m (350 kgf·cm, 25 ft·lbf)

HINT:

If the shock absorber has not been disassembled, it is not necessary to torque the nut.

- (e) Install the cap to the suspension support.

2. CONNECT STABILIZER BAR LINK TO STABILIZER BAR

Torque: 49 N·m (500 kgf·cm, 36 ft·lbf)

HINT:

If the ball joint turns together with the nut, use a 5 mm hexagon wrench to hold the stud.

3. CONNECT UPPER SUSPENSION ARM TO STEERING KNUCKLE

- (a) Connect the upper suspension arm with the nut.
Torque: 65 N·m (660 kgf·cm, 50 ft·lbf)
- (b) Install a new clip.

If the holes for the clip are not aligned, tighten the nut further up to 60°.

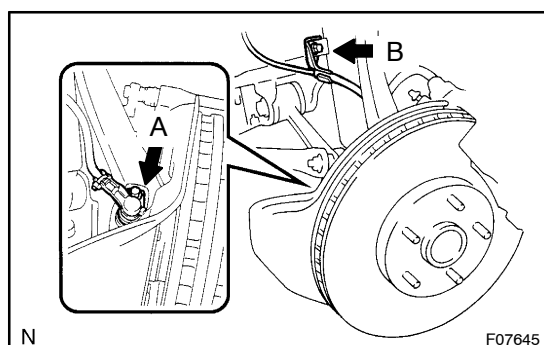

4. CONNECT ABS SPEED SENSOR AND WIRE HARNESS CLAMP

Torque:

Bolt A: 8.0 N·m (82 kgf·cm, 71 in·lbf)

Bolt B: 5.0 N·m (55 kgf·cm, 48 in·lbf)

5. INSTALL FRONT WHEEL

Torque: 103 N·m (1,050 kgf·cm, 76 ft·lbf)

6. CHECK FRONT WHEEL ALIGNMENT

(See page SA-5)

7. CHECK ABS SPEED SENSOR SIGNAL
(See page DI-223)