

DISASSEMBLY

1. CHECK PISTON STROKE OF REAR CLUTCH

- (a) Place the rear clutch assembly onto the center support.

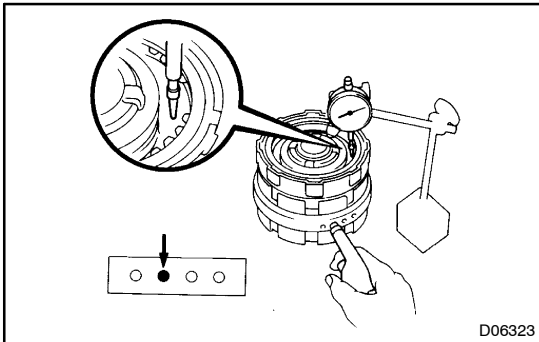

- (b) Using a dial indicator, measure the rear clutch piston stroke applying and releasing the compressed air (392 – 785 kPa, 4 – 8 kgf/cm², 57 – 114 psi), as shown.

Piston stroke:

0.90 – 1.30 mm (0.0354 – 0.0512 in.)

If the values are non-standard, inspect the discs.

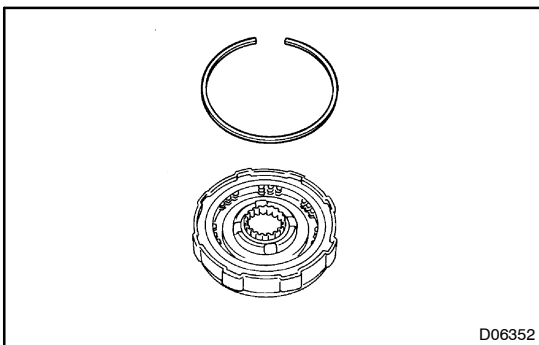

2. REMOVE FLANGE

- (a) Using a screwdriver, remove the snap ring.

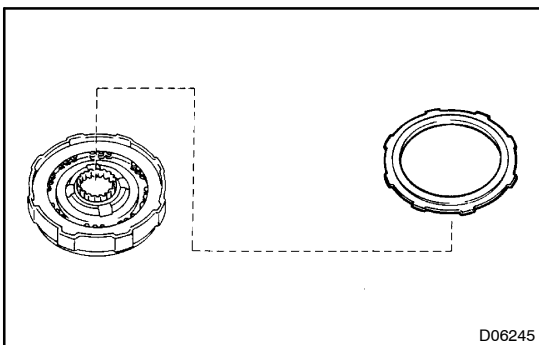

- (b) Remove the flange.

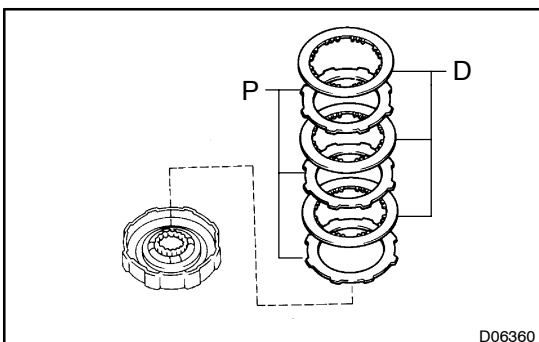

3. REMOVE DISC AND PLATE

Remove the 3 discs and 3 plates.

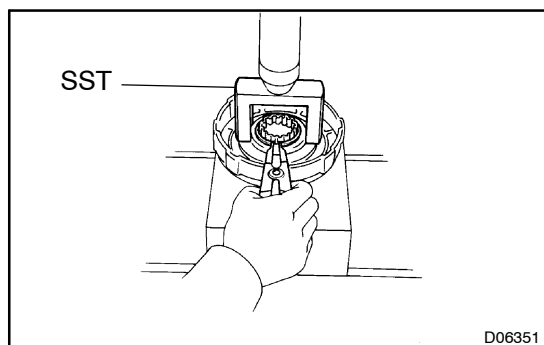
**4. REMOVE PISTON RETURN SPRING**

- (a) Place SST on the piston return spring and compress the piston return spring with a shop press.
SST 09350-20015 (09369-20040)
- (b) Using a snap ring expander, remove the snap ring.

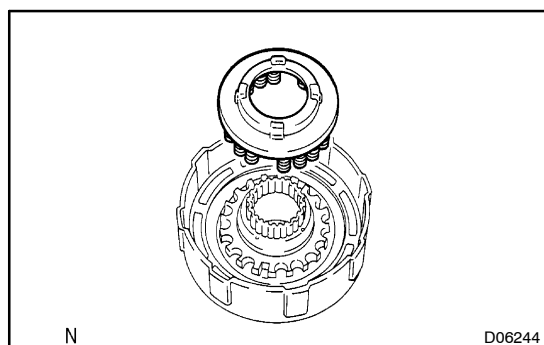

- (c) Remove the piston return spring.

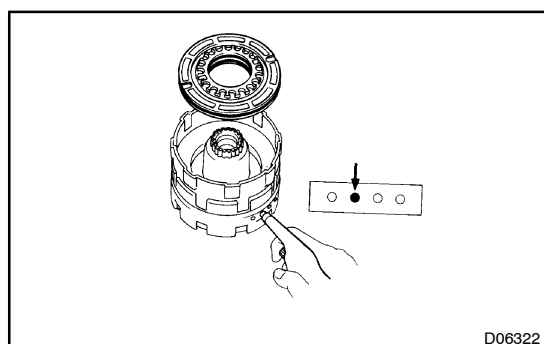
**5. REMOVE REAR CLUTCH PISTON**

- (a) Place the rear clutch drum onto the center support.
- (b) Hold the rear clutch piston with hand, apply compressed air to the center support to remove the rear clutch piston.
- (c) Remove the 4 O-rings from the piston.