

DISASSEMBLY

1. REMOVE PLANETARY SUN GEAR AND NO. 1 ONE-WAY CLUTCH

(a) Using a snap ring expander, remove the snap ring.

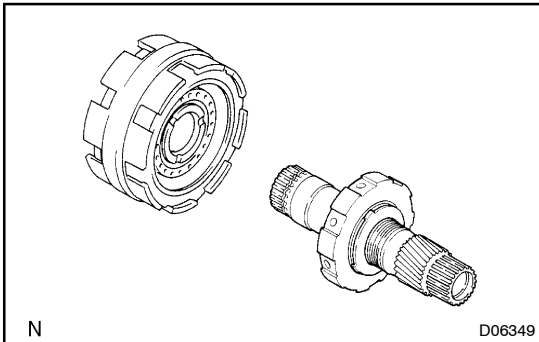

(b) Remove the planetary sun gear with the No. 1 one-way clutch.

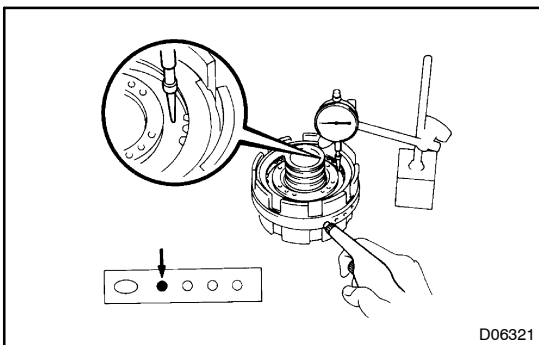

2. CHECK PISTON STROKE OF NO. 1 BRAKE

Using a dial indicator, measure the No. 1 brake piston stroke applying and releasing the compressed air (392 – 785 kPa, 4 – 8 kgf/cm², 57 – 114 psi), as shown.

Piston stroke: 0.75 – 1.35 mm (0.0295 – 0.0531 in.)

If the values are non-standard, inspect the disc.

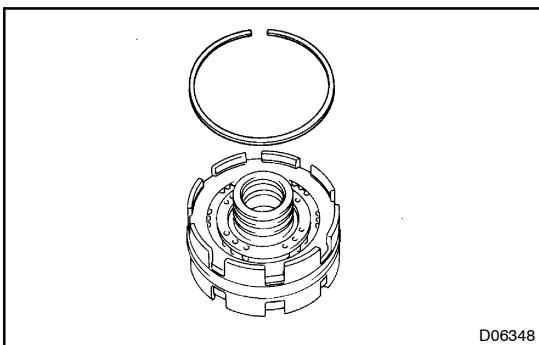

3. REMOVE FLANGE

(a) Using a screwdriver, remove the snap ring.

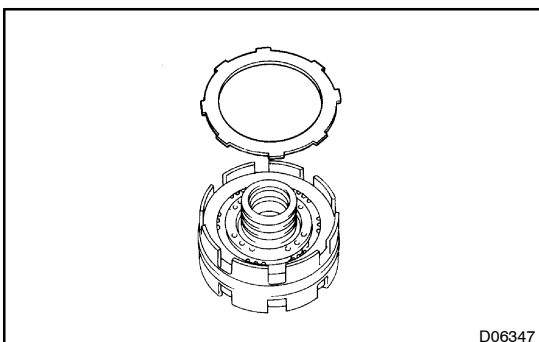

(b) Remove the flange.

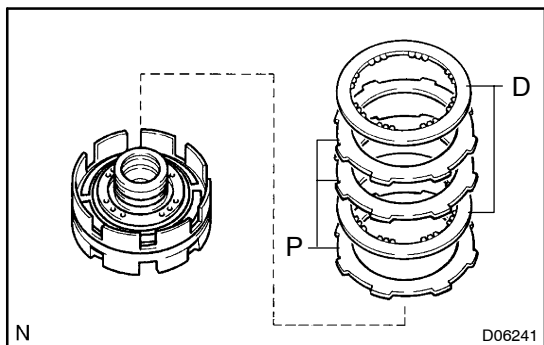
**4. REMOVE DISC AND PLATE**

Remove the 2 discs and 3 plates.

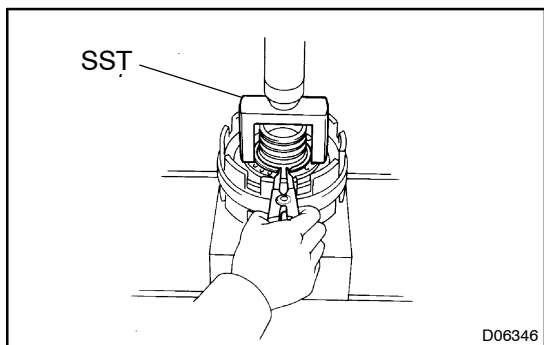
**5. REMOVE PISTON RETURN SPRING**

- (a) Place SST on the spring seat and compress the return springs with a shop press.
SST 09350-20015 (09369-20040)
- (b) Using a snap ring expander, remove the snap ring.

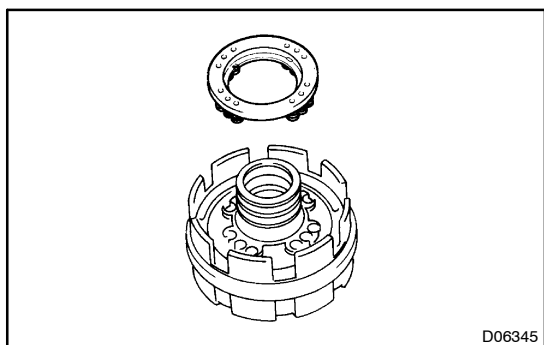

- (c) Remove the piston return spring.

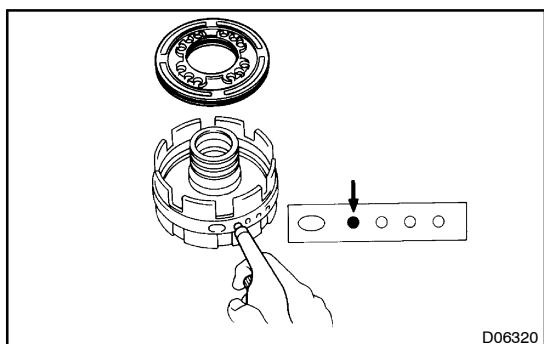
**6. REMOVE NO. 1 BRAKE PISTON**

- (a) Push the No. 1 brake piston with hand, apply compressed air to the center support to remove the No. 1 brake piston.
- (b) Remove the 2 O-rings from the piston.

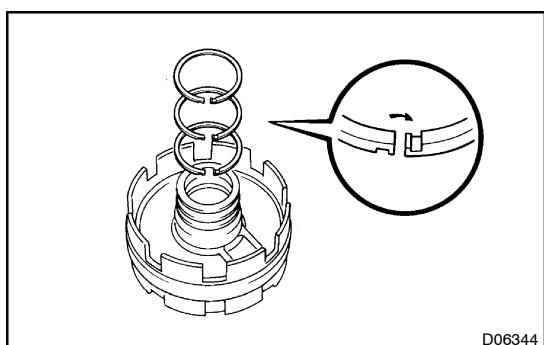
**7. REMOVE OIL SEAL RING**

Remove the 3 oil seal rings.