

REASSEMBLY

1. INSTALL OIL SEAL RING

- (a) Coat the 3 oil seal rings with ATF.
- (b) Contract the oil seal rings and install them onto the center support.

NOTICE:

Donot spread the ring ends too much.

HINT:

After installing the oil seal rings, check that they rotate smoothly.

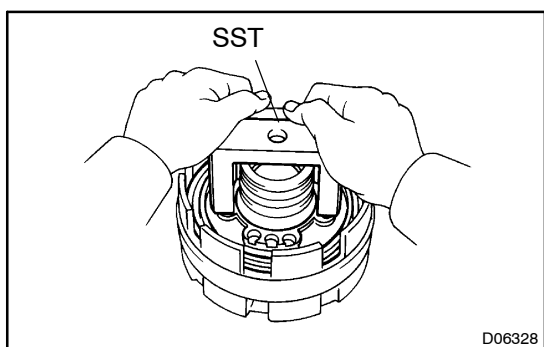

2. INSTALL NO. 1 BRAKE PISTON

- (a) Coat new O-rings with ATF and install them on the No. 1 brake piston.
- (b) Place SST on the No. 1 brake piston.
SST 09350-20015 (09369-20040)
- (c) Being careful not to damage the O-rings, press in the No. 1 brake piston into the center support with both hands.

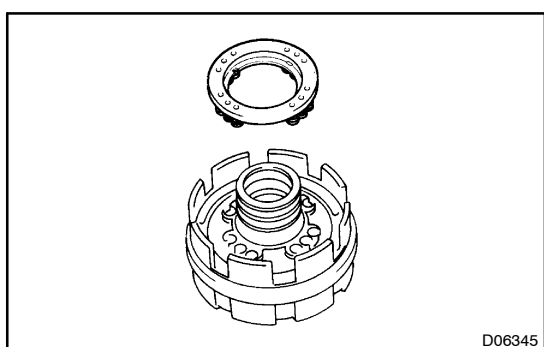

3. INSTQALL PISTON RETURN SPRING

- (a) Install the piston return spring.

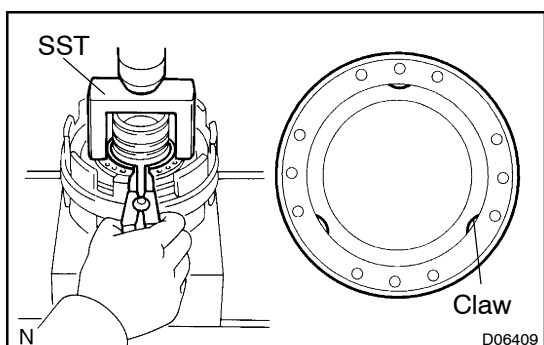

- (b) Place SST on the spring seat, and compress the return springs with a shop press.
SST 09350-20015 (09369-20040)
- (c) Install the snap ring with a snap ring expander. Be sure the end gap of the snap ring is not aligned with the spring seat claw.

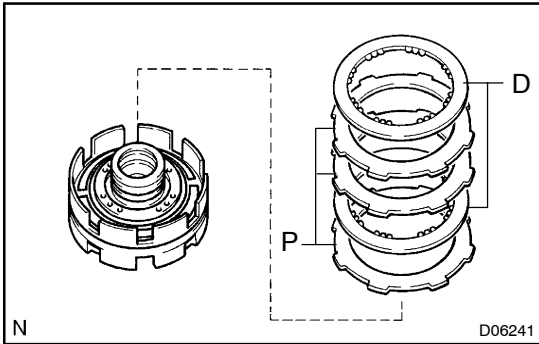

4. INSTALL PLATE AND DISC

Install the 3 plates and 2 discs.

Install in order: P = Plate D = Disc

P - D - P - P - D

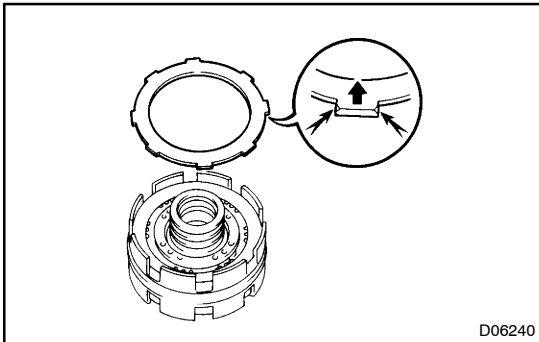

5. INSTALL FLANGE

(a) Install the flange, the rounded edge facing upward.

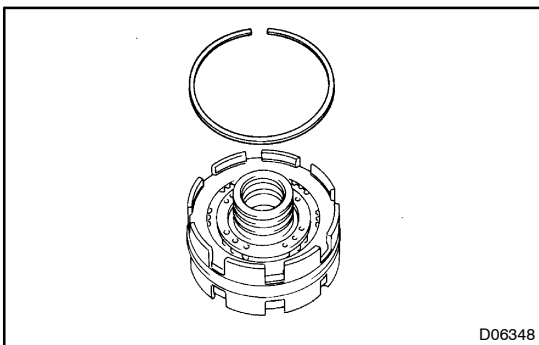

(b) Using a screwdriver, install the snap ring. Be sure the end gap of the snap ring is not aligned with the cutout portion of the center support.

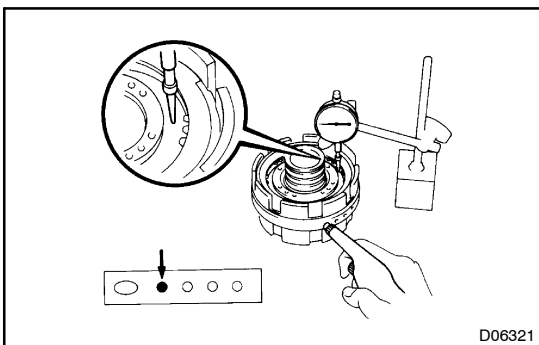

6. CHECK PISTON STROKE OF NO. 1 BRAKE

Using a dial indicator, measure the No. 1 brake piston stroke applying and releasing the compressed air (392 – 785 kPa, 4 – 8 kgf/cm², 57 – 114 psi), as shown.

Piston stroke: 0.97 – 1.64 mm (0.03892 – 0.0646 in.)

If the piston stroke is less than the limit, parts may have been assembled incorrectly, check and reassemble again.

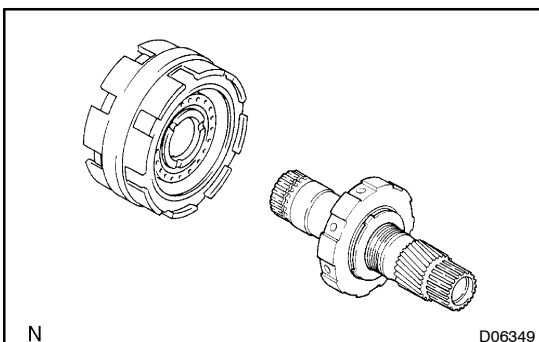

7. INSTALL PLANETARY SUN GEAR AND NO. 1 ONE-WAY CLUTCH

(a) While turning the one-way clutch, install the planetary sun gear.

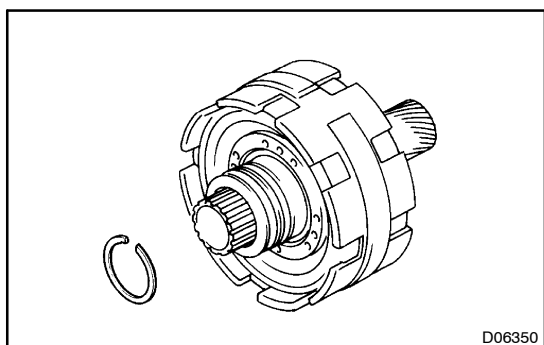

(b) Using a snap ring expander, install the snap ring.