

DISASSEMBLY

NOTICE:

- Disassembling and reassembling should be conducted on a clean vinyl sheet or mat, or aluminum tray.
- Make the valve slide through the valve hole by its own weight. Do not forcibly pull out the valve using needle nose pliers. When having difficulty in removing it, slant and shake the valve body or use a magnet hand.
- Do not place the disassembled parts directly on metal work bench or waste cloth.

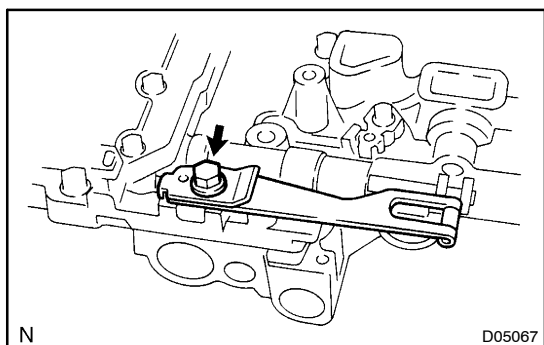

1. REMOVE DETENT SPRING AND SPRING PLATE

Remove the bolt, detent spring and spring plate.

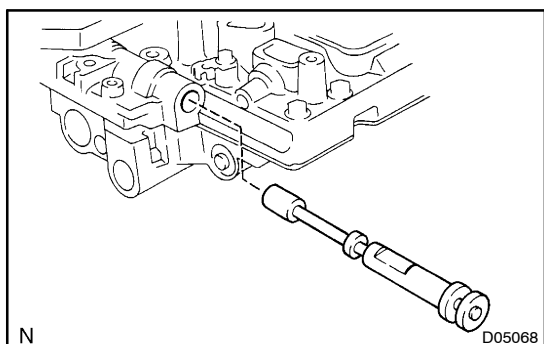

2. REMOVE MANUAL VALVE

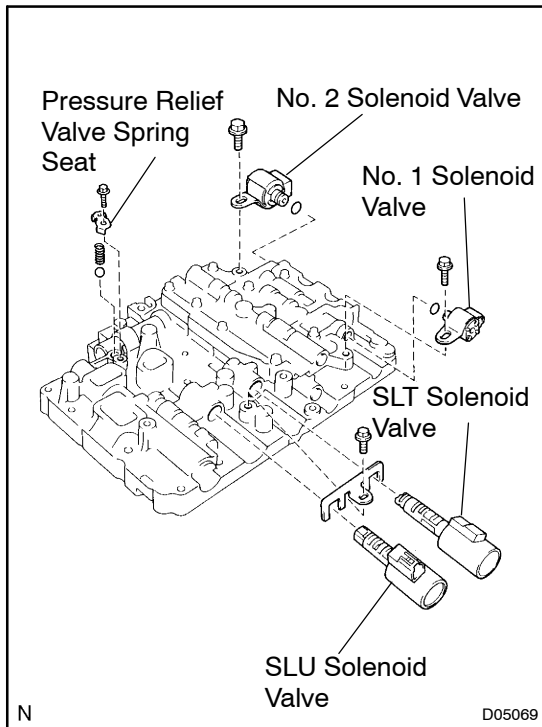
**3. REMOVE 4 SOLENOIDS**

- (a) Remove the bolt and No. 1 solenoid valve.
- (b) Remove the bolt and No. 2 solenoid valve.
- (c) Remove the bolt, lock plate and SLU, SLT solenoid valves.
- (d) Remove the 2 O-rings from the No. 1, No. 2 solenoid valves.
- (e) Remove the bolt, pressure relief valve spring seat, spring and ball.

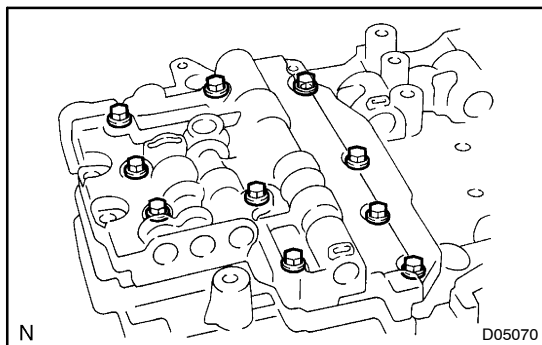
**4. REMOVE LOWER NO. 2 VALVE BODY**

- (a) Remove the 10 bolts.
- (b) Remove the lower No. 2 valve body.
- (c) Remove the plate sub assembly.

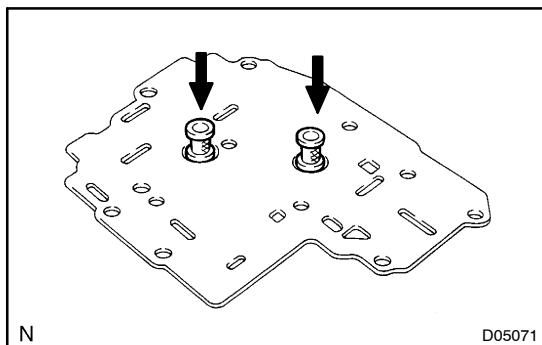

- (d) Remove the 2 strainers from the plate sub assembly.

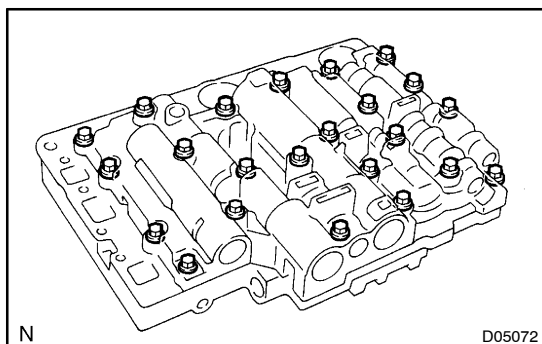
**5. REMOVE UPPER VALVE BODY**

- (a) Turn over assembly and remove the 23 bolts.
- (b) Remove the plate from the upper valve body.
- (c) Remove the upper valve body with the plate sub-assembly.
- (d) Turn over upper valve body, remove the plate sub-assembly.

NOTICE:

Be careful that the check balls do not fall out.

- (e) Remove the check valve and spring.

- (f) Remove the ball and spring.
- (g) Remove the check balls.