

AIR INLET SERVOMOTOR INSPECTION

AC37R-01

1. REMOVE GLOVE COMPARTMENT DOOR
(See Pub. No. RM684E on page BO-96)

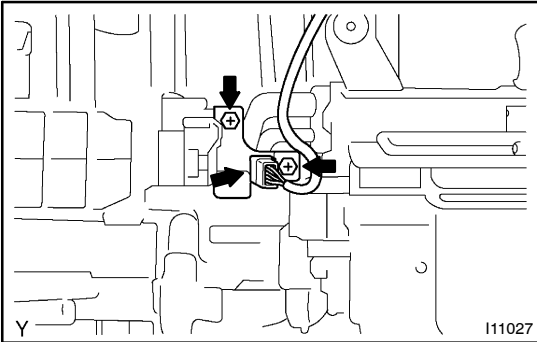

2. REMOVE BRACKET
 - (a) Disconnect the wire harness clamp.
 - (b) Remove the 2 bolts and bracket.

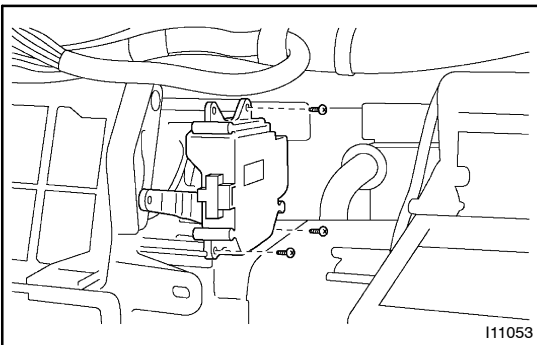

3. REMOVE AIR INLET SERVOMOTOR
 - (a) Disconnect the connector.
 - (b) Remove the 3 screws and servomotor.

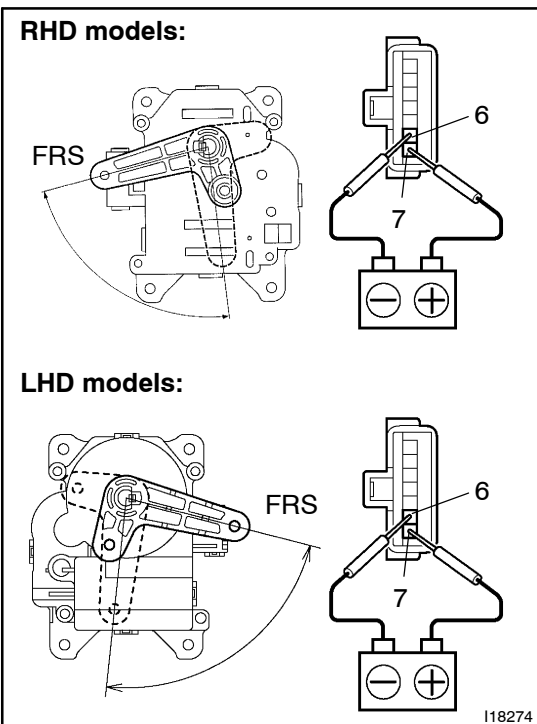

4. INSPECT AIR INLET SERVOMOTOR OPERATION
 - (a) Connect the positive (+) lead from the battery to terminal 7 and negative (-) lead to terminal 6, then check that the arm turns to "FRESH" side smoothly.

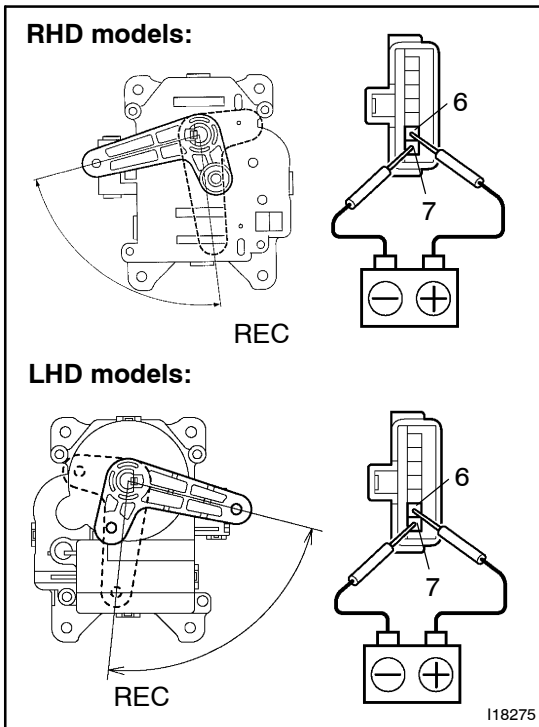

- (b) Connect the positive (+) lead from the battery to terminal 6 and negative (-) lead to terminal 7, then check that the arm turns to "RECIRC" side smoothly.
If operations are not as specified, replace the servomotor.

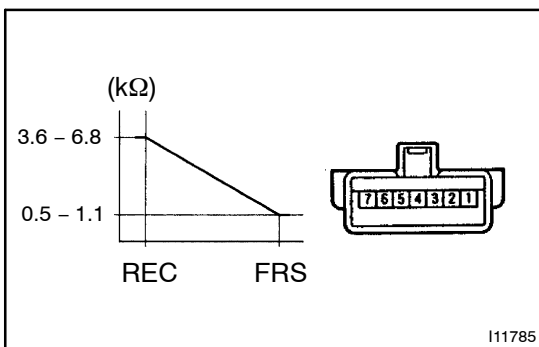

5. INSPECT POSITION SENSOR RESISTANCE

Measure resistance between terminals at servomotor arm each position as shown in the chart.

Tester connection	Condition	Specified condition
1 - 3	Constant	4.2 - 7.8 kΩ
3 - 5	REC	3.1 - 5.8 kΩ
3 - 5	FRS	0.8 - 1.6 kΩ

If resistance is not as specified, replace the servomotor.

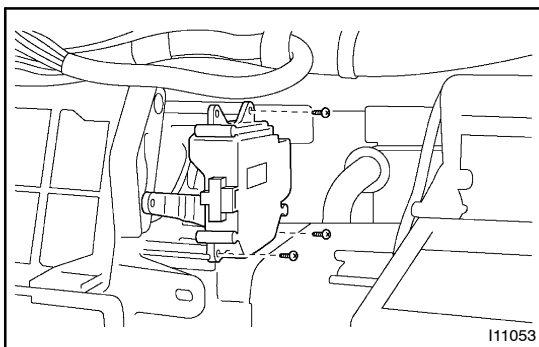

6. INSTALL AIR INLET SERVOMOTOR

- (a) Install the servomotor with the 3 screws.
(b) Connect the connector.

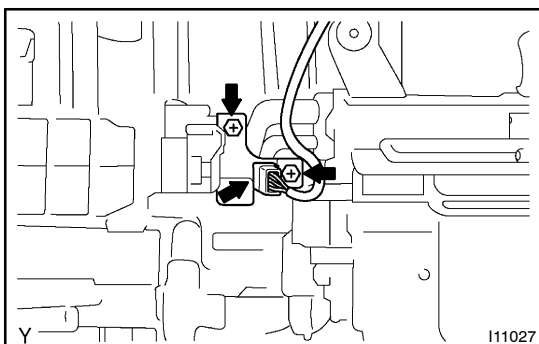

7. INSTALL BRACKET

- (a) Install the bracket with 2 bolts.
(b) Connect the wire harness clamp.

8. INSTALL GLOVE COMPARTMENT DOOR
(See Pub. No. RM684E on page BO-96)