

## COMPRESSOR AND MAGNETIC CLUTCH (2JZ-GE) ON-VEHICLE INSPECTION

AC3LC-01

### 1. INSPECT COMPRESSOR FOR METALLIC SOUND

Check there is abnormal metallic sound from the compressor when the A/C switch is ON.

If abnormal metallic sound is heard, replace the compressor assembly.

### 2. INSPECT REFRIGERANT PRESSURE

(See Pub. No. RM684E on page AC-3)

### 3. INSPECT VISUALLY FOR LEAKAGE OF REFRIGERANT

Using a gas leak detector, check for leakage of refrigerant.

If there is any leakage, replace the compressor assembly.

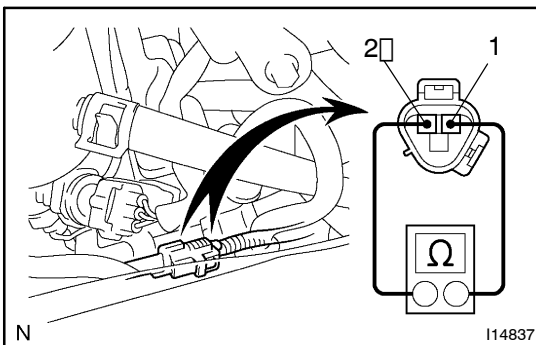

### 4. INSPECT COMPRESSOR LOCK SENSOR RESISTANCE

(a) Disconnect the connector.

(b) Measure resistance between terminals 1 and 2.

**Standard resistance: 990 – 1,210  $\Omega$  at 20°C (68 °F)**

If resistance is not as specified, replace the compressor.

### 5. MAKE THESE VISUAL CHECKS:

(a) Leakage of grease from the clutch bearing.

(b) Signs of oil on the pressure plate or rotor.

### 6. INSPECT MAGNETIC CLUTCH BEARING FOR NOISE

(a) Start engine.

(b) Check for abnormal noise from the compressor when the A/C switch is OFF.

If abnormal noise is being emitted, replace the rotor of magnetic clutch.

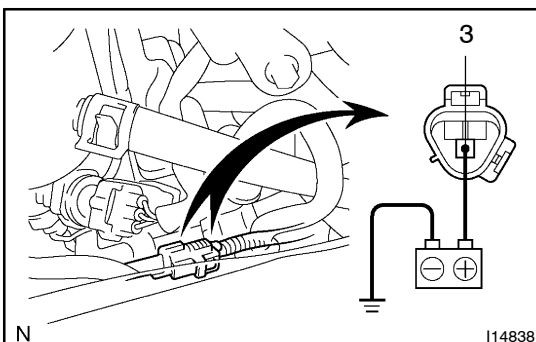

### 7. INSPECT MAGNETIC CLUTCH OPERATION

(a) Disconnect the connector.

(b) Connect the positive (+) lead from the battery to terminal 3 and the negative (-) lead to the body ground.

(c) Check that the magnetic clutch is energized.

If operation is not as specified, replace the magnetic clutch.