

## REMOVAL

### 1. DRAIN ENGINE COOLANT FROM RADIATOR

HINT:

It is not necessary to drain out all coolant.

### 2. REMOVE AIR CLEANER INLET

### 3. REMOVE AIR CLEANER AND MAF METER ASSEMBLY

### 4. REMOVE COOLING FAN

- (a) Disconnect the upper radiator hose from the radiator.
- (b) Disconnect the ECU outlet duct from the ECU box.
- (c) Disconnect the wire for cooling fan from the clamp on the cooling fan.
- (d) Disconnect the 2 cooling fan connector.
- (e) Disconnect the radiator reservoir hose from the radiator.

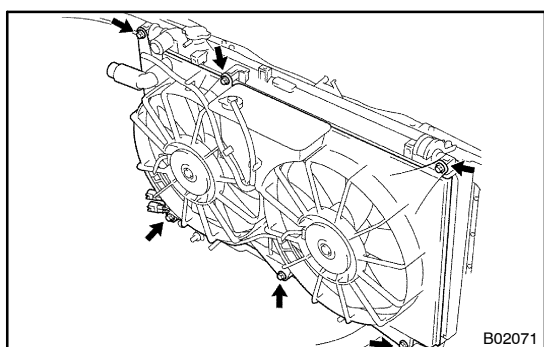

- (f) Remove the 6 bolts and cooling fan.