

REMOVAL

1. REMOVE CENTER CLUSTER FINISH PANEL

- (a) w/ LEXUS navigation system:
 Using a screwdriver, remove center register opening cover.

HINT:

Tape the screwdriver tip before use.

- (b) w/ LEXUS navigation system:
 Remove the 2 screws.
- (c) Using a screwdriver, remove center cluster finish panel.

HINT:

Tape the screwdriver tip before use.

- (d) w/ LEXUS navigation system:
 Disconnect the connectors.

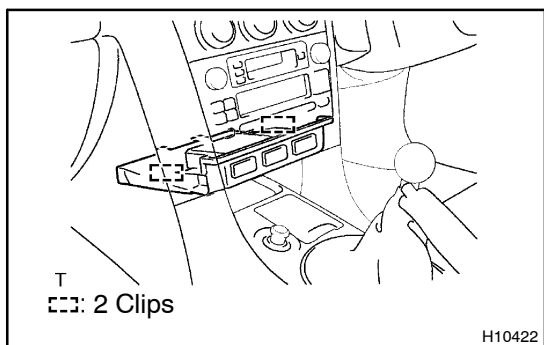

2. REMOVE LOWER CENTER CLUSTER FINISH PANEL

- (a) Using a screwdriver, remove the lower center cluster finish panel.

HINT:

Tape the screwdriver tip before use.

- (b) Disconnect the connectors.

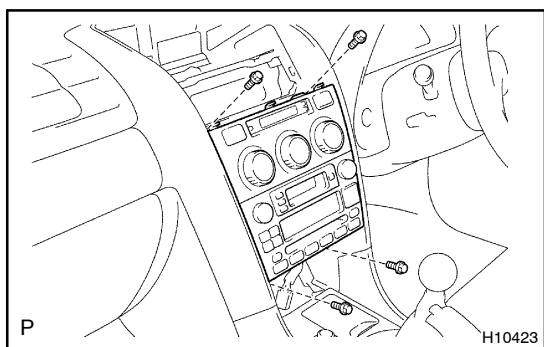

3. REMOVE A/C CONTROL WITH RADIO RECEIVER ASSEMBLY

- (a) Remove the 4 bolts and the A/C control with radio receiver assembly.
- (b) Disconnect the connectors.

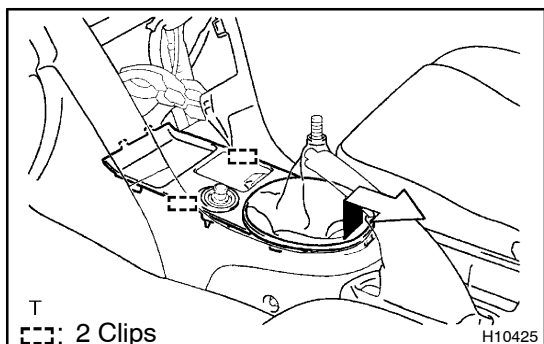

4. REMOVE UPPER CONSOLE PANEL

- (a) M/T:
 Remove the shift lever knob.
- (b) Using a screwdriver, remove the upper console panel as shown in the illustration.

HINT:

Tape the screwdriver tip before use.

- (c) Disconnect the connector.

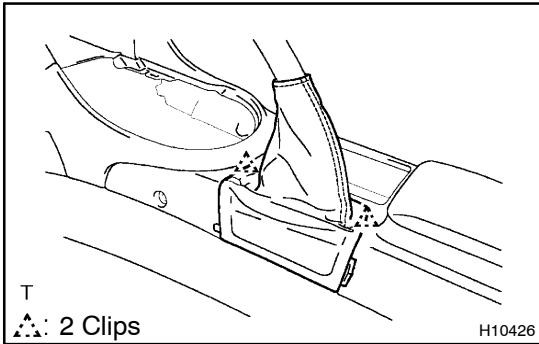

5. REMOVE PARKING BRAKE HOLE COVER

Using a screwdriver, remove the parking brake hole cover.

HINT:

Tape the screwdriver tip before use.

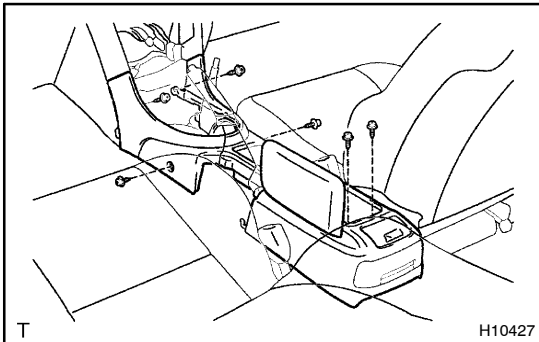

6. w/o Arm rest:

REMOVE CONSOLE BOX

- (a) Remove the 6 screws.
- (b) w/o LEXUS navigation system:
Pull the console box rearward to remove it.
- (c) w/ LEXUS navigation system:
Pull the console box rearward to remove it then disconnect the connector.

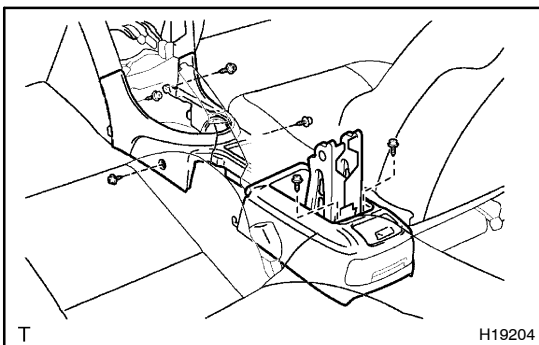

7. w/ Arm rest:

REMOVE CONSOLE BOX

- (a) Using a screwdriver, remove the box side No. 1 and No. 2 panel.

HINT:

Tape the screwdriver tip before use.

- (b) Remove the 2 bolts and console compartment door.
- (c) Remove the console box cover rear.
- (d) Remove the 6 screws.
- (e) w/o LEXUS navigation system:
Pull the console box rearward to remove it.
- (f) w/ LEXUS navigation system:
Pull the console box rearward to remove it then disconnect the connector.
- (g) Remove the 4 bolts and rear console armrest hinge.

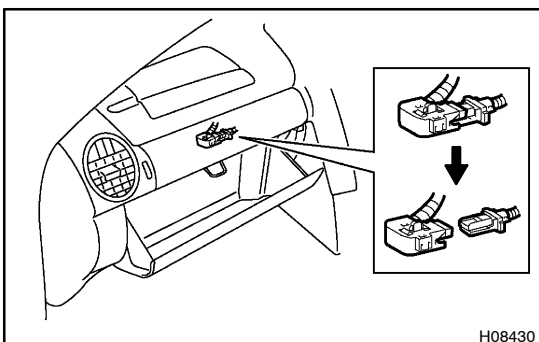

8. DISCONNECT PASSENGER AIRBAG CONNECTOR

- (a) Using a clip remover, disengage the connector clamp.
- (b) Disconnect the passenger airbag connector.

NOTICE:

When disconnecting the airbag connector, take care not to damage the airbag wire harness.

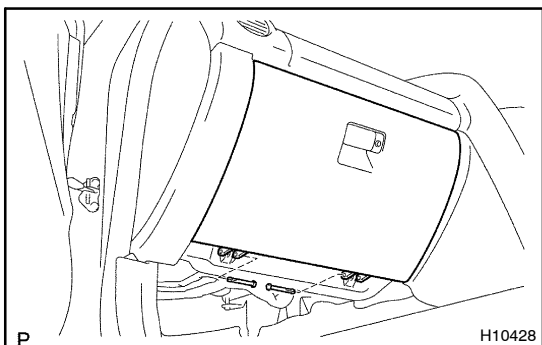
**9. REMOVE GLOVE COMPARTMENT DOOR**

Disconnect the hinge shaft and remove the glove compartment door.

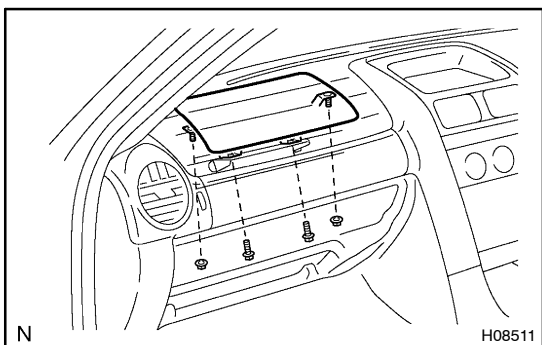
**10. REMOVE FRONT PASSENGER AIRBAG ASSEMBLY**

Remove the 2 bolts, 2 nuts and the front passenger airbag assembly from the instrument panel.

Torque:

20 N·m (205 kgf·cm, 15 ft·lbf.) for bolt

5.5 N·m (56 kgf·cm, 49 in·lbf) for nut

CAUTION:

- Do not store the front passenger airbag assembly with the airbag deployment side facing downward.
- Never disassemble the front passenger airbag assembly.

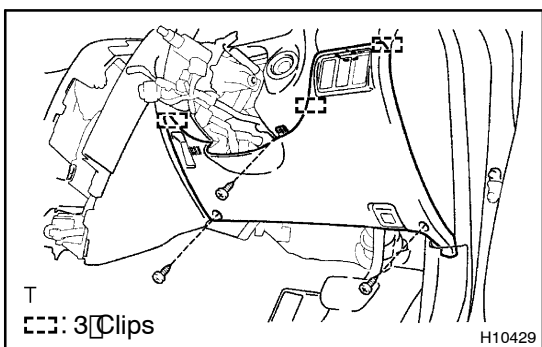
11. REMOVE STEERING WHEEL PAD (See page SR-8)**12. REMOVE STEERING WHEEL (See page SR-8)****13. REMOVE COLUMN UPPER AND LOWER COVERS (See page SR-8)****14. REMOVE SPIRAL CABLE (See page SR-8)****15. REMOVE LOWER FINISH PANEL**

- (a) Remove the 3 screws and lower finish panel.
- (b) Disconnect the connectors and hood lock control cable.

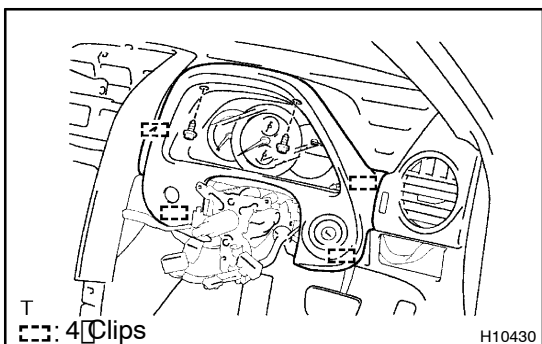
**16. REMOVE CLUSTER FINISH PANEL**

- (a) Remove the 2 screws.
- (b) Using a screwdriver, remove the cluster finish panel.

HINT:

Tape the screwdriver tip before use.

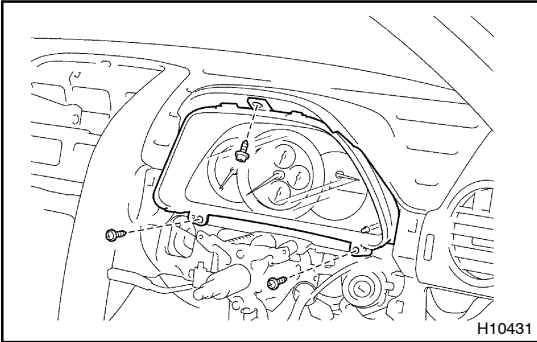
**17. REMOVE COMBINATION METER**

- (a) Remove the 3 screws and combination meter.
- (b) Disconnect the connector.

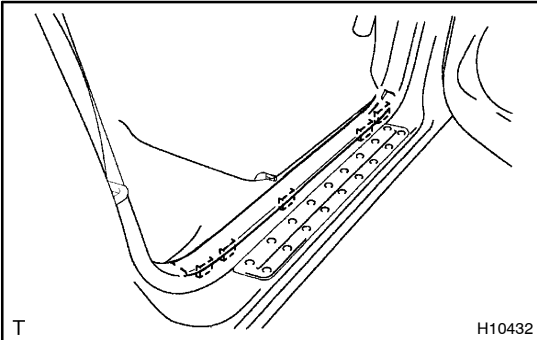
**18. REMOVE FRONT DOOR INSIDE SCUFF PLATE**

- (a) Using a screwdriver, remove the front door inside scuff plate.

HINT:

Tape the screwdriver tip before use.

- (b) Employ the same manner described above to the other side.

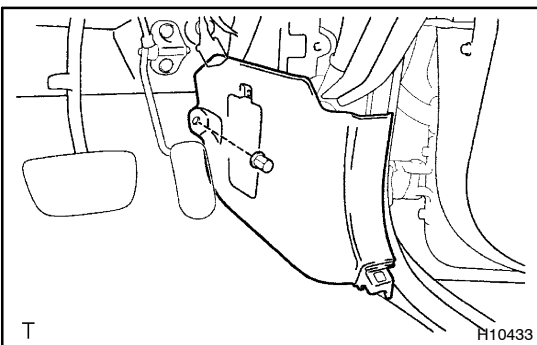
**19. REMOVE COWL SIDE TRIM BOARD**

- (a) Remove the clip.
- (b) Pull the cowl side trim board rearward to remove it.
- (c) Employ the same manner described above to the other side.

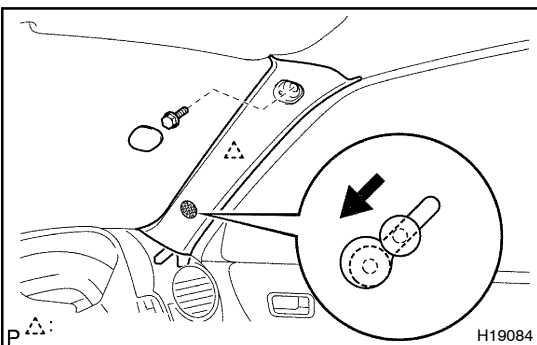
20. REMOVE FRONT PART OF FRONT DOOR OPENING TRIMS**21. REMOVE FRONT PILLAR GARNISH**

- (a) Using a screwdriver, remove the front pillar garnish cover.

HINT:

Tape the screwdriver tip before use.

- (b) Remove the bolt.
- (c) Using a screwdriver, remove the front pillar garnish.

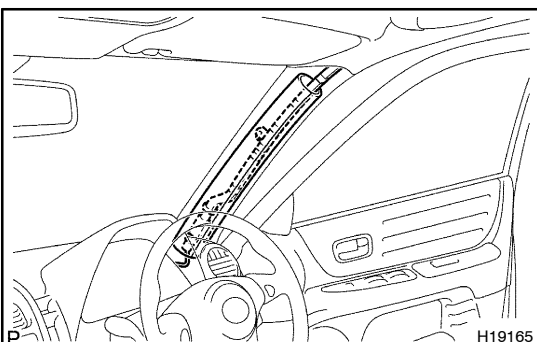

- (d) Remove the bolt.

Torque: 9.8 N·m (100 kgf·cm, 87 in.·lbf)

- (e) Pack the airbag with protection cover.
- (f) Employ the same manner described above to the other side.

22. REMOVE INSTRUMENT PANEL

- (a) Disconnect the connectors.
- (b) Disengage the wire harness clamps.
- (c) Remove the 3 bolts, 2 screws and 2 nuts.
- (d) Pull the instrument panel rearward to remove it.

NOTICE:

Be careful not to damage the instrument panel and wire harness.

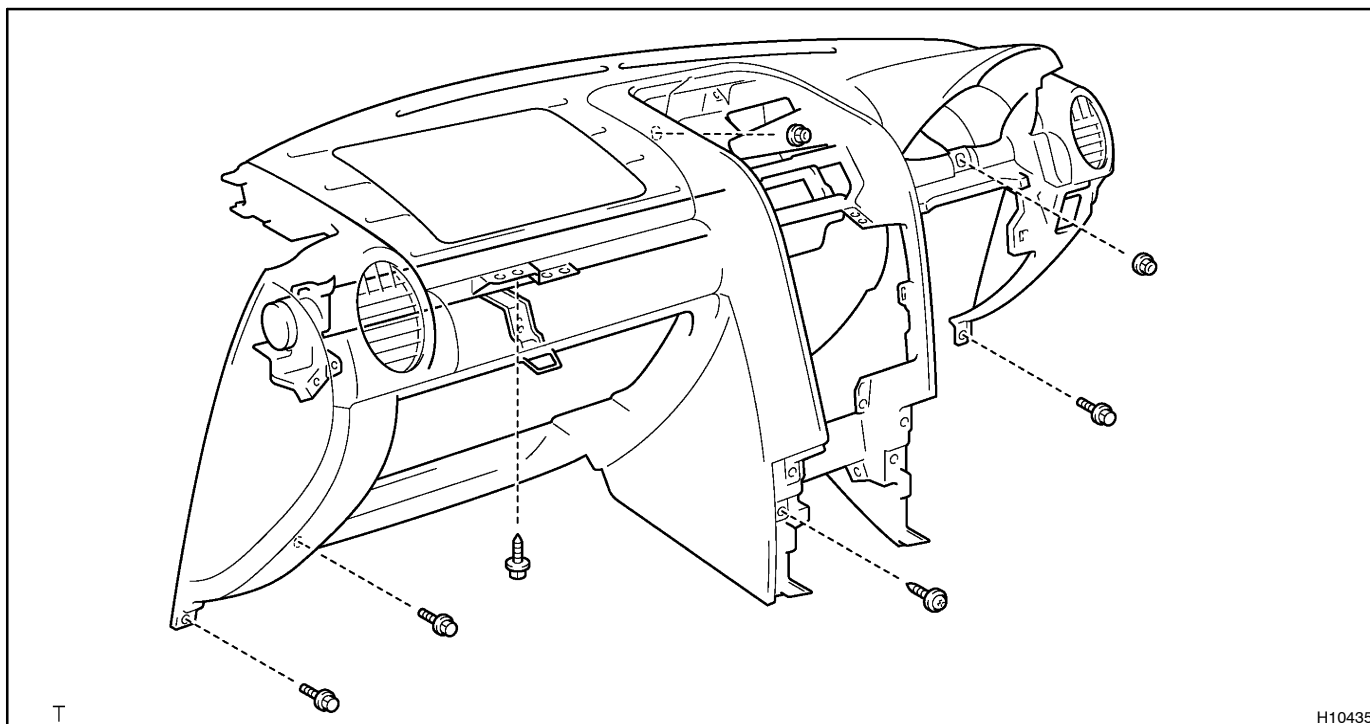

23. REMOVE INSTRUMENT PANEL REINFORCEMENT

- (a) Disengage the wire harness clamps.
- (b) Remove the 2 nuts and wire harness from the reinforcement.
- (c) Remove the bolt and ground cable.
- (d) Remove the bolt, screw and No. 1 mounting bracket.
- (e) Remove the bolt and panel to floor brace LH.
- (f) Remove the bolt and No. 2 mounting bracket.
- (g) Remove the 4 bolts and No.1 brace.
- (h) Remove the 5 bolts, 2 nuts, instrument panel reinforcement and lower mounting bracket.

NOTICE:

Be careful not to damage the body and wire harness.

