

REMOVAL

1. DRAIN ENGINE COOLANT
2. REMOVE ENGINE COVER

Remove the 4 nuts and engine cover.

3. REMOVE INTAKE AIR RESONATOR
4. REMOVE THROTTLE BODY BRACKET AND THROTTLE BODY

- (a) Disconnect the accelerator cable.
- (b) Disconnect the throttle position sensor connector.
- (c) Disconnect the throttle control motor connector.
- (d) Disconnect the accelerator pedal position sensor connector.
- (e) Disconnect the engine wire clamp from the clamp bracket of throttle body.

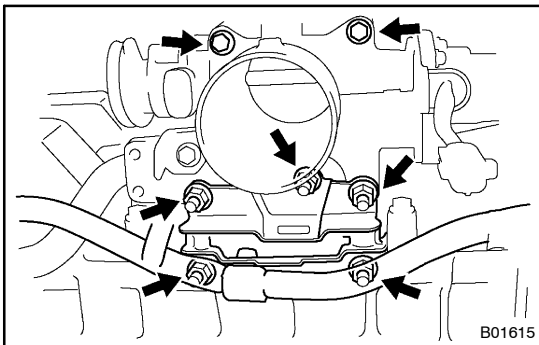

- (f) Remove the 2 bolts and nut holding the throttle body to the intake air connector.
Torque: 21 N·m (210 kgf·cm, 15 ft·lbf)
- (g) Remove the 4 nuts and throttle body bracket.
Torque: 21 N·m (210 kgf·cm, 15 ft·lbf)
- (h) Slightly slide the throttle body away from the intake air connector.

NOTICE:

When putting up the throttle body, do not hold the motor part.

- (i) Disconnect the 2 water bypass hoses from the throttle body, and remove the throttle body.

HINT:

- At the time of installation, please refer to the following items.
- Connect the water bypass hose with its discrimination mark downward.
- Install the with its crawl direction for (1) forward and down-side diagonal (engine side about 45°) for (2).

