

## INSTALLATION

### 1. INSTALL FRONT SHOCK ABSORBER WITH COIL SPRING

- (a) SEDAN:  
Install the No. 3 front spring reinforcement to the shock absorber.
- (b) Install the shock absorber, No. 1 front spring reinforcement to the body with the 3 nuts.  
**Torque: 35 N·m (360 kgf·cm, 26 ft·lbf)**
- (c) Connect the shock absorber to the shock absorber bracket with the bolt and nut.  
**Torque: 64 N·m (650 kgf·cm, 47 ft·lbf)**

#### HINT:

After stabilizing the suspension, torque the nut.

- (d) Torque the nut in the center of the suspension support.  
**Torque: 34 N·m (350 kgf·cm, 25 ft·lbf)**

#### HINT:

If the shock absorber has not been disassembled, it is not necessary to torque the nut.

- (e) Install the cap to the suspension support.

### 2. CONNECT STABILIZER BAR LINK TO STABILIZER BAR

**Torque: 49 N·m (500 kgf·cm, 36 ft·lbf)**

#### HINT:

If the ball joint turns together with the nut, use a 5 mm hexagon wrench to hold the stud.

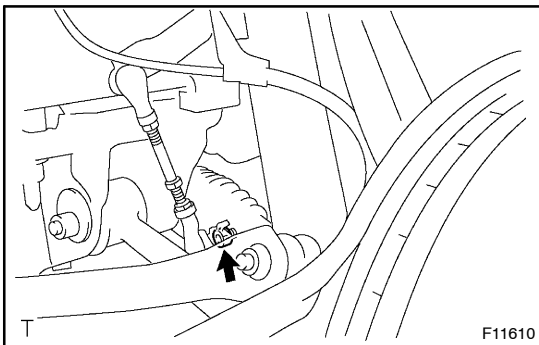

### 3. w/ DISCHARGE HEAD LAMP: CONNECT HEIGHT CONTROL SENSOR LINK

- (a) Set the lower arm to the vehicle height.
- (b) Install the sensor link to the lower arm bracket with a nut.  
**Torque: 5.4 N·m (55 kgf·cm, 48 in·lbf)**

#### NOTICE:

- Be careful not to brake the link fixing pin until the above operation is completed.
- The pin can be broken after completion of the above, however, the sensor arm rotation angle shall not exceed the range of  $\pm 70^\circ$  from the standard vehicle height.

### 4. CONNECT UPPER SUSPENSION ARM TO STEERING KNUCKLE

- (a) Connect the upper suspension arm with the nut.  
**Torque: 65 N·m (660 kgf·cm, 50 ft·lbf)**
- (b) Install a new clip.

If the holes for the clip are not aligned, tighten the nut further up to  $60^\circ$ .

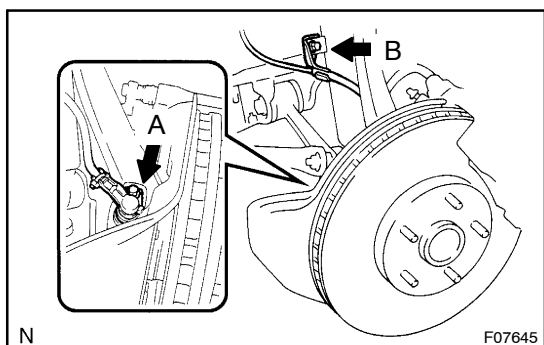

5. **CONNECT ABS SPEED SENSOR AND WIRE HARNESS CLAMP**

Torque:

**Bolt A:** 3.0 N·m (82 kgf·cm, 71 in·lbf)

**Bolt B:** 5.0 N·m (51 kgf·cm, 44 in·lbf)

6. **2JZ-GE Engine:**

**INSTALL IGNITER**

(a) Install the igniter with the bolt and nut.

(b) Connect the connector.

7. **INSTALL FRONT WHEEL**

Torque: 103 N·m (1,050 kgf·cm, 76 ft·lbf)

8. **CHECK FRONT WHEEL ALIGNMENT**

(See [page SA-4](#))

9. **CHECK ABS SPEED SENSOR SIGNAL**

w/VSC (See [page DI-318](#))

w/o VSC (See [page DI-251](#))