

## REMOVAL

1. REMOVE REAR WHEEL
2. REMOVE REAR FENDER APRON SEAL

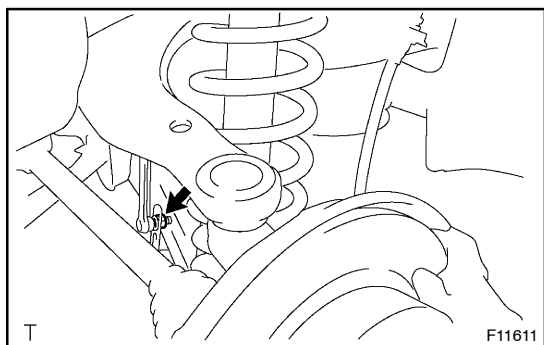

3. w/ DISCHARG HEAD LAMP  
DISCONNECT HEIGHT CONTROL SENSOR LINK

Remove the nut and disconnect the height control sensor link from lower arm bracket.

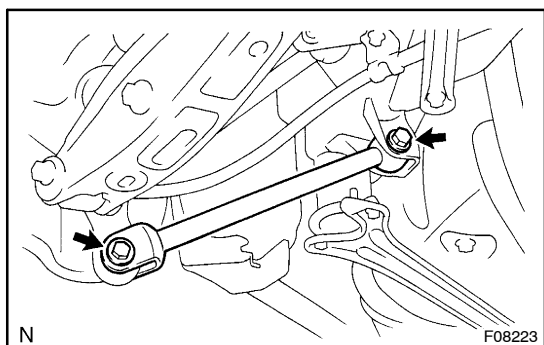

4. REMOVE NO. 1 LOWER SUSPENSION ARM

Remove the 2 bolts, nuts, and No. 1 lower suspension arm.

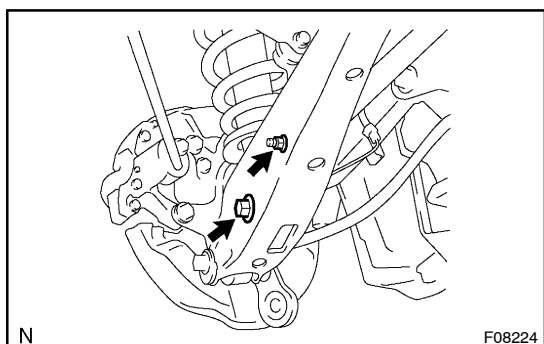

5. REMOVE NO. 2 LOWER SUSPENSION ARM

- (a) Remove the nut, bolt and bracket, and disconnect the stabilizer bar link from the No. 2 lower suspension arm.
- (b) Remove the bolt and nut, and disconnect the shock absorber from the No. 2 lower suspension arm.

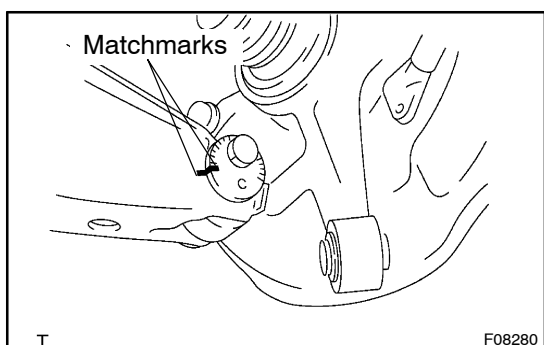

- (c) Place matchmarks on the cam bolt and No. 2 lower suspension arm.
- (d) Remove the nut, cam plate and cam bolt, and disconnect the axle carrier.

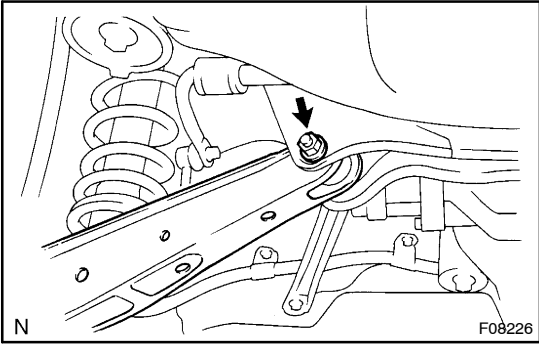

- (e) Remove the nut, washer, bolt and No. 2 lower suspension arm from the rear suspension member.