

# BLOWER UNIT COMPONENTS

AC

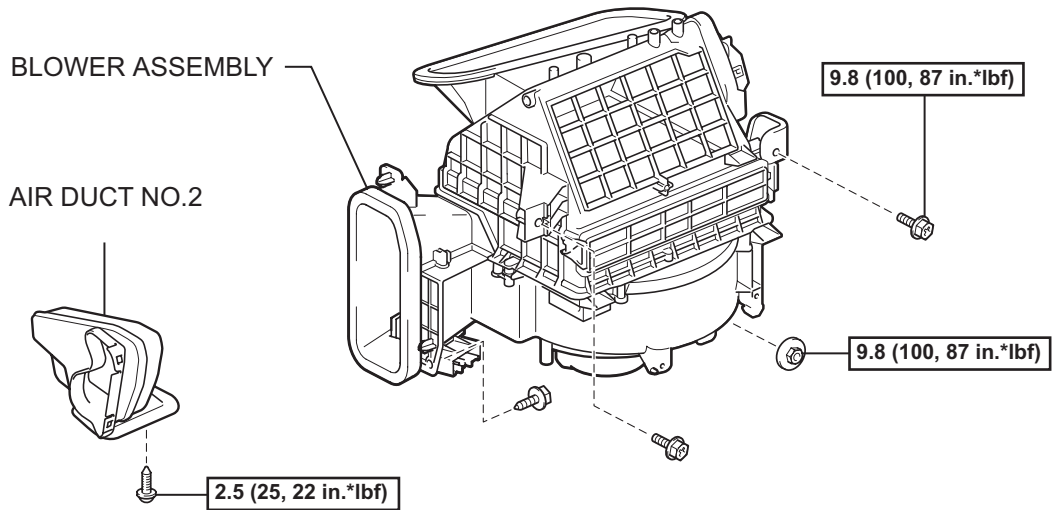

## RECIRCULATION DAMPER SERVO SUB-ASSEMBLY

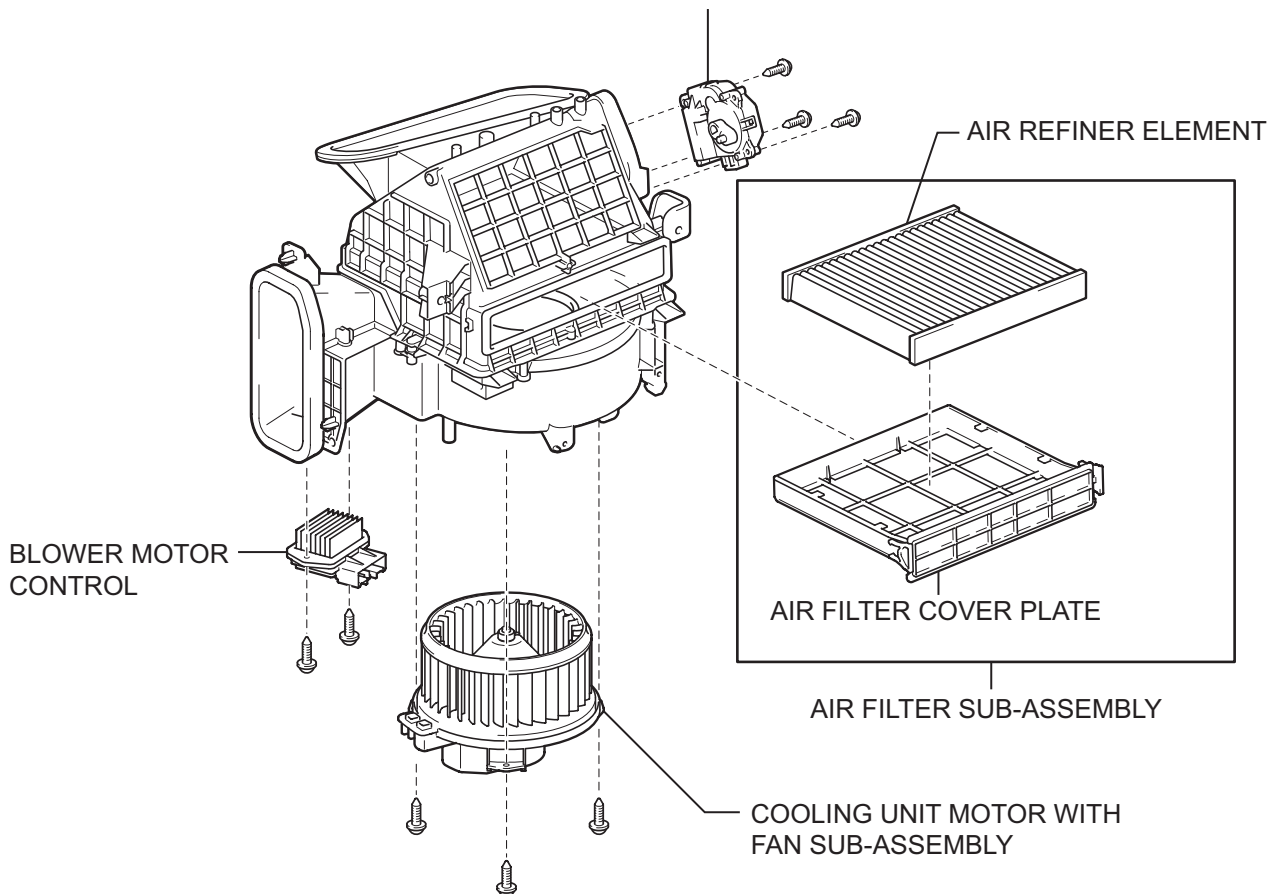

**N\*m (kgf\*cm, ft.\*lbf)** : Specified torque

**REMOVAL**

1. **DISCONNECT CABLE FROM NEGATIVE BATTERY TERMINAL**
2. **REMOVE FRONT DOOR SCUFF PLATE RH**
3. **REMOVE COWL SIDE TRIM RH SUB-ASSEMBLY**
4. **REMOVE INSTRUMENT PANEL UNDER COVER NO.2 SUB-ASSEMBLY (See page [IP-13](#))**
5. **REMOVE GLOVE COMPARTMENT DOOR ASSEMBLY (See page [IP-13](#))**
6. **REMOVE AIR DUCT NO.2**
  - (a) Remove the screw.
  - (b) Release the 2 claws and remove the air duct No. 2.

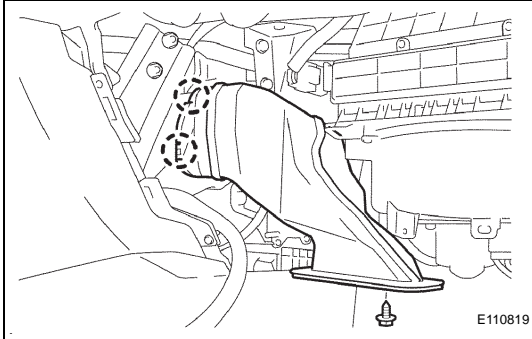
**AC**

7. **DISCONNECT WIRING AIR INDICATOR HARNESS NO.2 SUB-ASSEMBLY**
  - (a) Remove the clamp and disconnect the 2 connectors.

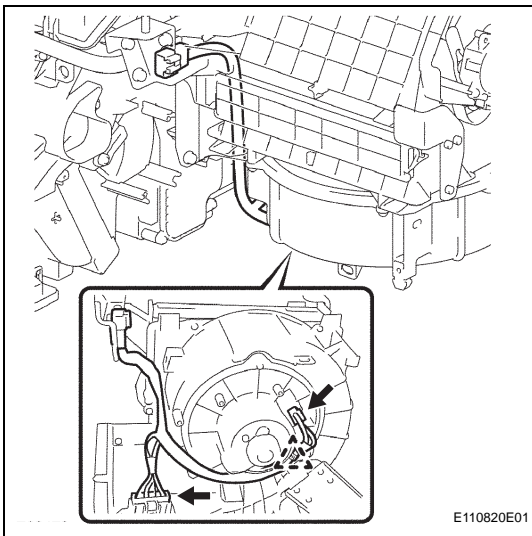

8. **REMOVE BLOWER ASSEMBLY**
  - (a) Remove the clamp and disconnect the connectors.

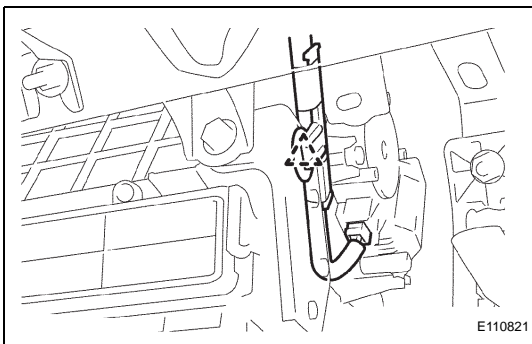

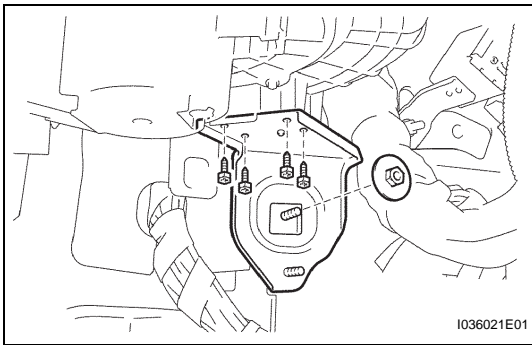

- (b) Remove the 4 screws and the nut, and then the bracket.

AC

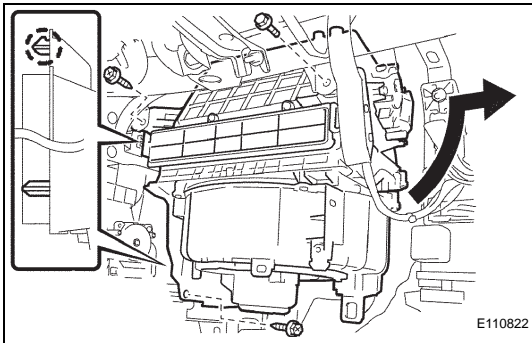

- (c) Remove the bolt and 2 screws.  
 (d) Release the claw and remove the blower assembly.

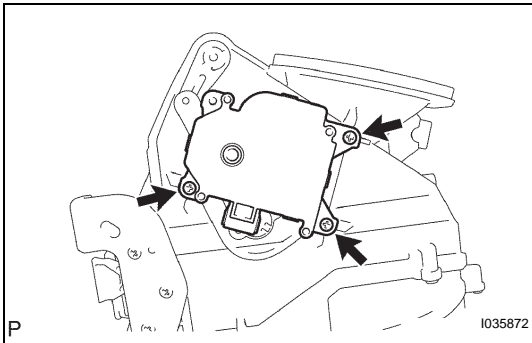

## DISASSEMBLY

### 1. REMOVE AIR INLET SERVO MOTOR

- (a) Remove the 3 screws and air inlet servomotor.

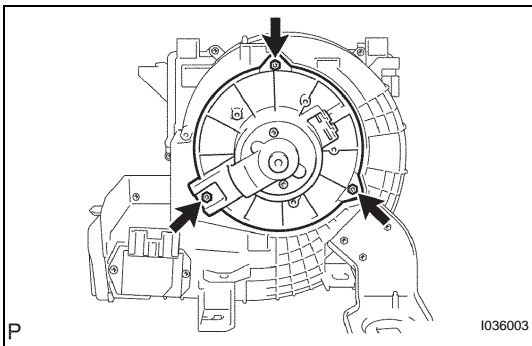

### 2. REMOVE COOLING UNIT MOTOR WITH FAN SUB-ASSEMBLY

- (a) Remove the 3 screws and cooling unit motor with fan sub-assembly.

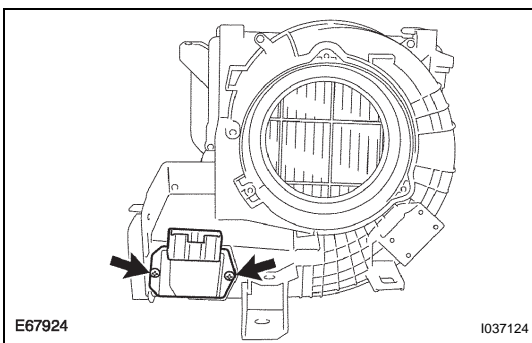

### 3. REMOVE BLOWER MOTOR CONTROL

- (a) Remove the 2 screws and blower motor control.

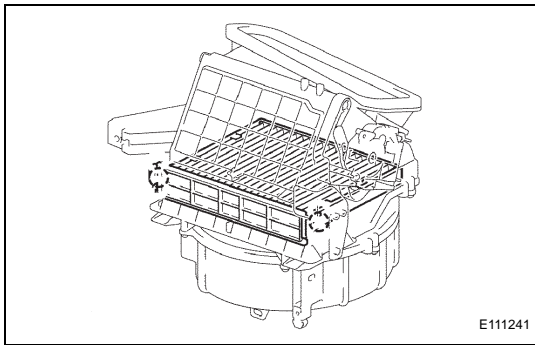

**4. REMOVE CLEAN AIR FILTER**

- (a) Release the 2 claws and remove the air filter sub-assembly.

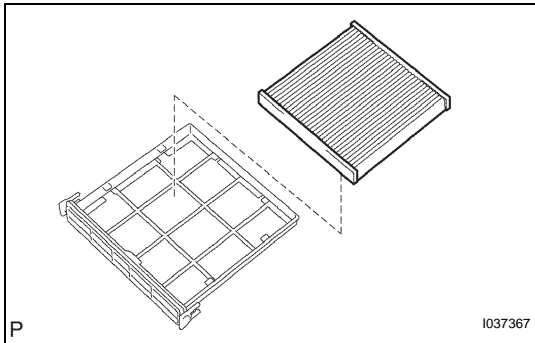

- (b) Remove the air refiner element from the air filter cover plate.

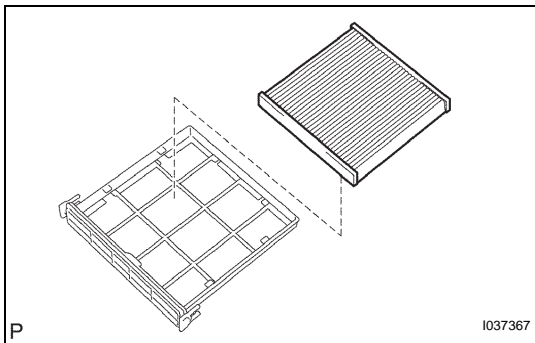

**REASSEMBLY**

**1. INSTALL CLEAN AIR FILTER**

- (a) Install the clean air filter.
- (b) Engage the 2 claws to install the air filter sub-assembly.

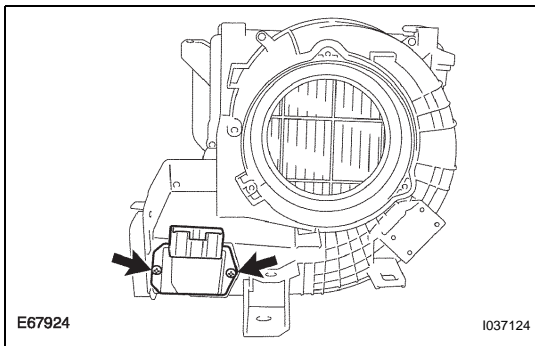

**2. INSTALL BLOWER MOTOR CONTROL**

- (a) Install the blower motor control with the 2 screws.

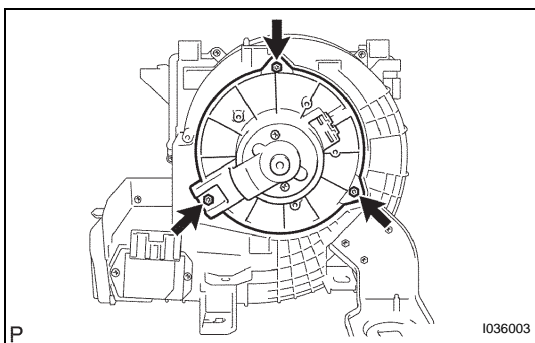

**3. INSTALL COOLING UNIT MOTOR WITH FAN SUB-ASSEMBLY**

- (a) Install the cooling unit motor with fan sub-assembly with the 3 screws.

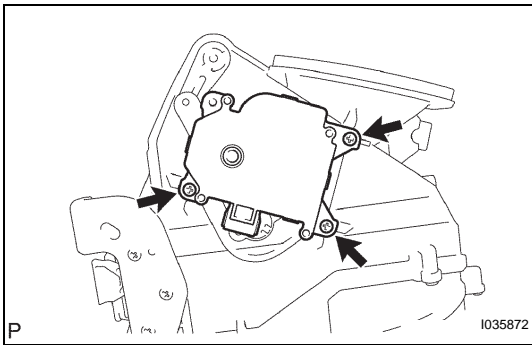

#### 4. INSTALL AIR INLET SERVO MOTOR

- (a) Install the air inlet servomotor with the 3 screws.

AC

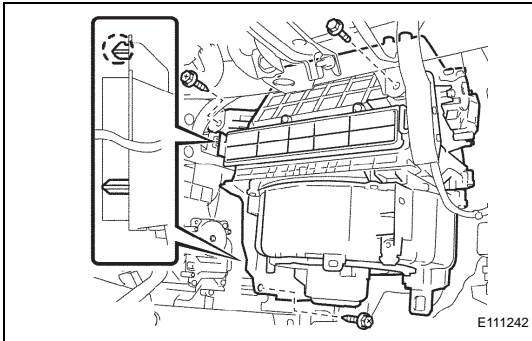

## INSTALLATION

### 1. INSTALL BLOWER ASSEMBLY

- (a) Install the blower assembly with the claw.  
 (b) Install the bolt and 2 screws.

**Torque: BOLT**

**9.8 N\*m (100 kgf\*cm, 87 in.\*lbf)**

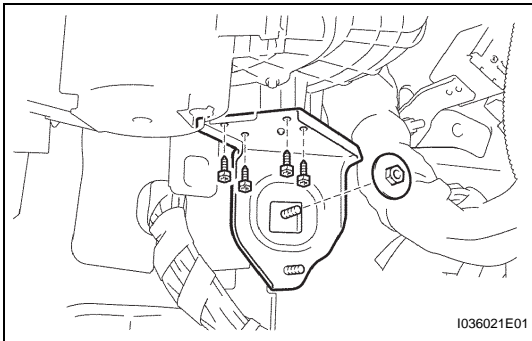

- (c) Install the bracket with the 4 screws and nut.

**Torque: NUT**

**9.8 N\*m (100 kgf\*cm, 87 in.\*lbf)**

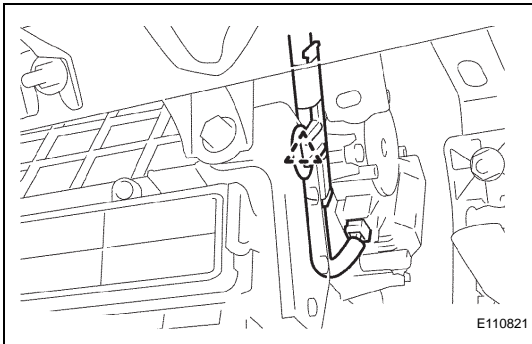

- (d) Install the clamp and connect the connectors.

### 2. INSTALL WIRING AIR INDICATOR HARNESS NO.2 SUB-ASSEMBLY

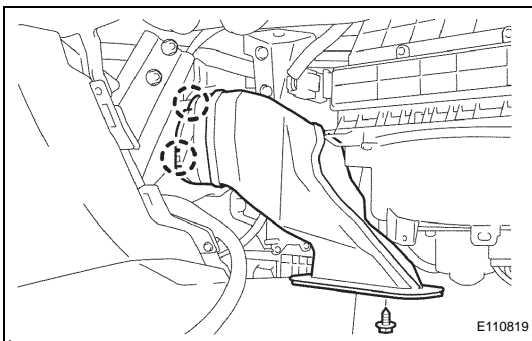

### 3. INSTALL AIR DUCT NO.2

- (a) Install the air duct No. 2 with the screw.

**Torque: 2.5 N\*m (25 kgf\*cm, 22 in.\*lbf)**

### 4. INSTALL GLOVE COMPARTMENT DOOR ASSEMBLY (See page IP-27)

### 5. INSTALL INSTRUMENT PANEL UNDER COVER NO.2 SUB-ASSEMBLY (See page IP-28)

### 6. INSTALL COWL SIDE TRIM RH SUB-ASSEMBLY

### 7. INSTALL FRONT DOOR SCUFF PLATE RH

8. **CONNECT CABLE TO NEGATIVE BATTERY TERMINAL**

9. **PERFORM INITIALIZATION**

**NOTICE:**

**Some systems need initialization when disconnecting the cable from the negative battery terminal.**