

# SPEED SENSOR

## COMPONENTS

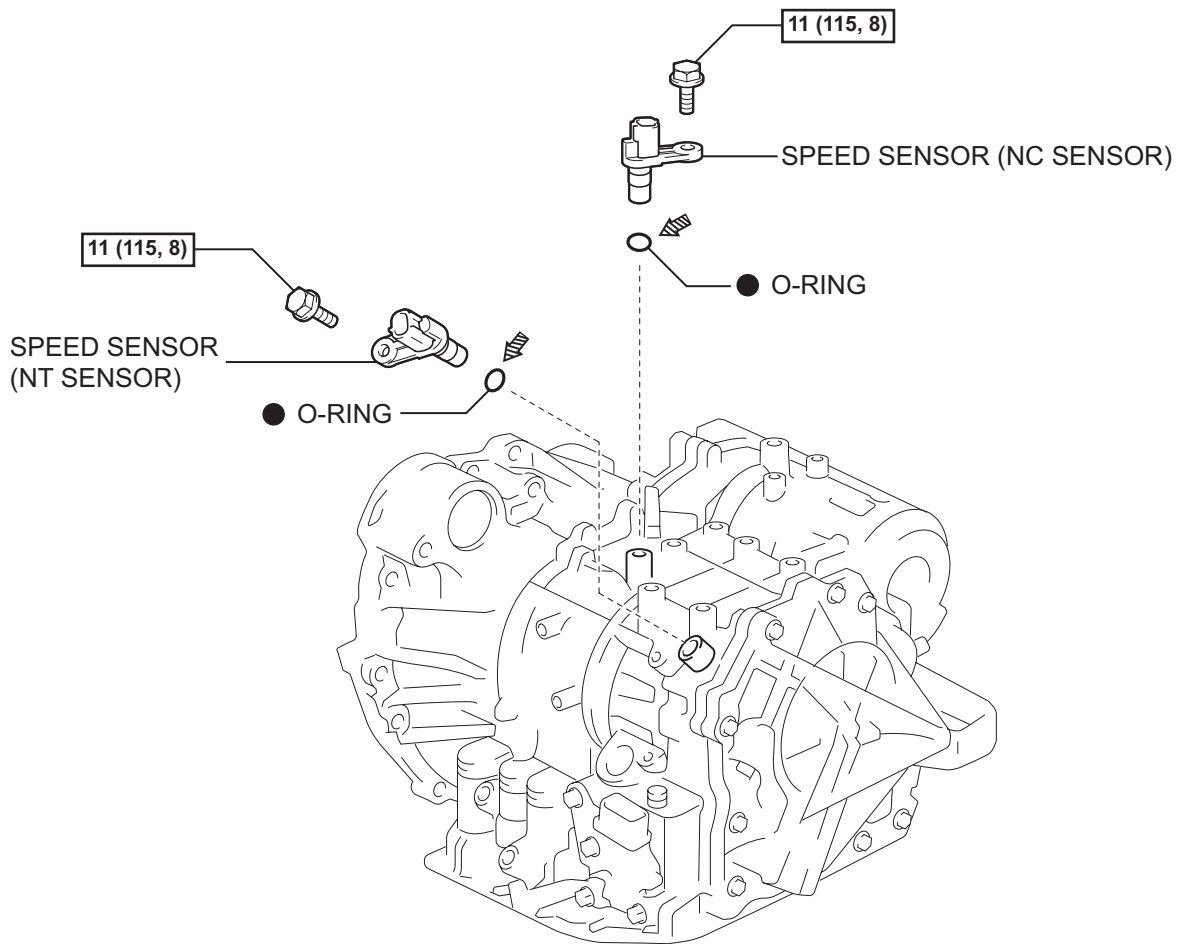

◄ Precoated part ● Non-reusable part

**11 (115, 8)** : Specified torque

AX

## REMOVAL

1. REMOVE BATTERY
2. REMOVE AIR CLEANER ASSEMBLY  
HINT:  
(See page [ST-5](#))
3. REMOVE AIR CLEANER HOSE NO.1  
HINT:  
(See page [ST-5](#))
4. REMOVE AIR CLEANER INLET NO.2  
HINT:  
(See page [ST-5](#))
5. REMOVE AIR CLEANER BRACKET  
HINT:  
(See page [ST-5](#))
6. REMOVE AIR CLEANER INLET NO.1  
HINT:  
(See page [ST-5](#))
7. REMOVE SPEED SENSOR (NT SENSOR)
  - (a) Disconnect the speed sensor connector.
  - (b) Remove the bolt and speed sensor.
8. REMOVE SPEED SENSOR (NC SENSOR)
  - (a) Disconnect the speed sensor connector.
  - (b) Remove the bolt and speed sensor.

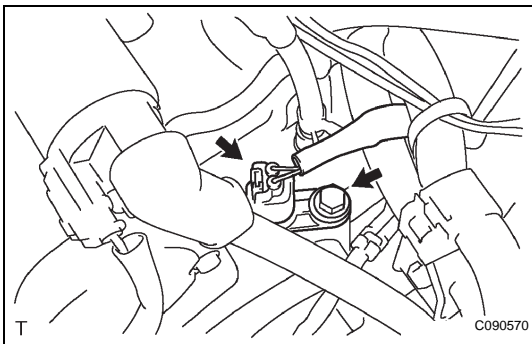
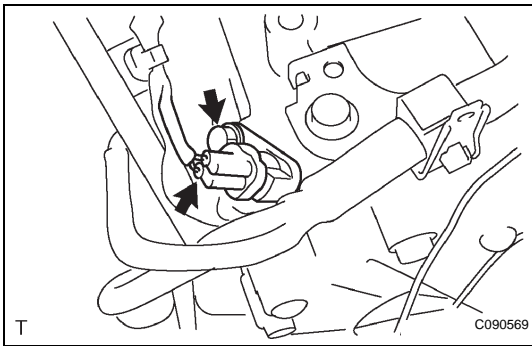

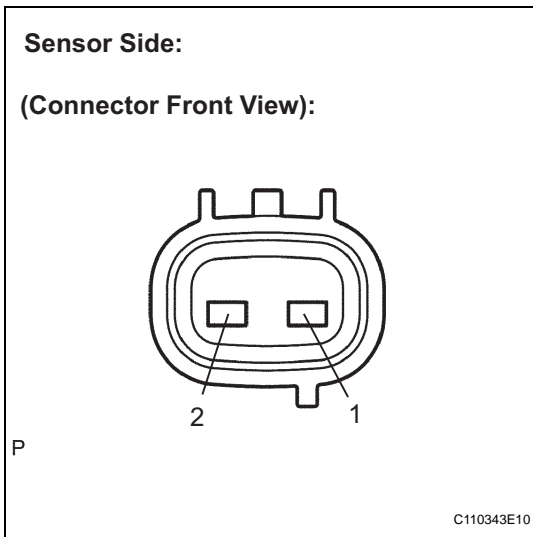

## INSPECTION

### 1. INSPECT SPEED SENSOR (NT SENSOR)

- (a) Disconnect the speed sensor connector from the transaxle.
- (b) Measure the resistance according to the value(s) in the table below.

**Resistance:**

Tester Connection	Specified Condition 20°C (68°F)
1 - 2	560 to 680 Ω

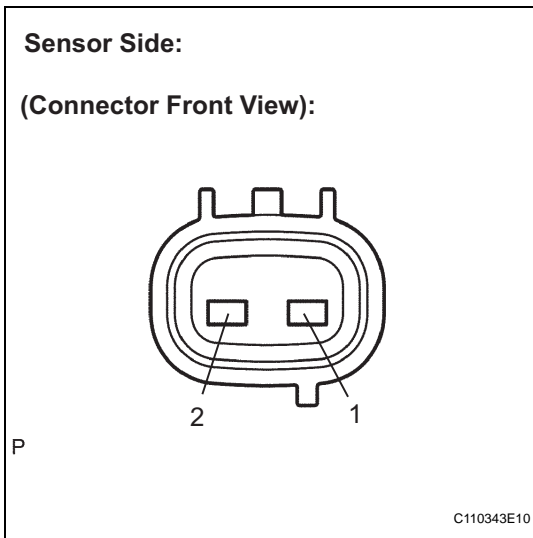

### 2. INSPECT SPEED SENSOR (NC SENSOR)

- (a) Disconnect the speed sensor connector from the transaxle.
- (b) Measure the resistance according to the value(s) in the table below.

**Resistance:**

Tester Connection	Specified Condition 20°C (68°F)
1 - 2	560 to 680 Ω

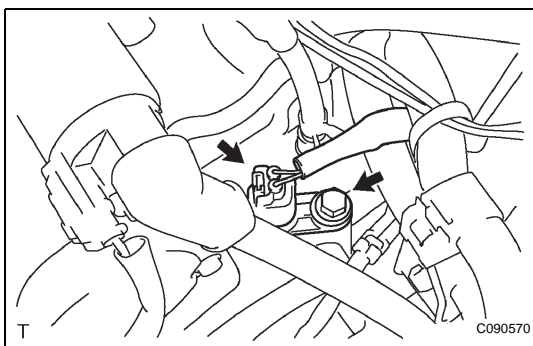

## INSTALLATION

### 1. INSTALL SPEED SENSOR (NC SENSOR)

- (a) Coat the O-ring with ATF.
- (b) Install the speed sensor with the bolt.  
**Torque: 11 N\*m (115 kgf\*cm, 8 ft.\*lbf)**  
HINT:  
Make sure to install the same manufacturer's sensor.
- (c) Connect the speed sensor connector.

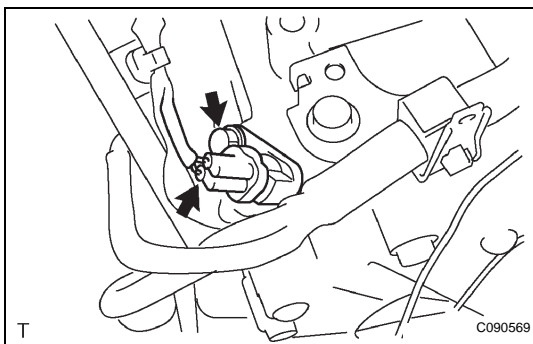

### 2. INSTALL SPEED SENSOR (NT SENSOR)

- (a) Coat the O-ring with ATF.
- (b) Install the speed sensor with the bolt.  
**Torque: 11 N\*m (115 kgf\*cm, 8 ft.\*lbf)**  
HINT:  
Make sure to install the same manufacturer's sensor.
- (c) Connect the speed sensor connector.

**3. INSTALL AIR CLEANER INLET NO.1**

HINT:

(See page [ST-12](#))**4. INSTALL AIR CLEANER BRACKET**

HINT:

(See page [ST-12](#))**5. INSTALL AIR CLEANER INLET NO.2**

HINT:

(See page [ST-12](#))**6. INSTALL AIR CLEANER HOSE NO.1**

HINT:

(See page [ST-12](#))**7. INSTALL AIR CLEANER ASSEMBLY**

HINT:

(See page [ST-12](#))**8. INSTALL BATTERY****9. PERFORM INITIALIZATION**

HINT:

Some systems need initialization when disconnecting the cable from the negative battery terminal (See page [AX-1](#)).