

FRONT AXLE HUB BOLT

COMPONENTS

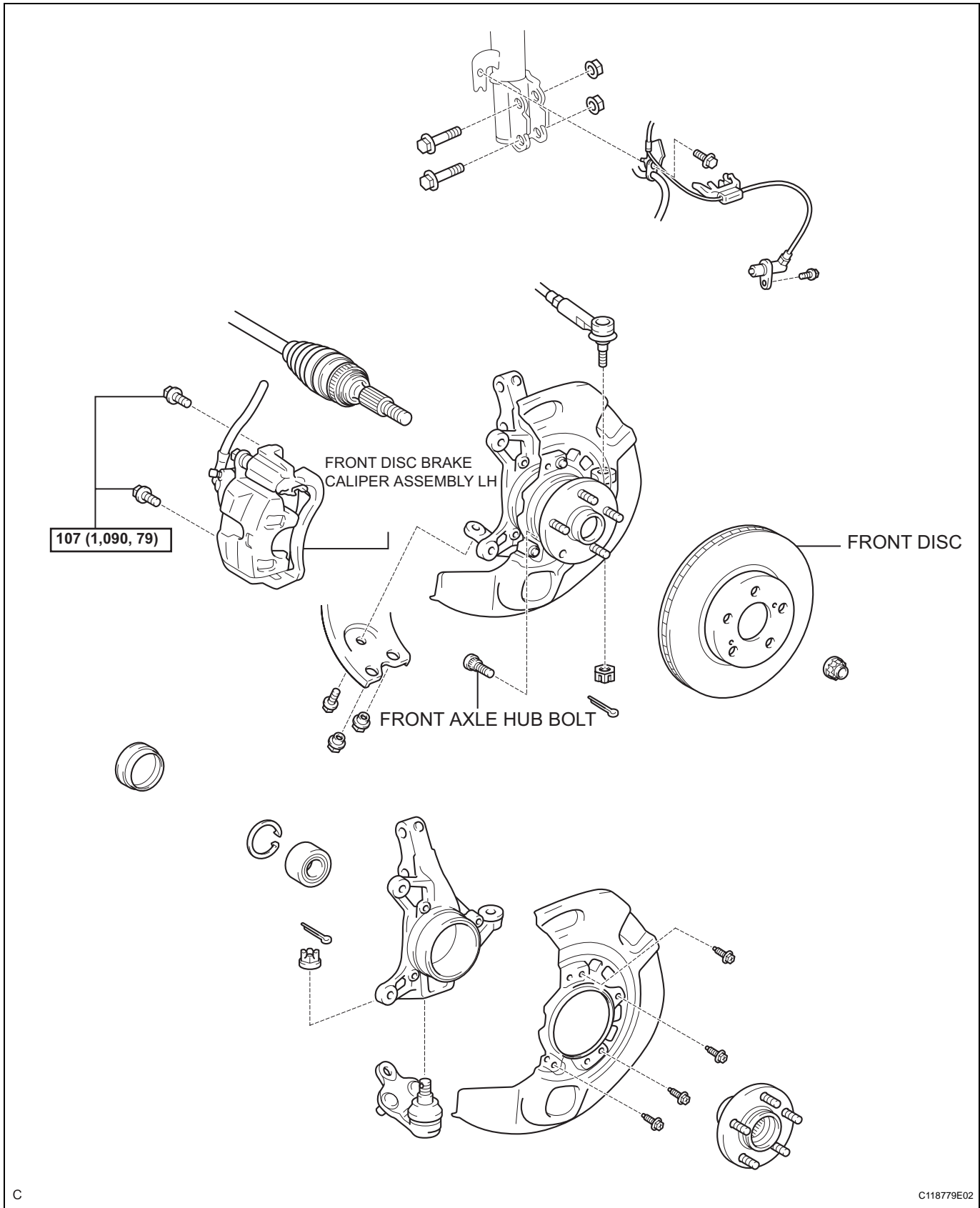

AH

REPLACEMENT

HINT:

Replace the RH side using the same procedures as for the LH side.

1. REMOVE FRONT WHEEL
2. SEPARATE FRONT DISC BRAKE CALIPER ASSEMBLY LH (See page [AH-5](#))

3. REMOVE FRONT DISC

4. REMOVE FRONT AXLE LH HUB BOLT

- (a) Temporarily install the 2 nuts and washers to the front axle LH hub bolt as shown in the illustration.
- (b) Using SST(s) and a screwdriver or an equivalent to hold the front axle, remove the front axle LH hub bolt.

SST 09628-10011

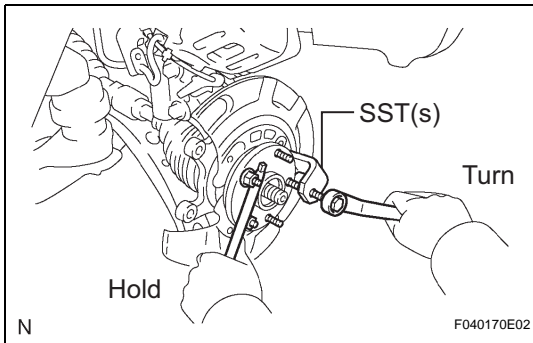

5. INSTALL FRONT AXLE LH HUB BOLT

- (a) Install a washer and nut to a new front axle LH hub bolt as shown in the illustration.
- (b) Using a screwdriver to hold the front axle, install the hub bolt by torquing the nut.

6. INSTALL FRONT DISC

7. INSTALL FRONT DISC BRAKE CALIPER ASSEMBLY LH (See page [AH-9](#))

8. INSTALL FRONT WHEEL

Torque: 103 N*m (1,050 kgf*cm, 76 ft.*lbf)

