

FRONT AXLE HUB

COMPONENTS

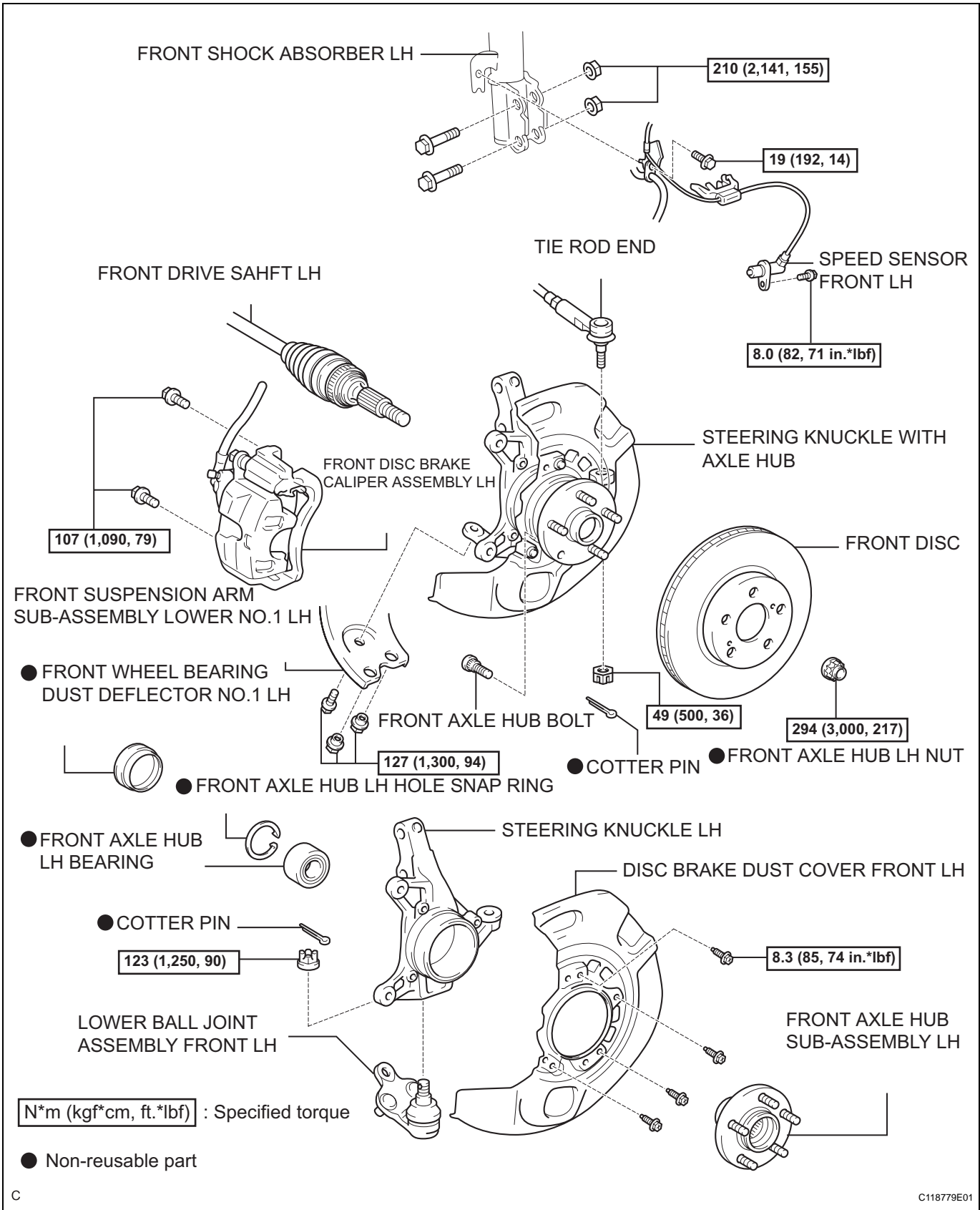

AH

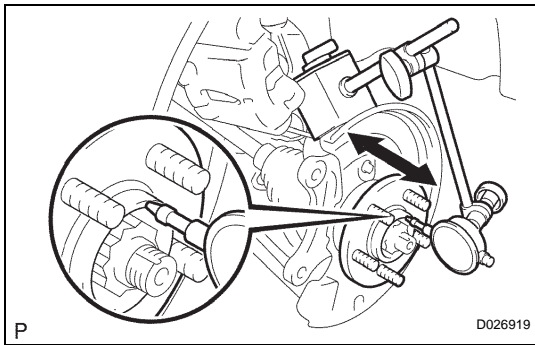

ON-VEHICLE INSPECTION

1. INSPECT FRONT AXLE HUB BEARING BACKLASH

- (a) Using a dial gauge, check for backlash near the center of the axle hub.

Maximum:

0.05 mm (0.0020 in.)

If backlash exceeds the maximum, replace the bearing.

NOTICE:

Ensure that the dial gauge is set at right angles to the measurement surface.

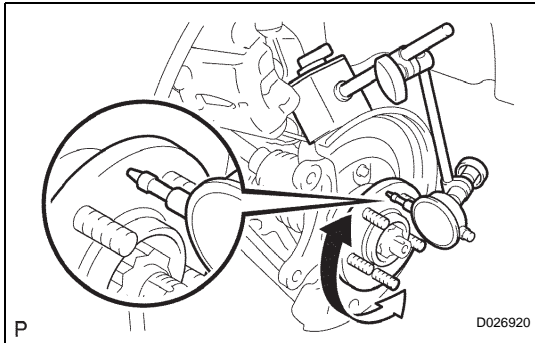

2. INSPECT FRONT AXLE HUB BEARING DEVIATION

- (a) Using a dial gauge, check for deviation in the surface of the axle hub outside the hub bolt.

Maximum:

0.05 mm (0.0020 in.)

If deviation exceeds the maximum, replace the axle hub.

NOTICE:

Ensure that the dial gauge is set at right angles to the measurement surface.