

# REAR DIFFERENTIAL CARRIER ASSEMBLY

## COMPONENTS

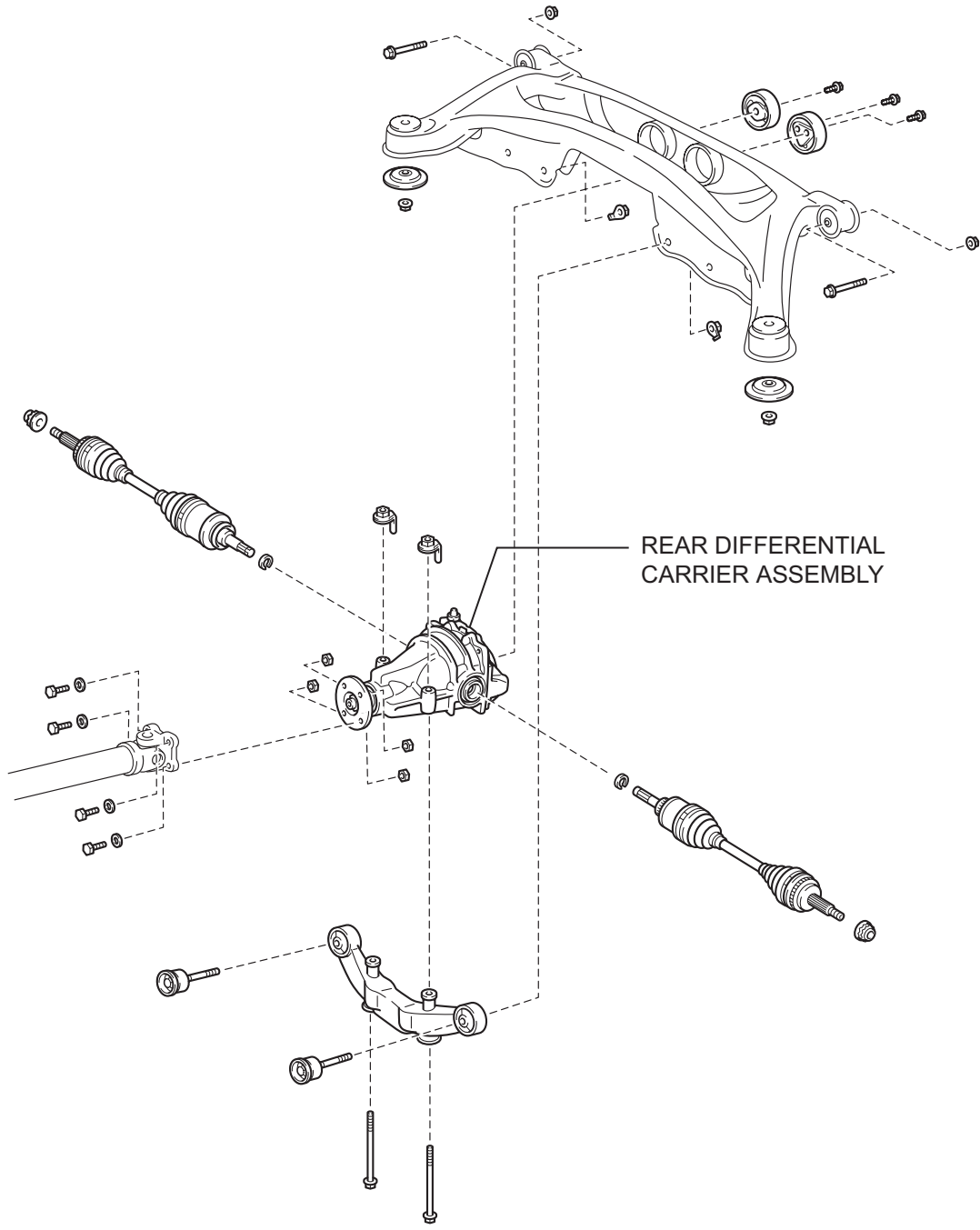

DF

## REMOVAL

1. REMOVE REAR WHEEL
2. REMOVE ENGINE UNDER COVER ASSEMBLY (See page EX-3)
3. REMOVE NO. 2 ENGINE UNDER COVER (See page EX-3)
4. REMOVE PROPELLER W/CENTER BEARING SHAFT ASSEMBLY  
HINT:  
(See page PR-3)
5. REMOVE EXHAUST PIPE ASSEMBLY  
HINT:  
(See page EX-3)
6. REMOVE REAR DIFFERENTIAL FILLER PLUG  
(a) Using a hexagon wrench (10 mm), remove the filler plug and gasket.
7. REMOVE REAR DIFFERENTIAL DRAIN PLUG  
(a) Using a hexagon wrench (10 mm), remove the drain plug and gasket, and drain the oil.
8. REMOVE REAR DRIVE SHAFT ASSEMBLY LH  
HINT:  
(See page DS-21)
9. REMOVE REAR SUSPENSION MEMBER SUB-ASSEMBLY  
(a) Remove the rear suspension member sub-assembly.
10. REMOVE REAR DIFFERENTIAL CARRIER ASSEMBLY  
(a) Support the differential carrier assembly rear with jack.  
(b) Remove the 2 bolts and 2 lock nuts, and separate the rear differential support No. 1 from the rear suspension member sub-assembly.

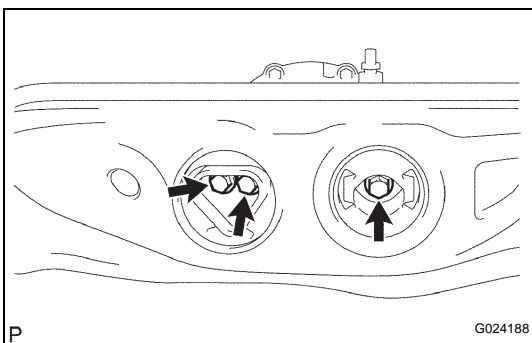
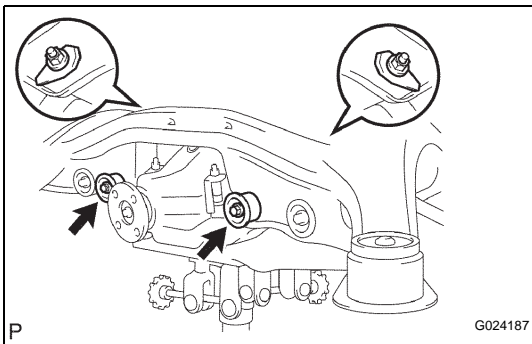

- (c) Remove the 3 bolts and differential carrier assembly rear from the rear suspension member sub-assembly.

### NOTICE:

**Be careful not to drop the differential carrier assembly rear.**