

11. REMOVE NO. 1 REAR DIFFERENTIAL SUPPORT

- (a) Remove the 2 bolts, 2 lock nuts and rear differential support No. 1 from the differential carrier assembly rear.

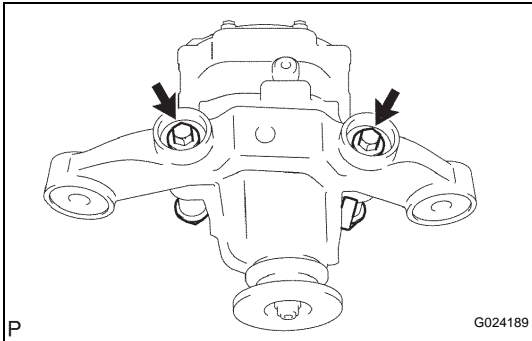

INSTALLATION

1. INSTALL NO. 1 REAR DIFFERENTIAL SUPPORT

- (a) Install the rear differential support No. 1 to the differential carrier assembly rear with the 2 bolts and 2 lock nuts.

Torque: 103 N*m (1,050 kgf*cm, 76 ft.*lbf)

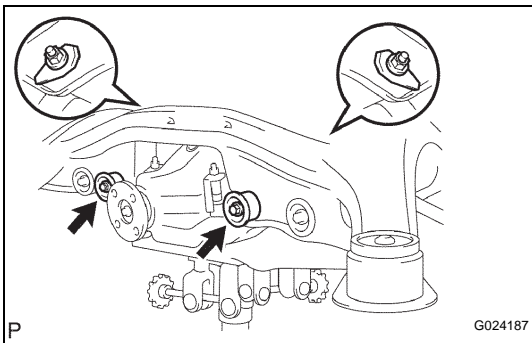

2. INSTALL REAR DIFFERENTIAL CARRIER ASSEMBLY

- (a) Jack up the differential carrier assembly rear and rear suspension member with a jack.
 (b) Connect the rear differential support No. 1 to the rear suspension member with 2 bolts and 2 lock nuts.

Torque: 137 N*m (1,400 kgf*cm, 101 ft.*lbf)

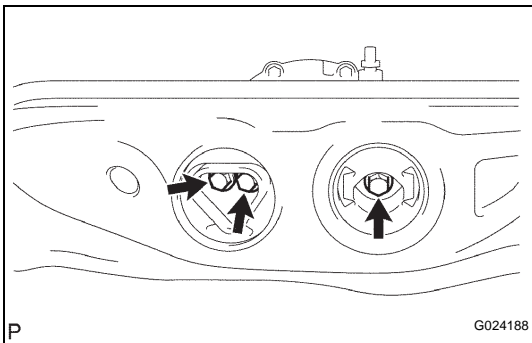

- (c) Install the differential carrier assembly rear to the rear suspension member sub-assembly with the 3 bolts.

Torque: 95 N*m (970 kgf*cm, 70 ft.*lbf)

3. INSTALL REAR SUSPENSION MEMBER SUB-ASSEMBLY

- (a) Install the rear suspension member sub-assembly.

4. INSTALL REAR DRIVE SHAFT ASSEMBLY LH

- HINT:
 (See page [DS-27](#))

5. INSTALL EXHAUST PIPE ASSEMBLY

- HINT:
 (See page [EX-6](#))

6. INSTALL PROPELLER W/CENTER BEARING SHAFT ASSEMBLY

- HINT:
 (See page [PR-9](#))

7. **FULLY TIGHTEN PROPELLER W/CENTER BEARING SHAFT ASSEMBLY**
HINT:
(See page [PR-9](#))
8. **INSTALL NO. 2 ENGINE UNDER COVER (See page [EX-7](#))**
9. **INSTALL ENGINE UNDER COVER ASSEMBLY (See page [EX-7](#))**
10. **INSTALL REAR DIFFERENTIAL DRAIN PLUG**
 - (a) Using a hexagon wrench (10 mm), install the filler plug with a new gasket.
Torque: 49 N*m (500 kgf*cm, 36 ft.*lbf)
11. **ADD DIFFERENTIAL OIL**
 - (a) Fill the rear differential carrier assembly with hypoid gear oil.
12. **INSPECT DIFFERENTIAL OIL**
HINT:
(See page [DF-3](#))
13. **INSTALL REAR DIFFERENTIAL FILLER PLUG**
 - (a) Using a hexagon wrench (10 mm), install the filler plug with a new gasket.
Torque: 49 N*m (500 kgf*cm, 36 ft.*lbf)
14. **INSTALL REAR WHEEL**
Torque: 103 N*m (1,050 kgf*cm, 76 ft.*lbf)
15. **INSPECT AND ADJUST REAR WHEEL ALIGNMENT**
HINT:
(See page [SP-7](#))
16. **CHECK FOR EXHAUST GAS LEAKAGE**
HINT:
(See page [EX-6](#))
17. **ADJUST VEHICLE HEIGHT**
HINT:
(See page [SC-15](#))
18. **ADJUST HEADLIGHT AIMING (w/ HID)**
HINT:
(See page [LI-14](#))
19. **CHECK ABS SPEED SENSOR SIGNAL**
HINT:
(See page [BC-16](#))