

## ADJUSTMENT

### 1. INSPECT HOOD SUB-ASSEMBLY

- (a) Check that the clearance is within the standard range.

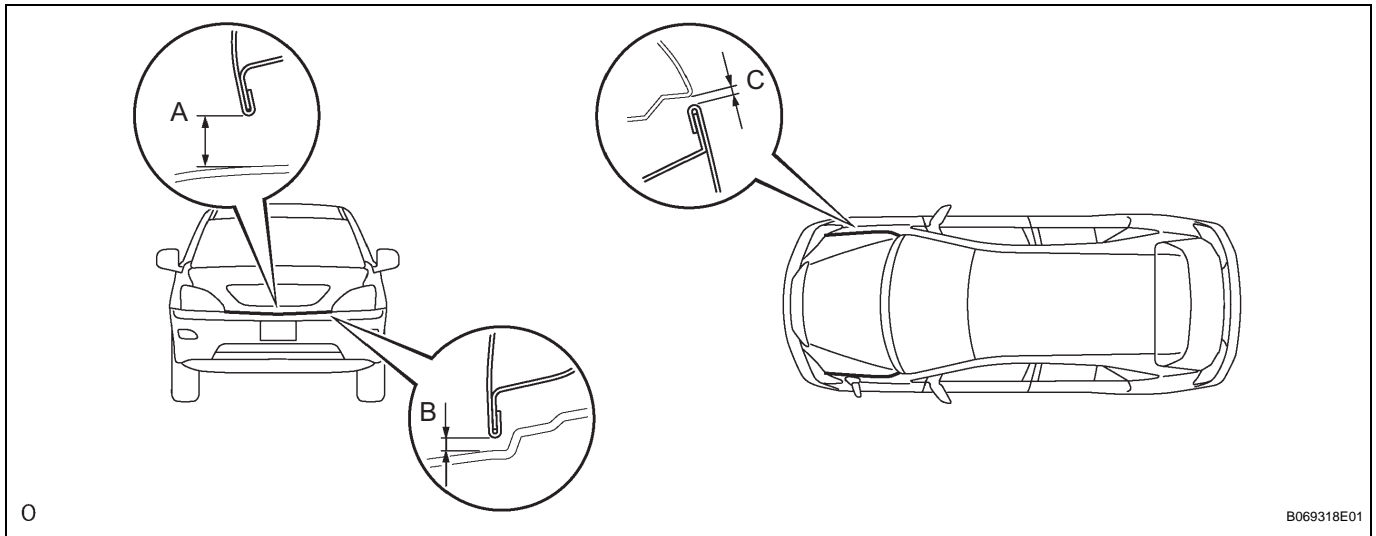

#### Standard range:

A	25.1 +- 1.5 mm (0.988 +- 0.059 in.)
B	6.0 +- 1.5 mm (0.236 +- 0.059 in.)
C	4.0 +- 1.5 mm (0.157 +- 0.059 in.)

### 2. ADJUST HOOD SUB-ASSEMBLY

- (a) Horizontally and vertically adjust the hood.  
 (1) Loosen the 4 hood hinge mounting bolts on the hood side.

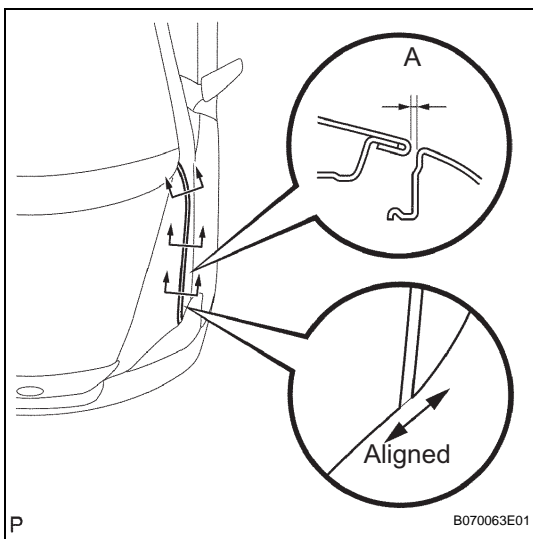
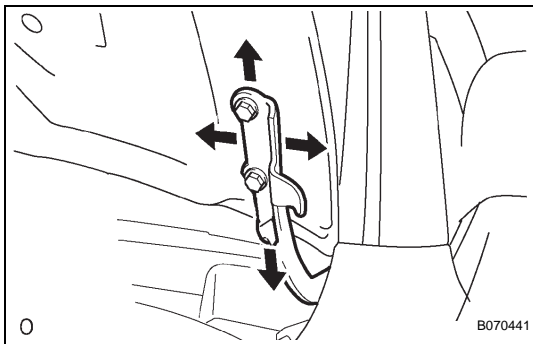

- (2) Adjust the clearance by moving the hood, so that it will be in the standard range.

#### Standard range A:

**4.0 +- 1.5 mm (0.157 +- 0.059 in.)**

- (3) Tighten the hood side hinge bolts after the adjustment.

**Torque: 13 N\*m (133 kgf\*cm, 10 ft.\*lbf)**

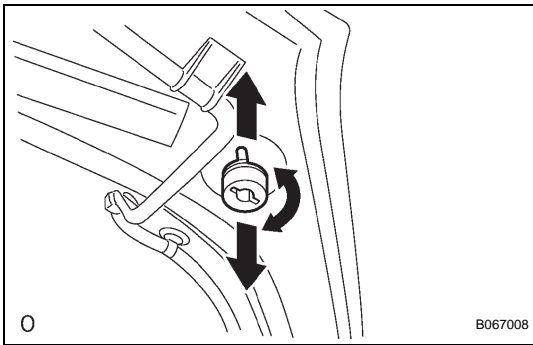

- (b) Adjust the height of the hood front end using the cushion rubber.
- (1) Adjust the cushion rubber so that the hood and the fender will be aligned.
- HINT:  
The cushion rubber moves up and down when turned.

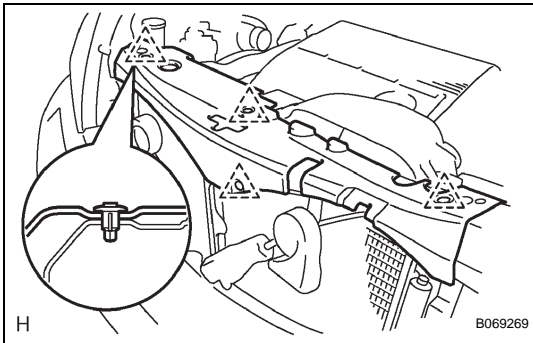

- (c) Adjust the hood lock.
- (1) Remove the 4 clips and cool air intake duct seal.

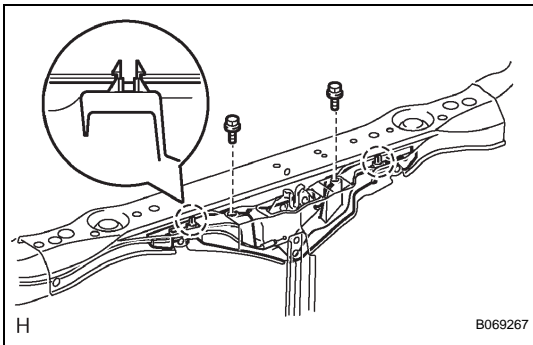

- (2) Remove the 2 bolts, disengage the 2 claws and remove the hood lock control cable cover.
- HINT:  
If the cover is damaged, replace it with a new cover.

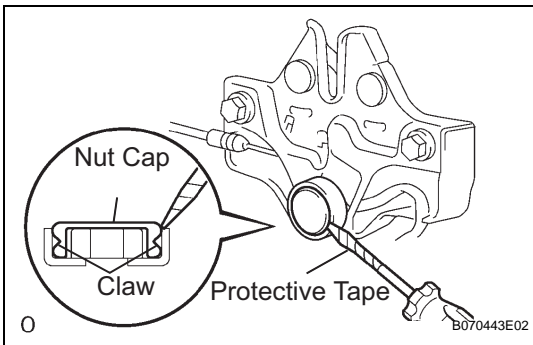

- (3) Using a screwdriver wrapped with protective tape, remove the nut cap.
- NOTICE:**  
Removing the nut cap damages the claw inside the nut cap. Therefore, the use of a new nut cap is necessary for installation.

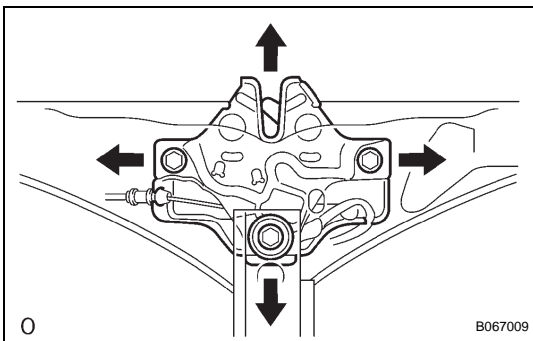

- (4) Loosen the 3 bolts.
  - (5) Adjust the hood lock position by moving the striker, so that the striker can enter smoothly.
- Torque: 8.0 N\*m (82 kgf\*cm, 71 in.\*lbf)**

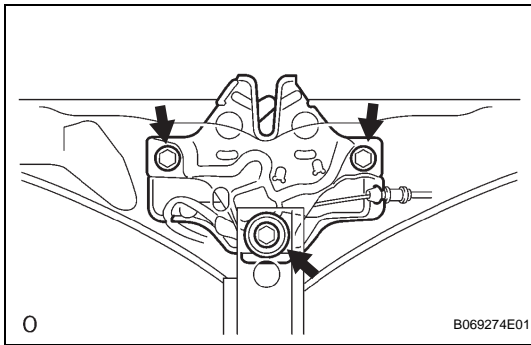
**REASSEMBLY**

1. **INSTALL HOOD LOCK ASSEMBLY**
  - (a) Connect the connector and the cable.
  - (b) Install the hood lock assembly with the 3 bolts.  
**Torque: 8.0 N\*m (82 kgf\*cm, 71 in.\*lbf)**
  - (c) Install a nut cap.

2. **INSTALL HOOD LOCK CONTROL CABLE COVER**
3. **INSTALL COOL AIR INTAKE DUCT SEAL**

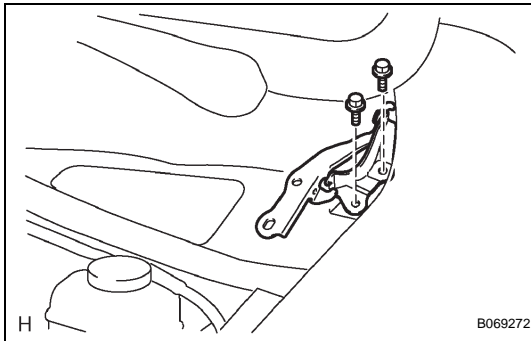

4. **INSTALL HOOD HINGE ASSEMBLY LH**
  - (a) Install the hood hinge assembly LH with the 2 bolts.  
**Torque: 13 N\*m (133 kgf\*cm, 10 ft.\*lbf)**
5. **INSTALL HOOD HINGE ASSEMBLY RH**
  - (a) Install the hood hinge assembly RH with the 2 bolts.  
**Torque: 13 N\*m (133 kgf\*cm, 10 ft.\*lbf)**

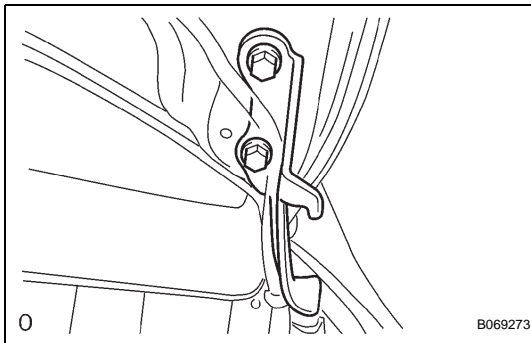

6. **INSTALL HOOD SUB-ASSEMBLY**
  - (a) Install the hood sub-assembly with the 2 bolts.  
**Torque: 13 N\*m (133 kgf\*cm, 10 ft.\*lbf)**

HINT:  
Use the same procedure for removal on the RH side.

7. **INSTALL HOOD TO FRONT FENDER SEAL RH**
8. **INSTALL HOOD TO FRONT FENDER SEAL LH**
9. **INSTALL HOOD TO RADIATOR SUPPORT SEAL**
10. **INSTALL HOOD SUPPORT ROD**
11. **INSTALL HOOD INSULATOR**
12. **INSTALL RADIATOR GRILLE**
13. **INSTALL HOOD AUXILIARY CATCH HOOK ASSEMBLY**

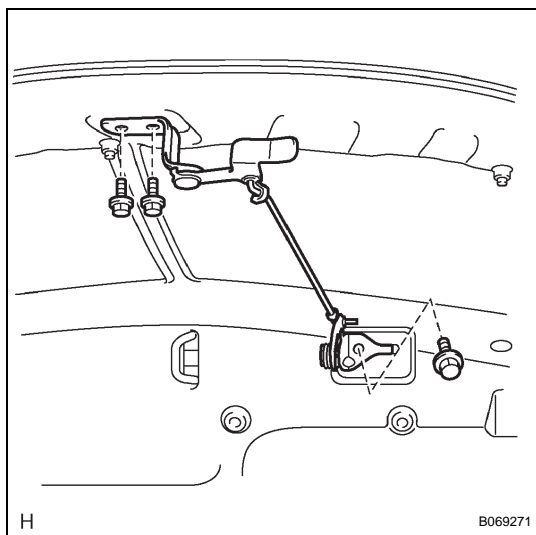

#### 14. INSTALL AUXILIARY CATCH RELEASE LEVER ASSEMBLY

- (a) Install the auxiliary catch release lever assembly and hood auxiliary catch hook assembly as a unit with the 3 bolts.

**Torque: 7.0 N\*m (71 kgf\*cm, 62 in.\*lbf)**