

REMOVAL

1. REMOVE POWER WINDOW REGULATOR MASTER SWITCH ASSEMBLY (See page [ED-100](#))
2. REMOVE FRONT DOOR LOWER FRAME BRACKET GARNISH (See page [ED-100](#))
3. REMOVE FRONT DOOR INSIDE HANDLE BEZEL PLUG (See page [ED-100](#))
4. REMOVE FRONT DOOR TRIM BOARD SUB-ASSEMBLY (See page [ED-101](#))
5. REMOVE OUTER REAR VIEW MIRROR ASSEMBLY (See page [MI-32](#))
6. REMOVE FRONT DOOR BELT MOULDING ASSEMBLY

- (a) Put protective tape under the moulding.
- (b) Using a moulding remover, disengage the claws and remove the front door belt moulding assembly.

HINT:

Tape the remover tip before use.

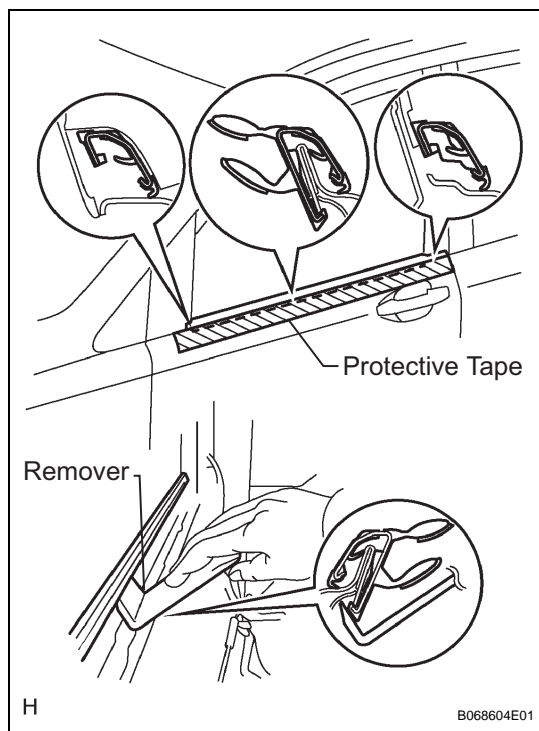

INSTALLATION

1. INSTALL FRONT DOOR BELT MOULDING ASSEMBLY
2. INSTALL OUTER REAR VIEW MIRROR ASSEMBLY
(See page [MI-37](#))
3. INSTALL FRONT DOOR TRIM BOARD SUB-ASSEMBLY LH
4. INSTALL FRONT DOOR INSIDE HANDLE BEZEL PLUG
5. INSTALL FRONT DOOR LOWER FRAME BRACKET GARNISH
6. REMOVE POWER WINDOW REGULATOR MASTER SWITCH ASSEMBLY