

REMOVAL

1. **DISCHARGE FUEL SYSTEM PRESSURE**
HINT:
See page [FU-1](#).
2. **DRAIN ENGINE COOLANT** (See page [CO-7](#))
3. **REMOVE FR WIPER ARM LH** (See page [WW-37](#))
4. **REMOVE FR WIPER ARM RH** (See page [WW-37](#))
5. **REMOVE FRONT FENDER TO COWL SIDE SEAL LH**
6. **REMOVE FRONT FENDER TO COWL SIDE SEAL RH**
7. **REMOVE COWL TOP VENTILATOR LOUVER SUB-ASSEMBLY** (See page [WW-37](#))
8. **REMOVE WINDSHIELD WIPER LINK ASSEMBLY** (See page [WW-37](#))
9. **REMOVE COWL TOP PANEL SUB-ASSEMBLY OUTER**
 - (a) Disconnect the rain sensor connector. (w/ Auto Wiper)
 - (b) Remove the 2 wire harness clamps.
 - (c) Remove the grommet.
 - (d) Remove the 6 nuts, and then remove 2 front shock absorber caps. (w/ Air Suspension)
 - (e) Remove the 4 set nuts of the shock absorber. (w/o Air Suspension)
 - (f) Remove the 4 bolts and 2 nuts, and then remove the cowl top panel outer.
 - (g) Tighten the 6 set nuts of the shock absorber.
Torque: 80 N*m (815 kgf*cm, 59 ft.*lbf)
10. **REMOVE V-BANK COVER SUB-ASSEMBLY** (See page [ES-372](#))
11. **REMOVE AIR CLEANER CAP SUB-ASSEMBLY**
 - (a) Disconnect the mass air flow meter connector.
 - (b) Disconnect the 4 vacuum hoses.
 - (c) Disconnect the ventilation hose No. 2.
 - (d) Remove the fuel vapor feed hose from the 2 hose clamps.
 - (e) Loosen the 2 air cleaner cap bolts.
 - (f) Loosen the air cleaner hose clamp bolt, and remove the air cleaner cap.
 - (g) Remove the air cleaner filter element.

FU

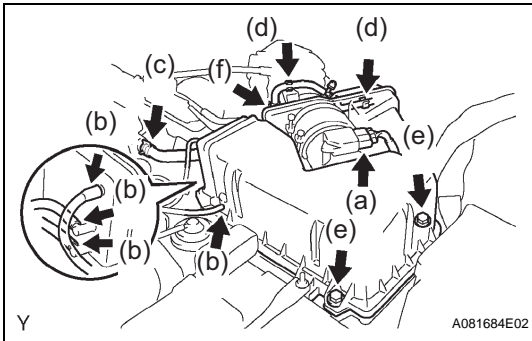
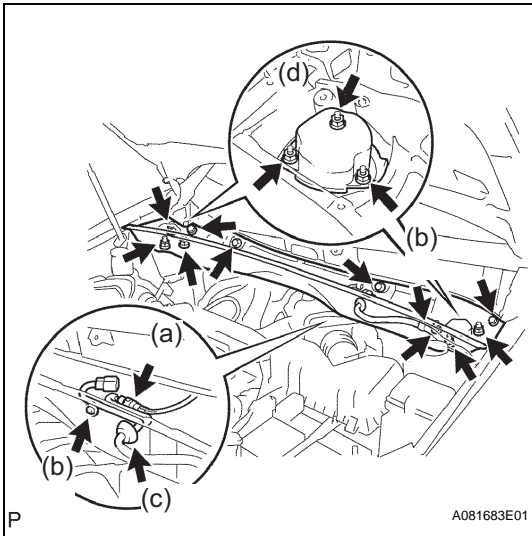
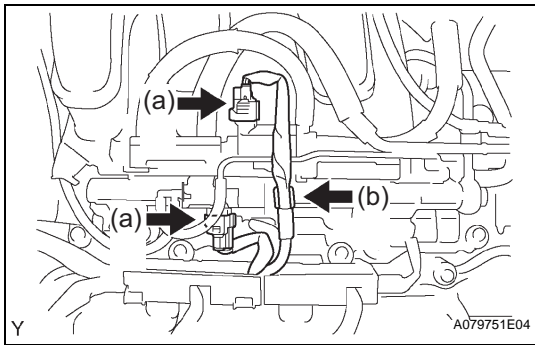

**12. REMOVE EMISSION CONTROL VALVE SET**

- (a) Disconnect the 2 VSV connectors.
- (b) Remove the wire harness clamp.

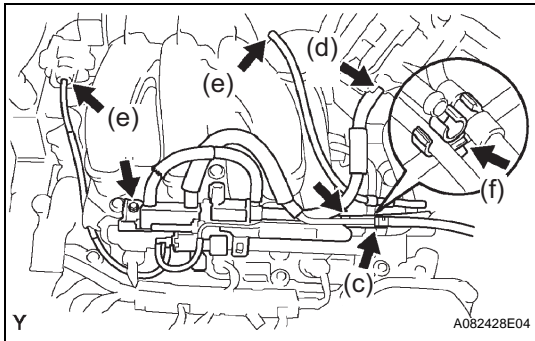

- (c) Disconnect the fuel vapor feed hose No. 1.
- (d) Disconnect the fuel vapor feed hose No. 2.
- (e) Disconnect the 2 vacuum hoses.
- (f) Remove the clamp.
- (g) Remove the 2 nuts, and then remove the emission control valve set.

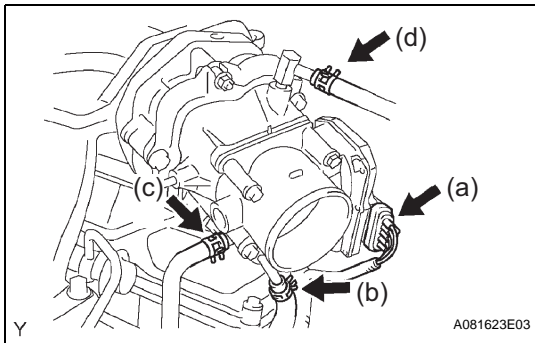
**13. REMOVE INTAKE AIR SURGE TANK**

- (a) Disconnect the throttle motor connector.
- (b) Disconnect the water by-pass hose No. 3.
- (c) Disconnect the water by-pass hose No. 2.
- (d) Disconnect the union to check valve hose.

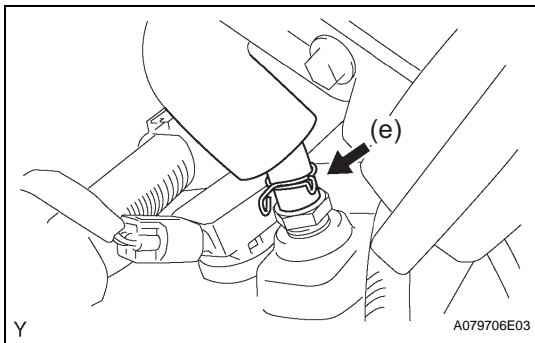

- (e) Disconnect the ventilation hose.

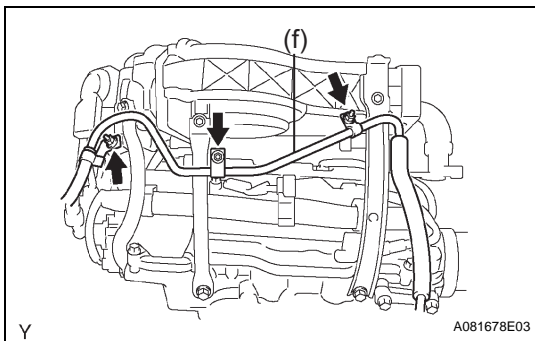

- (f) Remove the 3 nuts and separate the pressure feed tube.

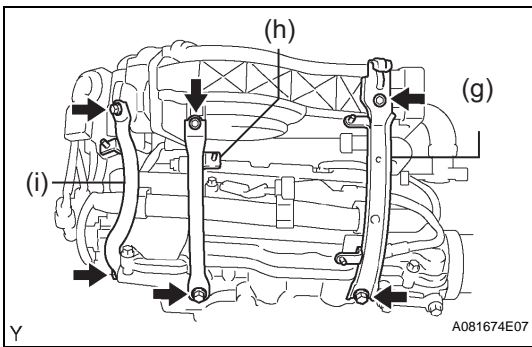

- (g) Remove the 2 bolts, and then remove the engine hanger No. 1.
- (h) Remove the 2 bolts, and then remove the surge tank stay No. 1.
- (i) Remove the 2 bolts, and then remove the surge tank stay No. 2.

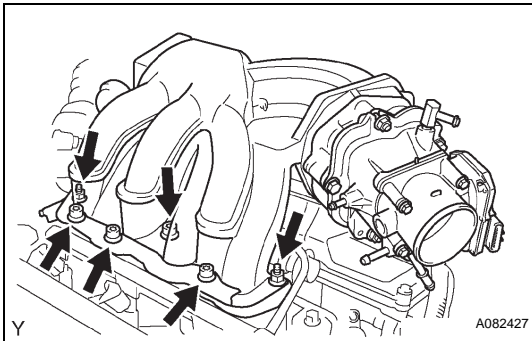

- (j) Using a socket hexagon wrench 8, remove the 4 bolts.
- (k) Remove the 2 nuts, and then remove the emission control valve bracket and the intake air surge tank.
- (l) Remove the gasket from the intake air surge tank.

FU

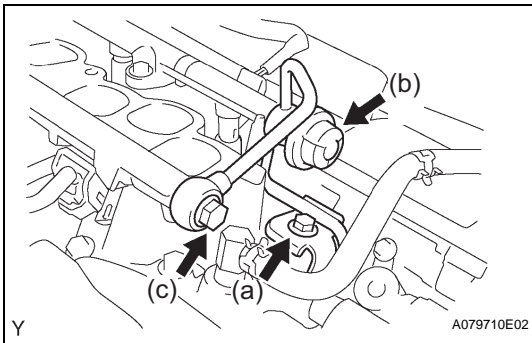

14. SEPARATE FUEL PIPE SUB-ASSEMBLY NO.1

- (a) Remove the bolt and separate the fuel pipe No. 1.
- (b) Remove the fuel pressure pulsation damper and the 2 gaskets.
- (c) Remove the fuel pipe No. 2 union bolt and the 2 gaskets.

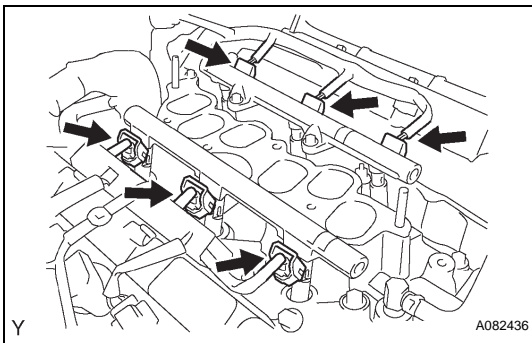

15. REMOVE FUEL INJECTOR ASSEMBLY

- (a) Disconnect the 6 fuel injector connectors.

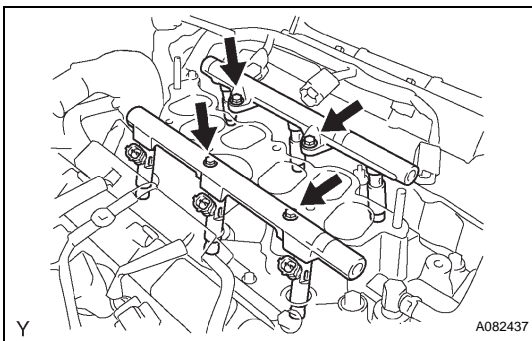

- (b) Remove the 4 bolts, and then remove the 2 fuel delivery pipes together with the 6 fuel injectors.

NOTICE:

Be careful not to drop the fuel injectors when removing the fuel delivery pipe.

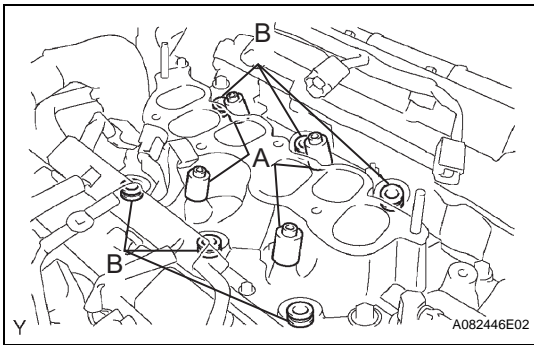

- (c) Remove the 4 delivery pipe No. 1 spacers (A) and the 6 insulators (B) from the intake manifold.

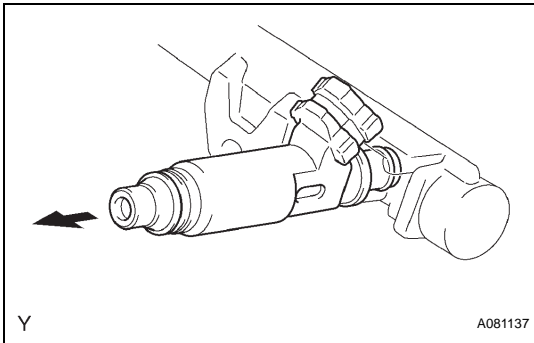

- (d) Pull out the fuel injector from the fuel delivery pipe.