

INSTALLATION

1. INSTALL FUEL INJECTOR ASSEMBLY

- (a) Install new grommets to each fuel injector.
- (b) Apply a light coat of spindle oil or gasoline to new O-rings, and install them to each fuel injector.

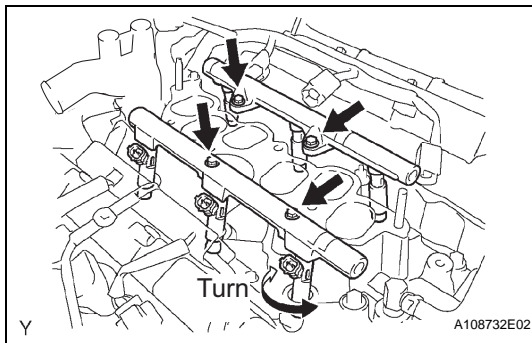
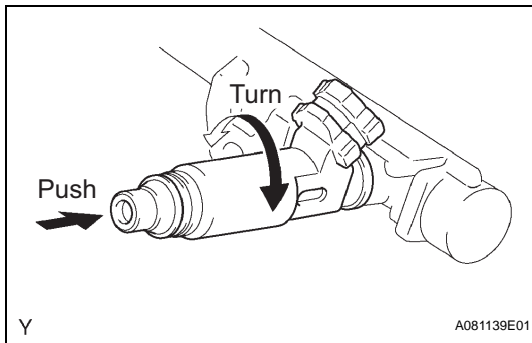
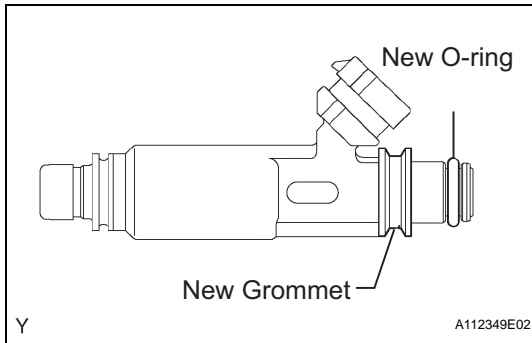

- (c) Apply a light coat of spindle oil or gasoline on the place where the fuel delivery pipe contacts the O-ring.
- (d) Push the fuel injector while twisting it back and force to install it in the fuel delivery pipe.

NOTICE:

- Be careful not to twist the O-ring.
- After installing the fuel injector, check that they turns smoothly. If not, reinstall it with a new O-ring.

- (e) Install 6 new insulators and the 4 delivery pipe No. 1 spacers to the intake manifold.
- (f) Place the 2 fuel delivery pipes and the 6 fuel injectors together to the intake manifold.

NOTICE:

Be careful not to drop the fuel injectors when installing the fuel delivery pipe.

- (g) Temporarily install 4 bolts which are used to attach the fuel delivery pipe to the intake manifold.
- (h) Check that the fuel injectors rotate smoothly. If fuel injectors do not rotate smoothly, the probable cause is incorrect installation of O-ring. Replace with the O-ring.
- (i) Tighten the 4 bolts.
Torque: 10 N*m (102 kgf*cm, 7 ft.*lbf)
- (j) Connect the 6 fuel injector connectors.

2. INSTALL FUEL PIPE SUB-ASSEMBLY NO.1

- (a) Install 2 new gaskets and the fuel pipe No. 2 union bolt.
Torque: 33 N*m (331 kgf*cm, 24 ft.*lbf)
- (b) Install 2 new gaskets and the fuel pressure pulsation damper.
Torque: 33 N*m (331 kgf*cm, 24 ft.*lbf)
- (c) Install the fuel pipe No. 1 with the bolt.
Torque: 20 N*m (199 kgf*cm, 14 ft.*lbf)

3. INSTALL INTAKE AIR SURGE TANK

- (a) Install a new gasket to the intake air surge tank.

- (b) Install the intake air surge tank and the emission control valve bracket with the 2 nuts.
Torque: 28 N*m (286 kgf*cm, 21 ft.*lbf)
- (c) Using a socket hexagon wrench 8, tighten the 4 bolts.
Torque: 28 N*m (286 kgf*cm, 21 ft.*lbf)
- (d) Install the surge tank stay No. 2 with the 2 bolts.
Torque: 20 N*m (199 kgf*cm, 14 ft.*lbf)
- (e) Install the surge tank stay No. 1 with the 2 bolts.
Torque: 20 N*m (199 kgf*cm, 14 ft.*lbf)
- (f) Install the engine hunger No. 1 with the 2 bolts.
Torque: 20 N*m (199 kgf*cm, 14 ft.*lbf)
- (g) Install the pressure feed tube with the 3 nuts.
Torque: 7.8 N*m (80 kgf*cm, 69 in.*lbf)
- (h) Connect the ventilation hose.
- (i) Connect the union to check valve hose.
- (j) Connect the water by-pass hose No. 2.
- (k) Connect the water by-pass hose No. 3.
- (l) Connect the throttle motor connector.

4. INSTALL EMISSION CONTROL VALVE SET**Torque: 8.0 N*m (82 kgf*cm, 71 in.*lbf)****5. INSTALL AIR CLEANER CAP SUB-ASSEMBLY****Torque: 5.0 N*m (51 kgf*cm, 44 in.*lbf)****6. CHECK CONNECTION OF VACUUM HOSE**

HINT:

See page [EM-127](#).**7. ADD ENGINE COOLANT (See page [CO-7](#))****8. CHECK FOR ENGINE COOLANT LEAKS**

HINT:

See page [CO-1](#).**9. CHECK FOR FUEL LEAKS**

HINT:

See page [FU-4](#).**10. INSTALL V-BANK COVER SUB-ASSEMBLY (See page [ES-374](#))****11. INSTALL COWL TOP PANEL SUB-ASSEMBLY OUTER****Torque: 5.0 N*m (51 kgf*cm, 44 in.*lbf) (Set bolts and nuts of the cowl top panel outer)****Torque: 80 N*m (815 kgf*cm, 59 ft.*lbf) (Set nuts of the shock absorber)****12. INSTALL WINDSHIELD WIPER LINK ASSEMBLY (See page [WW-39](#))****13. INSTALL COWL TOP VENTILATOR LOUVER SUB-ASSEMBLY****14. INSTALL FRONT FENDER TO COWL SIDE SEAL RH****15. INSTALL FRONT FENDER TO COWL SIDE SEAL LH****16. INSTALL FR WIPER ARM RH (See page [WW-40](#))**

17. INSTALL FR WIPER ARM LH (See page [WW-39](#))

FU