

## INSTALLATION

1. **INSTALL FUEL TANK CUSHION SET**
2. **INSTALL FUEL TANK SIDE PLATE**  
Torque: 30 N\*m (306 kgf\*cm, 22 ft.\*lbf)
3. **INSTALL TANK SUCTION TUBE SUPPORT**  
(a) Install a new tank suction tube support as shown in the illustration.
4. **INSTALL FUEL TANK VENT HOSE**

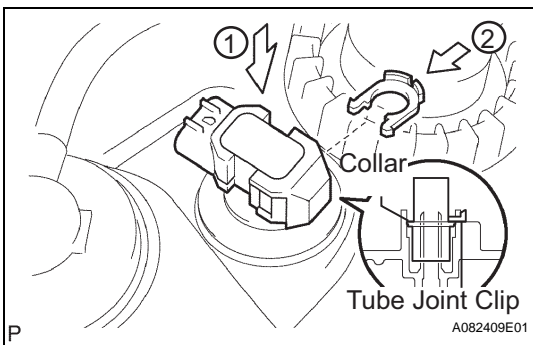
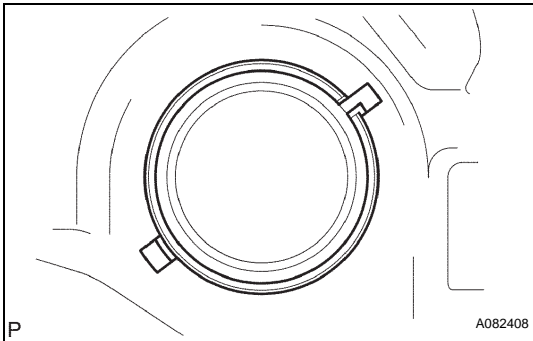

5. **INSTALL VAPOR PRESSURE SENSOR ASSEMBLY**  
(a) Install the vapor pressure sensor with the fuel tube joint clip.  
**NOTICE:**
  - Check that there is no scratch or foreign objects on the connecting parts.
  - Check that the fuel tube joint is fully inserted.
  - Check that the fuel tube joint clip is on the collar of the fuel tube joint.
  - After installing the tube joint clip, check if the fuel joint is securely connected by pulling it.

6. **INSTALL FUEL TANK WIRE**
7. **INSTALL FUEL TANK TO FILLER PIPE HOSE**
8. **INSTALL FUEL PUMP TUBE SUB-ASSEMBLY**
9. **INSTALL FUEL TANK ASSEMBLY**

- (a) Set up the fuel tank to the transmission jack.
- (b) Operating the transmission jack and the install the fuel tank.
- (c) Tighten the 2 nuts.  
**Torque: 20 N\*m (200 kgf\*cm, 14 ft.\*lbf)**
- (d) Install the 2 fuel tank bands with the 4 bolts.  
**Torque: 39 N\*m (400 kgf\*cm, 29 ft.\*lbf)**
- (e) Install the connector clamp.
- (f) Connect the fuel tank wire connector.
- (g) Connect the fuel tank to filler pipe hose.
- (h) Connect the fuel tank breather tube No. 3.  
(1) Push the quick connector to the pipe until it makes "click" sound.

### NOTICE:

- Check if there is any damage or foreign objects on the connected part.
- After connecting, check if the quick connector and the pipe are securely connected by pulling on them.

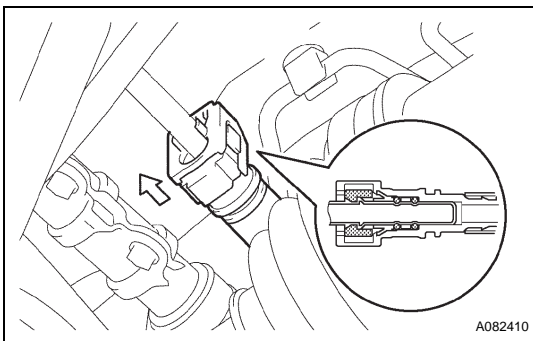

- (i) Connect the fuel tank vent hose.

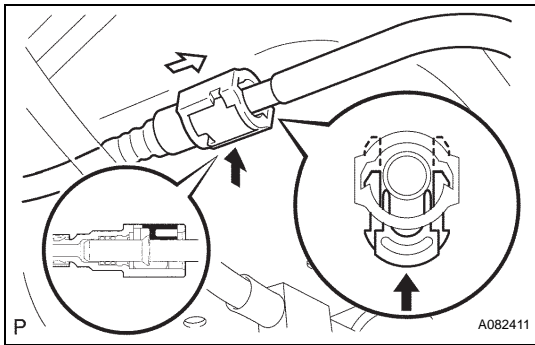

- (j) Connect the fuel pump tube.  
 (1) Push quick connector and push up retainer to the claws lock.

**NOTICE:**

- Check if there is any damage or foreign objects on the connected part.
- After connecting, check if the quick connector and the pipe are securely connected by pulling on them.

**10. INSTALL FUEL TANK PROTECTOR SUB-ASSEMBLY NO.1**

- (a) Install the fuel tank protector No. 1 with the 6 nuts.  
**Torque: 5.5 N\*m (56 kgf\*cm, 49 in.\*lbf)**  
 (b) Install 3 new clips.

**11. INSTALL FUEL TANK PROTECTOR NO.1**  
**Torque: 5.5 N\*m (56 kgf\*cm, 49 in.\*lbf)****12. INSTALL FUEL TUBE PROTECTOR NO.1****13. INSTALL EXHAUST PIPE SUPPORT BRACKET NO.4**  
**Torque: 22 N\*m (224 kgf\*cm, 16 ft.\*lbf)****14. INSTALL FRONT FLOOR HEAT INSULATOR NO.3**  
(See page [EC-14](#))**15. INSTALL EXHAUST PIPE ASSEMBLY CENTER** (See page [EC-14](#))**16. INSTALL FUEL****17. INSTALL SUCTION TUBE SUB-ASSEMBLY** (See page [FU-24](#))**18. CHECK FOR FUEL LEAKS**

HINT:

See page [FU-4](#).**19. CHECK FOR EXHAUST GAS LEAKS****20. INSTALL REAR FLOOR SERVICE HOLE COVER** (See page [FU-25](#))**21. INSTALL REAR SEAT SIDE COVER LH****22. INSTALL DECK SIDE TRIM COVER LH****23. INSTALL REAR DOOR SCUFF PLATE LH****24. INSTALL REAR SEAT ASSEMBLY LH** (See page [SE-55](#))**25. INSTALL REAR SEAT ASSEMBLY RH** (See page [SE-72](#))**26. INSTALL REAR SEAT TRACK BRACKET COVER OUTER****27. INSTALL REAR SEAT TRACK BRACKET COVER OUTER****28. INSTALL DECK BOARD SUB-ASSEMBLY**

29. INSTALL PROPELLER W/CENTER BEARING SHAFT ASSEMBLY (See page [PR-9](#))
30. FULLY TIGHTEN PROPELLER W/CENTER BEARING SHAFT ASSEMBLY (See page [PR-10](#))
31. ADD TRANSFER OIL
32. INSPECT TRANSFER OIL
33. INSTALL ENGINE UNDER COVER ASSEMBLY