

DTC	B2417	Headlight Beam Level Control Motor LH Malfunction
DTC	B2418	Headlight Beam Level Control Motor RH Malfunction

DESCRIPTION

The leveling actuator receives the signal from the AFS ECU to operate. The AFS ECU receives the signal regarding the operating conditions of the leveling actuator.

DTC No.	DTC Detecting Condition	Trouble Area
B2417	<ul style="list-style-type: none"> • Malfunction of headlight beam level control motor LH • Open or short of headlight beam level control motor LH circuit 	<ul style="list-style-type: none"> • Headlight beam level control motor LH • Harness or connector • AFS ECU
B2418	<ul style="list-style-type: none"> • Malfunction of headlight beam level control motor RH • Open or short of headlight beam level control motor RH circuit 	<ul style="list-style-type: none"> • Headlight beam level control motor RH • Harness or connector • AFS ECU

WIRING DIAGRAM

H3 Headlight LH

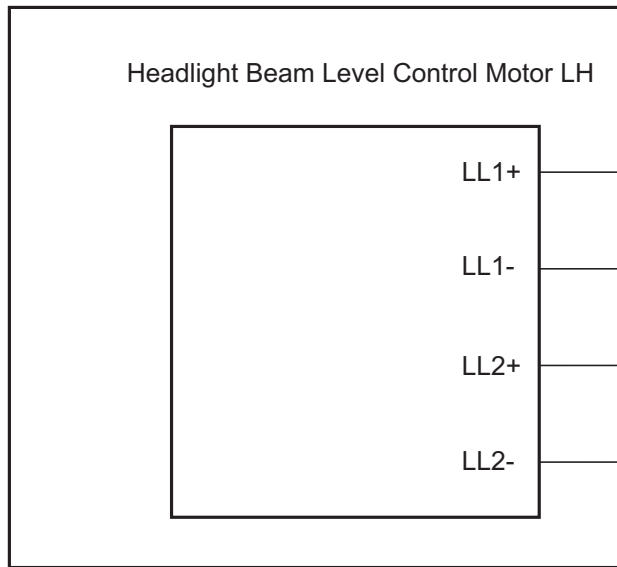

AFS ECU

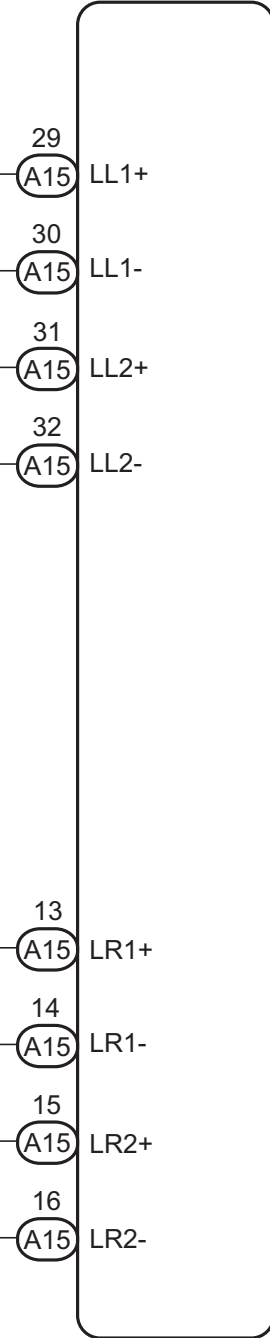

H7 Headlight RH

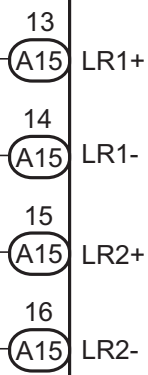
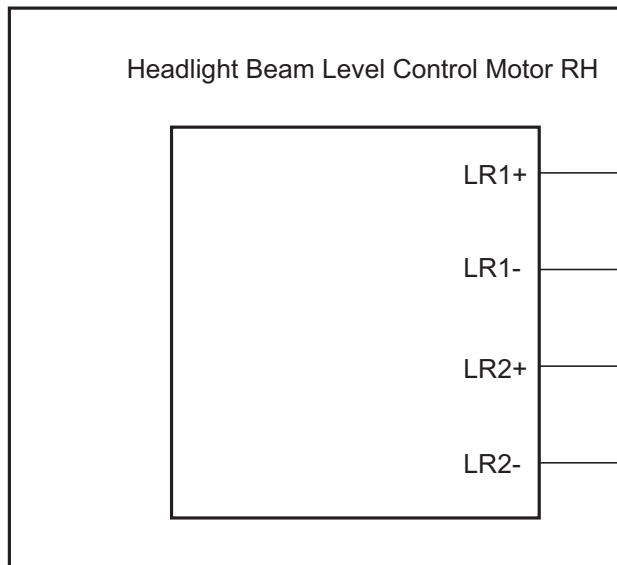

1 CHECK HARNESS AND CONNECTOR (HEADLIGHT BEAM LEVEL CONTROL MOTOR - AFS ECU)

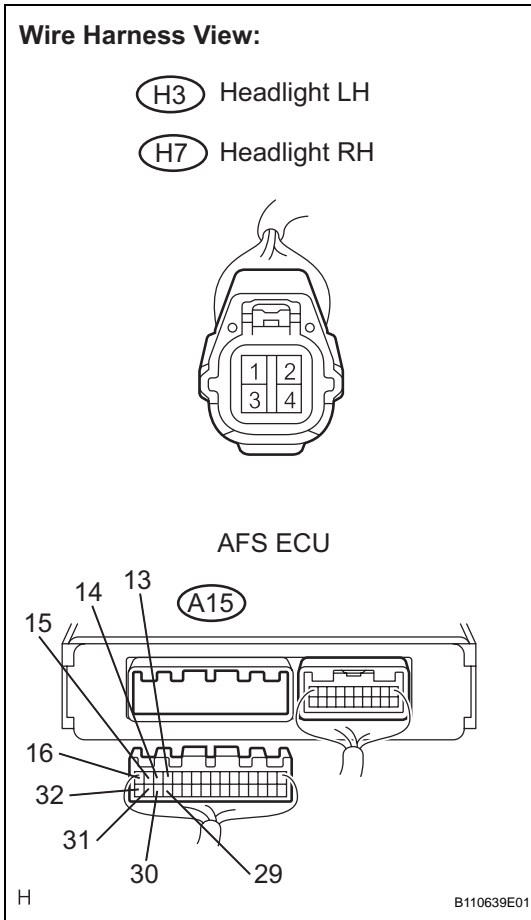

- (a) Disconnect the headlight connector of headlight beam level control motor side and AFS ECU connector.
- (b) Measure the resistance according to the value(s) in the table below.

**Resistance:
LH Side (B2417)**

Tester connection	Condition	Specified condition
LL2+ (H3-1) - LL2+ (A15-31)	Always	Below 1 Ω
LL2- (H3-2) - LL2- (A15-32)	Always	Below 1 Ω
LL1+ (H3-3) - LL1+ (A15-29)	Always	Below 1 Ω
LL1- (H3-4) - LL1- (A15-30)	Always	Below 1 Ω
LL1+ (A15-29) - Body ground	Always	10 kΩ or higher
LL1- (A15-30) - Body ground	Always	10 kΩ or higher
LL2+ (A15-31) - Body ground	Always	10 kΩ or higher
LL2- (A15-32) - Body ground	Always	10 kΩ or higher

RH Side (B2418)

Tester connection	Condition	Specified condition
LR2+ (H7-1) - LR2+ (A15-15)	Always	Below 1 Ω
LR2- (H7-2) - LR2- (A15-16)	Always	Below 1 Ω
LR1+ (H7-3) - LR1+ (A15-13)	Always	Below 1 Ω
LR1- (H7-4) - LR1- (A15-14)	Always	Below 1 Ω
LR1+ (A15-13) - Body ground	Always	10 kΩ or higher
LR1- (A15-14) - Body ground	Always	10 kΩ or higher
LR2+ (A15-15) - Body ground	Always	10 kΩ or higher
LR2- (A15-16) - Body ground	Always	10 kΩ or higher

NG → **REPAIR OR REPLACE HARNESS OR CONNECTOR**

OK

2 INSPECT HEADLIGHT BEAM LEVEL CONTROL MOTOR

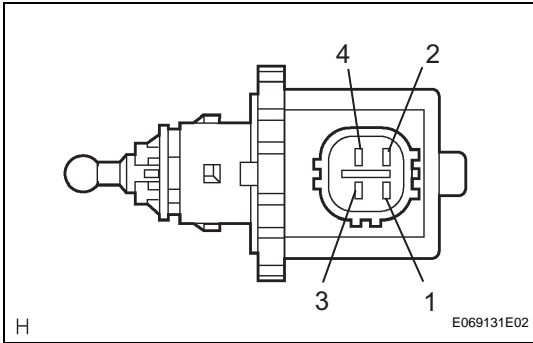

- (a) Disconnect the headlight connector of headlight beam level control motor side.
- (b) Measure the resistance according to the value(s) in the table below.

**Resistance:
LH Side (B2417)**

Tester connection	Condition	Specified condition
LL2+ (1) - LL2- (2)	Always	5.8 to 12.5 Ω
LL1+ (3) - LL1- (4)	Always	5.8 to 12.5 Ω

RH Side (B2418)

Tester connection	Condition	Specified condition
LR2+ (1) - LR2- (2)	Always	5.8 to 12.5 Ω
LR1+ (3) - LR1- (4)	Always	5.8 to 12.5 Ω

Result

Condition	Proceed to
OK (When checking from the DTC)	A
OK (When checking from the PROBLEM SYMPTOMS TABLE)	B
NG	C

B → **PROCEED TO NEXT CIRCUIT INSPECTION SHOWN IN PROBLEM SYMPTOMS TABLE**

C → **REPLACE HEADLIGHT BEAM LEVEL CONTROL MOTOR**

A

REPLACE AFS ECU