

TRANSFER ASSEMBLY

COMPONENTS

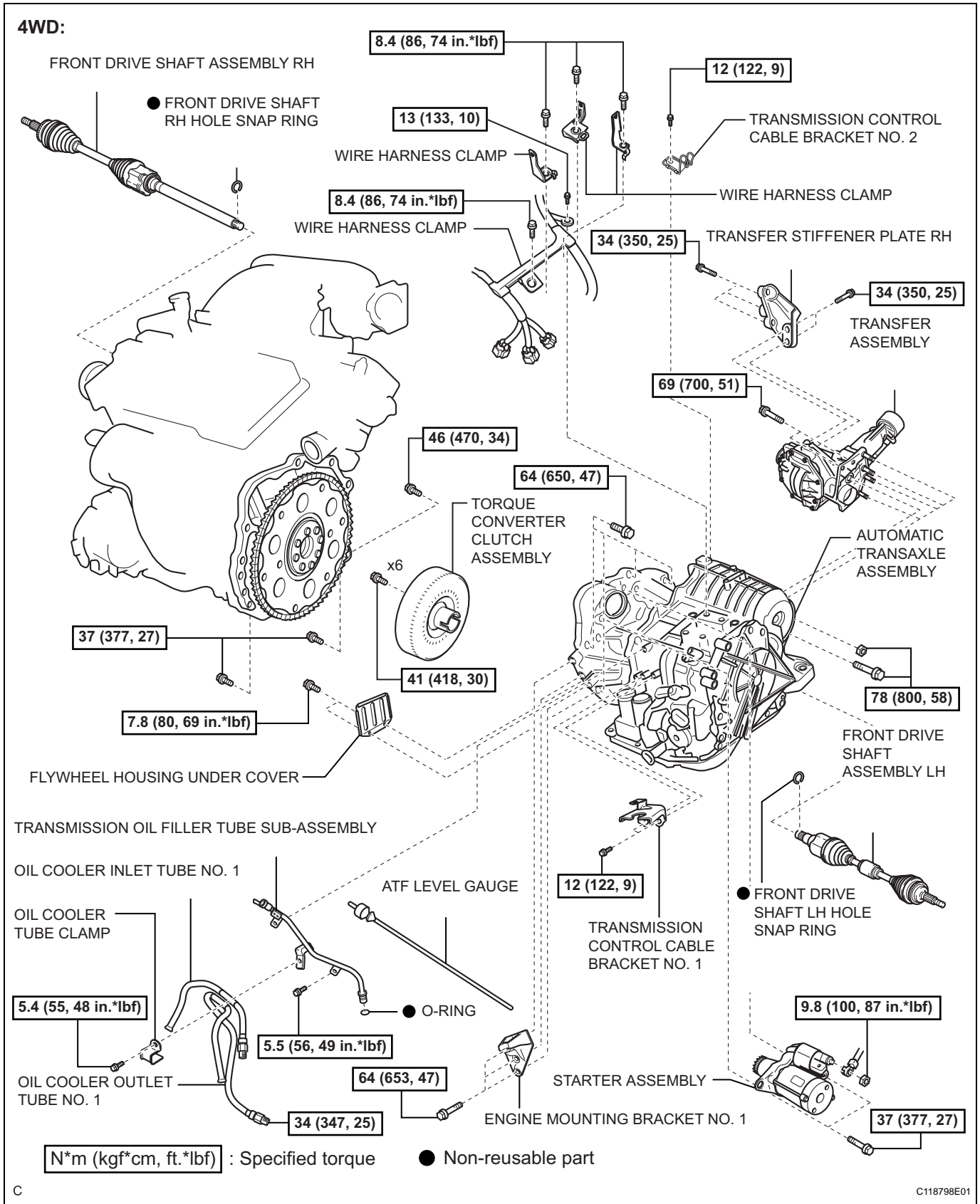

TF

REMOVAL

1. REMOVE ENGINE AND TRANSAXLE

HINT:

(See page [EM-113](#))

2. REMOVE TRANSFER STIFFENER PLATE RH (See page [AX-173](#))

3. REMOVE AUTOMATIC TRANSMISSION W/ TRANSFER

HINT:

(See page [AX-171](#))

4. REMOVE TRANSFER CASE NO. 1 PLUG

(a) Remove the transfer case No. 1 plug.

(b) Remove the gasket No. 1 from the transfer case No. 1 plug.

5. REMOVE TRANSFER CASE NO. 2 PLUG

(a) Remove the transfer case No. 2 plug.

(b) Remove the gasket No. 2 from the transfer case No. 2 plug.

6. REMOVE TRANSFER DRAIN PLUG

(a) Remove the transfer drain plug and bleed the oil.

(b) Remove the drain gasket from the transfer drain plug.

7. REMOVE TRANSFER ASSEMBLY

(a) Remove the 2 bolts and 6 bolts.

(b) Using a plastic hammer, remove the transfer assembly from the transaxle assembly.

NOTICE:

- Remove the transfer assembly from the transaxle assembly without tilting it.
- When removing the transfer assembly, do not hold onto the oil seal parts on both sides of the assembly.

