

REMOVAL

1. **REMOVE ENGINE AND TRANSAXLE**
(a) (See page [EM-113](#))
2. **REMOVE TRANSFER STIFFENER PLATE RH** (See page [AX-173](#))
3. **REMOVE AUTOMATIC TRANSMISSION W/ TRANSFER**
HINT:
(See page [AX-171](#))
4. **REMOVE TRANSFER ASSEMBLY**
HINT:
(See page [TF-14](#))
5. **REMOVE CTR DIFFERENTIAL LOCK SLEEVE**
HINT:
(See page [TF-19](#))

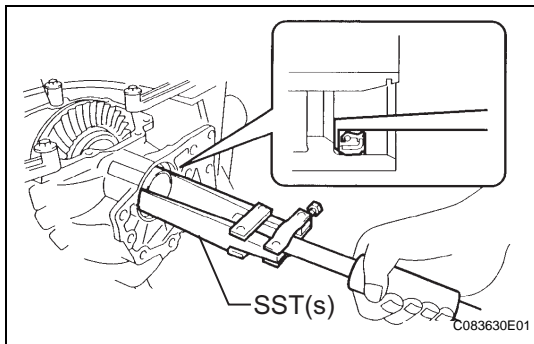

6. **REMOVE TRANSFER CASE OIL SEAL**
(a) Using SST(s), remove the transfer case oil seal from the transfer case.
SST 09308-00010
NOTICE:
Do not damage the oil-seal-fitted surface of the case.

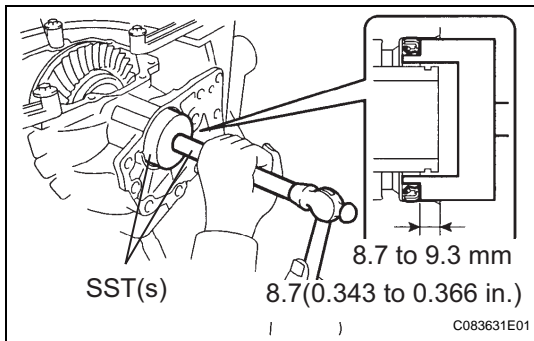

INSTALLATION

1. **INSTALL TRANSFER CASE OIL SEAL**
(a) Using SST(s), install anew transfer case oil seal to the transfer case at the position shown in the illustration.
SST 09387-00010, 09950-70010 (09951-07150)
NOTICE:
Do not install it obliquely.
(b) Apply small amount of MP grease to the oil seal lip.
2. **INSTALL CTR DIFFERENTIAL LOCK SLEEVE**
HINT:
(See page [TF-27](#))
3. **INSTALL TRANSFER ASSEMBLY**
HINT:
(See page [TF-15](#))
4. **INSTALL AUTOMATIC TRANSMISSION W/ TRANSFER**
HINT:
See page [AX-174](#)
5. **REMOVE AND INSTALL TRANSFER STIFFENER PLATE RH** (See page [AX-175](#))

6. INSTALL ENGINE AND TRANSAXLE

HINT:

(See page [EM-120](#))