

OUTER REAR VIEW MIRROR

COMPONENTS

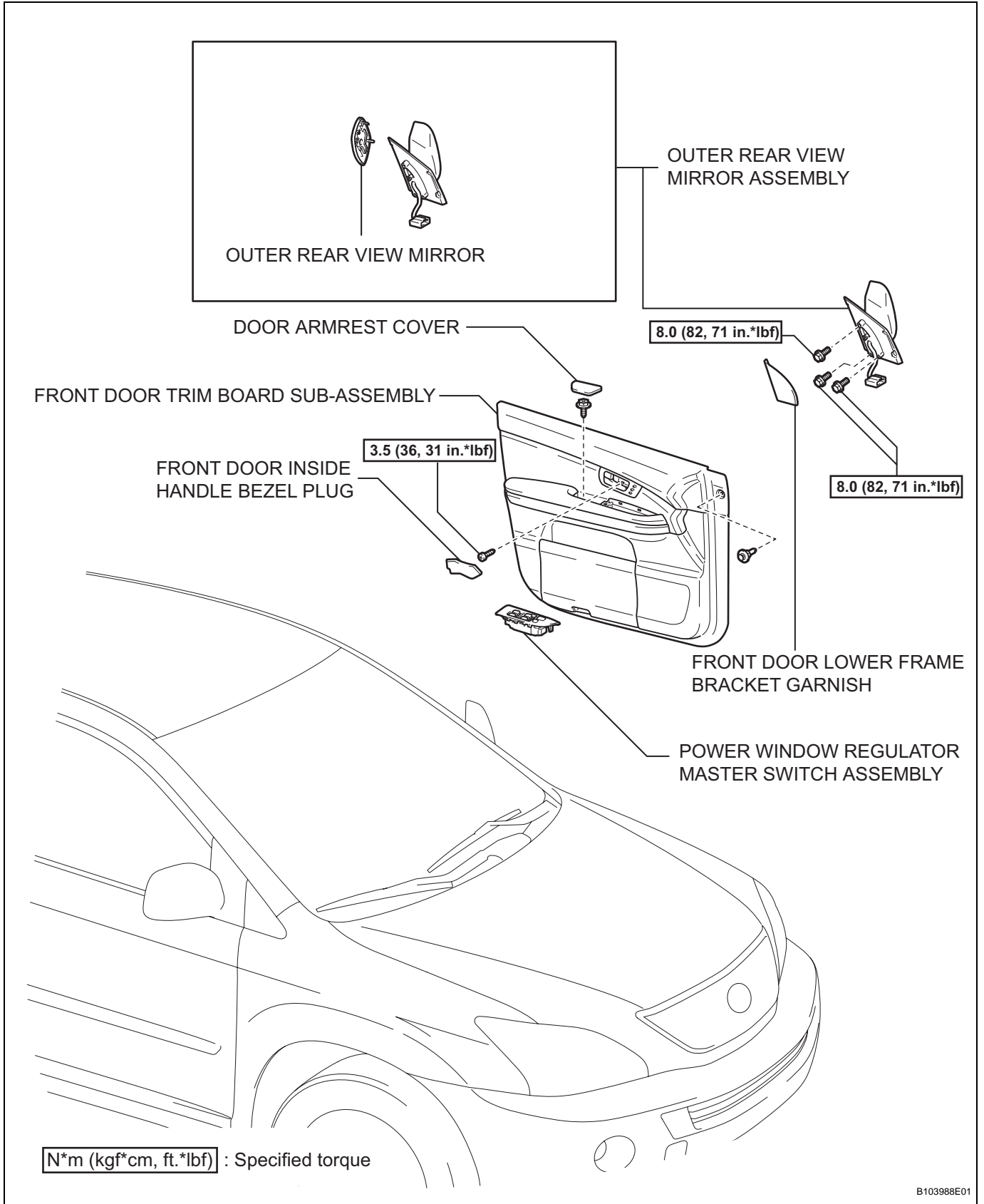

REMOVAL

1. REMOVE FRONT DOOR INSIDE HANDLE BEZEL PLUG (See page ED-100)
2. REMOVE POWER WINDOW REGULATOR MASTER SWITCH ASSEMBLY (See page ED-100)
3. REMOVE DOOR ARMREST COVER (See page ED-100)
4. REMOVE FRONT DOOR LOWER FRAME BRACKET GARNISH (See page ED-100)
5. REMOVE FRONT DOOR TRIM BOARD SUB-ASSEMBLY (See page ED-101)
6. REMOVE OUTER REAR VIEW MIRROR ASSEMBLY
 - (a) Disconnect the connector and remove the clamp.
 - (b) Remove the 3 bolts and the outer rear view mirror assembly.

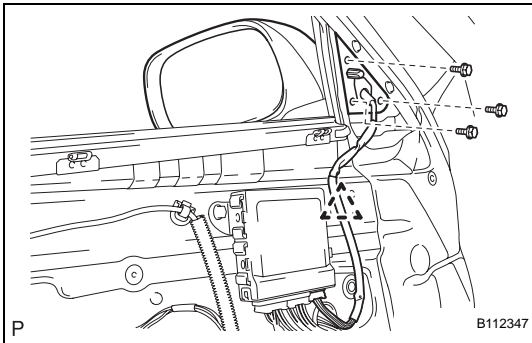

7. REMOVE OUTER REAR VIEW MIRROR
 - (a) Push the upper part of the mirror surface and tilt it.
 - (b) Apply protective tape on the outer rear view mirror assembly.
 - (c) Using a moulding remover, disengage the 2 claws at the lower part of the outer rear view mirror.
 - (d) Pull the mirror in the direction indicated by the arrow shown in the illustration to disengage the 2 claws on the upper part of the outer rear view mirror, and separate the outer rear view mirror sub-assembly.
 - (e) Disconnect each connector and remove the outer rear view mirror.

