

## INSTALLATION

### 1. INSTALL VANE PUMP ASSEMBLY

- Temporarily install the vane pump assembly with the 2 bolts.

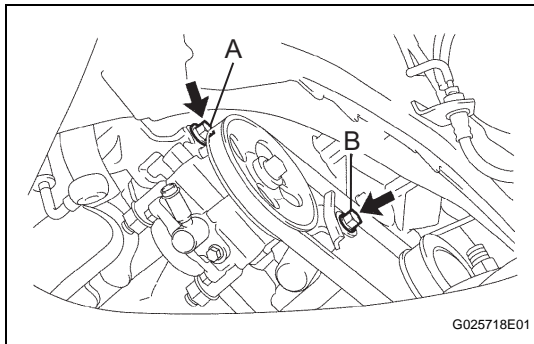

### 2. INSTALL VANE PUMP V BELT

- Install the vane pump V belt and adjust the V belt tension (See page EM-6).

- Torque the bolt A.

**Torque: 43 N\*m (438 kgf\*cm, 32 ft.\*lbf)**

- Torque the bolt B.

**Torque: 43 N\*m (438 kgf\*cm, 32 ft.\*lbf)**

### 3. CONNECT PRESSURE FEED TUBE ASSEMBLY

- Using a spanner (24mm) to keep the pressure port union, connect the pressure feed tube assembly with the union bolt and a new gasket.

**Torque: 52 N\*m (525 kgf\*cm, 38 ft.\*lbf)**

**NOTICE:**

**Make sure that the stopper of the pressure feed tube assembly touches the pump bracket front as shown in the illustration, then tighten the union bolt.**

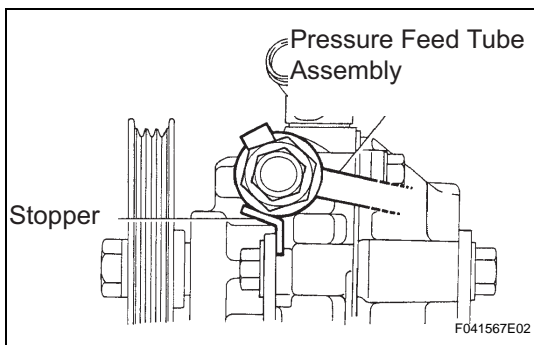

### 4. INSTALL POWER STEERING OIL PRESSURE SWITCH

- Install the oil pressure switch to the union bolt.

**Torque: 21 N\*m (214 kgf\*cm, 15 ft.\*lbf)**

**NOTICE:**

**Be careful to keep oil away from the connector.**

- Connect the connector.

### 5. CONNECT OIL RESERVOIR TO PUMP HOSE NO.1

- Connect the oil reservoir to pump hose No. 1.

- Install the clip.

### 6. INSTALL FRONT FENDER APRON SEAL RH

### 7. INSTALL FRONT WHEEL RH

**Torque: 103 N\*m (1,050 kgf\*cm, 76 ft.\*lbf)**

### 8. BLEED POWER STEERING FLUID

### 9. INSPECT POWER STEERING FLUID LEAK