

REMOVAL

1. **PRECAUTION** (See page [RS-387](#))
2. **SEPARATE BATTERY NEGATIVE TERMINAL**
 - (a) With the ignition key in the key cylinder and the ignition switch off (LOCK), perform tilt-down and telescoping operation by adjusting the tilt and telescopic switch. Disconnect the negative terminal of the battery with the ignition key cylinder.

CAUTION:

 - **Start the overhaul of the steering column assembly at least 90 seconds after disconnecting the negative terminal of the battery.**
 - **Be sure to disconnect the negative terminal of the battery properly so that the following procedure can be performed without any problem.**
 - (b) Remove the ignition key from the key cylinder.
3. **PLACE FRONT WHEELS FACING STRAIGHT AHEAD**
4. **REMOVE STEERING WHEEL COVER LOWER NO.2**
5. **REMOVE STEERING WHEEL COVER LOWER NO.3**
6. **REMOVE HORN BUTTON ASSEMBLY**
 - (a) Using a "torx" socket wrench, loosen the 2 "torx" screws until the groove along the screw circumference is caught on the screw case.

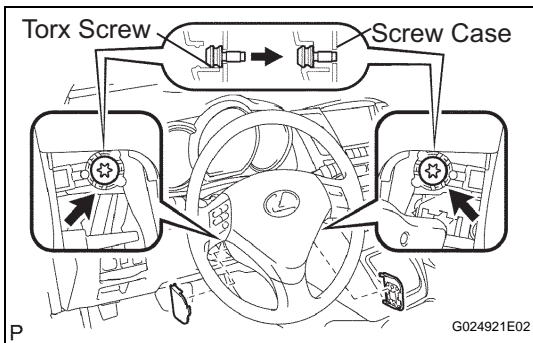

SR

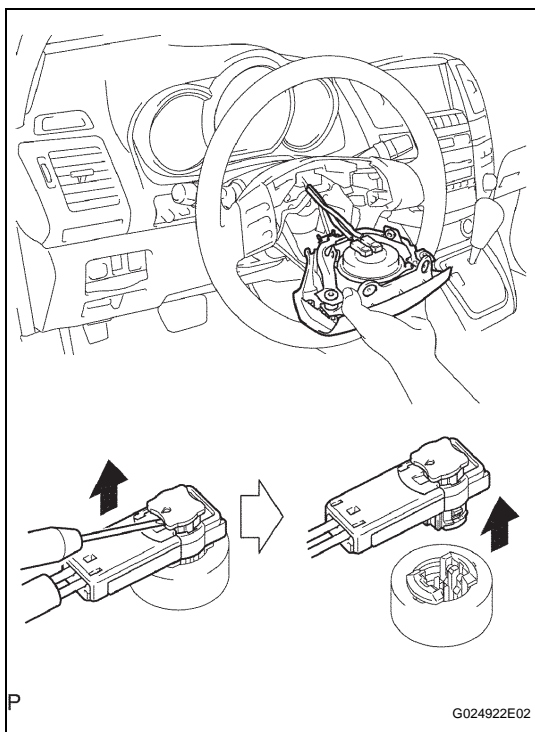

- (b) Pull out the horn button assembly from the steering wheel and disconnect the airbag connector.

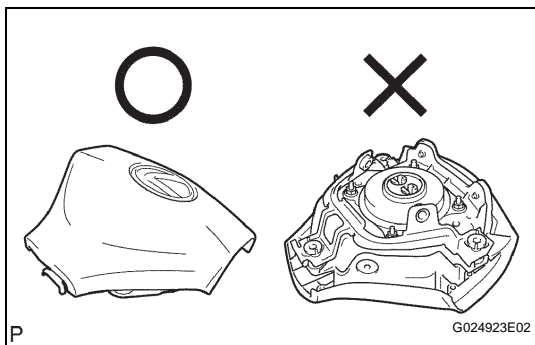

- (c) Disconnect the terminal.

NOTICE:

When removing the horn button assembly, take care not to pull the airbag wire harness.

CAUTION:

- When placing the horn button assembly down, keep the upper surface of the horn button assembly facing upward.
- Never disassemble the horn button assembly.

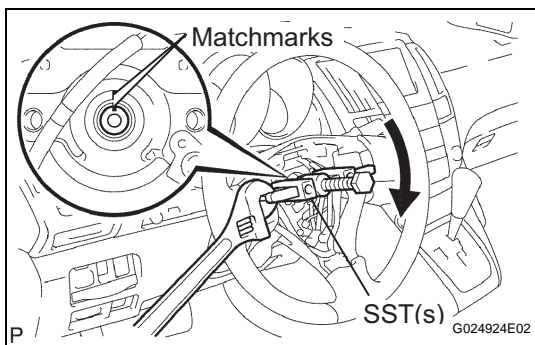
**7. REMOVE STEERING WHEEL ASSEMBLY**

- (a) Remove the steering wheel assembly set nut.
 (b) Place matchmarks on the steering wheel assembly and main shaft assembly.
 (c) Using SST(s), remove the steering wheel assembly.
SST 09950-50013 (09951-05010, 09952-05010, 09953-05020, 09954-05021)

8. REMOVE FRONT DOOR SCUFF PLATE LH (See page [IR-6](#))**9. REMOVE INSTRUMENT PANEL FINISH PANEL SUB-ASSEMBLY LOWER (See page [IP-11](#))****10. REMOVE INSTRUMENT PANEL AIR BAG ASSEMBLY LOWER NO.1 (See page [RS-403](#))**

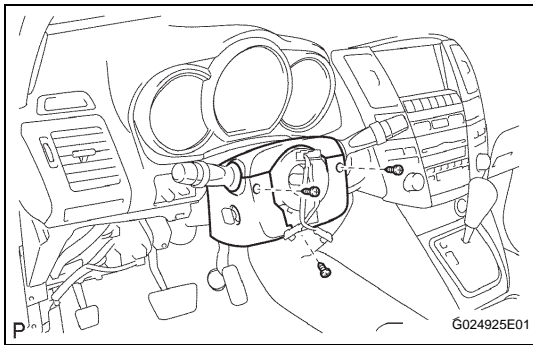

11. REMOVE STEERING COLUMN COVER

- (a) Remove the 3 screws and steering column cover UPR and LWR.

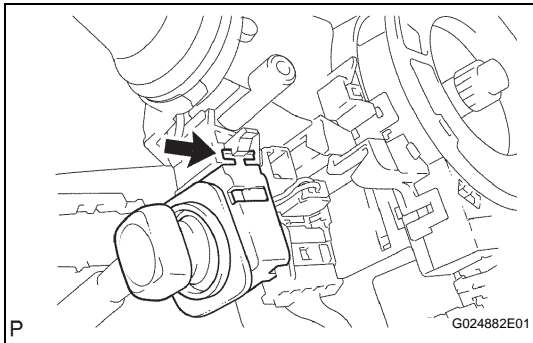

12. REMOVE TILT AND TELESCOPIC SWITCH

- (a) Disconnect the connectors.
- (b) Using a screwdriver, disengage the claw and pull out the tilt and telescopic switch.

NOTICE:

Pushing the claw too hard will break the claw.

HINT:

Tape the screwdriver tip before use.

13. REMOVE SPIRAL CABLE SUB-ASSEMBLY (See page RS-399)

14. REMOVE HEADLIGHT DIMMER SWITCH ASSEMBLY (See page LI-228)

15. REMOVE WINDSHIELD WIPER SWITCH ASSEMBLY (See page WW-49)

16. REMOVE AIR DUCT NO.1

- (a) Remove the bolt, disengage the 3 claw fittings and remove the air duct No.1.

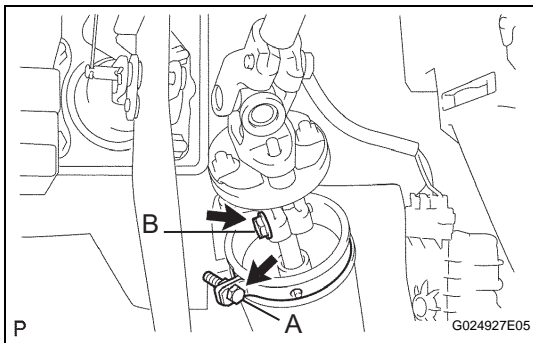

17. REMOVE STEERING INTERMEDIATE SHAFT ASSEMBLY

- (a) Loosen the bolt A and remove the clamp from the steering column hole shield.
- (b) Separate the steering column hole cover No.2 from the steering column hole shield.
- (c) Loosen the bolt B.

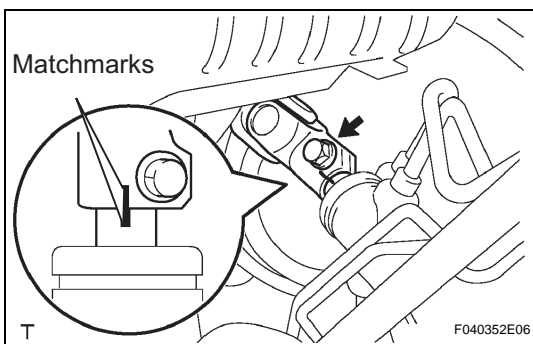

- (d) Place matchmarks on the steering intermediate shaft sub-assembly and steering gear assembly.
- (e) Remove the bolt and separate the steering intermediate shaft sub-assembly.

18. REMOVE INSTRUMENT PANEL FINISH PLATE

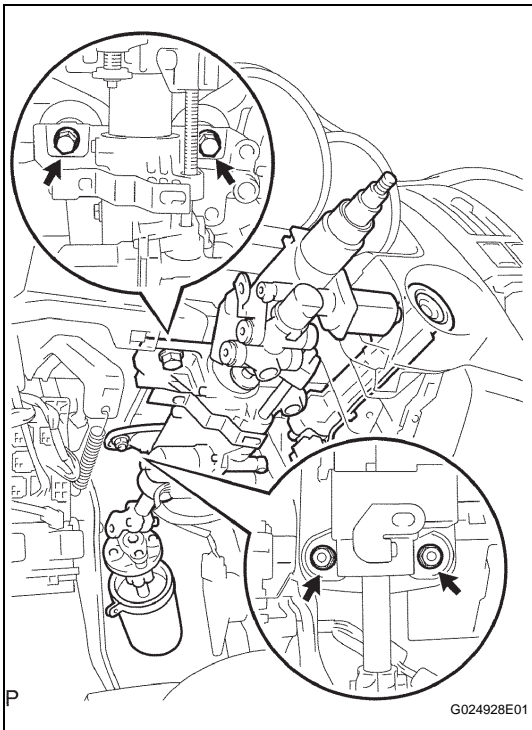
**19. REMOVE STEERING COLUMN ASSEMBLY**

- (a) Disconnect the connectors and wire harness clamps.
- (b) Remove the 2 bolts, 2 nuts and steering column assembly from the instrument panel reinforcement assembly.

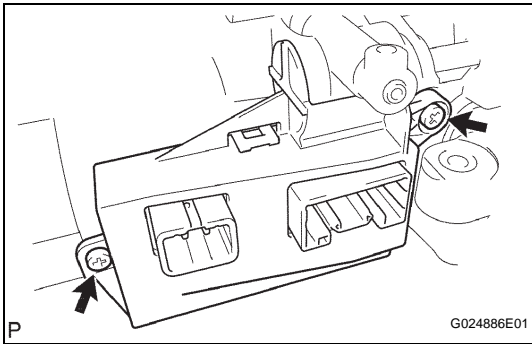
**20. REMOVE MULTIPLEX TILT AND TELESCOPIC ECU**

- (a) Disconnect the connectors from the multiplex tilt and telescopic ECU.
- (b) Using a socket wrench (+), remove the 2 screws and multiplex tilt and telescopic ECU.

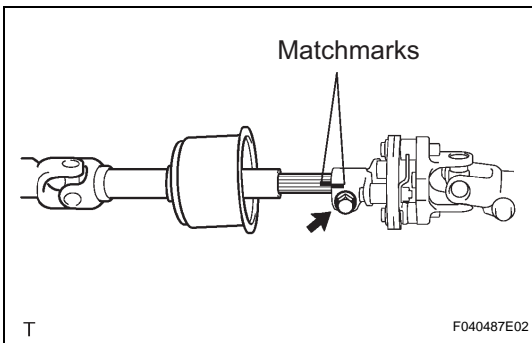
**21. REMOVE STEERING INTERMEDIATE SHAFT ASSEMBLY**

- (a) put matchmarks on the steering intermediate shaft sub-assembly and steering shaft universal joint assembly.
- (b) Remove the bolt and steering intermediate shaft sub-assembly.

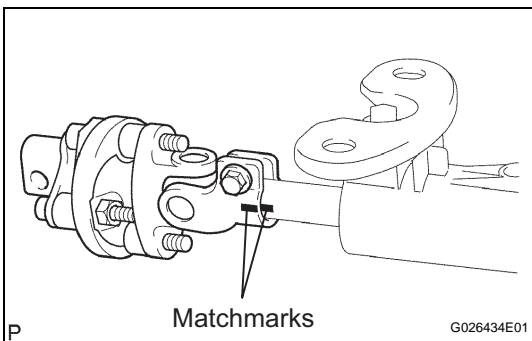
22. REMOVE STEERING COLUMN HOLE COVER**23. REMOVE STEERING SHAFT UNIVERSAL JOINT ASSEMBLY**

- (a) Put matchmarks on the steering shaft universal joint assembly and steering main shaft assembly.
- (b) Remove the bolt and steering shaft universal joint assembly from the steering main shaft assembly.

DISASSEMBLY

1. REMOVE TRANSPONDER KEY AMPLIFIER

- (a) Widen the claw hung on the upper bracket by approx. 1.0 mm (0.039 in.) using a screwdriver.
- (b) Pull the transponder key amplifier toward the rear of the vehicle with the claw open.

NOTICE:

Do not use excessive force.

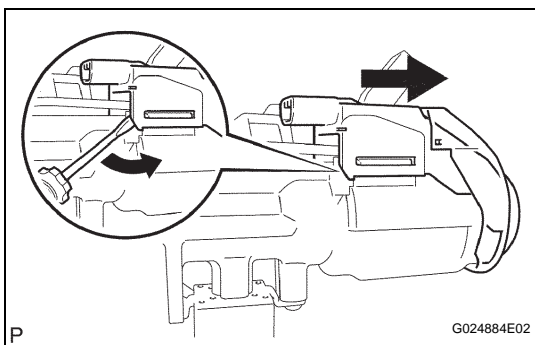

2. REMOVE STEERING COLUMN UPPER WITH SWITCH BRACKET ASSEMBLY

- (a) Using a centering punch, mark the center of the 2 tapered-hand bolts.
- (b) Using a 3 - 4 mm (0.12 - 0.16 in.) drill, drill a hole in the 2 bolt heads.
- (c) Using a screw extractor, remove the 2 bolts and steering column upper w/ switch bracket assembly.

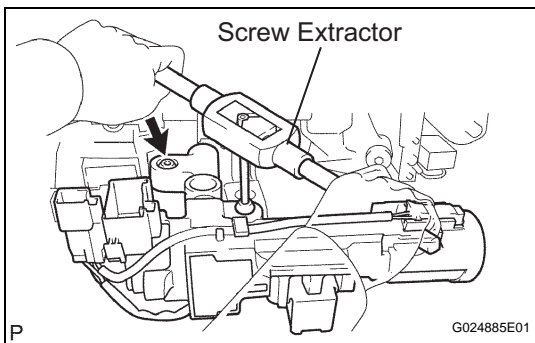

3. REMOVE IGNITION SWITCH LOCK CYLINDER ASSEMBLY

- (a) Put the ignition switch lock cylinder assembly in the ACC position.
- (b) Push down the stop pin with a screwdriver, and pull out the cylinder assembly.

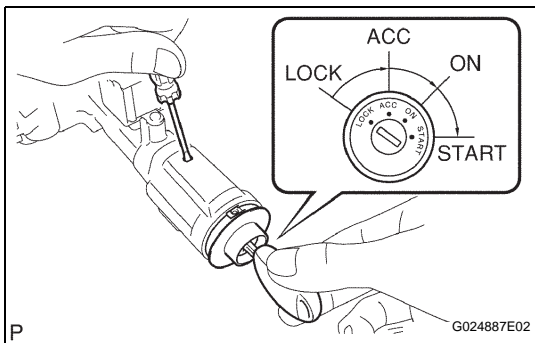

4. REMOVE UN-LOCK WARNING SWITCH ASSEMBLY

- (a) Separate the un-lock warning switch assembly connector from the ignition or starter switch assembly.
- (b) Remove the un-lock warning switch assembly by pushing up the center part and disengaging the 2 claws.

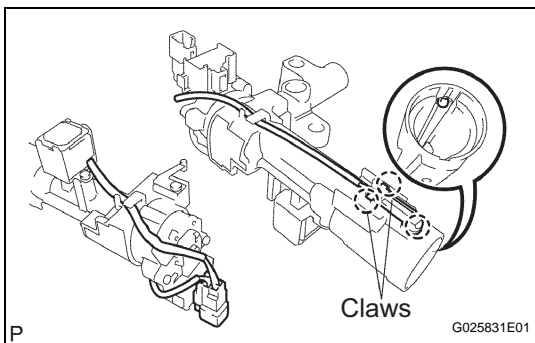

- (c) Disengage the secondary locking device.
- (d) Using a small screwdriver, disengage the locking lug of the terminals 3 and 4, and pull the terminals out from the un-lock warning switch assembly rear side.

5. REMOVE KEY INTER LOCK SOLENOID

- (a) Remove the 2 screws and solenoid from the steering column bracket assembly.

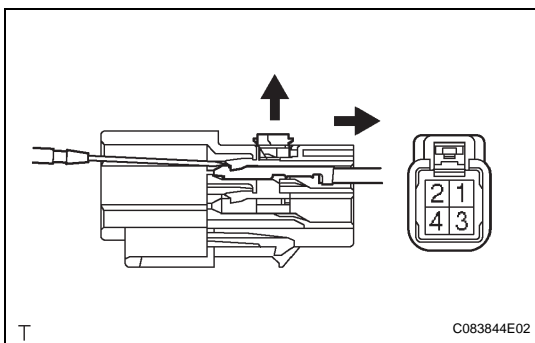

**6. REMOVE IGNITION OR STARTER SWITCH
ASSEMBLY**

- (a) Remove the 2 screws and ignition or starter switch assembly from the steering column bracket assembly UPR.