

REASSEMBLY

1. INSTALL IGNITION OR STARTER SWITCH ASSEMBLY

- (a) Install the ignition or starter switch assembly to the steering column bracket assembly UPR with the 2 screws.

2. INSTALL KEY INTER LOCK SOLENOID

- (a) Install the solenoid to the steering column bracket assembly with the 2 screws.

3. INSTALL UN-LOCK WARNING SWITCH ASSEMBLY

- (a) Install the un-lock warning switch assembly.
- (b) Connect the terminals 3 and 4 of the un-lock warning switch assembly connector.
- (c) Connect the un-lock warning switch assembly connector to the ignition or starter switch assembly.

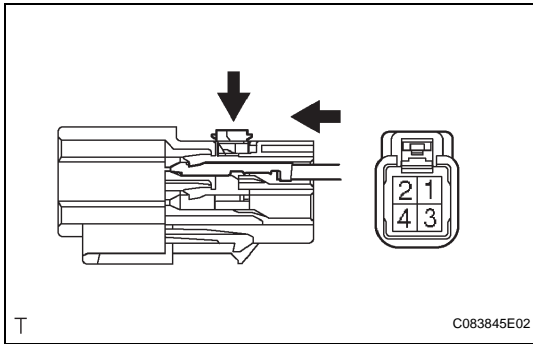

4. INSTALL IGNITION SWITCH LOCK CYLINDER ASSEMBLY

- (a) Make sure the ignition switch lock cylinder assembly is in the ACC position.
- (b) Install the ignition switch lock cylinder assembly.

5. INSPECT STEERING LOCK OPERATION

- (a) Check that the steering lock mechanism is activated when the key is removed.
- (b) Check that the steering lock mechanism is deactivated when the key is inserted and turned to the ACC position.

6. INSTALL STEERING COLUMN UPPER WITH SWITCH BRACKET ASSEMBLY

- (a) Temporarily install the steering column upper w/ switch bracket assembly and steering column upper clamp with 2 new tapered-head bolts.
- (b) Tighten the 2 tapered-head bolts until the bolt heads break off.

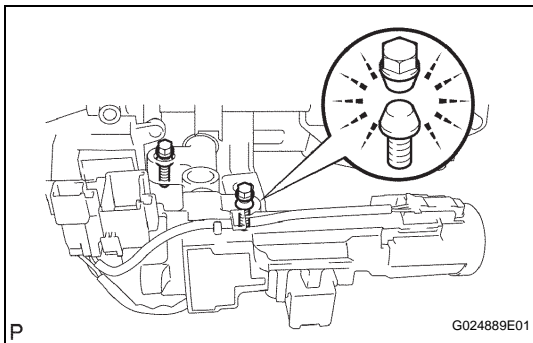

7. INSTALL TRANSPONDER KEY AMPLIFIER

- (a) Align the transponder key amplifier with the installation position of the upper bracket with the amplifier inclined.
- (b) Push the transponder key amplifier up and connect it to the upper bracket.

NOTICE:

Do not push the amplifier up with excessive force.

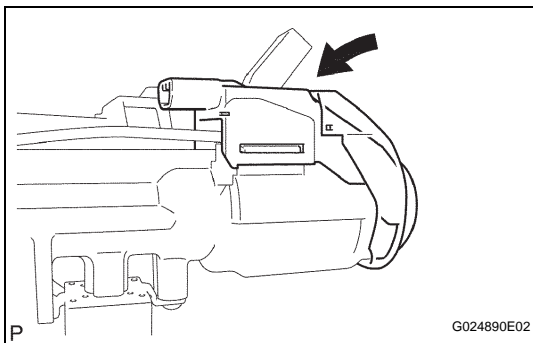

SR

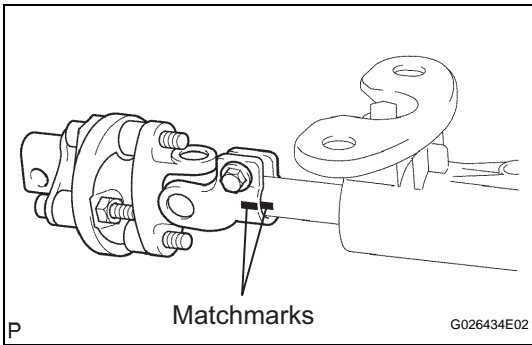

INSTALLATION

1. INSTALL STEERING SHAFT UNIVERSAL JOINT ASSEMBLY

- Align the matchmarks on the steering universal joint assembly and steering main shaft assembly.
- install the steering universal joint assembly with the bolt.

Torque:

35 N*m (360 kgf*cm, 26 ft.*lbf)

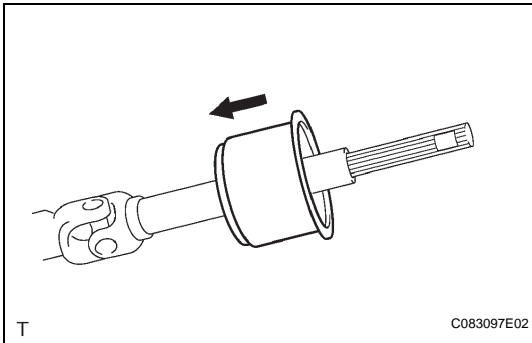

2. INSTALL STEERING COLUMN HOLE COVER

- Install the steering column hole cover sub-assembly No.2 to the steering intermediate shaft sub-assembly.

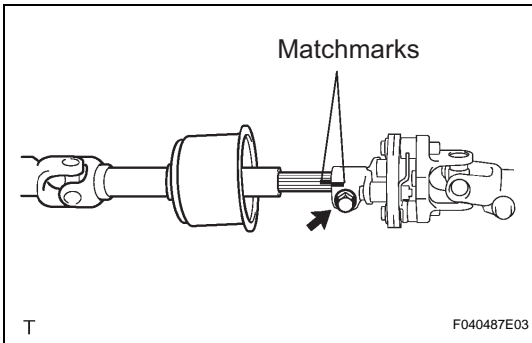

3. TEMPORARILY TIGHTEN STEERING INTERMEDIATE SHAFT ASSEMBLY

- Align the matchmarks on the steering intermediate shaft sub-assembly and steering main shaft assembly.
- Temporarily install the steering intermediate shaft sub-assembly with the bolt.

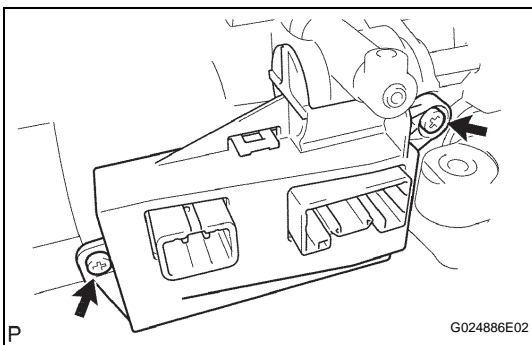

4. INSTALL MULTIPLEX TILT AND TELESCOPIC ECU

- Using a socket wrench (+), install the 2 screws.
Torque: 1.5 N*m (15 kgf*cm, 13 in.*lbf)
- Connect the connectors to the multiplex tilt and telescopic ECU.

NOTICE:

- The wire harness between the telescopic motor and ECU has same shape connectors at both ends.
- When installing them, connect the connectors with the same color.

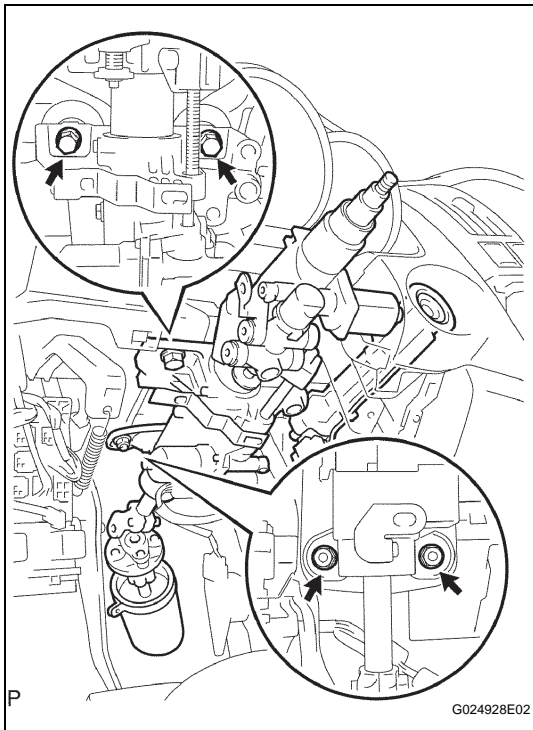

5. INSTALL STEERING COLUMN ASSEMBLY

- (a) Install the steering column assembly with the 2 bolts and 2 nuts.
Torque: 26 N*m (265 kgf*cm, 19 ft.*lbf)
- (b) Connect the connectors.
- (c) Connect the wire harness clamps to the steering column tube.

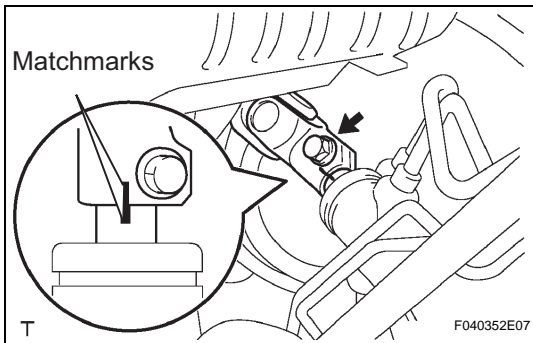

6. CONNECT STEERING INTERMEDIATE SHAFT ASSEMBLY

- (a) Align the matchmarks on the intermediate shaft sub-assembly and steering gear assembly.
- (b) Install the bolt.
Torque: 35 N*m (360 kgf*cm, 26 ft.*lbf)

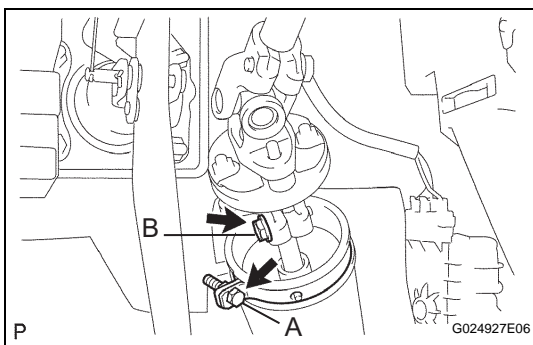

- (c) Tighten the bolt B.
Torque: 35 N*m (360 kgf*cm, 26 ft.*lbf)
- (d) Install the steering column hole cover No.2 to the steering hole shield.
- (e) Install the clamp to the steering column hole shield and tighten the bolt A.

7. INSTALL AIR DUCT NO.1

- (a) Install the air dust No.1 with the bolt.
Torque: 9.8 N*m (100 kgf*cm, 87 in.*lbf)

8. PLACE FRONT WHEELS FACING STRAIGHT AHEAD

9. INSTALL SPIRAL CABLE SUB-ASSEMBLY (See page [RS-399](#))

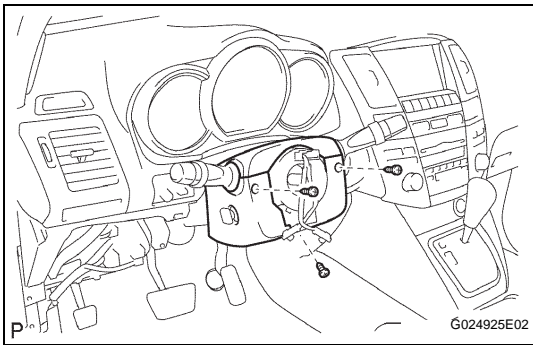
**10. INSTALL STEERING COLUMN COVER**

- (a) Install the steering column cover UPR and LWR with the 3 screws.

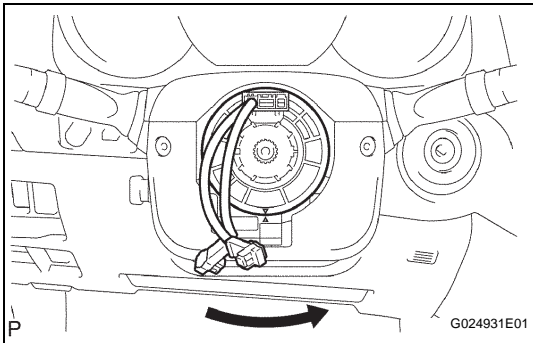
**11. CENTER SPIRAL CABLE**

- (a) Check that the ignition switch is off.
 (b) Check that the battery negative terminal is separated.

NOTICE:

Wait at least 90 seconds after removing the battery terminal before starting the operation.

- (c) Turn the cable counterclockwise by hand until it becomes hard to turn.

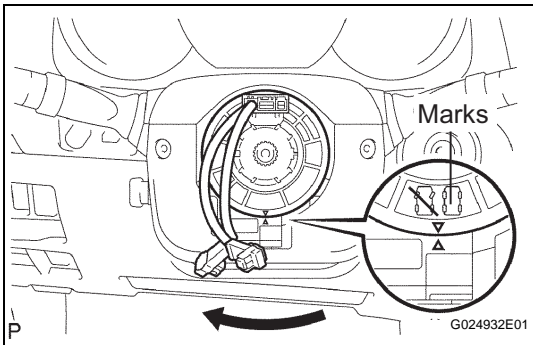

- (d) rotate the cable clockwise about 2.5 turns to align the marks.

HINT:

The cable will rotate about 2.5 turns to both the left and right.

12. INSTALL STEERING WHEEL ASSEMBLY

- (a) Align the matchmarks on the steering wheel assembly and steering main shaft assembly.
 (b) Install the steering wheel assembly set nut.

Torque: 50 N*m (510 kgf*cm, 37 ft.*lbf)

13. INSPECT STEERING WHEEL CENTER POINT**14. INSPECT HORN BUTTON ASSEMBLY (See page [RS-389](#))****15. INSTALL HORN BUTTON ASSEMBLY****NOTICE:**

- Never use airbag parts removed from another vehicle. when replacing parts, replace with new ones.
- Make sure the wheel pad is installed with the specified torque.
- If the wheel pad is dropped or there are cracks, dents or other defects in the case or connector, replace the wheel pad with a new one.
- when installing the wheel pad, take care so that the wiring does not interfere with other parts and that they are not pinched between other parts.

- (a) Connect the terminal.
 (b) Connect the airbag connector.

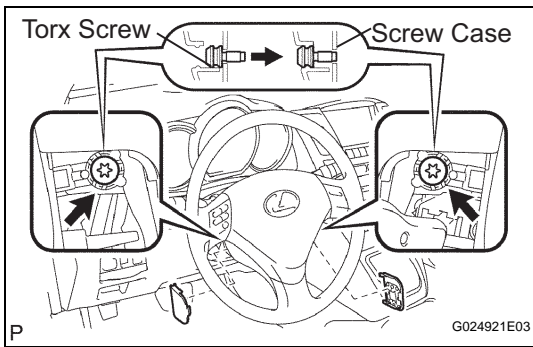

- (c) Install the steering wheel pad after confirming that the circumference groove of the "torx" screws is caught on the screw case.
- (d) Using a "torx" socket wrench, torque the 2 screws.
Torque: 8.8 N*m (90 kgf*cm, 78 in.*lbf)

16. INSPECT SRS WARNING LIGHT (See page [RS-401](#))