

STEERING PAD

COMPONENTS

RS

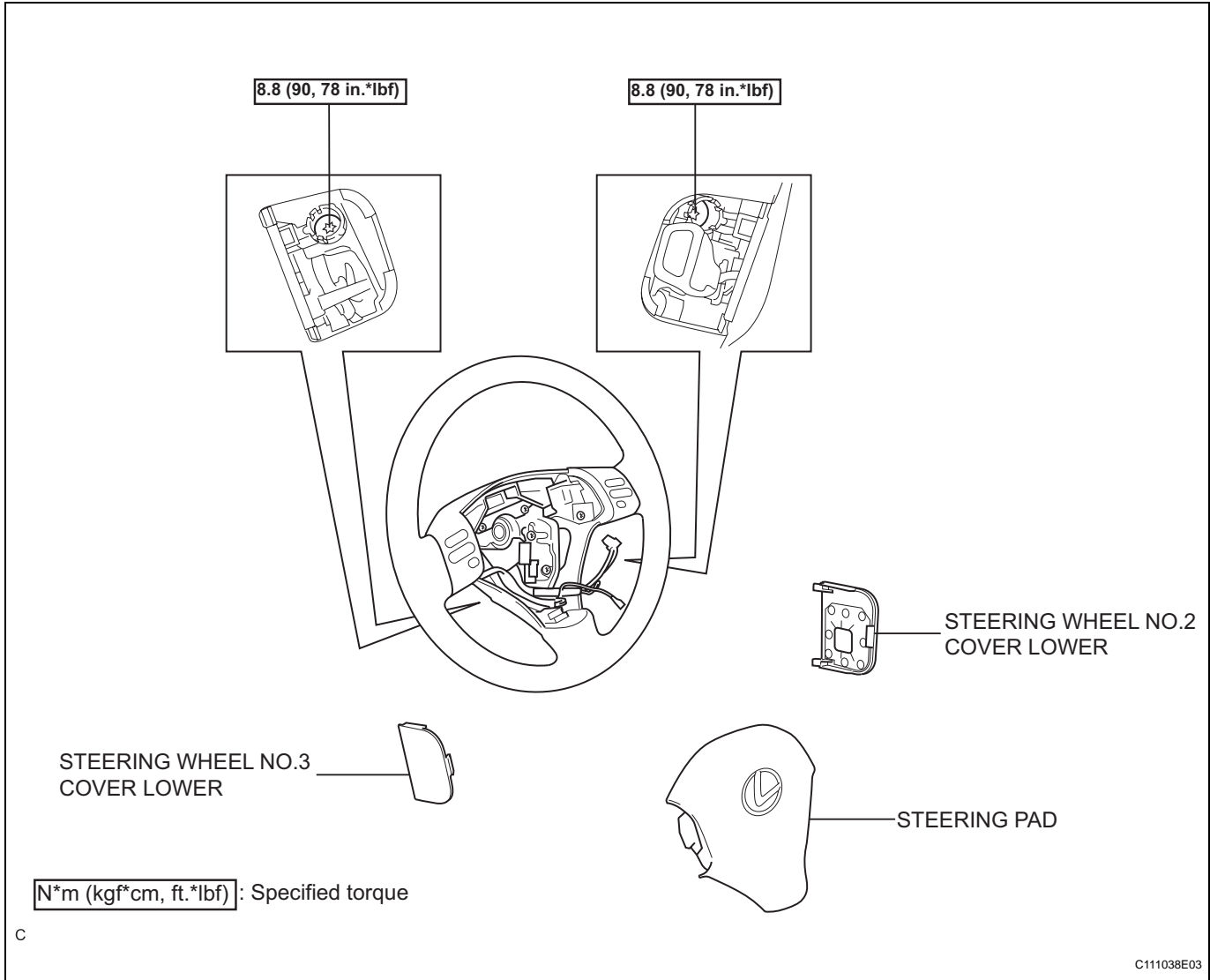

ON-VEHICLE INSPECTION

1. INSPECT STEERING PAD (VEHICLE NOT INVOLVED IN COLLISION)

- (a) Perform a diagnostic system check (See page [RS-25](#)).
- (b) With the steering pad installed on the vehicle, perform a visual check. If there are any defects as mentioned below, replace the steering pad with a new one:
Cuts, minute cracks or marked discoloration on the steering pad top surface or in the grooved portion.

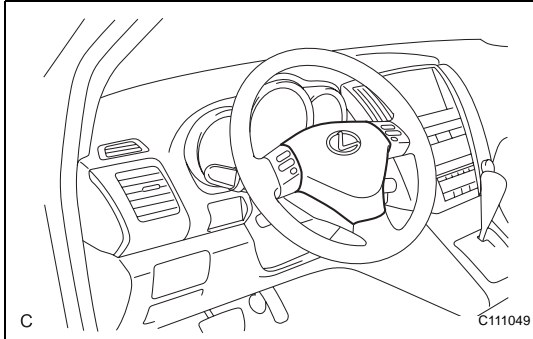

2. INSPECT STEERING PAD (VEHICLE INVOLVED IN COLLISION AND AIRBAG HAS NOT DEPLOYED)

- (a) Perform a diagnostic system check (See page [RS-25](#)).
- (b) With the steering pad removed from the vehicle, perform a visual check. If there are any defects as mentioned below, replace the steering pad or steering wheel assembly with a new one:
 - Cuts, minute cracks or marked discoloration on the steering pad top surface or in the grooved portion.
 - Cracks or other damage to the connectors.
 - Deformation of the steering wheel assembly.
 - Deformation of the horn button contact plate of the steering pad.
 - There should be no interference between the steering pad and steering wheel assembly, and the clearance should be uniform all the way around when the new steering pad is installed on the steering wheel assembly.

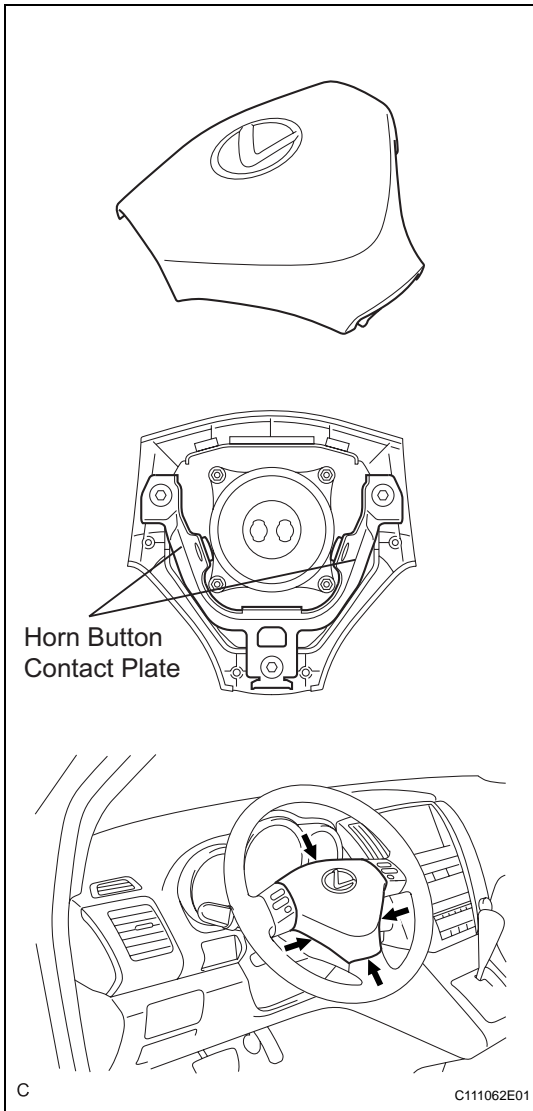

CAUTION:

Be sure to follow the correct removal and installation procedures.