

SPIRAL CABLE

COMPONENTS

RS

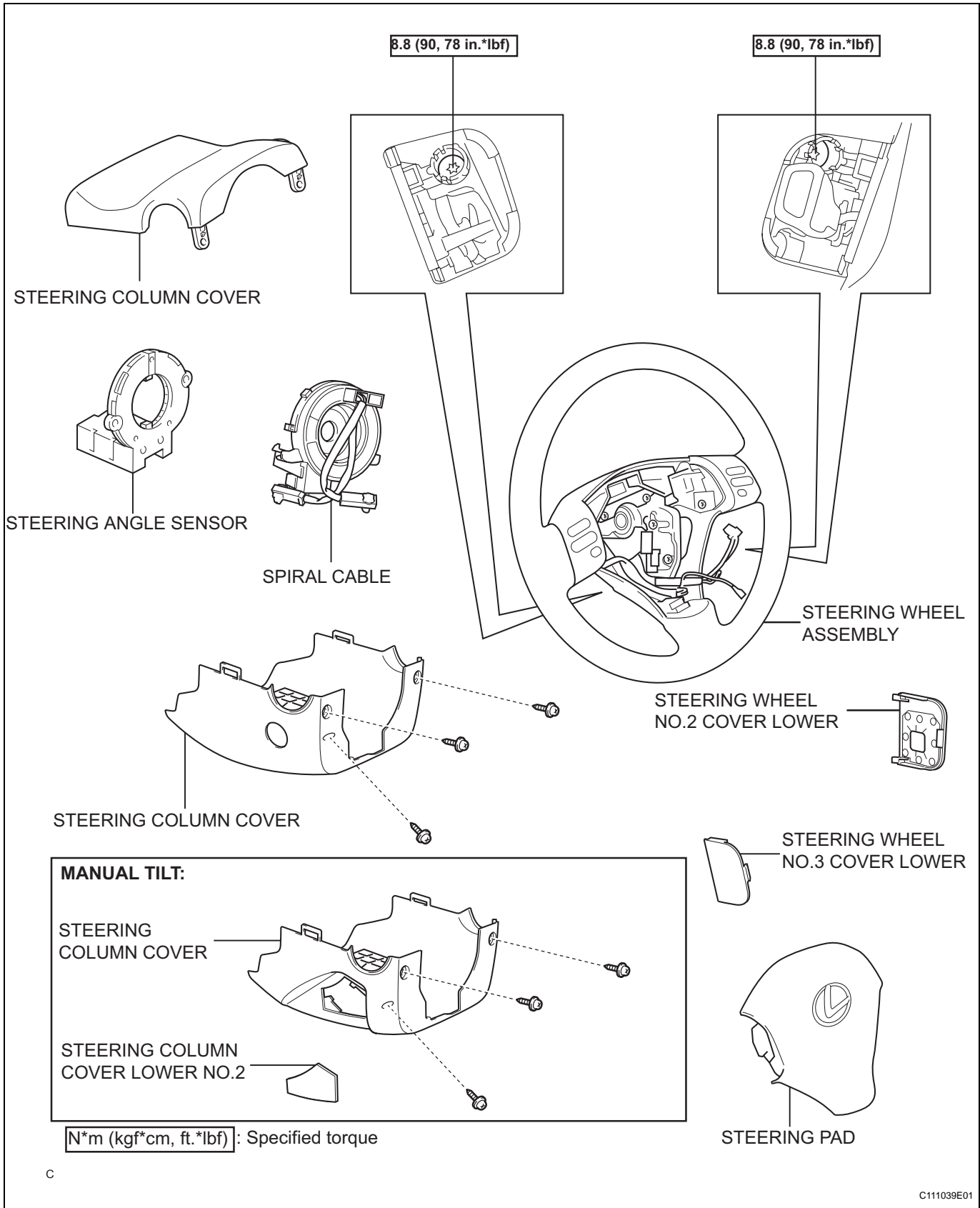

REMOVAL

1. **PRECAUTION**
CAUTION:
 Be sure to read the "PRECAUTION" thoroughly before servicing (See page [RS-1](#)).
2. **DISCONNECT CABLE FROM NEGATIVE BATTERY TERMINAL**
CAUTION:
 Wait for 90 seconds after disconnecting the cable to prevent the airbag working
3. **PLACE FRONT WHEELS FACING STRAIGHT AHEAD**
4. **REMOVE STEERING WHEEL NO.3 COVER LOWER** (See page [RS-387](#))
5. **REMOVE STEERING WHEEL NO.2 COVER LOWER** (See page [RS-387](#))
6. **REMOVE STEERING PAD** (See page [RS-388](#))
7. **REMOVE STEERING WHEEL ASSEMBLY (for Manual Tilt)** (See page [SR-40](#))
8. **REMOVE STEERING WHEEL ASSEMBLY (for Power Tilt and Power Telescopic)** (See page [SR-50](#))
9. **REMOVE STEERING COLUMN COVER (for Manual Tilt)** (See page [SR-40](#))
10. **REMOVE STEERING COLUMN COVER (for Power Tilt and Power Telescopic)** (See page [SR-51](#))
11. **REMOVE SPIRAL CABLE**
 - (a) Disconnect the connectors from the spiral cable.
NOTICE:
 When handling the airbag connector, take care not to damage the airbag wire harness.
 - (b) Disengage the 3 claws and remove the spiral cable.
12. **REMOVE STEERING ANGLE SENSOR** (See page [BC-128](#))

RS

