

REAR AIRBAG SENSOR

COMPONENTS

RS

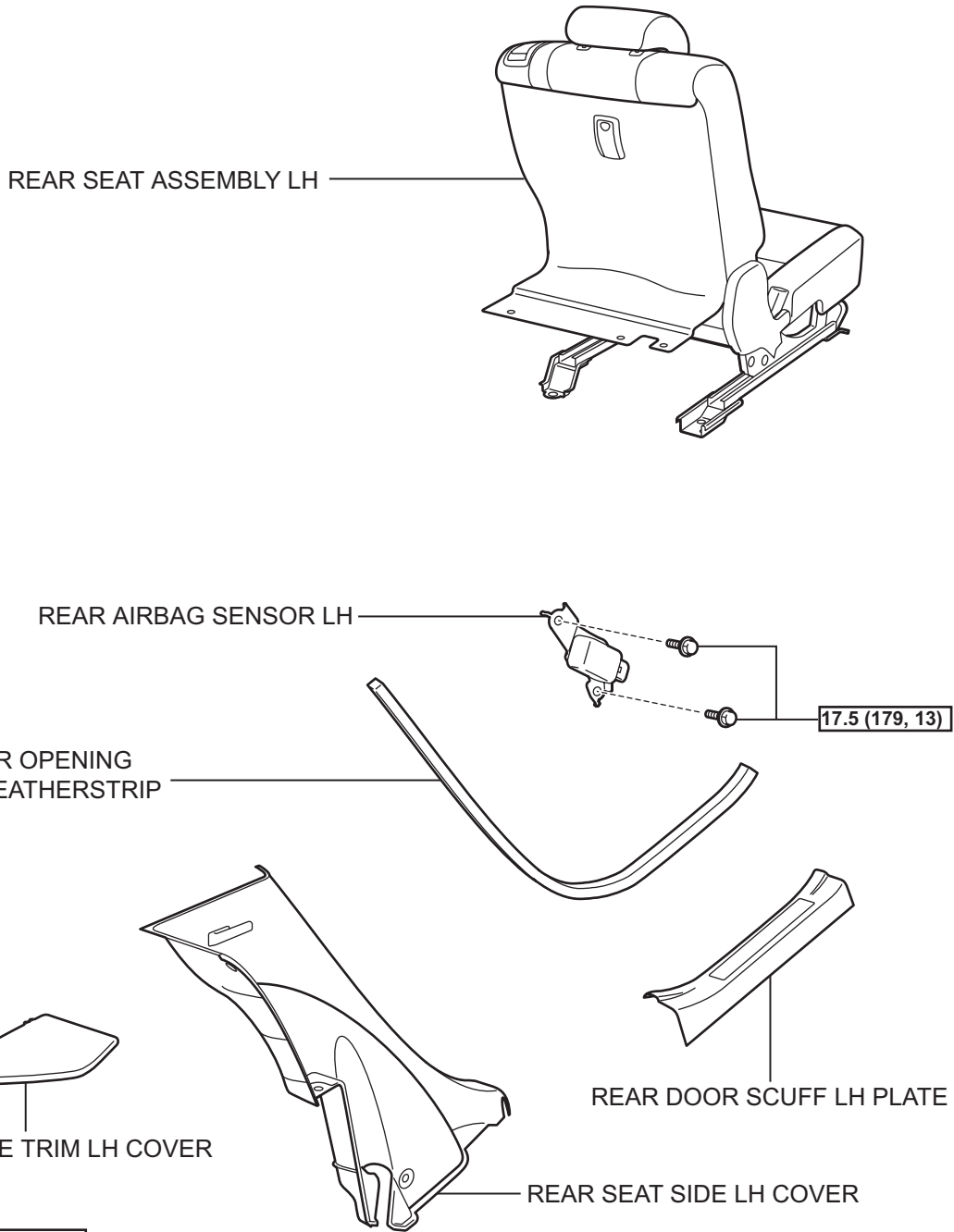

N*m (kgf*cm, ft.*lbf): Specified torque

C

ON-VEHICLE INSPECTION

1. **INSPECT REAR AIRBAG SENSOR (VEHICLE NOT INVOLVED IN COLLISION)**
 - (a) Perform a diagnostic system check (See page [RS-25](#)).
2. **INSPECT REAR AIRBAG SENSOR (VEHICLE INVOLVED IN COLLISION AND AIRBAG HAS NOT DEPLOYED)**
 - (a) Perform a diagnostic system check (See page [RS-25](#)).
 - (b) When the quarter panel of the vehicle or its area is damaged, check if there is any damage to the rear airbag sensor. If there are any defects as mentioned below, replace the rear airbag sensor with a new one:
 - Cracks, dents or chips on the sensor housing.
 - Cracks or other damage to the connector.
 - Peeling off of the label or damage to the serial number.

CAUTION:
Be sure to follow the correct removal and installation procedures.
3. **INSPECT REAR AIRBAG SENSOR (VEHICLE INVOLVED IN COLLISION AND AIRBAG HAS DEPLOYED)**
 - (a) Replace the rear airbag sensor.

CAUTION:
Be sure to follow the correct removal and installation procedures.

HINT:
The rear airbag sensor on the impacted side should be replaced after the curtain shield airbag assembly has deployed.