

# PNEUMATIC CYLINDER WITH FRONT SHOCK ABSORBER COMPONENTS

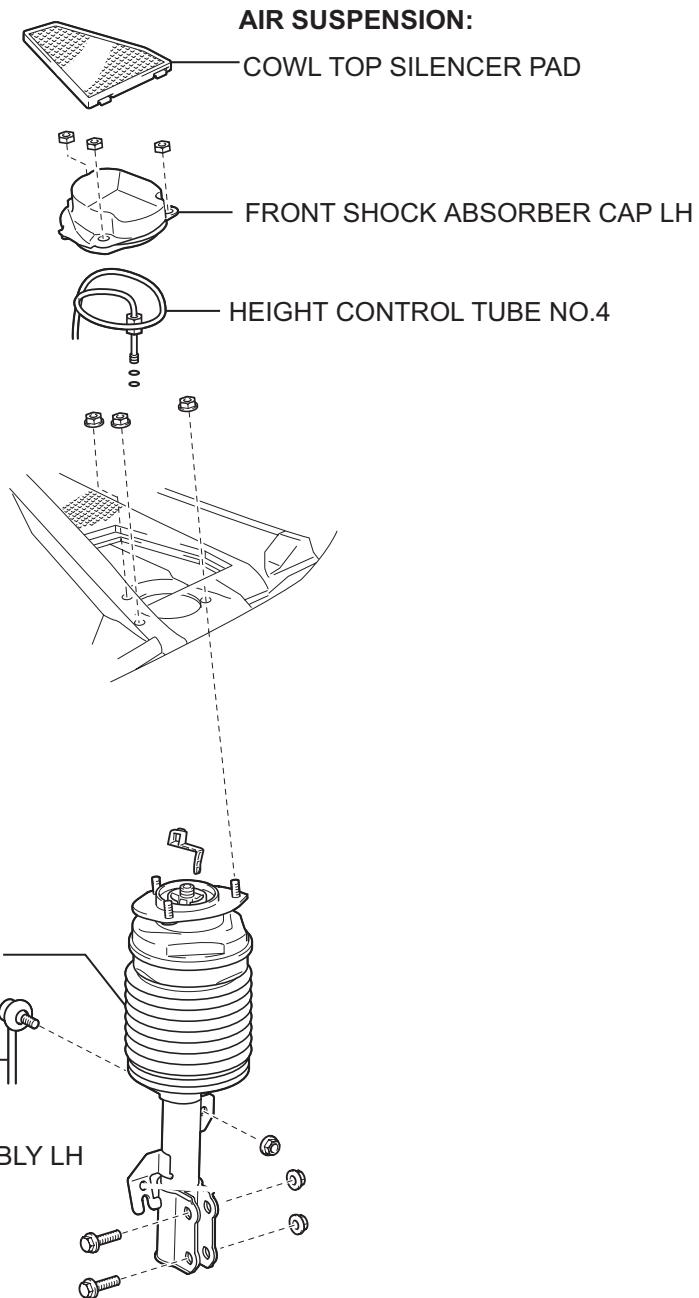

SP

## REMOVAL

### 1. REMOVE FRONT WHEELS

#### NOTICE:

Before disconnecting the air tube, press the height control OFF SW to stop the vehicle height control operation.

### 2. REMOVE COWL TOP SIDE SILENCER PAD LH

### 3. REMOVE FRONT SHOCK ABSORBER CAP LH

- (a) Remove the 3 nuts and the front shock absorber cap LH.

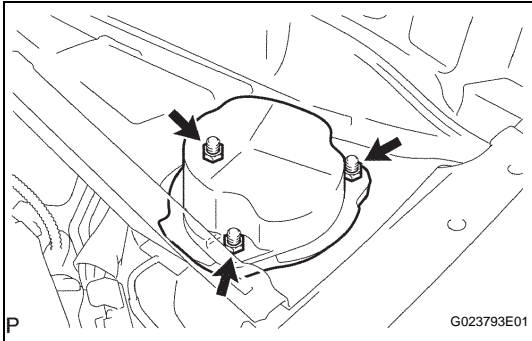

### 4. SEPARATE HEIGHT CONTROL TUBE NO.4

- (a) Remove the height control tube clamp No. 11. Disconnect the height control tube No. 4 from the pneumatic front LH w/ shock absorber cylinder assembly by loosening the nut.

#### NOTICE:

Keep the chamber of the pneumatic front LH/w/ shock absorber cylinder assembly unmoved by holding it with your hand.

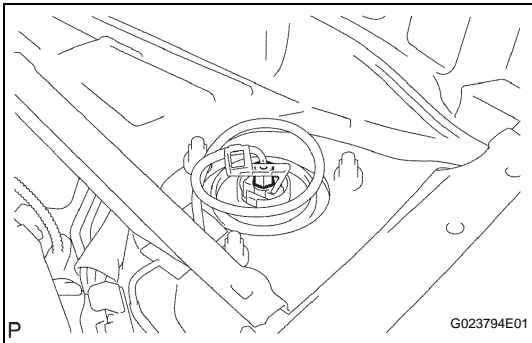

- (b) Holding chamber by your hand.

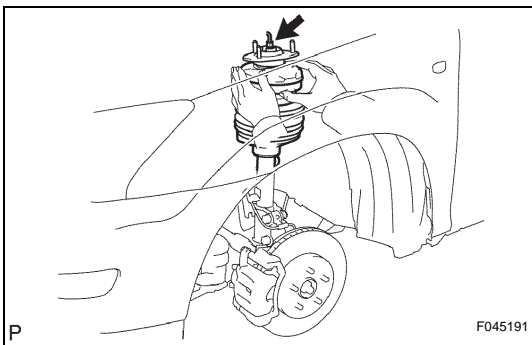

### 5. SEPARATE FRONT STABILIZER LINK ASSEMBLY LH

- (a) Support the suspension lower arm No. 1 with a jack using a wood block to avoid damage.  
 (b) Remove the nut and the stabilizer link assembly from the pneumatic front LH w/ shock absorber cylinder assembly.  
 (c) Disconnect the height control sensor sub-assembly front LH from the front suspension arm sub-assembly lower No. 1 LH.

#### HINT:

If the ball joint turns together with the nut, use a hexagon (6 mm) wrench to hold the stud.

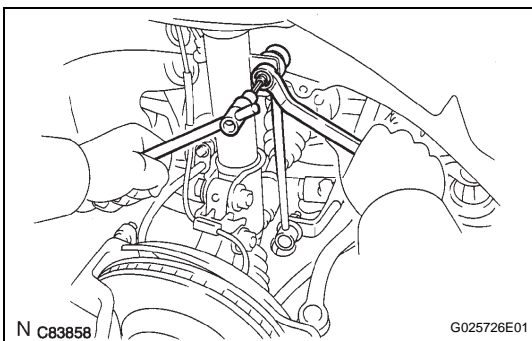

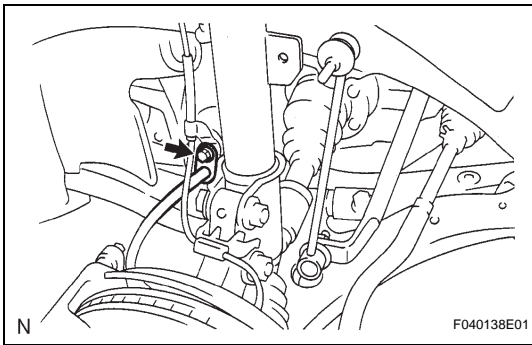

## 6. REMOVE PNEUMATIC FRONT LH W/SHOCK ABSORBER CYLINDER ASSEMBLY

- (a) Remove the bolt, and release the flexible hose and the speed sensor wire harness front the pneumatic front LH w/ shock absorber cylinder assembly.

### NOTICE:

**Confirm the disconnection of the front speed sensor and the pneumatic front w/ shock absorber cylinder assembly.**

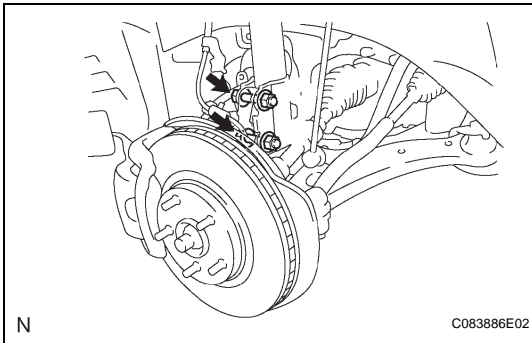

- (b) Remove the 2 nuts and the pneumatic front w/ shock absorber cylinder assembly (lower side) from the steering knuckle.

### NOTICE:

- Leave the 2 bolts untouched.
- Do not turn the steering.

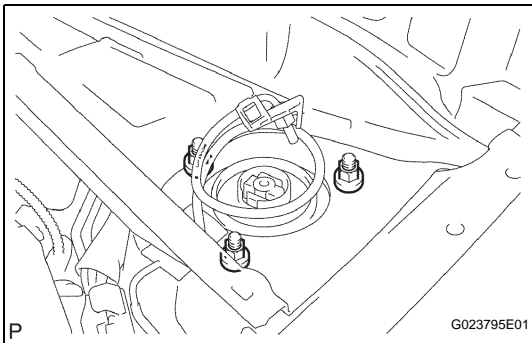

- (c) Remove the 3 nuts on the pneumatic cylinder with shock absorber (upper side).

- (d) Let it down slowly to remove the 2 bolts and the pneumatic front LH w/ shock absorber cylinder assembly.

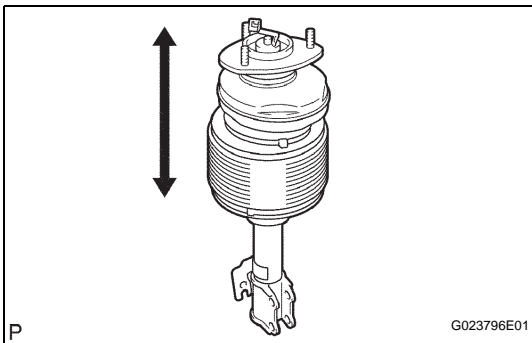

## INSPECTION

### 1. INSPECT PNEUMATIC FRONT LH W/SHOCK ABSORBER CYLINDER ASSEMBLY

- (a) Inspect pneumatic cylinder assembly operation
- (1) Compress and expand the pneumatic cylinder assembly 4 times or more.
  - (2) Inspect the pneumatic cylinder assembly.

### NOTICE:

- Be sure not to cover the connection part for height control tube No. 4 when compressing and expanding the pneumatic cylinder assembly.
- When disposing of the pneumatic front w/ shock absorber cylinder assembly, see DISPOSAL (See page SP-19)