

# REAR SUSPENSION NO. 2 ARM (for 2WD)

## COMPONENTS

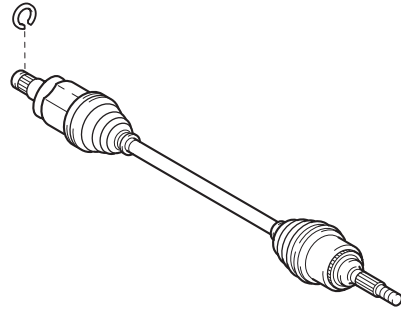

REAR SUSPENSION ARM ASSEMBLY NO.2 LH

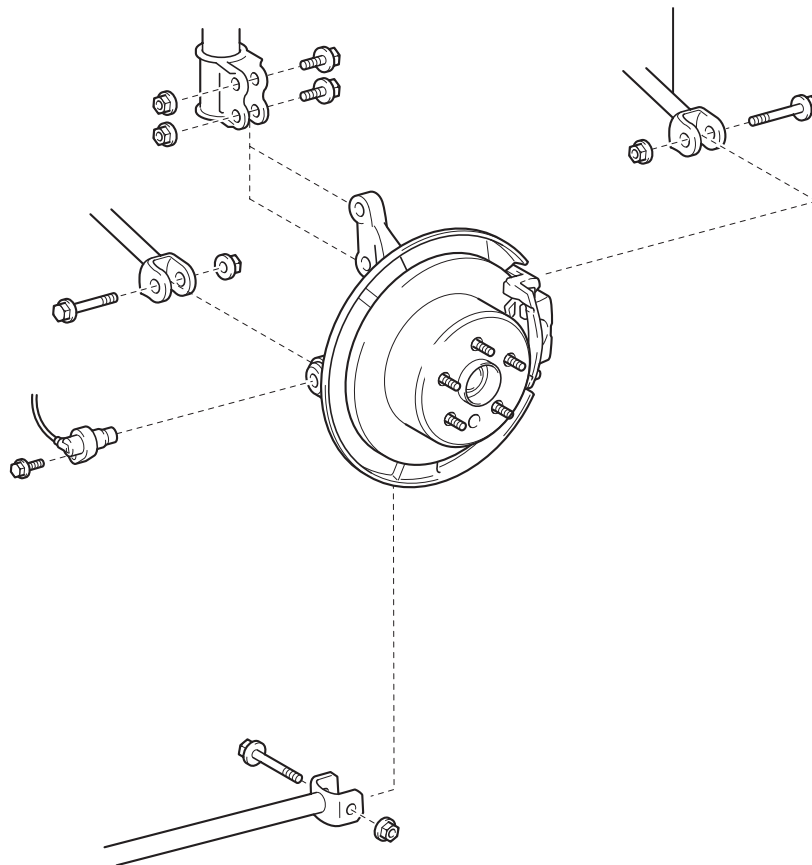

SP

## REMOVAL

### NOTICE:

- Press the height control switch to stop the vehicle height control operation before jacking up or lifting up the vehicle with air suspension.
- Press the height control switch to operate the vehicle height control after jacking down or lifting down the vehicle with air suspension.
- Support the rear axle carrier with a jack.

### 1. REMOVE REAR WHEEL

### 2. REMOVE REAR SUSPENSION ARM ASSEMBLY NO.2 LH

- (a) Remove the nut, and separate the height control sensor sub-assembly from the suspension arm assembly No. 2 (w/ height control sensor sub-assembly).

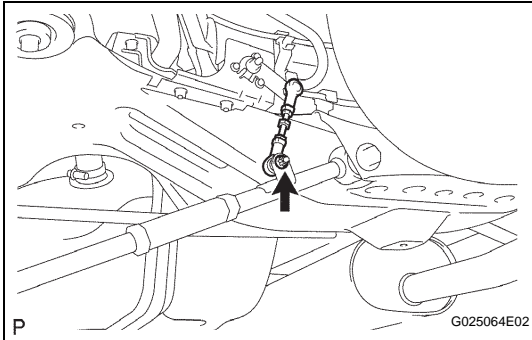

- (b) Remove the bolt, nut and disconnect the rear suspension arm assembly No. 2 (inner side).

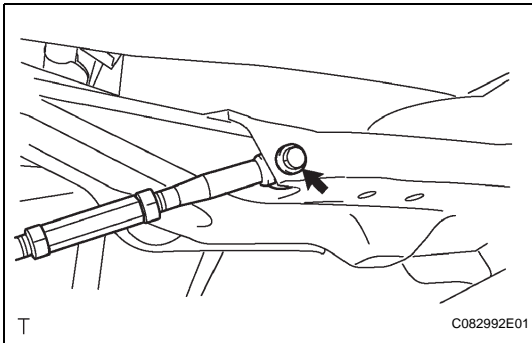

- (c) Remove the bolt, nut and the rear suspension arm assembly No. 2 (outer side) from the rear axle carrier.

### NOTICE:

**When removing the bolt, keep the nut from rotating.**

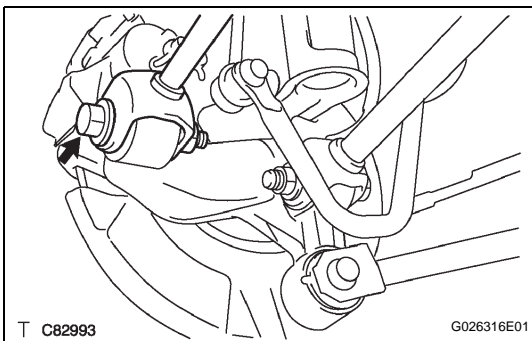

## INSTALLATION

### 1. TEMPORARILY TIGHTEN REAR SUSPENSION ARM ASSEMBLY NO.2 LH

- (a) Install the rear suspension arm assembly No. 2 (inner side) with the bolt, and temporarily tighten the bolt.

### HINT:

Ensure that the paint mark faces to the rear.

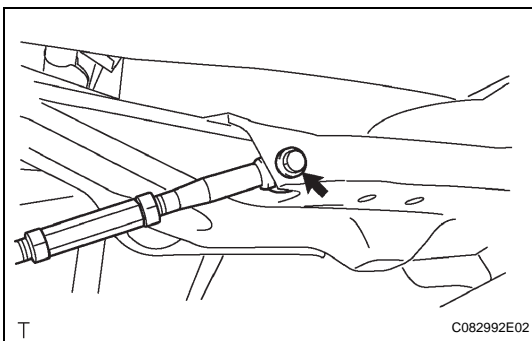

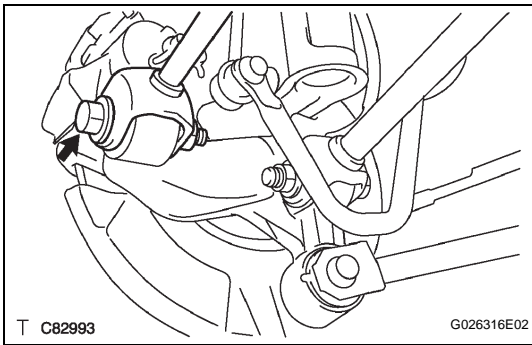

- (b) Connect the rear suspension arm assembly No. 2 (outer side) to the rear axle carrier with the bolt and nut, and temporarily tighten the bolt.

**NOTICE:**

**When installing the bolt, tighten the bolt temporarily with the nut fixed.**

**2. STABILIZE SUSPENSION (See page [SP-49](#))****3. FULLY TIGHTEN REAR SUSPENSION ARM ASSEMBLY NO.2 LH**

- (a) Fully tighten the bolt.

**Torque: 120 N\*m (1,224 kgf\*cm, 89 ft.\*lbf)**

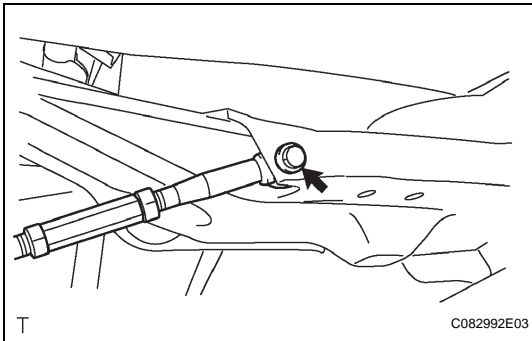

- (b) Fully tighten the bolt.

**Torque: 112 N\*m (1,142 kgf\*cm, 83 ft.\*lbf)**

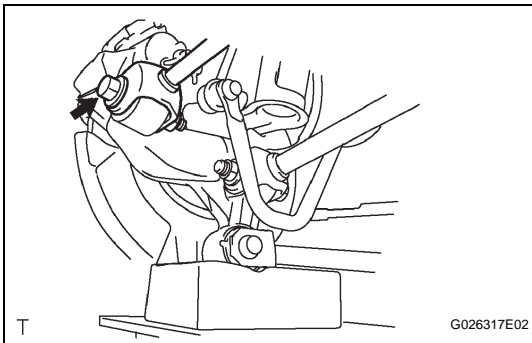

- (c) Install the height control sensor sub-assembly and nut to the suspension arm assembly No. 2 (w/ height control sensor sub-assembly.)

**Torque: 5.4 N\*m (55 kgf\*cm, 48 in.\*lbf)**

**4. INSTALL REAR WHEEL**

**Torque: 103 N\*m (1,050 kgf\*cm, 76 ft.\*lbf)**

**5. INSPECT REAR WHEEL ALIGNMENT**

(See page [SP-7](#))

**6. ADJUST VEHICLE HEIGHT****7. ADJUST HEADLIGHT AIM ONLY**