

INSTALLATION

1. INSTALL HEIGHT CONTROL COMPRESSOR ASSEMBLY

- (a) Coat the O-ring with MP grease, install the height control compressor assembly.

HINT:

When the height control compressor assembly is replaced with new one, it doesn't require a new O-ring.

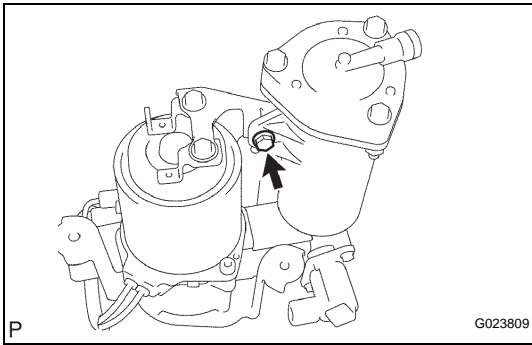

2. INSTALL HEIGHT CONTROL DRYER ASSEMBLY

- (a) Install the height control dryer assembly with a bolt onto the height control compressor assembly.

Torque: 6.4 N*m (65 kgf*cm, 57 in.*lbf)

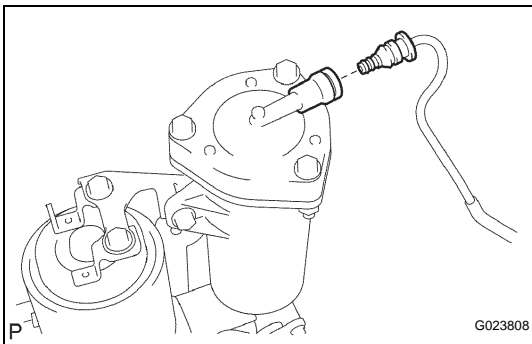

- (b) Connect the height control tube No. 2 to the height control dryer assembly.

- (c) Lock the clip and holder.

HINT:

For the installation procedure of the (type 3) tube, refer to PRECAUTION of SUSPENSION CONTROL SYSTEM (See page [SC-1](#)).

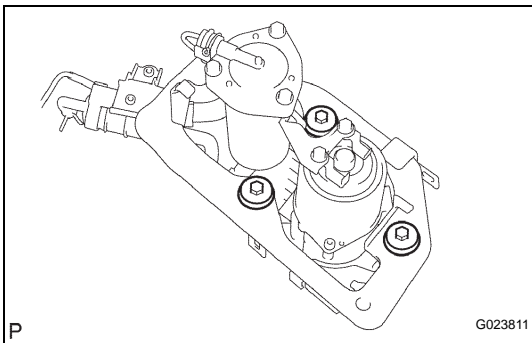

3. INSTALL REAR HEIGHT CONTROL COMPRESSOR BRACKET

- (a) Install the 3 height control compressor bush No. 2 onto the rear height control compressor bracket.

- (b) Install the rear height control compressor bracket with the 3 bolts onto the height control compressor assembly.

Torque: 5.9 N*m (60 kgf*cm, 52 in.*lbf)

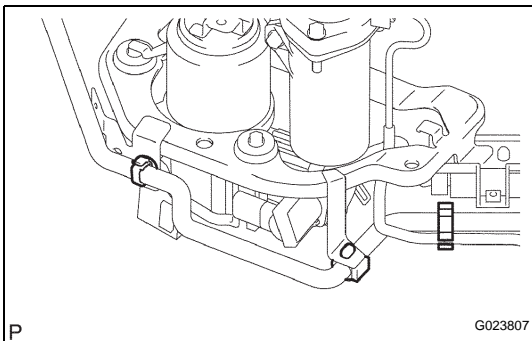

- (c) Install the 3 clamps.

4. INSTALL HEIGHT CONTROL FILTER

- (a) Install the 2 hoses and 2 clips to the height control filter.

- (b) Install a clamp onto the height control filter.

- (c) Connect the height control filter onto the rear height control compressor bracket.

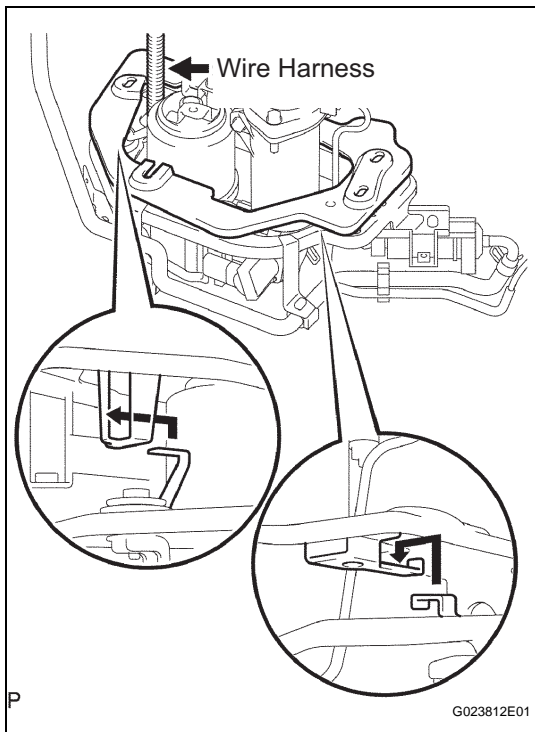

5. INSTALL REAR HEIGHT CONTROL COMPRESSOR BRACKET

(a) Passing the wire harness sub-assembly between the bracket and compressor, temporarily place the bracket as shown in the illustration.

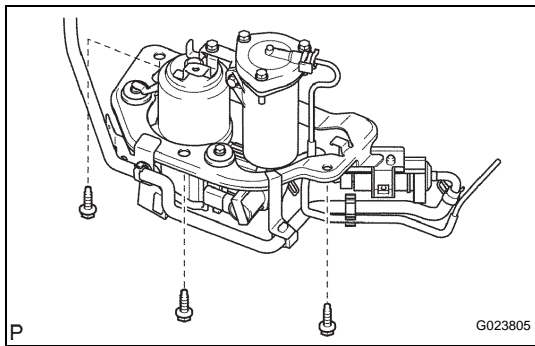

(b) Install the rear height control compressor bracket with the 3 bolts onto the height control compressor bracket.

Torque: 19 N*m (194 kgf*cm, 14 ft.*lbf)

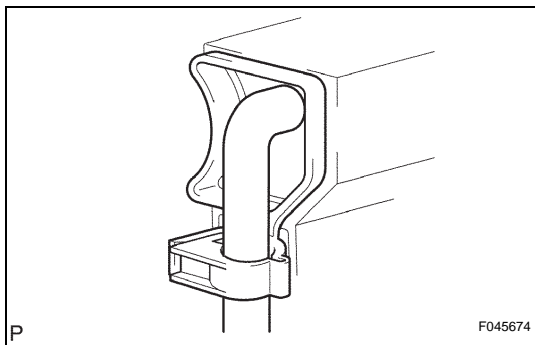

(c) Connect the hose to the cap grommet and clamp it.

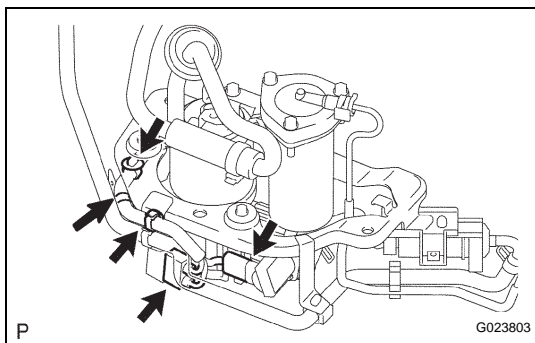

(d) Install the 3 clamps and the 2 connectors.

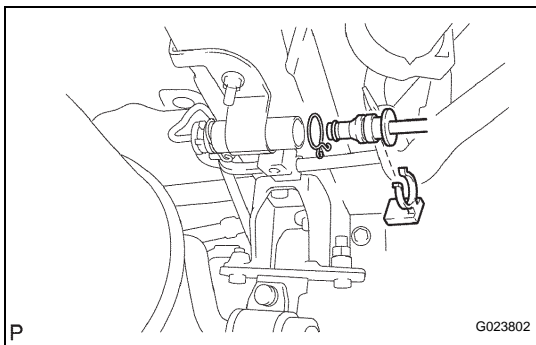
**6. CONNECT HEIGHT CONTROL TUBE NO.2**

- (a) Install a new O-ring onto the height control tube No. 2.
- (b) Coat the O-ring with MP grease.
- (c) Connect the height control tube No. 2 to the 2 way cap.
- (d) Lock the tube with a new clip and a new holder.

HINT:

For the installation procedure of the (type 3) tube, refer to PRECAUTION of SUSPENSION CONTROL SYSTEM (See page [SC-1](#)).

7. INSPECT AIR LEAK**8. INSTALL HEIGHT CONTROL COMPRESSOR COVER**

- (a) Install the height control compressor cover with the 2 screws, the clip and the bolt.