

REMOVAL

NOTICE:

- Before replacement, press the height control OFF switch to stop the vehicle height control operation.
- Be careful that the vehicle body lowers because the air in the pneumatic cylinder is discharged by disconnecting the pneumatic cylinder side air tube of the height control valve.
- This operation takes out the air from the front shock absorber, therefore never rotate the lower part of the absorber by turning the steering wheel etc..

1. REMOVE ENGINE UNDER COVER NO.1
2. SEPARATE FRONT FENDER SPLASH SHIELD SUB-ASSEMBLY RH
3. SEPARATE FRONT FENDER SPLASH SHIELD SUB-ASSEMBLY LH
4. REMOVE FRONT BUMPER COVER
5. REMOVE HEIGHT CONTROL VALVE SUB-ASSEMBLY NO.1

(a) Disconnect the connector.

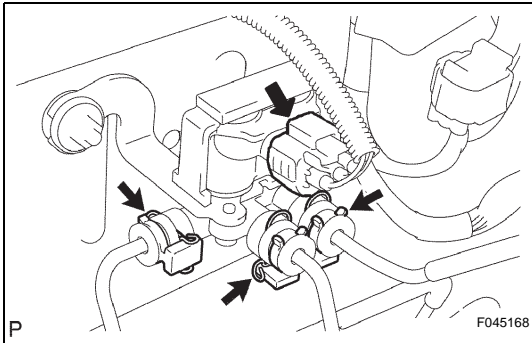

(b) Disconnect the 3 height control tubes.

HINT:

For the removal procedure of the (type 3) tube, refer to PRECAUTION OF SUSPENSION CONTROL SYSTEM (See page [SC-1](#)).

(c) Remove the 2 nuts and the height control valve sub-assembly No.1.

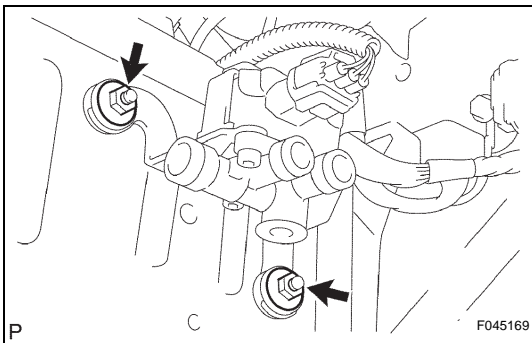

6. REMOVE HEIGHT CONTROL VALVE SUB-ASSEMBLY NO.2

(a) Disconnect the connector.

(b) Using SST, disconnect the 3 height control tubes.

SST 09730-00010

HINT:

For the disconnecting procedure of the (type 2) tube, refer to PRECAUTION OF SUSPENSION CONTROL SYSTEM (See page [SC-1](#))

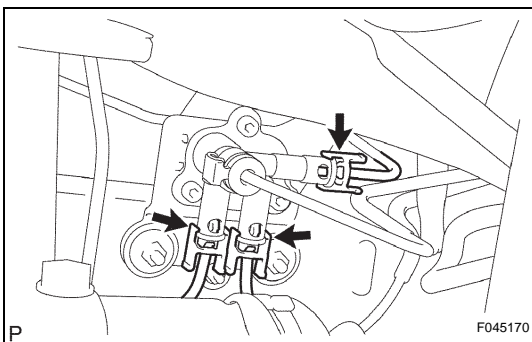

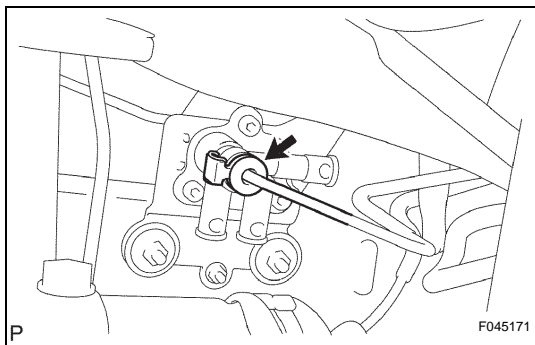

- (c) Disconnect the height control tube.
 HINT:
 For the disconnecting procedure of the (type 3) tube, refer to PRECAUTION OF SUSPENSION CONTROL SYSTEM (See page [SC-1](#)).

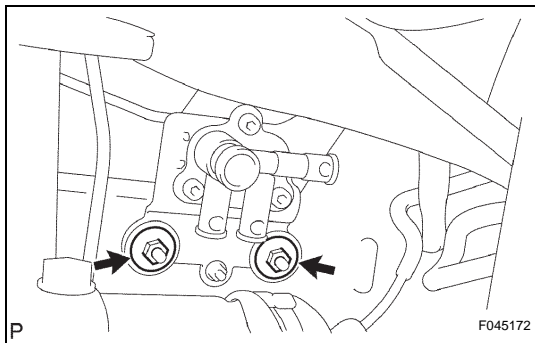

- (d) Remove the 2 nuts and the height control valve sub-assembly No.2.

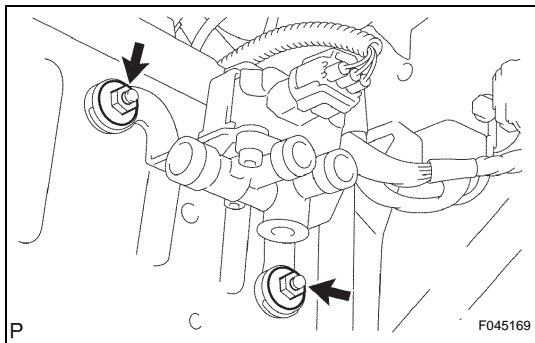

INSTALLATION

1. INSTALL HEIGHT CONTROL VALVE SUB-ASSY NO.1

- (a) Install the height control valve sub-assembly No.1 with the 2 nuts.
Torque: 5.4 N*m (55 kgf*cm, 48 in.*lbf)
 (b) Coat 2 new O-rings with MP grease No.2 and install them on each height control tube.

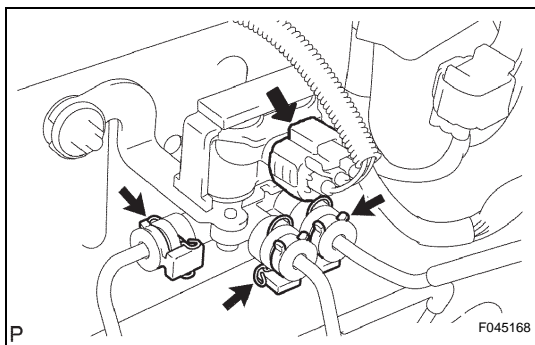

- (c) Connect the 3 height control tubes onto the height control valve sub-assembly No.1.
 HINT:
 For the removal procedure of the (type 3) tube, refer to PRECAUTION OF SUSPENSION CONTROL SYSTEM (See page [SC-1](#)).
- (d) Connect the connector.

2. INSPECT AIR LEAK

3. INSTALL FRONT BUMPER COVER

4. INSTALL FRONT FENDER SPLASH SHIELD SUB-ASSY LH

5. INSTALL FRONT FENDER SPLASH SHIELD SUB-ASSY RH

6. INSTALL ENGINE UNDER COVER NO.1

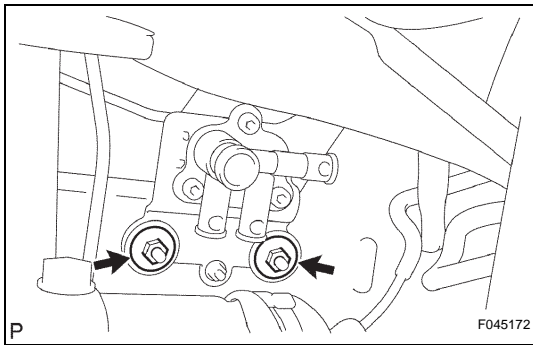

7. INSTALL HEIGHT CONTROL VALVE SUB-ASSEMBLY NO.2

- (a) Install the height control valve sub-assembly No.2 with the 2 nuts.

Torque: 5.4 N*m (55 kgf*cm, 48 in.*lbf)

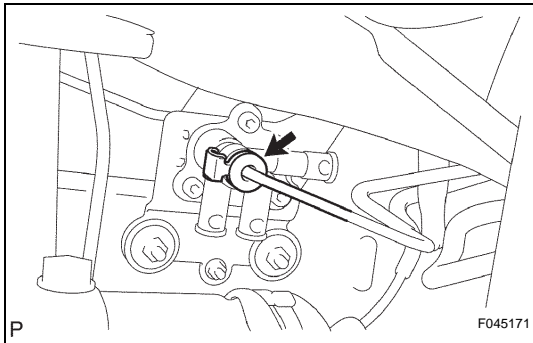

- (b) Coat the O-ring with MP grease.
 (c) Install the O-ring onto the height control tube.
 (d) Connect the height control tube.

HINT:

For the removal procedure of the (type 3) tube, refer to PRECAUTION OF SUSPENSION SYSTEM.

- (e) Install 6 new O-ring and 3 new plates to each installed part of the height control valve No.2 tube.

HINT:

When the height control valve No.2 is replaced with a new one, it does not require a new O-ring.

- (f) Install the 3 height control tubes.

HINT:

For the removal procedure of the (type 2) tube, refer to PRECAUTION OF SUSPENSION CONTROL SYSTEM (See page [SC-1](#))

- (g) Connect the connector.

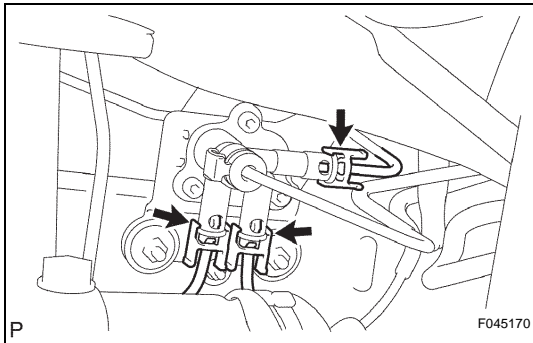

8. INSPECT AIR LEAK